

VEVOR[®]

TOUGH TOOLS, HALF PRICE

Technical Support and E-Warranty Certificate

www.vevor.com/support

ELECTRIC PORTABLE HEATER

MODEL:KPT-500

We continue to be committed to provide you tools with competitive price.

"Save Half", "Half Price" or any other similar expressions used by us only represents an estimate of savings you might benefit from buying certain tools with us compared to the major top brands and does not necessarily mean to cover all categories of tools offered by us. You are kindly reminded to verify carefully when you are placing an order with us if you are actually saving half in comparison with the top major brands.

VEVOR[®]

TOUGH TOOLS, HALF PRICE

ELECTRIC PORTABLE
HEATER

MODEL: KPT-500



NEED HELP? CONTACT US!

Have product questions? Need technical support? Please feel free to contact us:

✉ CustomerService@vevor.com

This is the original instruction, please read all manual instructions carefully before operating. VEVOR reserves a clear interpretation of our user manual. The appearance of the product shall be subject to the product you received. Please forgive us that we won't inform you again if there are any technology or software updates on our product.

INTRODUCTION

Before using your new heater, please carefully read through the following instructions. KEEP THIS BOOKLET IN A SAFE PLACE SO THAT YOU MAY CONSULT IT LATER.

After removing the packaging, make sure that the appliance is in good condition.

The packaging materials may contain plastic, nails etc., which may be hazardous and therefore should not be left within the reach of children.

IMPORTANT SAFETY INFORMATION

To ensure the best performance from your heater, please read and save the following instructions.

WHEN USING ELECTRICAL APPLIANCES, BASIC PRECUATIONS SHOULD ALWAYS BE FOLLOWED TO REDUCE THE RISK OF FIRE, ELECTRIC SHOCK AND INJURY TO PERSON, INCLUDING THE FOLLOWING:

- Read all instructions before using this heater.
- This heater is hot when in use. To avoid burns, do not let bare skin touch hot surfaces. Use grip handle when provided.
- Keep combustible materials such as drapes, furniture, pillows, bedding, papers, clothes, and curtains at least three (3) feet (0.9m) from the front of heater and keep them at least 1 foot (0.3m) the sides and rear of the heater.
- Extreme caution is necessary when heater is used by or near children or invalids and whenever the heater is left operating and unattended.
- Always unplug heater when not in use.
- Do not use any heater with a damaged cord or plug or after the heater malfunctions or has been dropped or damaged in any manner. Return heater to manufacturer for examination, electrical or mechanical adjustment, or repair. (See Warranty for information).
- Do not use outdoors.
- This heater is not to be used in bathrooms, laundry areas or other

similar indoor locations. Never locate heater where it may fall into a bathtub or other water container.

- Do not run cord under carpeting. Do not cover cord with throw rugs, runners or the like. Arrange cord away from traffic area where it will not be tripped over.
- To disconnect heater, turn control to OFF then remove plug from outlet.
- Do not insert or allow foreign objects to enter any ventilation or exhaust opening as this may cause electric shock or fire or damage the heater.
- To prevent possible fire, do not block air intakes or exhaust in any manner. Do not use on soft surfaces, like a bed, where openings may become blocked.
- A heater has hot and arcing or sparking parts inside. Do not use it in areas where gasoline, paint or flammable liquids are used or stored.
- Use this heater only as directed in this manual. Any other use not recommended by the manufacturer may cause fire, electric shock or injury to persons.
- Always plug heaters directly into a wall outlet/receptacle. Never use with an extension cord or relocatable power tap (outlet/power strip).
- If the heater will not operate: See specific instructions in Safety Feature explained in this manual.

OPERATION

1. Before inserting the plug into an electrical outlet, make sure that the electrical supply in your area matches that on the rating label on the unit.
2. SWITCH : 0: OFF
—: 500W

Before removing the plug from the socket, turn the switch to '0'.

OVERVIEW



TIP-OVER PROTECTION

This heater is protected with a safety switch that turns off the appliance automatically when the heater falls over, or is at an excessive angle from the horizontal. This helps prevent accidents, and the heater will back to the standby mode when it is put back upright, press the buttons on control panel or remote control to reset the heater

OVERHEAT PROTECTION

This heater is protected with an overheat protection that switches off the appliance automatically in case of overheating. For example: due to the total or partial obstruction of the vents. In this case, unplug the appliance, wait about 30 minutes for it to cool and remove the object which is obstructing the vents. Then switch it back on as described above. The appliance should now operate normally. Should the problem persist, please contact Customer Service for assistance.

CLEANING & MAINTENANCE

- Before undertaking any cleaning or maintenance on the appliance, disconnect it from the power supply.
- For cleaning it is recommended to use a soft moist rag and neutral detergent. Do not use an abrasive cloth or devices which could affect

the appearance of the appliance. Check that the hot air outlet and the ventilation inlet are free of dust and dirt.

During cleaning, be careful not to touch the heating elements.

- To open the filter on the back for cleaning, press the top of plastic net at back.
- In case of breakdown and/or poor functioning of the appliance, disconnect the appliance from the power supply and contact an authorised repairer.

SPECIFICATIONS

Model No	KPT-500
Voltage	AC120V
Frequency	60Hz
Max Power	500W
Weight	0.51kg
Size	130*90*146 mm

TROUBLESHOOTING

If the heater will not operate, please check the following:

1. Check if the power cord is plugged into an electrical outlet. If not, plug the unit into an appropriate outlet.
2. Check if the electricity to the outlet is working.
3. Ensure the power is turned to the ON position.
4. Make sure the heater is placed on a flat, solid surface.
5. Refer to the SAFETY FEATURES for additional information.

ACCESSORIES VIEW

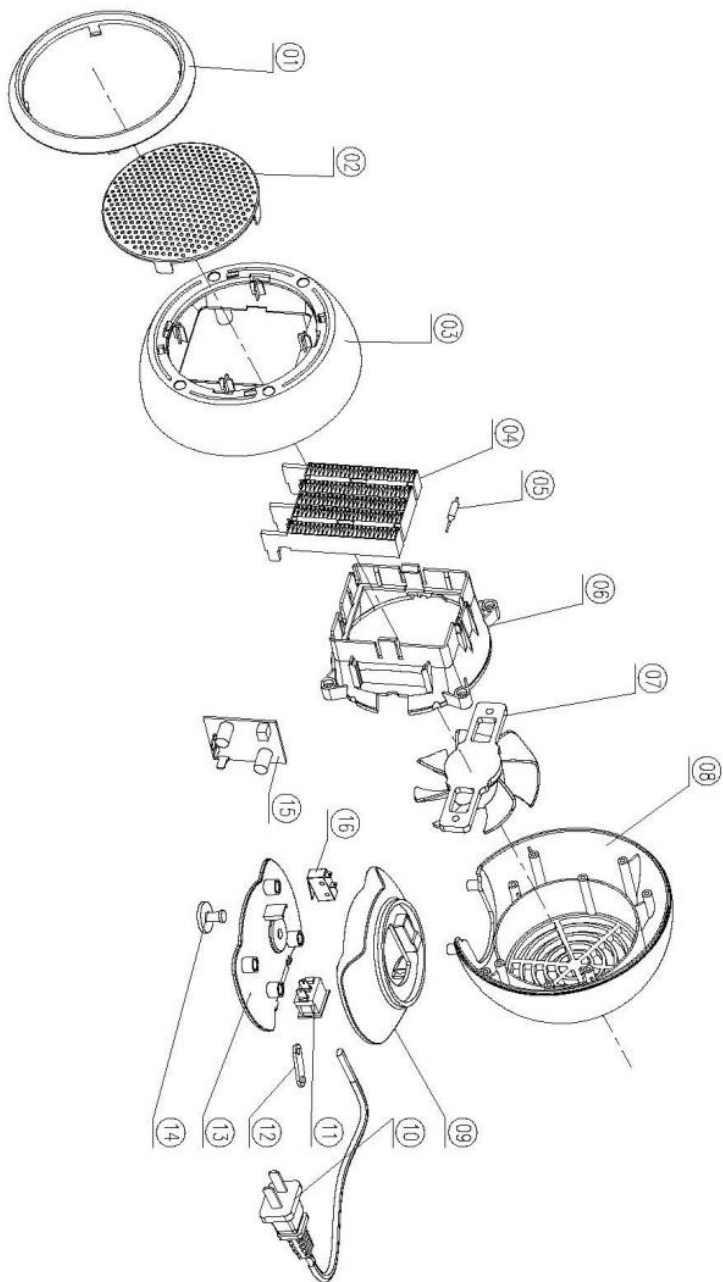

- 1.Declaration Ring
- 2.Grille
- 3.Front Body
- 4.PTC
5. Thermal Cut-out
- 6.PTC Support
- 7.DC Motor
- 8.Back Body
- 9.Basement
- 10.Power Cord
- 11.ON/OFF Switch
- 12.Press Board
- 13.Basement Cover
- 14.Pole
- 15.PCB Power Board
- 16.Tip-over Switch

CIRCUIT DIAGRAM

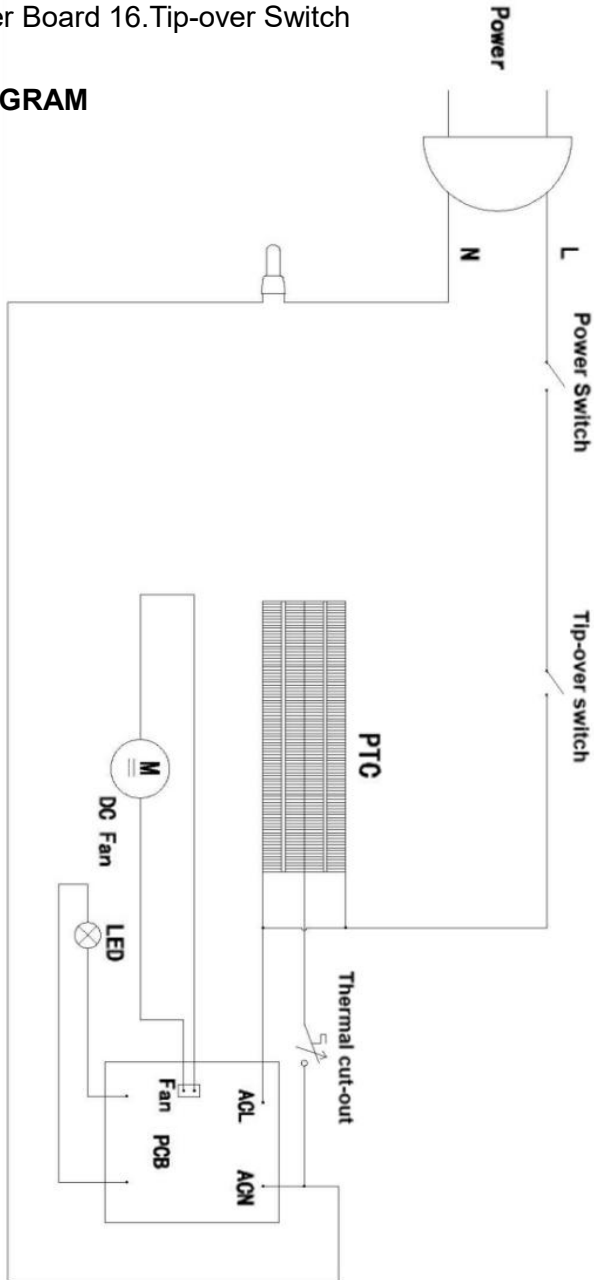

Made In China

VEVOR[®]

TOUGH TOOLS, HALF PRICE

Technical Support and E-Warranty Certificate

www.vevor.com/support