

VEVOR[®]

TOUGH TOOLS, HALF PRICE

Technical Support and E-Warranty Certificate www.vevor.com/support

WHITE BOARD USER MANUAL

MODEL:ZG-BB69

We continue to be committed to provide you tools with competitive price. "Save Half", "Half Price" or any other similar expressions used by us only represents an estimate of savings you might benefit from buying certain tools with us compared to the major top brands and does not necessarily mean to cover all categories of tools offered by us. You are kindly reminded to verify carefully when you are placing an order with us if you are actually saving half in comparison with the top major brands.

VEVOR[®]

TOUGH TOOLS, HALF PRICE

White Board

MODEL:ZG-BB69

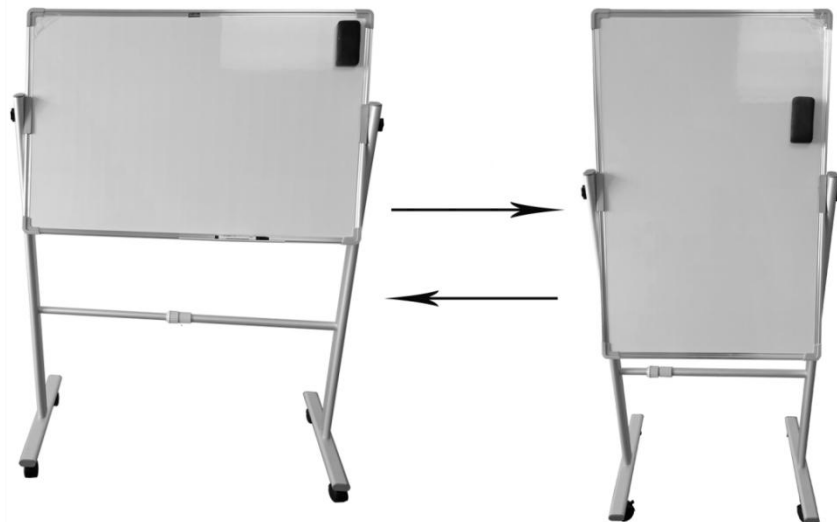

NEED HELP? CONTACT US!

Have product questions? Need technical support? Please feel free to contact us:

Technical Support and E-Warranty Certificate
www.vevor.com/support

This is the original instruction, please read all manual instructions carefully before operating. VEVOR reserves a clear interpretation of our user manual. The appearance of the product shall be subject to the product you received. Please forgive us that we won't inform you again if there are any technology or software updates on our product.

PRODUCT PARAMETERS

Model	ZG-BB69
Installation	Floor Type
Product Size	980*50*1420 mm



WARNING:

Read this manual before using this product. Failure to do so can result in serious injury.

ASSEMBLY PRECAUTIONS

1. Assemble needs to follow these instructions. Incorrect assembly can be a hazard.
2. Wear safety goggles and heavy-duty work gloves during assembly.
3. Do not assemble when tired or when under the influence of alcohol, drugs or medication.
4. Weight capacity and other product capabilities apply to a properly and completely assembled product only.
5. Keep the assembly area clean and well-lit.
6. Keep bystanders out of the area during assembly.
7. Assemble on a flat, level, hard and smooth surface capable of safely supporting the white board.

SAVE THESE INSTRUCTIONS.

USE PRECAUTIONS



WARNING: TO PREVENT SERIOUS INJURY AND DEATH FROM TIPPING:

Write down some words, wait to dry (15 seconds or so), and then wipe. When wiping, must use supporting tools, strength to wipe the surface of the board shall prevail.

2. The written words on the day should be wiped clean.
3. Clean the tool with water when it is dirty, and then continue to use it after it is dry.
4. Do not use hard objects to knock, hit, scratch the writing board, to ensure normal writing.
5. Use as intended only. Do not sit or stand on the product.
6. Inspect before every use. Do not use it if parts are loose or damaged.
7. Use on flat, level, and hard surfaces only.

PARTS LIST



ASSEMBLY STEPS

Thanks for purchasing one of our products, please read the assembly steps carefully before installation

STEP 1



STEP 2

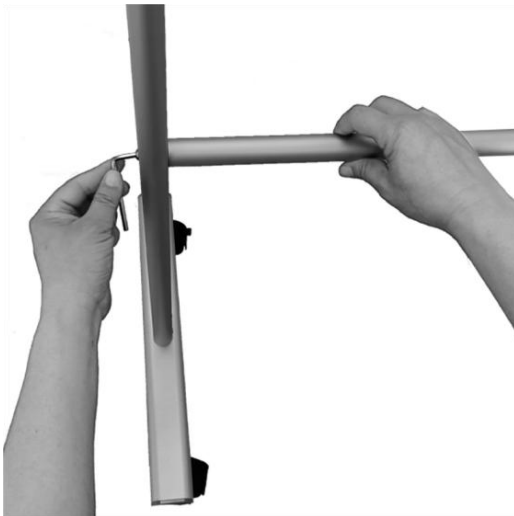

STEP 3

**Screws are installed on the back
of the whiteboard**

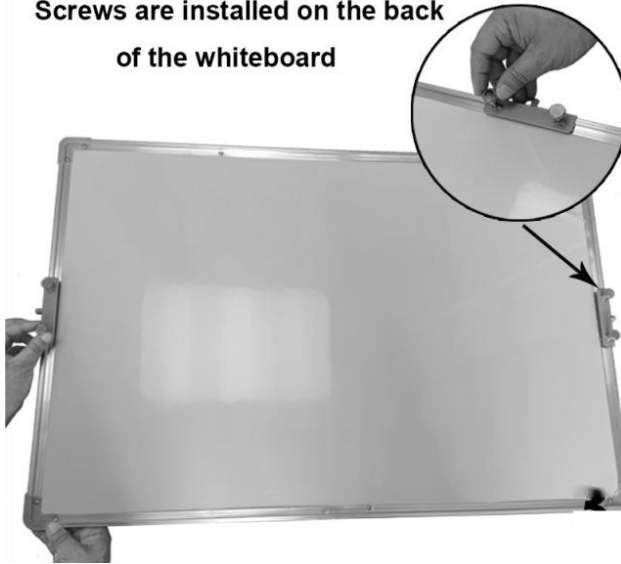

STEP 4

**Loosen the screw to adjust
the Angle of the white board**

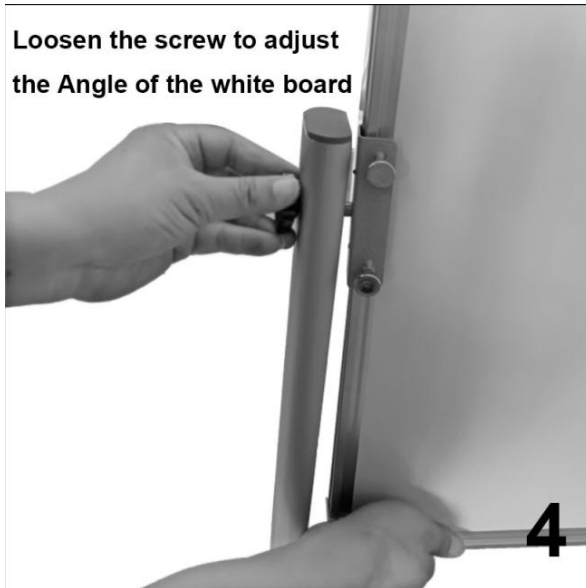

COMPLETION

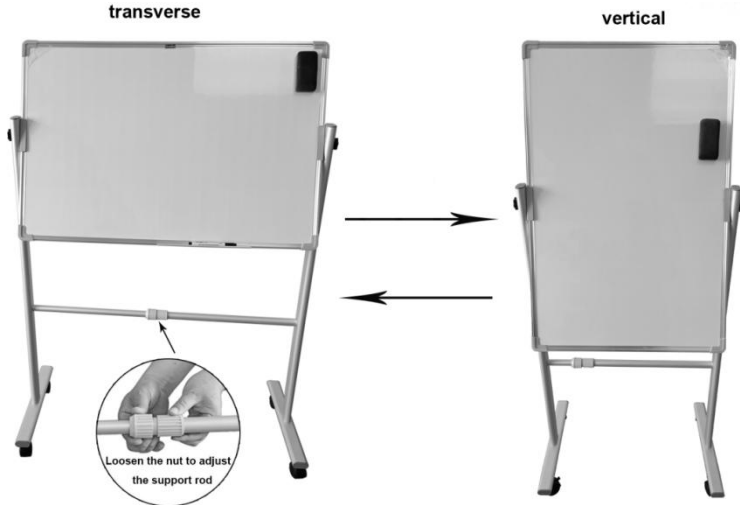

Manufacturer: Shanghai muxinmuyeyouxiangongsi

Address: Shuangchenglu 803nong11hao1602A-1609shi, baoshanqu, shanghai 200000 CN.

Imported to AUS: SIHAO PTY LTD. 1 ROKEVA STREET EASTWOOD NSW 2122 Australia

Imported to USA: Sanven Technology Ltd. Suite 250, 9166 Anaheim Place, Rancho Cucamonga. CA 91730

EC	REP
-----------	------------

E-CrossStu GmbH
Mainzer Landstr.69, 60329 Frankfurt am Main.

UK	REP
-----------	------------

YH CONSULTING LIMITED.
C/O YH Consulting Limited Office 147, Centurion House, London Road, Staines-upon-Thames, Surrey, TW18 4AX

Made In China

VEVOR[®]

TOUGH TOOLS, HALF PRICE

Support and E-Warranty Certificate

<https://www.vevor.com/support>