

VEVOR[®]

TOUGH TOOLS, HALF PRICE

Technical Support and E-Warranty Certificate

www.vevor.com/support

MOBILE BASE

MODEL: GZB88096

We continue to be committed to provide you tools with competitive price.

"Save Half", "Half Price" or any other similar expressions used by us only represents an estimate of savings you might benefit from buying certain tools with us compared to the major top brands and does not necessarily mean to cover all categories of tools offered by us. You are kindly reminded to verify carefully when you are placing an order with us if you are actually saving half in comparison with the top major brands.

VEVOR[®]

TOUGH TOOLS, HALF PRICE

MOBILE BASE

MODEL: GZB88096

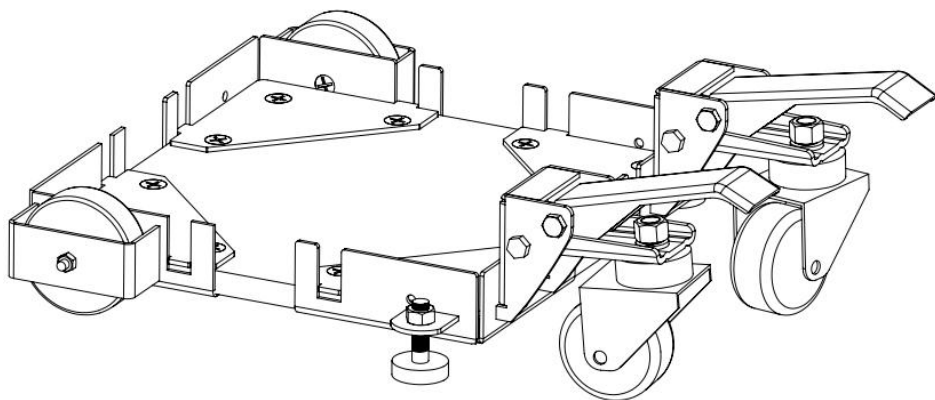

NEED HELP? CONTACT US!

Have product questions? Need technical support? Please feel free to contact us:

Technical Support and E-Warranty Certificate
www.vevor.com/support

This is the original instruction, please read all manual instructions carefully before operating. VEVOR reserves a clear interpretation of our user manual. The appearance of the product shall be subject to the product you received. Please forgive us that we won't inform you again if there are any technology or software updates on our product.

SAFETY INSTRUCTIONS



WARNING: Read and understand this manual before assembling, installing, operating, or servicing this product. Failure to follow these warnings and instructions can cause death, personal injury or damage to valuable property.

1. While assembling and using this product, keep the work area clean and well-lighted, and keep spectators and children out of the work area.
2. Wear ANSI-approved safety goggles and heavy-duty work gloves during use.

A blue circular icon showing a white silhouette of a person's head and shoulders wearing safety goggles.	Warning- Be sure to wear eye protectors when using this product.
A blue circular icon showing a white silhouette of a hand wearing a heavy-duty work glove.	Warning- Be sure to wear gloves when using this product.

3. Please do not put it near flammable materials.
4. It is forbidden to carry people under any condition.
5. This product cannot be used to go up or down stairs.
6. Overload is strictly prohibited.
7. Don't move too fast when passing pothole areas.
8. Electric tools are required for installation. Please pay attention to safe operation.

SAVE THESE INSTRUCTIONS

MODEL AND PARAMETERS

Material: Alloy Steel

Product size: Minimum 12x12 inches

Load capacity: 400 lbs max.

ASSEMBLY AND USE

1. Get everything ready.

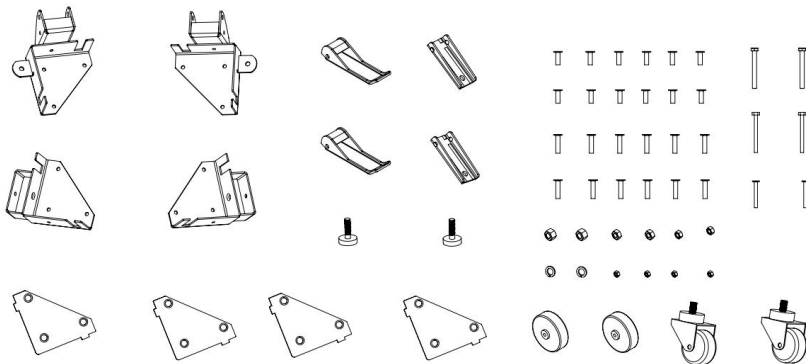

2. Select the appropriate bolts and nuts to secure the wheels.

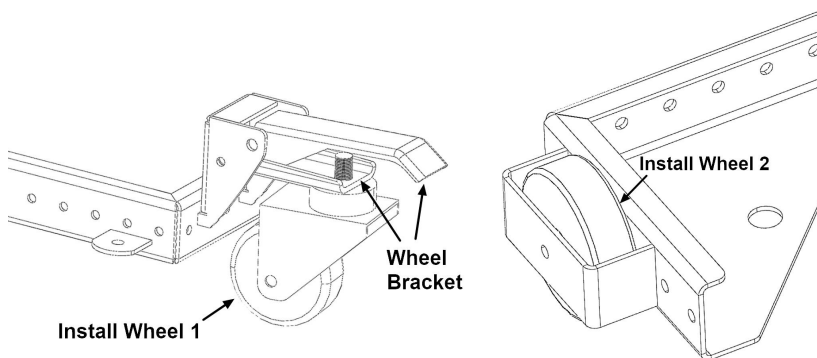

3. Install two support feet.

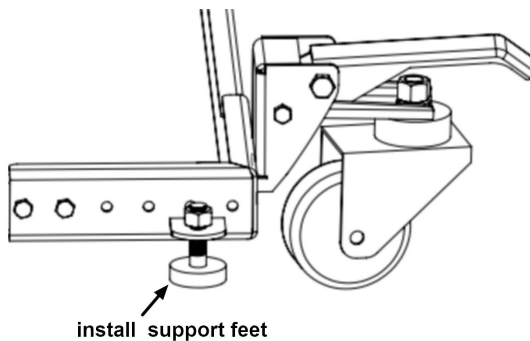

4. Measure the length and width of the object to be carried, and cut a slightly larger plywood board according to this size as the base.



5. Attach the corners to the plywood. Begin by marking the holes using the corner plates as your template.

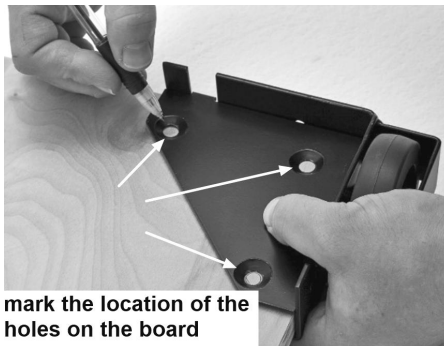

mark the location of the holes on the board

6. Drill the holes using a 1/2 inches drill bit, it is a good idea to check that the holes are lined up to the plate before drilling each hole.

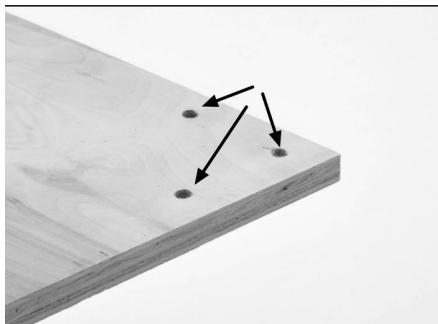

7. Put the fixing plate on the plywood board and screw the plywood board to the mobile base.

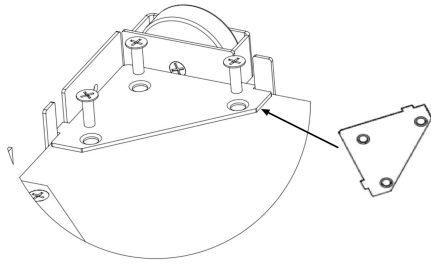

8. Status of the complete installation.

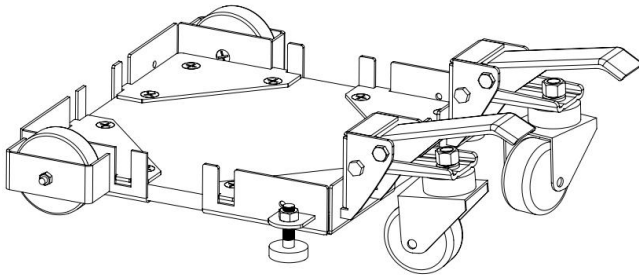

9. Use your feet to move the bracket to the horizontal state to push and pull the object. After moving to the desired position, adjust the bracket to the vertical state again, as shown in the figure below.

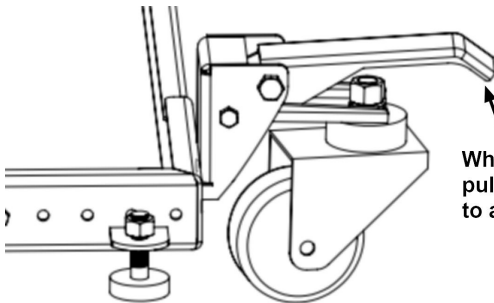

When you need to push and pull objects, adjust the bracket to a horizontal state.

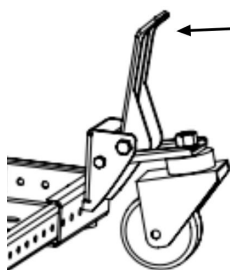

After moving the sample, readjust the stand to the vertical position.

10. Adjust the mobile base to be level by rotating the supporting feet.

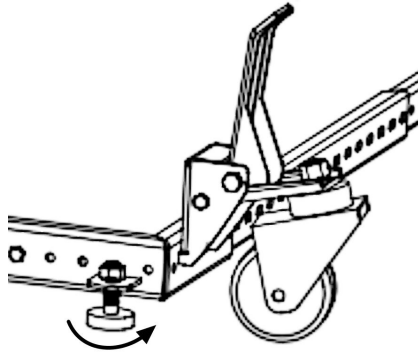

MAINTENANCE

1. Avoid prolonged exposure to the sun to avoid aging.
2. Inspect accessories for wear, cracks and other damage before use, and replace defective accessories immediately.

Manufacturer: Shanghai muxinmuyeyouxiangongsi

Address: Shuangchenglu 803nong11hao1602A-1609shi, baoshanqu, shanghai 200000 CN.

Imported to AUS: SIHAO PTY LTD, 1 ROKEVA STREET EASTWOOD NSW 2122 Australia

Imported to USA: Sanven Technology Ltd, Suite 250, 9166 Anaheim Place, Rancho Cucamonga, CA 91730

EC	REP
----	-----

E-CrossStu GmbH
Mainzer Landstr.69, 60329 Frankfurt am Main.

UK	REP
----	-----

YH CONSULTING LIMITED.
C/O YH Consulting Limited Office 147, Centurion House,
London Road, Staines-upon-Thames, Surrey, TW18 4AX

VEVOR[®]

TOUGH TOOLS, HALF PRICE

Technical Support and E-Warranty Certificate

www.vevor.com/support