

VEVOR[®]

TOUGH TOOLS, HALF PRICE

Technical Support and E-Warranty Certificate

www.vevor.com/support

BRAKE/CLUTCH BLEEDER SET

MODEL:BC-105

We continue to be committed to provide you tools with competitive price.

"Save Half", "Half Price" or any other similar expressions used by us only represents an estimate of savings you might benefit from buying certain tools with us compared to the major top brands and does not necessarily mean to cover all categories of tools offered by us. You are kindly reminded to verify carefully when you are placing an order with us if you are actually saving half in comparison with the top major brands.

VEVOR®
TOUGH TOOLS, HALF PRICE

BRAKE/CLUTCH BLEEDER SET

MODEL:BC-105



NEED HELP? CONTACT US!

Have product questions? Need technical support? Please feel free to contact us:

Technical Support and E-Warranty Certificate
www.vevor.com/support

This is the original instruction, please read all manual instructions carefully before operating. VEVOR reserves a clear interpretation of our user manual. The appearance of the product shall be subject to the product you received. Please forgive us that we won't inform you again if there are any technology or software updates on our product.

PARAMETER LIST

Model	BC-105
Pressure range	10-40psi
Capacity	5L
net weight(kg)	7.5

Save this manual

You will need manual for the safety warnings and precautions , assembly instructions, operating and maintenance procedures , parts list and diagram, keep your invoice with this manual .write the invoice number on the inside of the front cover. Keep the manual and invoice in a safe and dry place for future reference.

Safety warnings and precautions

Warning : when using tool ,basic safety precautions should always be followed to reduce the risk of personal injury and damage to equipment. Read all instructions before using this tool!

1. Keep work area clean .cluttered areas invite injuries.
2. Observe work area condition. Do not use machines or power tools in damp or wet locations. Don't expose to rain. Keep work area well lighted. Do not use electrically powered tools in the presence of flammable gases or liquids.
3. Keep children away. Children must never be allowed in the work area. Do not let them handle machines, tools or extension cords.
4. Store idle equipment. When not in use ,tools must be stored in a dry location to inhibit rust. Always lock up tools and keep out of reach of children.
5. Use the right tool for the job. Do not attempt to force a small tool or attachment to do the work of a larger industrial tool. There are certain applications for which this tool was designed. It will do the job better and more safely at the rate for which it was intended. Do

- not modify this tool and do not use this tool for a purpose for which it was not intended.
6. Dress properly. Do not wear loose clothing or jewelry as they can be caught in moving parts. Protective, electrically non-conductive clothes and non-skid footwear are recommended when working. Wear restrictive hair covering to contain long hair.
 7. Use eye and ear protection. Always wear ANSL approved impact safety goggles.
 8. Do not overreach. Keep proper footing and balance at all times, do not reach over or across running machines.
 9. Maintain tools with care. Inspect tool cords and hoses periodically and, if damaged, have them replaced, or repaired by an authorized technician. The handles must be kept clean, dry, and free from oil and grease at all times.
 10. Remove adjusting keys and wrenches. Check that keys and adjusting wrenches are removed from the tool or machine work surface before operating.
 11. Avoid unintentional starting. Be sure the air pressure is in the off position when not in use and before making hose connections.
 12. Stay alert. Watch what you are doing, use common sense. Do not operate any tool when you are tired.
 13. Check for damaged parts. Before using any tool, any part that appears damaged should be carefully checked to determine that it will operate properly and perform its intended function. Check for alignment and binding of moving parts; any broken parts or mounting fixtures; and any other condition that may affect proper operation any part that is damaged should be properly repaired or replaced by a qualified technician. Do not use the tool if any control or switch does operate properly.
 14. Replacement parts and accessories. When servicing, use only identical replacement parts. Use of any other parts will void the warranty. Only use accessories intended for use with this tool. Approved accessories are available from Harbor Freight Tools.
 15. Do not operate tool if under the influence of alcohol or drugs. Read warning labels if taking prescription medicine to determine if your judgment or reflexes are impaired while taking drugs. If there is any doubt, do not operate the tool.
 16. Pacemaker safety warning. People with pacemakers should consult their physician(s) before using this produce. Electromagnetic fields in close proximity to a heart pacemaker could cause interference to, or failure of the pacemaker. In addition, people with pacemakers should adhere to the following:
-caution is necessary when near the coil, spark plug cables, or distributor of a running engine. the engine should always be off if adjustments are to be made to the distributor.
 17. maintenance. for your safety, service and maintenance should be performed regularly by a qualified technician.

Note: performance of this tool may vary depending on variations in air pressure and compressor capability.

Brake fluid exchanger safety precautions

Caution: this equipment is designed to be operated by qualified and trained personnel. It should only be operated after reading and understanding the safety warnings and operating procedures in this instruction manual and vehicle's service manual.

1. Wear safety goggles.
2. Do not smoke near this equipment.
3. Use in a well ventilated area.
4. When leaks are found in the equipment or hoses, immediately turn the air pressure off and repair the leaks.
5. Immediately clean up any fluid spills or leaks.
6. Do not exceed the recommended operating air pressure. This could damage equipment. See specifications on page 2.
7. Do not use any cleaning compounds in this system.
8. Keep an empty plastic bucket nearby in case of fires
9. Keep a type ABC fire extinguisher nearby in case of leaks.
10. Prior to using the brake fluid exchanger, make sure to read and understand all warnings, safety precautions, and instructions as outlined in the vehicle manufacturer's service manual. Every vehicle has specific brake bleeding requirements. It is beyond the scope of this manual to

properly describe the correct procedure for each vehicle.

11. Prior to using the Break Fluid Exchanger, make sure to place the vehicle's transmission in "PARK" (if automatic) or "NEUTRAL" (if manual), then, set the emergency parking brake and block the tires with chocks.

12. Use the Break Fluid Exchanger only with brake fluid. Do not attempt to use the tool to siphon any other liquids. Contamination of brake fluid and possible brake system failure may result.

13. follow guidelines for proper brake fluid disposal. Used brake fluid should be properly disposed of or recycled. many states require recycling. Contact your local solid/liquid waster authority for information on recycling. do not reuse old brake fluid.

14. do not use pressurized air to blow off brake dust. Only use brake parts cleaner to clean dust off of the brake calipers.

15. be alert for hot brake components and other hot vehicle components to avoid accidental burns.

16. some brake pads contain asbestos. Asbestosis, a chronic lung inflammation, can result from prolonged inhalation of asbestos particles. Accordingly, wear appropriate respiratory devices and proper protective clothing when working near any brake pads.

17. always keep brake fluid from contacting the vehicle's paint finish. Brake fluid will damage the paint finish on vehicles.

Warning: the warnings, cautions, and instructions discussed in this instruction manual cannot cover all possible conditions and situations that may occur, it must be understood by the operator that common sense and caution are factors which cannot be built into this product, but must be supplied by the operator.

Unpacking

When unpacking, check to make sure the following parts are included. If any parts are missing or broken, please call Cannon Tools at the number on the cover of this manual as soon as possible.

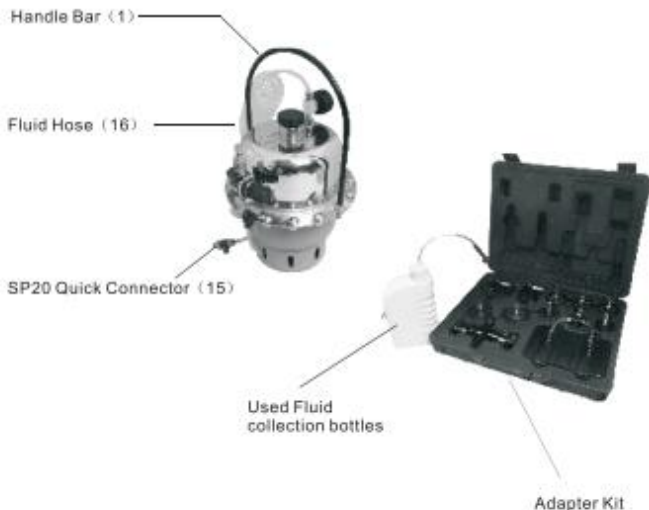

Operation

Preparation

1. Place vehicle on a hoist or on secure vehicle stands in a well ventilated area.
2. set vehicle emergency brake and turn engine off.
3. remove the wheels and locate the drain connection on the brake cylinders. Refer to the vehicle manufacturer's maintenance manual for their location.
4. turn on the air compressor (not supplied) and place its hose next to the Break Fluid Exchanger (the air compressor should have a moisture filter installed on it. See illustration on the top of page 6.)

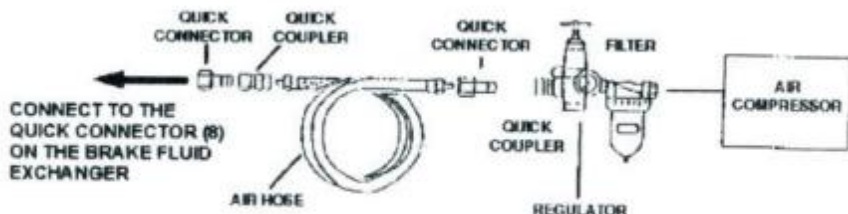

Controls and Indicators



Bleeding brakes and adding new fluid

Warning: the vehicle engine must never be started in a closed garage, or any other sealed structure. Carbon monoxide is produced during operation and is deadly in a closed environment. Early signs of carbon monoxide poisoning resemble the flu, with headaches, dizziness, or nausea..if you have any of these signs get fresh air immediately.

1. Place the Brake Fluid Exchanger near the vehicle and remove the Tank Cap(2)
2. Open and secure the engine hood and find the Master Cylinder.
3. Remove the Master Cylinder Lid.
4. Open the Adapter Kit and find the Adapter Lid that looks like, and best fits, the Master Cylinder.

Refer to the Adapter Kit Parts List at the end of this manual. The temporary Adapter Lid should have the from of the Master Cylinder Lid with the addition of a connector inlet for the Fluid Hose(16).In some instances, a universal Lid (E1,F1,or F2) may need to be used where other Adapters will not fit. Use the mounting loop cables and hardware provided with the

Adapter to secure the universal Lid.

5. Secure the Adapter Lid to the Master Cylinder.

6. Unscrew and remove the Tank Cap(2), then pour in the appropriate amount of new brake fluid. Refer to the vehicle manufacturer's service manual for the correct amount and type of fluid. Screw in the Tank Cap(2) tightly.

7. Insert the Fluid Hose(16) Quick Connector(15) onto the temporary Master Cylinder Adapter Lid. Make sure that's Ball valve(9) is in the closed position (sideways to the direction of the Fluid Hose).

8. Remove the Drain Screws from the rear brake cylinder, and insert clear rubber tube(not supplied) in to the drain holes. Press fit the rubber connector of the Used Fluid Bottles into the other end of the clear rubber tube

Note: The Used Fluid Bottles can be connected directly to the brake cylinders drain, but you will not be able to see the color of the fluid the bottles(darker is old, lighter is new).

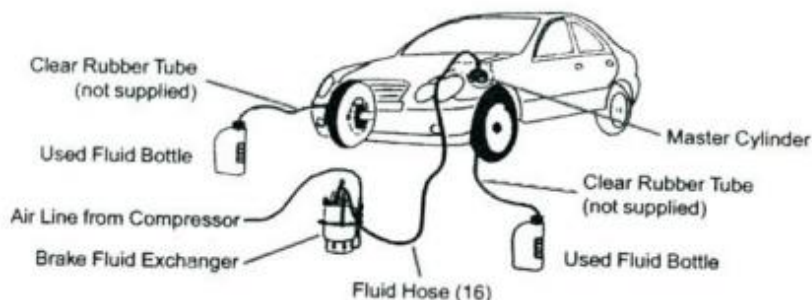

9. Connect the air line hose(not supplied) to the Air Hose Quick Connector (8) on the Brake Fluid Exchanger.

10. Set the Air Connector Ball Valve(9) to the ON(vertical) position.

11. Pull out on the Pressure Adjust Valve(10) knob, and while viewing the Pressure Gauge(19), turn the knob to adjust the Tank pressure to between 20 to 40 PSI

Caution: Never exceed 40 PSI or damage may occur to equipment and connection hoses.

12. Slowly open (in line with hose) the Fluid Hose (16) Ball Valve (9) on top of the Master Cylinder.

This begins the process of forcing the new fluid in, and while old fluid out and into the Used Fluid Bottles. Check for leaks at all connection Points. If leaks and continue.

13. During the fluid transfer, press in quickly on the brake pedal in the vehicle, and release slowly do this a few times.

14. When the Used Fluid Bottles are full, or the fluid color has changed from dark to light as seen through

15. Remove the Used Fluid Bottles or Clear Rubber Tubes connected to the brake cylinder and return screws to the drain holes.

16. Empty the Used Fluid Bottles into a fluid recycle tank, or in other bottles for proper disposal.

17. Repeat steps 8 through 15 the front brake cylinders.

18. When the fluid transfer of the front brake cylinders is complete, turn the Ball Valve(9) on the Master Cylinder to the Off(sideways) position, and remove the Fluid Hose(16) from the Master Cylinder lid.

Adding New Fluid to Vehicles with ABS Brake Systems

1. Follow all the previous steps, with these exceptions.

2. Remove the drain screw for only on the brake cylinder at a time, and drain that brake cylinder.

3. Place the vehicle transmission in Park, and start the engine during this process. When adding new fluid is complete, turn the engine off.

4. Remove the Used fluid bottle or Clear Rubber Tube connected to that brake cylinder and

return screw to the drain hole.
5.Repeat for each brake cylinder individually.

Steps When Finished Bleeding Brakes and Adding New Fluid

1. Replace the original Master Cylinder lid.
2. Remove the air input line from Air hose Quick Connector(8)on the Tank.
3. Open the Air release Ball Valve(9) on the Tank, and pull on the Air Release Safety Valve(12) to depressurize the Tank.
4. Empty the Used Fluid Bottles into a fluid recycle tank, or in other bottles for proper disposal.

WARNING: Before driving the vehicle, depress the brake pedal repeatedly until the brake pedal feels firm. Check the brake calipers for leaks. Then, test the brakes thoroughly at slow speed before operating the vehicle under normal conditions.

Maintenance

Caution: Before performing any maintenance on the Brake Fluid Exchanger, verify that the Brake Fluid Exchanger is depressurized.

1. Clean up any brake fluid oil that may have spilled.
2. Wipe down the Brake Fluid Exchanger components with a cloth.
3. Store the unit in a clean and dry location.

Brake fluid Exchanger Parts List

1	Handle Bar	1	10	Connector	2
2	Cap, Tank	1	11	Valve, Safety, Air Release	1
3	Tank , Upper Half	1	12	Connector	1
4	Rubber Membrane	1	13	Tube	1
5	Tank, lower Half	1	14	Connector, Quick Fluid	1
6	Connector, PL802L	1	15	Hose, Fluid	1
7	Connector, Quick	1	16	Coupler	1
8	Valve, Ball, 1/4"	3	17	Gauge, Pressure	1
9	Valve, Pressure Adjust	1	18	Coupler, Pressure Gauge	1

NOTE: Some parts are listed and shown for illustration purposes only and are not available individually as replacement parts.

Brake Fluid Exchanger Assembly Drawing

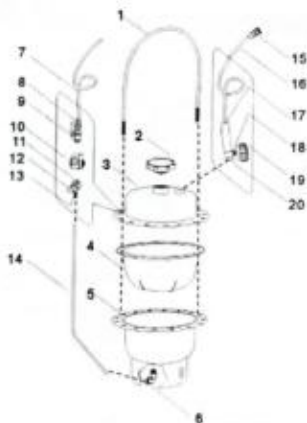

Adapter Kit Parts List

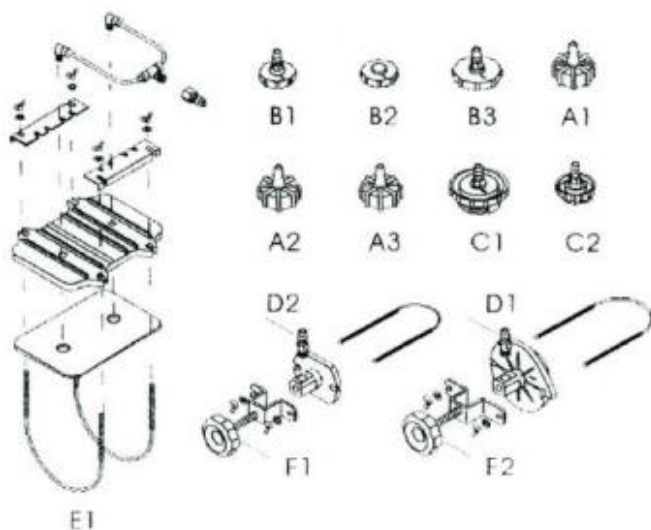

PLEASE READ THE FOLLOWING CAREFULLY

THE MANUFACTURER AND/OR DISTRIBUTOR HAS PROVIDED THE PARTS DIAGRAM IN THIS MANUAL AS A REFERENCE TOOL ONLY. NEITHER THE MANUFACTURER NOR DISTRIBUTOR MAKES ANY REPRESENTATION OR WARRANTY OF ANY KIND TO THE BUYER THAT HE OR SHE IS QUALIFIED TO MAKE ANY REPAIRS TO THE PRODUCT OR THAT HE OR SHE IS QUALIFIED TO REPLACE ANY PARTS OF THE PRODUCT. IN FACT, THE MANUFACTURER AND/OR DISTRIBUTOR EXPRESSLY STATES THAT ALL REPAIRS AND PARTS REPLACEMENTS SHOULD BE UNDERTAKEN BY CERTIFIED AND LICENSED TECHNICIANS AND NOT BY THE BUYER. THE BUYER ASSUMES ALL RISK AND LIABILITY ARISING OUT OF HIS OR HER REPAIRS TO THE ORIGINAL PRODUCT OR REPLACEMENT PARTS THERE TO, OR ARISING OUT OF HIS OR HER INSTALLATION OF REPLACEMENT PARTS THERE TO.

Manufacturer: Shanghai muxin mu yeyou xiangong si

Address: Shuangchenglu 803nong11hao1602A-1609shi, baoshanqu, shanghai 200000 CN.

Imported to AUS: SIHAO PTY LTD. 1 ROKEVA STREETEASTWOOD NSW 2122 Australia

Imported to USA: Sanven Technology Ltd. Suite 250, 9166 Anaheim Place, Rancho Cucamonga, CA 91730

UK	REP	YH CONSULTING LIMITED. C/O YH Consulting Limited Office 147, Centurion House, London Road, Staines-upon-Thames, Surrey, TW18 4AX
EC	REP	E-CrossStu GmbH Mainzer Landstr.69, 60329 Frankfurt am Main.



Technical Support and E-Warranty Certificate
www.vevor.com/support



Assistance technique et certificat de garantie

électronique www.vevor.com/support

KIT DE PURGE DE FREIN/EMBRAYAGE

MODÈLE : BC-105

Nous continuons à nous engager à vous fournir des outils à des prix compétitifs.

« Économisez la moitié », « Moitié prix » ou toute autre expression similaire utilisée par nous ne représente qu'une estimation des économies que vous pourriez réaliser en achetant certains outils chez nous par rapport aux grandes marques et ne couvre pas nécessairement toutes les catégories d'outils que nous proposons.

Nous vous rappelons de bien vouloir vérifier soigneusement lorsque vous passez une commande chez nous si vous économisez réellement la moitié par rapport aux grandes marques.

VEVOR®
TOUGH TOOLS, HALF PRICE

FREIN/EMBRAYAGE

ENSEMBLE DE PURGE

MODÈLE : BC-105



BESOIN D'AIDE? CONTACTEZ-NOUS!

Vous avez des questions sur nos produits ? Vous avez besoin d'assistance technique ?
N'hésitez pas

à nous contacter : Assistance technique et certificat de garantie
électronique www.vevor.com/support

Il s'agit de la notice d'utilisation d'origine. Veuillez lire attentivement toutes les instructions du manuel avant de l'utiliser. VEVOR se réserve le droit d'interpréter clairement notre manuel d'utilisation. L'apparence du produit dépend du produit que vous avez reçu. Veuillez nous excuser, nous ne vous informerons plus si des mises à jour technologiques ou logicielles sont disponibles sur notre produit.

LISTE DES PARAMÈTRES

Modèle	BC-105
Plage de pression	10 à 40 psi
Capacité	5L
poids net (kg)	7.5

Save this manual

You will need manual for the safety warnings and precautions , assembly instructions, operating and maintenance procedures , parts list and diagram, keep your invoice with this manual .write the invoice number on the inside of the front cover. Keep the manual and invoice in a safe and dry place for future reference.

Safety warnings and precautions

Warning : when using tool ,basic safety precautions should always be followed to reduce the risk of personal injury and damage to equipment. Read all instructions before using this tool!

1. Keep work area clean .cluttered areas invite injuries.
2. Observe work area condition. Do not use machines or power tools in damp or wet locations. Don't expose to rain. Keep work area well lighted. Do not use electrically powered tools in the presence of flammable gases or liquids.
3. Keep children away. Children must never be allowed in the work area. Do not let them handle machines, tools or extension cords.
4. Store idle equipment. When not in use ,tools must be stored in a dry location to inhibit rust. Always lock up tools and keep out of reach of children.
5. Use the right tool for the job. Do not attempt to force a small tool or attachment to do the work of a larger industrial tool. There are certain applications for which this tool was designed. It will do the job better and more safely at the rate for which it was intended. Do

- not modify this tool and do not use this tool for a purpose for which it was not intended.
6. Dress properly. Do not wear loose clothing or jewelry as they can be caught in moving parts. Protective, electrically non-conductive clothes and non-skid footwear are recommended when working. Wear restrictive hair covering to contain long hair.
7. Use eye and ear protection. Always wear ANSL approved impact safety goggles.
8. Do not overreach. Keep proper footing and balance at all times, do not reach over or across running machines.
9. Maintain tools with care. Inspect tool cords and hoses periodically and, if damaged, have them replaced, or repaired by an authorized technician. The handles must be kept clean, dry, and free from oil and grease at all times.
10. Remove adjusting keys and wrenches. Check that keys and adjusting wrenches are removed from the tool or machine work surface before operating.
11. Avoid unintentional starting. Be sure the air pressure is in the off position when not in use and before making hose connections.
12. Stay alert. Watch what you are doing, use common sense. Do not operate any tool when you are tired.
13. Check for damaged parts. Before using any tool, any part that appears damaged should be carefully checked to determine that it will operate properly and perform its intended function. Check for alignment and binding of moving parts; any broken parts or mounting fixtures; and any other condition that may affect proper operation any part that is damaged should be properly repaired or replaced by a qualified technician. Do not use the tool if any control or switch does operate properly.
14. Replacement parts and accessories. When servicing, use only identical replacement parts. Use of any other parts will void the warranty. Only use accessories intended for use with this tool. Approved accessories are available from Harbor Freight Tools.
15. Do not operate tool if under the influence of alcohol or drugs. Read warning labels if taking prescription medicine to determine if your judgment or reflexes are impaired while taking drugs. If there is any doubt, do not operate the tool.
16. Pacemaker safety warning. People with pacemakers should consult their physician(s) before using this product. Electromagnetic fields in close proximity to a heart pacemaker could cause interference to, or failure of the pacemaker. In addition, people with pacemakers should adhere to the following:
 - caution is necessary when near the coil, spark plug cables, or distributor of a running engine. the engine should always be off if adjustments are to be made to the distributor.
17. maintenance. for your safety, service and maintenance should be performed regularly by a qualified technician.

Note: performance of this tool may vary depending on variations in air pressure and compressor capability.

Brake fluid exchanger safety precautions

Caution: this equipment is designed to be operated by qualified and trained personnel. It should only be operated after reading and understanding the safety warnings and operating procedures in this instruction manual and vehicle's service manual.

1. Wear safety goggles.
2. Do not smoke near this equipment.
3. Use in a well ventilated area.
4. When leaks are found in the equipment or hoses, immediately turn the air pressure off and repair the leaks.
5. Immediately clean up any fluid spills or leaks.
6. Do not exceed the recommended operating air pressure. This could damage equipment. See specifications on page 2.
7. Do not use any cleaning compounds in this system.
8. Keep an empty plastic bucket nearby in case of fires
9. Keep a type ABC fire extinguisher nearby in case of leaks.
10. Prior to using the brake fluid exchanger, make sure to read and understand all warnings, safety precautions, and instructions as outlined in the vehicle manufacturer's service manual. Every vehicle has specific brake bleeding requirements. It is beyond the scope of this manual to

properly describe the correct procedure for each vehicle.

11. Prior to using the Break Fluid Exchanger, make sure to place the vehicle's transmission in "PARK" (if automatic) or "NEUTRAL" (if manual), then, set the emergency parking brake and block the tires with chocks. }

12. Use the Break Fluid Exchanger only with brake fluid. Do not attempt to use the tool to siphon any other liquids. Contamination of brake fluid and possible break system failure may result.

13. follow guidelines for proper brake fluid disposal. Used brake fluid should be properly disposed of or recycled. many states require recycling. Contact your local solid/liquid waster authority for information on recycling. do not reuse old brake fluid.

14. do not use pressurized air to blow off brake dust. Only use brake parts cleaner to clean dust off of the brake calipers.

15. be alert for hot brake components and other hot vehicle components to avoid accidental burns.

16. some brake pads contain asbestos. Asbestosis, a chronic lung inflammation, can result from prolonged inhalation of asbestos particles. Accordingly, wear appropriate respiratory devices and proper protective clothing when working near any break pads.

17. always keep brake fluid from contacting the vehicle's paint finish. Brake fluid will damage the paint finish on vehicles.

Warning: the warnings, cautions, and instructions discussed in this instruction manual cannot cover all possible conditions and situations that may occur , it must be under-stood by the operator that common sense and caution are factors which cannot be built into this product ,but must be supplied by the operator.

Unpacking

When unpacking, check to make sure the following parts are included. If any parts are missing or broken ,please call Cannon Tools at the number on the cover of this manual as soon as possible.

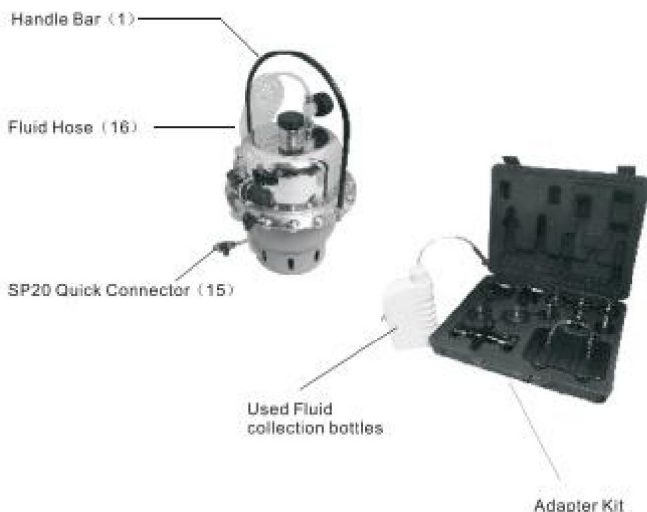

Operation

Preparation

1. Place vehicle on a hoist or on secure vehicle stands in a well ventilated area.
2. set vehicle emergency brake and turn engine off.
3. remove the wheels and locate the drain connection on the brake cylinders. Refer to the vehicle manufacturer's maintenance manual for their location.
4. turn on the air compressor (not supplied) and place its hose next to the Break Fluid Exchanger (the air compressor should have a moisture filter installed on it. See illustration on the top of page 6.)

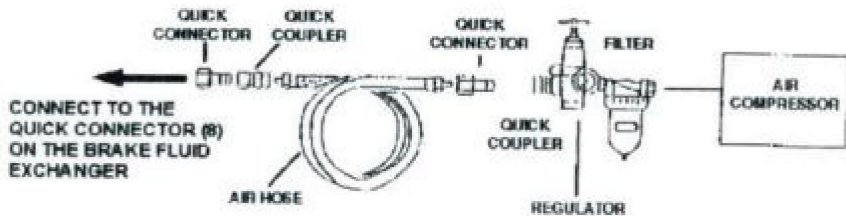

Controls and Indicators

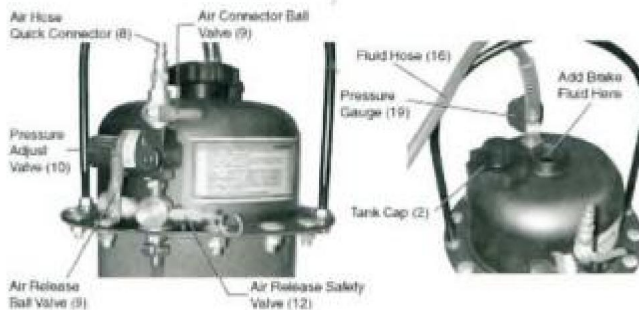

Bleeding brakes and adding new fluid

Warning: the vehicle engine must never be started in a closed garage, or any other sealed structure. Carbon monoxide is produced during operation and is deadly in a closed environment. Early signs of carbon monoxide poisoning resemble the flu, with headaches, dizziness, or nausea..if you have any of these signs get fresh air immediately.

1. Place the Brake Fluid Exchanger near the vehicle and remove the Tank Cap(2)
2. Open and secure the engine hood and find the Master Cylinder.
3. Remove the Master Cylinder Lid.
4. Open the Adapter Kit and find the Adapter Lid that looks like, and best fits, the Master Cylinder.

Refer to the Adapter Kit Parts List at the end of this manual. The temporary Adapter Lid should have the from of the Master Cylinder Lid with the addition of a connector inlet for the Fluid Hose(16).In some instances, a universal Lid (E1,F1,or F2) may need to be used where other Adapters will not fit. Use the mounting loop cables and hardware provided with the

Adapter to secure the universal Lid.

5. Secure the Adapter Lid to the Master Cylinder.

6. Unscrew and remove the Tank Cap(2), then pour in the appropriate amount of new brake fluid. Refer to the vehicle manufacturer's service manual for the correct amount and type of fluid. Screw in the Tank Cap(2) tightly.

7. Insert the Fluid Hose(16) Quick Connector(15) onto the temporary Master Cylinder Adapter Lid. Make sure that's Ball valve(9) is in the closed position (sideways to the direction of the Fluid Hose).

8. Remove the Drain Screws from the rear brake cylinder, and insert clear rubber tube(not supplied) in to the drain holes. Press fit the rubber connector of the Used Fluid Bottles into the other end of the clear rubber tube

Note: The Used Fluid Bottles can be connected directly to the brake cylinders drain, but you will not be able to see the color of the fluid the bottles (darker is old, lighter is new).

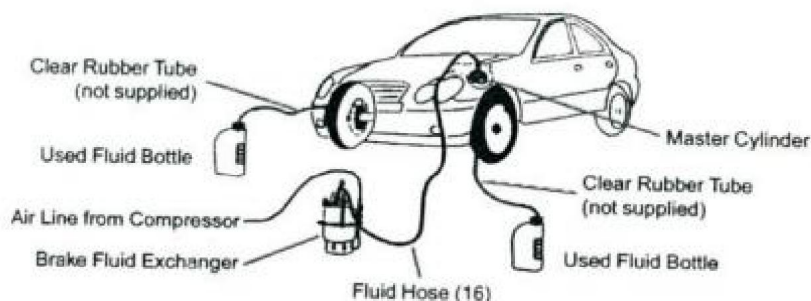

9. Connect the air line hose(not supplied) to the Air Hose Quick Connector (8) on the Brake Fluid Exchanger.

10. Set the Air Connector Ball Valve(9) to the ON(vertical) position.

11. Pull out on the Pressure Adjust Valve(10) knob, and while viewing the Pressure Gauge(19), turn the knob to adjust the Tank pressure to between 20 to 40 PSI

Caution: Never exceed 40 PSI or damage may occur to equipment and connection hoses.

12. Slowly open (in line with hose) the Fluid Hose (16) Ball Valve (9) on top of the Master Cylinder.

This begins the process of forcing the new fluid in, and while old fluid out and into the Used Fluid Bottles. Check for leaks at all connection Points. If leaks and continue.

13. During the fluid transfer, press in quickly on the brake pedal in the vehicle, and release slowly do this a few times.

14. When the Used Fluid Bottles are full, or the fluid color has changed from dark to light as seen through

15. Remove the Used Fluid Bottles or Clear Rubber Tubes connected to the brake cylinder and return screws to the drain holes.

16. Empty the Used Fluid Bottles into a fluid recycle tank, or in other bottles for proper disposal.

17. Repeat steps 8 through 15 the front brake cylinders.

18. When the fluid transfer of the front brake cylinders is complete, turn the Ball Valve(9) on the Master Cylinder to the Off(sideways) position, and remove the Fluid Hose(16) from the Master Cylinder lid.

Adding New Fluid to Vehicles with ABS Brake Systems

1. Follow all the previous steps, with these exceptions.

2. Remove the drain screw for only on the brake cylinder at a time, and drain that brake cylinder.

3. Place the vehicle transmission in Park, and start the engine during this process. When adding new fluid is complete, turn the engine off.

4. Remove the Used fluid bottle or Clear Rubber Tube connected to that brake cylinder and

return screw to the drain hole.
5. Repeat for each brake cylinder individually.

Steps When Finished Bleeding Brakes and Adding New Fluid

1. Replace the original Master Cylinder lid.
2. Remove the air input line from Air hose Quick Connector(8) on the Tank.
3. Open the Air release Ball Valve(9) on the Tank, and pull on the Air Release Safety Valve(12) to depressurize the Tank.
4. Empty the Used Fluid Bottles into a fluid recycle tank, or in other bottles for proper disposal.

WARNING: Before driving the vehicle, depress the brake pedal repeatedly until the brake pedal feels firm. Check the brake calipers for leaks. Then, test the brakes thoroughly at slow speed before operating the vehicle under normal conditions.

Maintenance

Caution: Before performing any maintenance on the Brake Fluid Exchanger, verify that the Brake Fluid Exchanger is depressurized.

1. Clean up any brake fluid oil that may have spilled.
2. Wipe down the Brake Fluid Exchanger components with a cloth.
3. Store the unit in a clean and dry location.

Brake fluid Exchanger Parts List

1	Handle Bar	1	10	Connector	2
2	Cap, Tank	1	11	Valve, Safety, Air Release	1
3	Tank, Upper Half	1	12	Connector	1
4	Rubber Membrane	1	13	Tube	1
5	Tank, lower Half	1	14	Connector, Quick Fluid	1
6	Connector, PL802L	1	15	Hose, Fluid	1
7	Connector, Quick	1	16	Coupler	1
8	Valve, Ball, 1/4"	3	17	Gauge, Pressure	1
9	Valve, Pressure Adjust	1	18	Coupler, Pressure Gauge	1

NOTE: Some parts are listed and shown for illustration purposes only and are not available individually as replacement parts.

Brake Fluid Exchanger Assembly Drawing

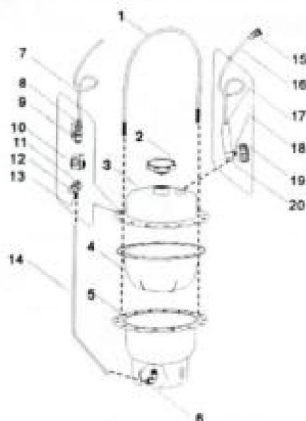

Adapter Kit Parts List

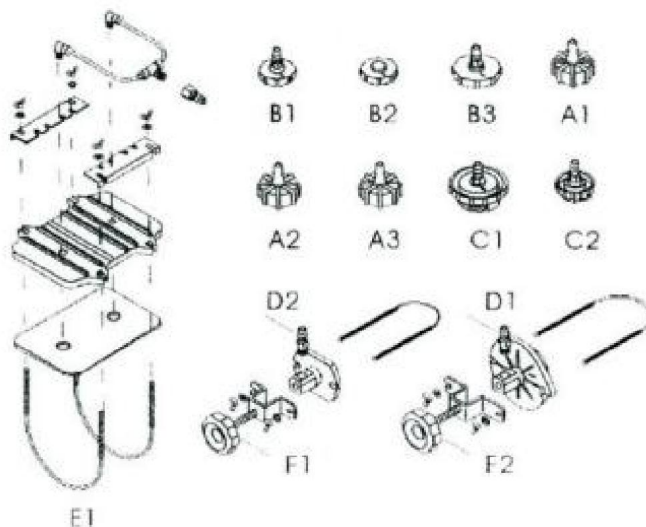

PLEASE READ THE FOLLOWING CAREFULLY

THE MANUFACTURER AND/OR DISTRIBUTOR HAS PROVIDED THE PARTS DIAGRAM IN THIS MANUAL AS A REFERENCE TOOL ONLY. NEITHER THE MANUFACTURER NOR DISTRIBUTOR MAKES ANY REPRESENTATION OR WARRANTY OF ANY KIND TO THE BUYER THAT HE OR SHE IS QUALIFIED TO MAKE ANY REPAIRS TO THE PRODUCT OR THAT HE OR SHE IS QUALIFIED TO REPLACE ANY PARTS OF THE PRODUCT. IN FACT, THE MANUFACTURER AND/OR DISTRIBUTOR EXPRESSLY STATES THAT ALL REPAIRS AND PARTS REPLACEMENTS SHOULD BE UNDERTAKEN BY CERTIFIED AND LICENSED TECHNICIANS AND NOT BY THE BUYER. THE BUYER ASSUMES ALL RISK AND LIABILITY ARISING OUT OF HIS OR HER REPAIRS TO THE ORIGINAL PRODUCT OR REPLACEMENT PARTS THERE TO, OR ARISING OUT OF HIS OR HER INSTALLATION OF REPLACEMENT PARTS THERE TO.

Fabricant : Shanghaimuxinmuyeyouxiangongsi

Adresse : Shuangchenglu 803nong11hao1602A-1609shi, Baoshanqu, Shanghai
200000 CN.

Importé en Australie : SIHAO PTY LTD. 1 ROKEVA STREETEASTWOOD NSW 2122
Australie

Importé aux États-Unis : Sanven Technology Ltd. Suite 250, 9166 Anaheim Place,
Rancho Cucamonga, CA 91730

REPRÉSENTANT	DU ROYAUME-UNI
--------------	----------------

YH CONSULTING LIMITED. C/O YH Consulting Limited
Bureau 147, Centurion House, London Road, Staines-
upon-Thames, Surrey, TW18 4AX

REPRÉSENTANT	DE LA CE
--------------	----------

E-CrossStu GmbH
Mainzer Landstr.69,
60329 Francfort-sur-le-Main.

VEVOR[®]
TOUGH TOOLS, HALF PRICE

Assistance technique et certificat de garantie
électronique www.vevor.com/support



Technischer Support und E-Garantie-Zertifikat
www.vevor.com/support

Bremsen-/Kupplungs-Entlüftungsset

MODELL: BC-105

Wir sind weiterhin bestrebt, Ihnen Werkzeuge zu wettbewerbsfähigen Preisen anzubieten.

„Sparen Sie die Hälfte“, „Halber Preis“ oder andere ähnliche Ausdrücke, die wir verwenden, stellen nur eine Schätzung der Ersparnis dar, die Sie beim Kauf bestimmter Werkzeuge bei uns im Vergleich zu den großen Topmarken erzielen können, und decken nicht unbedingt alle von uns angebotenen Werkzeugkategorien ab. Wir möchten Sie freundlich daran erinnern, bei Ihrer Bestellung bei uns sorgfältig zu prüfen, ob Sie im Vergleich zu den großen Topmarken tatsächlich die Hälfte sparen.

VEVOR®
TOUGH TOOLS, HALF PRICE

**BREMSE/KUPPLUNG
ENTLÜFTUNGSSATZ**

MODELL: BC-105



Brauchen Sie Hilfe? Kontaktieren Sie uns!

Haben Sie Fragen zum Produkt? Benötigen Sie technischen Support? Bitte kontaktieren Sie uns:

Technischer Support und E-Garantie-Zertifikat www.vevor.com/support

Dies ist die Originalanleitung. Bitte lesen Sie alle Anweisungen sorgfältig durch, bevor Sie das Gerät in Betrieb nehmen. VEVOR behält sich eine klare Auslegung unserer Bedienungsanleitung vor. Das Erscheinungsbild des Produkts richtet sich nach dem Produkt, das Sie erhalten haben. Bitte verzeihen Sie uns, dass wir Sie nicht erneut informieren, wenn es Technologie- oder Software-Updates für unser Produkt gibt.

PARAMETERLISTE

Modell	BC-105
Druckbereich	10 bis 40 psi
Kapazität	5 Liter
Nettogewicht (kg)	7.5

Save this manual

You will need manual for the safety warnings and precautions , assembly instructions, operating and maintenance procedures , parts list and diagram, keep your invoice with this manual .write the invoice number on the inside of the front cover. Keep the manual and invoice in a safe and dry place for future reference.

Safety warnings and precautions

Warning : when using tool ,basic safety precautions should always be followed to reduce the risk of personal injury and damage to equipment. Read all instructions before using this tool!

1. Keep work area clean .cluttered areas invite injuries.
2. Observe work area condition. Do not use machines or power tools in damp or wet locations. Don't expose to rain. Keep work area well lighted. Do not use electrically powered tools in the presence of flammable gases or liquids.
3. Keep children away. Children must never be allowed in the work area. Do not let them handle machines, tools or extension cords.
4. Store idle equipment. When not in use ,tools must be stored in a dry location to inhibit rust. Always lock up tools and keep out of reach of children.
5. Use the right tool for the job. Do not attempt to force a small tool or attachment to do the work of a larger industrial tool. There are certain applications for which this tool was designed. It will do the job better and more safely at the rate for which it was intended. Do

- not modify this tool and do not use this tool for a purpose for which it was not intended.
6. Dress properly. Do not wear loose clothing or jewelry as they can be caught in moving parts. Protective, electrically non-conductive clothes and non-skid footwear are recommended when working. Wear restrictive hair covering to contain long hair.
7. Use eye and ear protection. Always wear ANSL approved impact safety goggles.
8. Do not overreach. Keep proper footing and balance at all times, do not reach over or across running machines.
9. Maintain tools with care. Inspect tool cords and hoses periodically and, if damaged, have them replaced, or repaired by an authorized technician. The handles must be kept clean, dry, and free from oil and grease at all times.
10. Remove adjusting keys and wrenches. Check that keys and adjusting wrenches are removed from the tool or machine work surface before operating.
11. Avoid unintentional starting. Be sure the air pressure is in the off position when not in use and before making hose connections.
12. Stay alert. Watch what you are doing, use common sense. Do not operate any tool when you are tired.
13. Check for damaged parts. Before using any tool, any part that appears damaged should be carefully checked to determine that it will operate properly and perform its intended function. Check for alignment and binding of moving parts; any broken parts or mounting fixtures; and any other condition that may affect proper operation any part that is damaged should be properly repaired or replaced by a qualified technician. Do not use the tool if any control or switch does operate properly.
14. Replacement parts and accessories. When servicing, use only identical replacement parts. Use of any other parts will void the warranty. Only use accessories intended for use with this tool. Approved accessories are available from Harbor Freight Tools.
15. Do not operate tool if under the influence of alcohol or drugs. Read warning labels if taking prescription medicine to determine if your judgment or reflexes are impaired while taking drugs. If there is any doubt, do not operate the tool.
16. Pacemaker safety warning. People with pacemakers should consult their physician(s) before using this product. Electromagnetic fields in close proximity to a heart pacemaker could cause interference to, or failure of the pacemaker. In addition, people with pacemakers should adhere to the following:
 - caution is necessary when near the coil, spark plug cables, or distributor of a running engine. the engine should always be off if adjustments are to be made to the distributor.
17. maintenance. for your safety, service and maintenance should be performed regularly by a qualified technician.

Note: performance of this tool may vary depending on variations in air pressure and compressor capability.

Brake fluid exchanger safety precautions

Caution: this equipment is designed to be operated by qualified and trained personnel. It should only be operated after reading and understanding the safety warnings and operating procedures in this instruction manual and vehicle's service manual.

1. Wear safety goggles.
2. Do not smoke near this equipment.
3. Use in a well ventilated area.
4. When leaks are found in the equipment or hoses, immediately turn the air pressure off and repair the leaks.
5. Immediately clean up any fluid spills or leaks.
6. Do not exceed the recommended operating air pressure. This could damage equipment. See specifications on page 2.
7. Do not use any cleaning compounds in this system.
8. Keep an empty plastic bucket nearby in case of fires
9. Keep a type ABC fire extinguisher nearby in case of leaks.
10. Prior to using the brake fluid exchanger, make sure to read and understand all warnings, safety precautions, and instructions as outlined in the vehicle manufacturer's service manual. Every vehicle has specific brake bleeding requirements. It is beyond the scope of this manual to

properly describe the correct procedure for each vehicle.

11. Prior to using the Break Fluid Exchanger, make sure to place the vehicle's transmission in "PARK" (if automatic) or "NEUTRAL" (if manual), then, set the emergency parking brake and block the tires with chocks. }

12. Use the Break Fluid Exchanger only with brake fluid. Do not attempt to use the tool to siphon any other liquids. Contamination of brake fluid and possible break system failure may result.

13. follow guidelines for proper brake fluid disposal. Used brake fluid should be properly disposed of or recycled. many states require recycling. Contact your local solid/liquid waster authority for information on recycling. do not reuse old brake fluid.

14. do not use pressurized air to blow off brake dust. Only use brake parts cleaner to clean dust off of the brake calipers.

15. be alert for hot brake components and other hot vehicle components to avoid accidental burns.

16. some brake pads contain asbestos. Asbestosis, a chronic lung inflammation, can result from prolonged inhalation of asbestos particles. Accordingly, wear appropriate respiratory devices and proper protective clothing when working near any break pads.

17. always keep brake fluid from contacting the vehicle's paint finish. Brake fluid will damage the paint finish on vehicles.

Warning: the warnings, cautions, and instructions discussed in this instruction manual cannot cover all possible conditions and situations that may occur , it must be under-stood by the operator that common sense and caution are factors which cannot be built into this product ,but must be supplied by the operator.

Unpacking

When unpacking, check to make sure the following parts are included. If any parts are missing or broken ,please call Cannon Tools at the number on the cover of this manual as soon as possible.

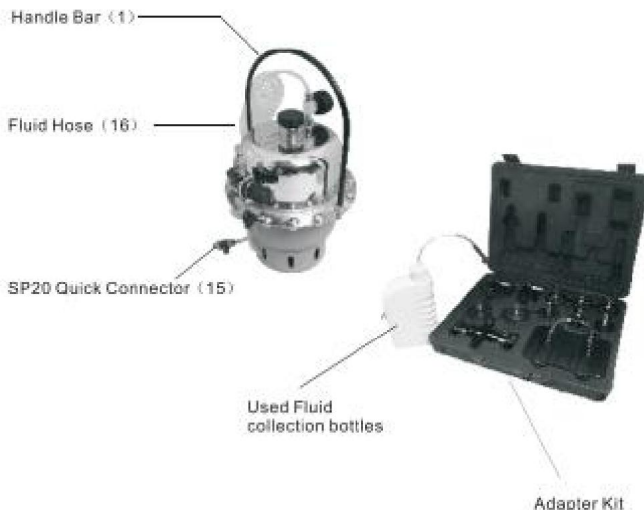

Operation

Preparation

1. Place vehicle on a hoist or on secure vehicle stands in a well ventilated area.
2. set vehicle emergency brake and turn engine off.
3. remove the wheels and locate the drain connection on the brake cylinders. Refer to the vehicle manufacturer's maintenance manual for their location.
4. turn on the air compressor (not supplied) and place its hose next to the Break Fluid Exchanger (the air compressor should have a moisture filter installed on it. See illustration on the top of page 6.)

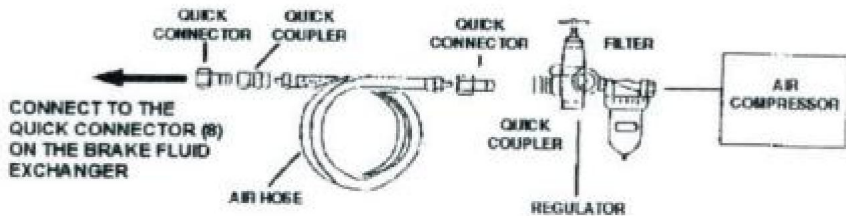

Controls and Indicators

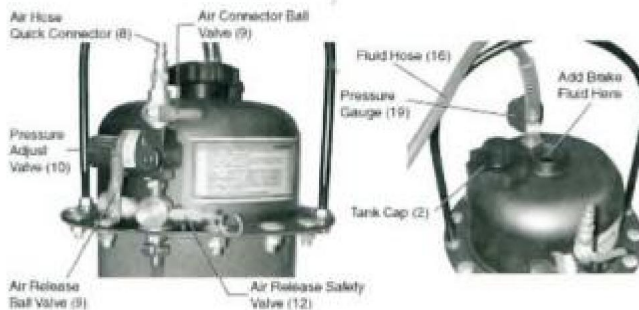

Bleeding brakes and adding new fluid

Warning: the vehicle engine must never be started in a closed garage, or any other sealed structure. Carbon monoxide is produced during operation and is deadly in a closed environment. Early signs of carbon monoxide poisoning resemble the flu, with headaches, dizziness, or nausea..if you have any of these signs get fresh air immediately.

1. Place the Brake Fluid Exchanger near the vehicle and remove the Tank Cap(2)
2. Open and secure the engine hood and find the Master Cylinder.
3. Remove the Master Cylinder Lid.
4. Open the Adapter Kit and find the Adapter Lid that looks like, and best fits, the Master Cylinder.

Refer to the Adapter Kit Parts List at the end of this manual. The temporary Adapter Lid should have the from of the Master Cylinder Lid with the addition of a connector inlet for the Fluid Hose(16).In some instances, a universal Lid (E1,F1,or F2) may need to be used where other Adapters will not fit. Use the mounting loop cables and hardware provided with the

Adapter to secure the universal Lid.

5. Secure the Adapter Lid to the Master Cylinder.

6. Unscrew and remove the Tank Cap(2), then pour in the appropriate amount of new brake fluid. Refer to the vehicle manufacturer's service manual for the correct amount and type of fluid. Screw in the Tank Cap(2) tightly.

7. Insert the Fluid Hose(16) Quick Connector(15) onto the temporary Master Cylinder Adapter Lid. Make sure that's Ball valve(9) is in the closed position (sideways to the direction of the Fluid Hose).

8. Remove the Drain Screws from the rear brake cylinder, and insert clear rubber tube(not supplied) in to the drain holes. Press fit the rubber connector of the Used Fluid Bottles into the other end of the clear rubber tube

Note: The Used Fluid Bottles can be connected directly to the brake cylinders drain, but you will not be able to see the color of the fluid the bottles (darker is old, lighter is new).

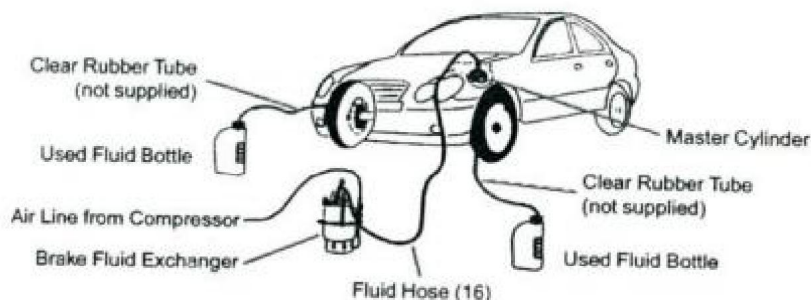

9. Connect the air line hose(not supplied) to the Air Hose Quick Connector (8) on the Brake Fluid Exchanger.

10. Set the Air Connector Ball Valve(9) to the ON(vertical) position.

11. Pull out on the Pressure Adjust Valve(10) knob, and while viewing the Pressure Gauge(19), turn the knob to adjust the Tank pressure to between 20 to 40 PSI

Caution: Never exceed 40 PSI or damage may occur to equipment and connection hoses.

12. Slowly open (in line with hose) the Fluid Hose (16) Ball Valve (9) on top of the Master Cylinder.

This begins the process of forcing the new fluid in, and while old fluid out and into the Used Fluid Bottles. Check for leaks at all connection Points. If leaks and continue.

13. During the fluid transfer, press in quickly on the brake pedal in the vehicle, and release slowly do this a few times.

14. When the Used Fluid Bottles are full, or the fluid color has changed from dark to light as seen through

15. Remove the Used Fluid Bottles or Clear Rubber Tubes connected to the brake cylinder and return screws to the drain holes.

16. Empty the Used Fluid Bottles into a fluid recycle tank, or in other bottles for proper disposal.

17. Repeat steps 8 through 15 the front brake cylinders.

18. When the fluid transfer of the front brake cylinders is complete, turn the Ball Valve(9) on the Master Cylinder to the Off(sideways) position, and remove the Fluid Hose(16) from the Master Cylinder lid.

Adding New Fluid to Vehicles with ABS Brake Systems

1. Follow all the previous steps, with these exceptions.

2. Remove the drain screw for only on the brake cylinder at a time, and drain that brake cylinder.

3. Place the vehicle transmission in Park, and start the engine during this process. When adding new fluid is complete, turn the engine off.

4. Remove the Used fluid bottle or Clear Rubber Tube connected to that brake cylinder and

return screw to the drain hole.
5. Repeat for each brake cylinder individually.

Steps When Finished Bleeding Brakes and Adding New Fluid

1. Replace the original Master Cylinder lid.
2. Remove the air input line from Air hose Quick Connector(8) on the Tank.
3. Open the Air release Ball Valve(9) on the Tank, and pull on the Air Release Safety Valve(12) to depressurize the Tank.
4. Empty the Used Fluid Bottles into a fluid recycle tank, or in other bottles for proper disposal.

WARNING: Before driving the vehicle, depress the brake pedal repeatedly until the brake pedal feels firm. Check the brake calipers for leaks. Then, test the brakes thoroughly at slow speed before operating the vehicle under normal conditions.

Maintenance

Caution: Before performing any maintenance on the Brake Fluid Exchanger, verify that the Brake Fluid Exchanger is depressurized.

1. Clean up any brake fluid oil that may have spilled.
2. Wipe down the Brake Fluid Exchanger components with a cloth.
3. Store the unit in a clean and dry location.

Brake fluid Exchanger Parts List

1	Handle Bar	1	10	Connector	2
2	Cap, Tank	1	11	Valve, Safety, Air Release	1
3	Tank, Upper Half	1	12	Connector	1
4	Rubber Membrane	1	13	Tube	1
5	Tank, lower Half	1	14	Connector, Quick Fluid	1
6	Connector, PL802L	1	15	Hose, Fluid	1
7	Connector, Quick	1	16	Coupler	1
8	Valve, Ball, 1/4"	3	17	Gauge, Pressure	1
9	Valve, Pressure Adjust	1	18	Coupler, Pressure Gauge	1

NOTE: Some parts are listed and shown for illustration purposes only and are not available individually as replacement parts.

Brake Fluid Exchanger Assembly Drawing

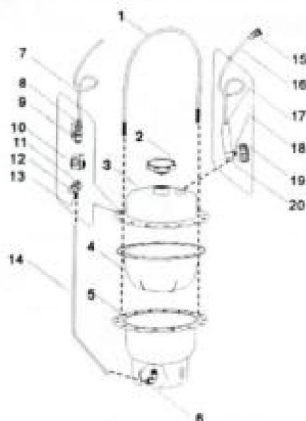

Adapter Kit Parts List

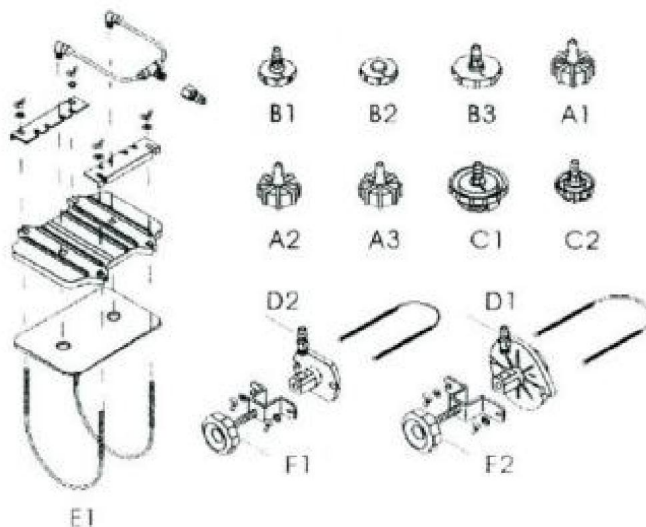

PLEASE READ THE FOLLOWING CAREFULLY

THE MANUFACTURER AND/OR DISTRIBUTOR HAS PROVIDED THE PARTS DIAGRAM IN THIS MANUAL AS A REFERENCE TOOL ONLY. NEITHER THE MANUFACTURER NOR DISTRIBUTOR MAKES ANY REPRESENTATION OR WARRANTY OF ANY KIND TO THE BUYER THAT HE OR SHE IS QUALIFIED TO MAKE ANY REPAIRS TO THE PRODUCT OR THAT HE OR SHE IS QUALIFIED TO REPLACE ANY PARTS OF THE PRODUCT. IN FACT, THE MANUFACTURER AND/OR DISTRIBUTOR EXPRESSLY STATES THAT ALL REPAIRS AND PARTS REPLACEMENTS SHOULD BE UNDERTAKEN BY CERTIFIED AND LICENSED TECHNICIANS AND NOT BY THE BUYER. THE BUYER ASSUMES ALL RISK AND LIABILITY ARISING OUT OF HIS OR HER REPAIRS TO THE ORIGINAL PRODUCT OR REPLACEMENT PARTS THERE TO, OR ARISING OUT OF HIS OR HER INSTALLATION OF REPLACEMENT PARTS THERE TO.

Hersteller: Shanghai muxin muyeyouxiangongsi

Adresse: Shuangchenglu 803nong11hao1602A-1609shi, Baoshanqu, Shanghai
200000 CN.

Nach AUS importiert: SIHAO PTY LTD. 1 ROKEVA STREETEASTWOOD NSW 2122
Australien

Importiert in die USA: Sanven Technology Ltd. Suite 250, 9166 Anaheim Place,
Rancho Cucamonga, CA 91730



YH CONSULTING LIMITED. C/O YH Consulting Limited
Büro 147, Centurion House, London Road, Staines-upon-
Thames, Surrey, TW18 4AX

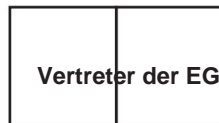

E-CrossStu GmbH
Mainzer Landstr.69,
60329 Frankfurt am Main.

VEVOR[®]
TOUGH TOOLS, HALF PRICE

Technischer Support und E-Garantie-Zertifikat
www.vevor.com/support



Supporto tecnico e certificato di garanzia

elettronica www.vevor.com/support

SET SPURGO FRENO/FRIZIONE

MODELLO:BC-105

Continuiamo a impegnarci per fornirvi strumenti a prezzi competitivi.

"Risparmia la metà", "Metà prezzo" o qualsiasi altra espressione simile da noi utilizzata rappresenta solo una stima del risparmio che potresti ottenere acquistando determinati utensili con noi rispetto ai principali marchi principali e non significa necessariamente coprire tutte le categorie di utensili da noi offerti. Ti ricordiamo gentilmente di verificare attentamente quando effettui un ordine con noi se stai effettivamente risparmiando la metà rispetto ai principali marchi principali.

VEVOR®
TOUGH TOOLS, HALF PRICE

FRENO/FRIZIONE SET DI SPURGO

MODELLO:BC-105



HAI BISOGNO DI AIUTO? CONTATTACI!

Hai domande sul prodotto? Hai bisogno di supporto tecnico? Non esitare a contattarci:

Supporto

**tecnico e certificato di garanzia elettronica [www.vevor.com/
support](http://www.vevor.com/support)**

Questa è l'istruzione originale, si prega di leggere attentamente tutte le istruzioni del manuale prima di utilizzare. VEVOR si riserva una chiara interpretazione del nostro manuale utente. L'aspetto del prodotto sarà soggetto al prodotto ricevuto. Vi preghiamo di perdonarci se non vi informeremo di nuovo se ci sono aggiornamenti tecnologici o software sul nostro prodotto.

ELENCO PARAMETRI

Modello	BC-105
Campo di pressione	10-40 psi
Capacità	5L
peso netto (kg)	7.5

Save this manual

You will need manual for the safety warnings and precautions , assembly instructions, operating and maintenance procedures , parts list and diagram, keep your invoice with this manual .write the invoice number on the inside of the front cover. Keep the manual and invoice in a safe and dry place for future reference.

Safety warnings and precautions

Warning : when using tool ,basic safety precautions should always be followed to reduce the risk of personal injury and damage to equipment. Read all instructions before using this tool!

1. Keep work area clean .cluttered areas invite injuries.
2. Observe work area condition. Do not use machines or power tools in damp or wet locations. Don't expose to rain. Keep work area well lighted. Do not use electrically powered tools in the presence of flammable gases or liquids.
3. Keep children away. Children must never be allowed in the work area. Do not let them handle machines, tools or extension cords.
4. Store idle equipment. When not in use ,tools must be stored in a dry location to inhibit rust. Always lock up tools and keep out of reach of children.
5. Use the right tool for the job. Do not attempt to force a small tool or attachment to do the work of a larger industrial tool. There are certain applications for which this tool was designed. It will do the job better and more safely at the rate for which it was intended. Do

- not modify this tool and do not use this tool for a purpose for which it was not intended.
6. Dress properly. Do not wear loose clothing or jewelry as they can be caught in moving parts. Protective, electrically non-conductive clothes and non-skid footwear are recommended when working. Wear restrictive hair covering to contain long hair.
7. Use eye and ear protection. Always wear ANSL approved impact safety goggles.
8. Do not overreach. Keep proper footing and balance at all times, do not reach over or across running machines.
9. Maintain tools with care. Inspect tool cords and hoses periodically and, if damaged, have them replaced, or repaired by an authorized technician. The handles must be kept clean, dry, and free from oil and grease at all times.
10. Remove adjusting keys and wrenches. Check that keys and adjusting wrenches are removed from the tool or machine work surface before operating.
11. Avoid unintentional starting. Be sure the air pressure is in the off position when not in use and before making hose connections.
12. Stay alert. Watch what you are doing, use common sense. Do not operate any tool when you are tired.
13. Check for damaged parts. Before using any tool, any part that appears damaged should be carefully checked to determine that it will operate properly and perform its intended function. Check for alignment and binding of moving parts; any broken parts or mounting fixtures; and any other condition that may affect proper operation any part that is damaged should be properly repaired or replaced by a qualified technician. Do not use the tool if any control or switch does operate properly.
14. Replacement parts and accessories. When servicing, use only identical replacement parts. Use of any other parts will void the warranty. Only use accessories intended for use with this tool. Approved accessories are available from Harbor Freight Tools.
15. Do not operate tool if under the influence of alcohol or drugs. Read warning labels if taking prescription medicine to determine if your judgment or reflexes are impaired while taking drugs. If there is any doubt, do not operate the tool.
16. Pacemaker safety warning. People with pacemakers should consult their physician(s) before using this product. Electromagnetic fields in close proximity to a heart pacemaker could cause interference to, or failure of the pacemaker. In addition, people with pacemakers should adhere to the following:
 - caution is necessary when near the coil, spark plug cables, or distributor of a running engine. the engine should always be off if adjustments are to be made to the distributor.
17. maintenance. for your safety, service and maintenance should be performed regularly by a qualified technician.

Note: performance of this tool may vary depending on variations in air pressure and compressor capability.

Brake fluid exchanger safety precautions

Caution: this equipment is designed to be operated by qualified and trained personnel. It should only be operated after reading and understanding the safety warnings and operating procedures in this instruction manual and vehicle's service manual.

1. Wear safety goggles.
2. Do not smoke near this equipment.
3. Use in a well ventilated area.
4. When leaks are found in the equipment or hoses, immediately turn the air pressure off and repair the leaks.
5. Immediately clean up any fluid spills or leaks.
6. Do not exceed the recommended operating air pressure. This could damage equipment. See specifications on page 2.
7. Do not use any cleaning compounds in this system.
8. Keep an empty plastic bucket nearby in case of fires
9. Keep a type ABC fire extinguisher nearby in case of leaks.
10. Prior to using the brake fluid exchanger, make sure to read and understand all warnings, safety precautions, and instructions as outlined in the vehicle manufacturer's service manual. Every vehicle has specific brake bleeding requirements. It is beyond the scope of this manual to

properly describe the correct procedure for each vehicle.

11. Prior to using the Break Fluid Exchanger, make sure to place the vehicle's transmission in "PARK" (if automatic) or "NEUTRAL" (if manual), then, set the emergency parking brake and block the tires with chocks. }

12. Use the Break Fluid Exchanger only with brake fluid. Do not attempt to use the tool to siphon any other liquids. Contamination of brake fluid and possible break system failure may result.

13. follow guidelines for proper brake fluid disposal. Used brake fluid should be properly disposed of or recycled. many states require recycling. Contact your local solid/liquid waster authority for information on recycling. do not reuse old brake fluid.

14. do not use pressurized air to blow off brake dust. Only use brake parts cleaner to clean dust off of the brake calipers.

15. be alert for hot brake components and other hot vehicle components to avoid accidental burns.

16. some brake pads contain asbestos. Asbestosis, a chronic lung inflammation, can result from prolonged inhalation of asbestos particles. Accordingly, wear appropriate respiratory devices and proper protective clothing when working near any break pads.

17. always keep brake fluid from contacting the vehicle's paint finish. Brake fluid will damage the paint finish on vehicles.

Warning: the warnings, cautions, and instructions discussed in this instruction manual cannot cover all possible conditions and situations that may occur , it must be under-stood by the operator that common sense and caution are factors which cannot be built into this product ,but must be supplied by the operator.

Unpacking

When unpacking, check to make sure the following parts are included. If any parts are missing or broken ,please call Cannon Tools at the number on the cover of this manual as soon as possible.

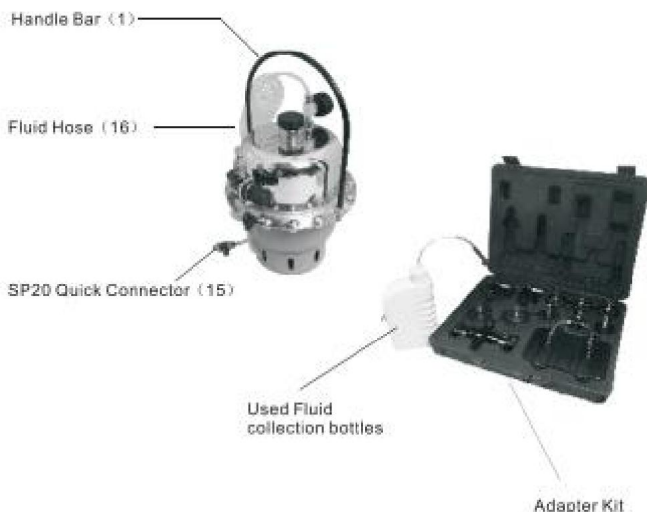

Operation

Preparation

1. Lase vehicle on a hoist or on secure vehicle stands in a well ventilated area.
2. set vehicle emergency brake and turn engine off.
3. remove the wheels and locate the drain connection on the brake cylinders. Refer to the vehicle manufacturer's maintenance manual for their location.
4. turn on the air compressor (not supplied) and place its hose next to the Break Fluid Exchanger (the air compressor should have a moisture filter installed on it. See illustration on the top of page 6.)

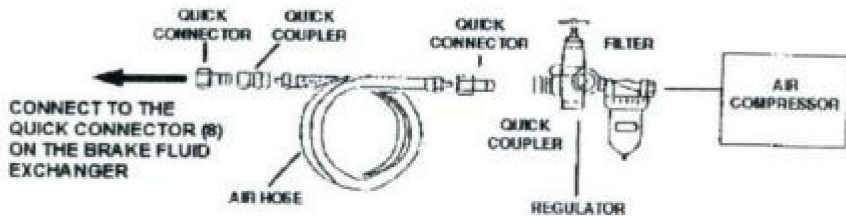

Controls and Indicators

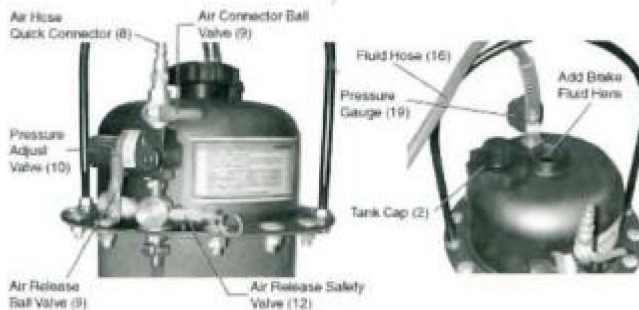

Bleeding brakes and adding new fluid

Warning: the vehicle engine must never be started in a closed garage, or any other sealed structure. Carbon monoxide is produced during operation and is deadly in a closed environment. Early signs of carbon monoxide poisoning resemble the flu, with headaches, dizziness, or nausea..if you have any of these signs get fresh air immediately.

1. Place the Brake Fluid Exchanger near the vehicle and remove the Tank Cap(2)
2. Open and secure the engine hood and find the Master Cylinder.
3. Remove the Master Cylinder Lid.
4. Open the Adapter Kit and find the Adapter Lid that looks like, and best fits, the Master Cylinder.

Refer to the Adapter Kit Parts List at the end of this manual. The temporary Adapter Lid should have the from of the Master Cylinder Lid with the addition of a connector inlet for the Fluid Hose(16).In some instances, a universal Lid (E1,F1,or F2) may need to be used where other Adapters will not fit. Use the mounting loop cables and hardware provided with the

Adapter to secure the universal Lid.

5. Secure the Adapter Lid to the Master Cylinder.

6. Unscrew and remove the Tank Cap(2), then pour in the appropriate amount of new brake fluid. Refer to the vehicle manufacturer's service manual for the correct amount and type of fluid. Screw in the Tank Cap(2) tightly.

7. Insert the Fluid Hose(16) Quick Connector(15) onto the temporary Master Cylinder Adapter Lid. Make sure that's Ball valve(9) is in the closed position (sideways to the direction of the Fluid Hose).

8. Remove the Drain Screws from the rear brake cylinder, and insert clear rubber tube(not supplied) in to the drain holes. Press fit the rubber connector of the Used Fluid Bottles into the other end of the clear rubber tube

Note: The Used Fluid Bottles can be connected directly to the brake cylinders drain, but you will not be able to see the color of the fluid the bottles (darker is old, lighter is new).

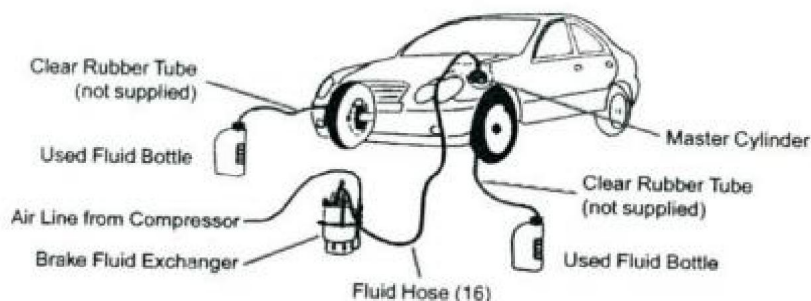

9. Connect the air line hose(not supplied) to the Air Hose Quick Connector (8) on the Brake Fluid Exchanger.

10. Set the Air Connector Ball Valve(9) to the ON(vertical) position.

11. Pull out on the Pressure Adjust Valve(10) knob, and while viewing the Pressure Gauge(19), turn the knob to adjust the Tank pressure to between 20 to 40 PSI

Caution: Never exceed 40 PSI or damage may occur to equipment and connection hoses.

12. Slowly open (in line with hose) the Fluid Hose (16) Ball Valve (9) on top of the Master Cylinder.

This begins the process of forcing the new fluid in ,and while oil fluid out and into the Used Fluid Bottles. Check for leaks at all connection Points. If leaks and continue.

13. During the fluid transfer, press in quickly on the brake pedal in the vehicle, and release slowly do this a few times.

14. When the Used Fluid Bottles are full ,or the fluid color has changed from dark to light as seen through

15. Remove the Used Fluid Bottles or Clear Rubber Tubes connected to the brake cylinder and return screws to the drain holes.

16. Empty the Used Fluid Bottles into a fluid recycle tank, or in other bottles for proper disposal.

17. Repeat steps 8 through 15 the front brake cylinders.

18. When the fluid transfer of the front brake cylinders is complete, turn the Ball Valve(9) on the Master Cylinder to the Off(sideways) position, and remove the Fluid Hose(16) from the Master Cylinder lid.

Adding New Fluid to Vehicles with ABS Brake Systems

1. Follow all the previous steps ,with these exceptions.

2. Remove the drain screw for only on the brake cylinder at a time, and drain that brake cylinder.

3. Place the vehicle transmission in Park, and start the engine during this process. When adding new fluid is complete, turn the engine off.

4. Remove the Used fluid bottle or Clear Rubber Tube connected to that brake cylinder and

return screw to the drain hole.
5. Repeat for each brake cylinder individually.

Steps When Finished Bleeding Brakes and Adding New Fluid

1. Replace the original Master Cylinder lid.
2. Remove the air input line from Air hose Quick Connector(8) on the Tank.
3. Open the Air release Ball Valve(9) on the Tank, and pull on the Air Release Safety Valve(12) to depressurize the Tank.
4. Empty the Used Fluid Bottles into a fluid recycle tank, or in other bottles for proper disposal.

WARNING: Before driving the vehicle, depress the brake pedal repeatedly until the brake pedal feels firm. Check the brake calipers for leaks. Then, test the brakes thoroughly at slow speed before operating the vehicle under normal conditions.

Maintenance

Caution: Before performing any maintenance on the Brake Fluid Exchanger, verify that the Brake Fluid Exchanger is depressurized.

1. Clean up any brake fluid oil that may have spilled.
2. Wipe down the Brake Fluid Exchanger components with a cloth.
3. Store the unit in a clean and dry location.

Brake fluid Exchanger Parts List

1	Handle Bar	1	10	Connector	2
2	Cap, Tank	1	11	Valve, Safety, Air Release	1
3	Tank, Upper Half	1	12	Connector	1
4	Rubber Membrane	1	13	Tube	1
5	Tank, lower Half	1	14	Connector, Quick Fluid	1
6	Connector, PL802L	1	15	Hose, Fluid	1
7	Connector, Quick	1	16	Coupler	1
8	Valve, Ball, 1/4"	3	17	Gauge, Pressure	1
9	Valve, Pressure Adjust	1	18	Coupler, Pressure Gauge	1

NOTE: Some parts are listed and shown for illustration purposes only and are not available individually as replacement parts.

Brake Fluid Exchanger Assembly Drawing

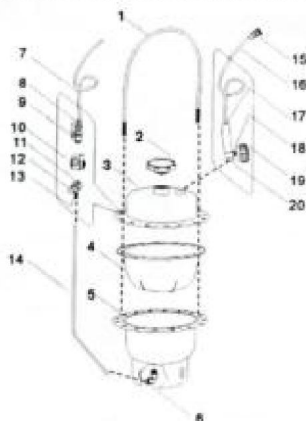

Adapter Kit Parts List

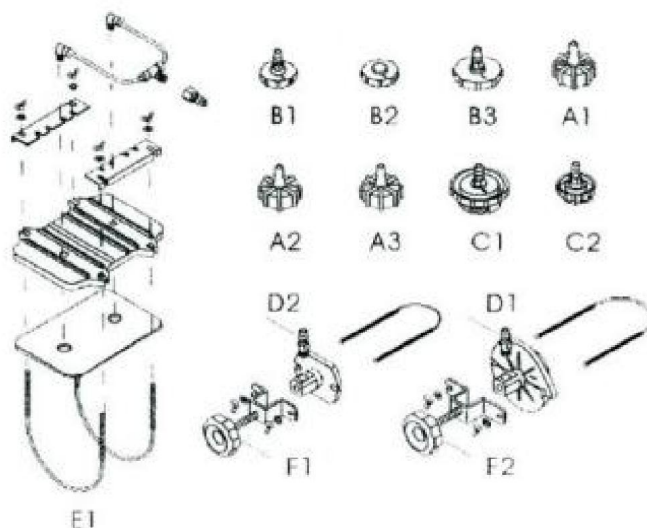

PLEASE READ THE FOLLOWING CAREFULLY

THE MANUFACTURER AND/OR DISTRIBUTOR HAS PROVIDED THE PARTS DIAGRAM IN THIS MANUAL AS A REFERENCE TOOL ONLY. NEITHER THE MANUFACTURER NOR DISTRIBUTOR MAKES ANY REPRESENTATION OR WARRANTY OF ANY KIND TO THE BUYER THAT HE OR SHE IS QUALIFIED TO MAKE ANY REPAIRS TO THE PRODUCT OR THAT HE OR SHE IS QUALIFIED TO REPLACE ANY PARTS OF THE PRODUCT. IN FACT, THE MANUFACTURER AND/OR DISTRIBUTOR EXPRESSLY STATES THAT ALL REPAIRS AND PARTS REPLACEMENTS SHOULD BE UNDERTAKEN BY CERTIFIED AND LICENSED TECHNICIANS AND NOT BY THE BUYER. THE BUYER ASSUMES ALL RISK AND LIABILITY ARISING OUT OF HIS OR HER REPAIRS TO THE ORIGINAL PRODUCT OR REPLACEMENT PARTS THERE TO, OR ARISING OUT OF HIS OR HER INSTALLATION OF REPLACEMENT PARTS THERE TO.

Produttore: Shanghai muxin mu yeyou xiangong si

Indirizzo: Shuangchenglu 803nong11hao1602A-1609shi, Baoshanqu, Shanghai
200000 CN.

Importato in AUS: SIHAO PTY LTD. 1 ROKEVA STREETEASTWOOD NSW 2122
Australia

Importato negli USA: Sanven Technology Ltd. Suite 250, 9166 Anaheim Place,
Rancho Cucamonga, CA 91730



YH CONSULTING LIMITED. C/O YH Consulting Limited
Ufficio 147, Centurion House, London Road, Staines-
upon-Thames, Surrey, TW18 4AX

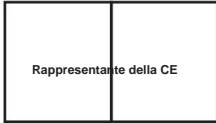

E-CrossStu GmbH
Mainzer Landstr.69,
60329 Francoforte sul Meno.

VEVOR[®]
TOUGH TOOLS, HALF PRICE

Supporto tecnico e certificato di garanzia
elettronica www.vevor.com/support



Soporte técnico y certificado de garantía

electrónica www.vevor.com/support

JUEGO DE PURGA DE FRENOS/EMBRAGUE

MODELO:BC-105

Seguimos comprometidos a brindarle herramientas a precios competitivos.

"Ahorre la mitad", "mitad de precio" o cualquier otra expresión similar que utilicemos solo representa una estimación del ahorro que podría obtener al comprar ciertas herramientas con nosotros en comparación con las principales marcas y no necesariamente significa que cubra todas las categorías de herramientas que ofrecemos. Le recordamos que, al realizar un pedido con nosotros, verifique cuidadosamente si realmente está ahorrando la mitad en comparación con las principales marcas.

VEVOR®
TOUGH TOOLS, HALF PRICE

FRENO/EMBRAGUE

JUEGO DE SANGRADO

MODELO:BC-105



¿NECESITAS AYUDA? ¡CONTÁCTANOS!

¿Tiene preguntas sobre el producto? ¿Necesita asistencia técnica? No dude en ponerse en contacto con

nosotros: Asistencia técnica y certificado de garantía electrónica
www.vevor.com/support

Estas son las instrucciones originales, lea atentamente todas las instrucciones del manual antes de utilizar el producto. VEVOR se reserva una interpretación clara de nuestro manual de usuario. La apariencia del producto estará sujeta al producto que recibió. Perdónenos por no informarle nuevamente si hay actualizaciones de tecnología o software en nuestro producto.

LISTA DE PARÁMETROS

Modelo	BC-105
Rango de presión	10-40 psi
Capacidad	5 litros
Peso neto (kg)	7.5

Save this manual

You will need manual for the safety warnings and precautions , assembly instructions, operating and maintenance procedures , parts list and diagram, keep your invoice with this manual .write the invoice number on the inside of the front cover. Keep the manual and invoice in a safe and dry place for future reference.

Safety warnings and precautions

Warning : when using tool ,basic safety precautions should always be followed to reduce the risk of personal injury and damage to equipment. Read all instructions before using this tool!

1. Keep work area clean .cluttered areas invite injuries.
2. Observe work area condition. Do not use machines or power tools in damp or wet locations. Don't expose to rain. Keep work area well lighted. Do not use electrically powered tools in the presence of flammable gases or liquids.
3. Keep children away. Children must never be allowed in the work area. Do not let them handle machines, tools or extension cords.
4. Store idle equipment. When not in use ,tools must be stored in a dry location to inhibit rust. Always lock up tools and keep out of reach of children.
5. Use the right tool for the job. Do not attempt to force a small tool or attachment to do the work of a larger industrial tool. There are certain applications for which this tool was designed. It will do the job better and more safely at the rate for which it was intended. Do

- not modify this tool and do not use this tool for a purpose for which it was not intended.
6. Dress properly. Do not wear loose clothing or jewelry as they can be caught in moving parts. Protective, electrically non-conductive clothes and non-skid footwear are recommended when working. Wear restrictive hair covering to contain long hair.
7. Use eye and ear protection. Always wear ANSL approved impact safety goggles.
8. Do not overreach. Keep proper footing and balance at all times, do not reach over or across running machines.
9. Maintain tools with care. Inspect tool cords and hoses periodically and, if damaged, have them replaced, or repaired by an authorized technician. The handles must be kept clean, dry, and free from oil and grease at all times.
10. Remove adjusting keys and wrenches. Check that keys and adjusting wrenches are removed from the tool or machine work surface before operating.
11. Avoid unintentional starting. Be sure the air pressure is in the off position when not in use and before making hose connections.
12. Stay alert. Watch what you are doing, use common sense. Do not operate any tool when you are tired.
13. Check for damaged parts. Before using any tool, any part that appears damaged should be carefully checked to determine that it will operate properly and perform its intended function. Check for alignment and binding of moving parts; any broken parts or mounting fixtures; and any other condition that may affect proper operation any part that is damaged should be properly repaired or replaced by a qualified technician. Do not use the tool if any control or switch does operate properly.
14. Replacement parts and accessories. When servicing, use only identical replacement parts. Use of any other parts will void the warranty. Only use accessories intended for use with this tool. Approved accessories are available from Harbor Freight Tools.
15. Do not operate tool if under the influence of alcohol or drugs. Read warning labels if taking prescription medicine to determine if your judgment or reflexes are impaired while taking drugs. If there is any doubt, do not operate the tool.
16. Pacemaker safety warning. People with pacemakers should consult their physician(s) before using this product. Electromagnetic fields in close proximity to a heart pacemaker could cause interference to, or failure of the pacemaker. In addition, people with pacemakers should adhere to the following:
-caution is necessary when near the coil, spark plug cables, or distributor of a running engine. the engine should always be off if adjustments are to be made to the distributor.
17. maintenance. for your safety, service and maintenance should be performed regularly by a qualified technician.

Note: performance of this tool may vary depending on variations in air pressure and compressor capability.

Brake fluid exchanger safety precautions

Caution: this equipment is designed to be operated by qualified and trained personnel. It should only be operated after reading and understanding the safety warnings and operating procedures in this instruction manual and vehicle's service manual.

1. Wear safety goggles.
2. Do not smoke near this equipment.
3. Use in a well ventilated area.
4. When leaks are found in the equipment or hoses, immediately turn the air pressure off and repair the leaks.
5. Immediately clean up any fluid spills or leaks.
6. Do not exceed the recommended operating air pressure. This could damage equipment. See specifications on page 2.
7. Do not use any cleaning compounds in this system.
8. Keep an empty plastic bucket nearby in case of fires
9. Keep a type ABC fire extinguisher nearby in case of leaks.
10. Prior to using the brake fluid exchanger, make sure to read and understand all warnings, safety precautions, and instructions as outlined in the vehicle manufacturer's service manual. Every vehicle has specific brake bleeding requirements. It is beyond the scope of this manual to

properly describe the correct procedure for each vehicle.

11. Prior to using the Break Fluid Exchanger, make sure to place the vehicle's transmission in "PARK" (if automatic) or "NEUTRAL" (if manual), then, set the emergency parking brake and block the tires with chocks. }

12. Use the Break Fluid Exchanger only with brake fluid. Do not attempt to use the tool to siphon any other liquids. Contamination of brake fluid and possible break system failure may result.

13. follow guidelines for proper brake fluid disposal. Used brake fluid should be properly disposed of or recycled. many states require recycling. Contact your local solid/liquid waster authority for information on recycling. do not reuse old brake fluid.

14. do not use pressurized air to blow off brake dust. Only use brake parts cleaner to clean dust off of the brake calipers.

15. be alert for hot brake components and other hot vehicle components to avoid accidental burns.

16. some brake pads contain asbestos. Asbestosis, a chronic lung inflammation, can result from prolonged inhalation of asbestos particles. Accordingly, wear appropriate respiratory devices and proper protective clothing when working near any break pads.

17. always keep brake fluid from contacting the vehicle's paint finish. Brake fluid will damage the paint finish on vehicles.

Warning: the warnings, cautions, and instructions discussed in this instruction manual cannot cover all possible conditions and situations that may occur , it must be under-stood by the operator that common sense and caution are factors which cannot be built into this product ,but must be supplied by the operator.

Unpacking

When unpacking, check to make sure the following parts are included. If any parts are missing or broken ,please call Cannon Tools at the number on the cover of this manual as soon as possible.

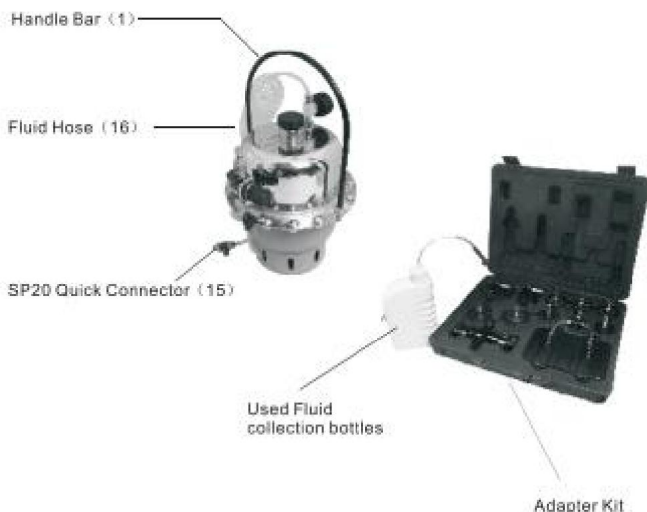

Operation

Preparation

1. Place vehicle on a hoist or on secure vehicle stands in a well ventilated area.
2. set vehicle emergency brake and turn engine off.
3. remove the wheels and locate the drain connection on the brake cylinders. Refer to the vehicle manufacturer's maintenance manual for their location.
4. turn on the air compressor (not supplied) and place its hose next to the Break Fluid Exchanger (the air compressor should have a moisture filter installed on it. See illustration on the top of page 6.)

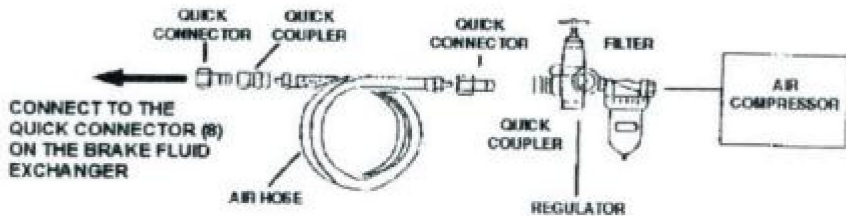

Controls and Indicators

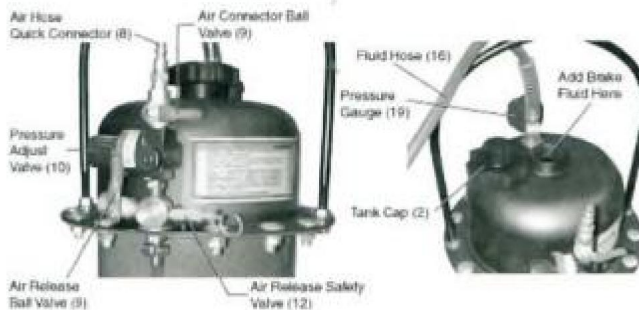

Bleeding brakes and adding new fluid

Warning: the vehicle engine must never be started in a closed garage, or any other sealed structure. Carbon monoxide is produced during operation and is deadly in a closed environment. Early signs of carbon monoxide poisoning resemble the flu, with headaches, dizziness, or nausea..if you have any of these signs get fresh air immediately.

1. Place the Brake Fluid Exchanger near the vehicle and remove the Tank Cap(2)
2. Open and secure the engine hood and find the Master Cylinder.
3. Remove the Master Cylinder Lid.
4. Open the Adapter Kit and find the Adapter Lid that looks like, and best fits, the Master Cylinder.

Refer to the Adapter Kit Parts List at the end of this manual. The temporary Adapter Lid should have the from of the Master Cylinder Lid with the addition of a connector inlet for the Fluid Hose(16).In some instances, a universal Lid (E1,F1,or F2) may need to be used where other Adapters will not fit. Use the mounting loop cables and hardware provided with the

Adapter to secure the universal Lid.

5. Secure the Adapter Lid to the Master Cylinder.

6. Unscrew and remove the Tank Cap(2), then pour in the appropriate amount of new brake fluid. Refer to the vehicle manufacturer's service manual for the correct amount and type of fluid. Screw in the Tank Cap(2) tightly.

7. Insert the Fluid Hose(16) Quick Connector(15) onto the temporary Master Cylinder Adapter Lid. Make sure that's Ball valve(9) is in the closed position (sideways to the direction of the Fluid Hose).

8. Remove the Drain Screws from the rear brake cylinder, and insert clear rubber tube(not supplied) in to the drain holes. Press fit the rubber connector of the Used Fluid Bottles into the other end of the clear rubber tube

Note: The Used Fluid Bottles can be connected directly to the brake cylinders drain, but you will not be able to see the color of the fluid the bottles (darker is old, lighter is new).

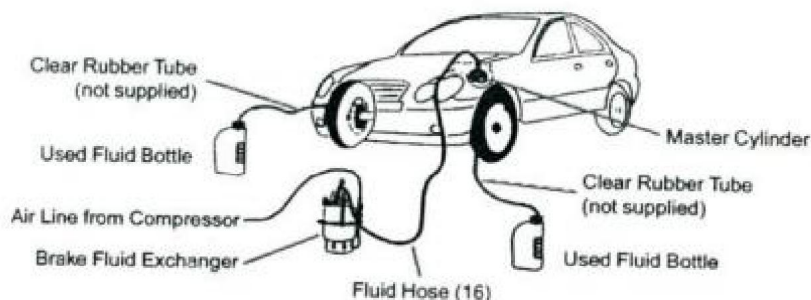

9. Connect the air line hose(not supplied) to the Air Hose Quick Connector (8) on the Brake Fluid Exchanger.

10. Set the Air Connector Ball Valve(9) to the ON(vertical) position.

11. Pull out on the Pressure Adjust Valve(10) knob, and while viewing the Pressure Gauge(19), turn the knob to adjust the Tank pressure to between 20 to 40 PSI

Caution: Never exceed 40 PSI or damage may occur to equipment and connection hoses.

12. Slowly open (in line with hose) the Fluid Hose (16) Ball Valve (9) on top of the Master Cylinder.

This begins the process of forcing the new fluid in, and while old fluid out and into the Used Fluid Bottles. Check for leaks at all connection Points. If leaks and continue.

13. During the fluid transfer, press in quickly on the brake pedal in the vehicle, and release slowly do this a few times.

14. When the Used Fluid Bottles are full, or the fluid color has changed from dark to light as seen through

15. Remove the Used Fluid Bottles or Clear Rubber Tubes connected to the brake cylinder and return screws to the drain holes.

16. Empty the Used Fluid Bottles into a fluid recycle tank, or in other bottles for proper disposal.

17. Repeat steps 8 through 15 the front brake cylinders.

18. When the fluid transfer of the front brake cylinders is complete, turn the Ball Valve(9) on the Master Cylinder to the Off(sideways) position, and remove the Fluid Hose(16) from the Master Cylinder lid.

Adding New Fluid to Vehicles with ABS Brake Systems

1. Follow all the previous steps, with these exceptions.

2. Remove the drain screw for only on the brake cylinder at a time, and drain that brake cylinder.

3. Place the vehicle transmission in Park, and start the engine during this process. When adding new fluid is complete, turn the engine off.

4. Remove the Used fluid bottle or Clear Rubber Tube connected to that brake cylinder and

return screw to the drain hole.
5. Repeat for each brake cylinder individually.

Steps When Finished Bleeding Brakes and Adding New Fluid

1. Replace the original Master Cylinder lid.
2. Remove the air input line from Air hose Quick Connector(8) on the Tank.
3. Open the Air release Ball Valve(9) on the Tank, and pull on the Air Release Safety Valve(12) to depressurize the Tank.
4. Empty the Used Fluid Bottles into a fluid recycle tank, or in other bottles for proper disposal.

WARNING: Before driving the vehicle, depress the brake pedal repeatedly until the brake pedal feels firm. Check the brake calipers for leaks. Then, test the brakes thoroughly at slow speed before operating the vehicle under normal conditions.

Maintenance

Caution: Before performing any maintenance on the Brake Fluid Exchanger, verify that the Brake Fluid Exchanger is depressurized.

1. Clean up any brake fluid oil that may have spilled.
2. Wipe down the Brake Fluid Exchanger components with a cloth.
3. Store the unit in a clean and dry location.

Brake fluid Exchanger Parts List

1	Handle Bar	1	10	Connector	2
2	Cap, Tank	1	11	Valve, Safety, Air Release	1
3	Tank, Upper Half	1	12	Connector	1
4	Rubber Membrane	1	13	Tube	1
5	Tank, lower Half	1	14	Connector, Quick Fluid	1
6	Connector, PL802L	1	15	Hose, Fluid	1
7	Connector, Quick	1	16	Coupler	1
8	Valve, Ball, 1/4"	3	17	Gauge, Pressure	1
9	Valve, Pressure Adjust	1	18	Coupler, Pressure Gauge	1

NOTE: Some parts are listed and shown for illustration purposes only and are not available individually as replacement parts.

Brake Fluid Exchanger Assembly Drawing

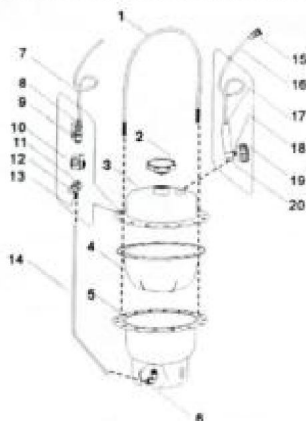

Adapter Kit Parts List

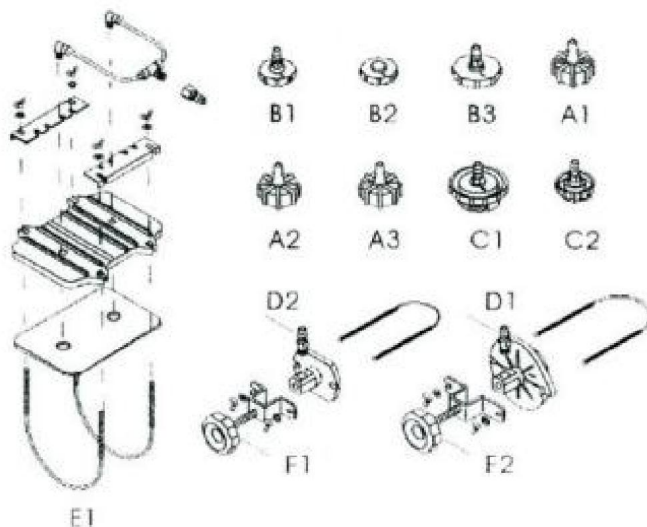

PLEASE READ THE FOLLOWING CAREFULLY

THE MANUFACTURER AND/OR DISTRIBUTOR HAS PROVIDED THE PARTS DIAGRAM IN THIS MANUAL AS A REFERENCE TOOL ONLY. NEITHER THE MANUFACTURER NOR DISTRIBUTOR MAKES ANY REPRESENTATION OR WARRANTY OF ANY KIND TO THE BUYER THAT HE OR SHE IS QUALIFIED TO MAKE ANY REPAIRS TO THE PRODUCT OR THAT HE OR SHE IS QUALIFIED TO REPLACE ANY PARTS OF THE PRODUCT. IN FACT, THE MANUFACTURER AND/OR DISTRIBUTOR EXPRESSLY STATES THAT ALL REPAIRS AND PARTS REPLACEMENTS SHOULD BE UNDERTAKEN BY CERTIFIED AND LICENSED TECHNICIANS AND NOT BY THE BUYER. THE BUYER ASSUMES ALL RISK AND LIABILITY ARISING OUT OF HIS OR HER REPAIRS TO THE ORIGINAL PRODUCT OR REPLACEMENT PARTS THERE TO, OR ARISING OUT OF HIS OR HER INSTALLATION OF REPLACEMENT PARTS THERE TO.

Fabricante: Shanghai muxin muyeyouxiangongsi

Dirección: Shuangchenglu 803nong11hao1602A-1609shi, Baoshanqu, Shanghai 200000 CN.

Importado a AUS: SIHAO PTY LTD. 1 ROKEVA STREETEASTWOOD NSW 2122 Australia

Importado a EE. UU.: Sanven Technology Ltd. Suite 250, 9166 Anaheim Place, Rancho Cucamonga, CA 91730



YH CONSULTING LIMITED. A LA DIRECCIÓN DE YH Consulting Limited Oficina 147, Centurion House, London Road, Staines-upon-Thames, Surrey, TW18 4AX



E-CrossStu GmbH Mainzer Landstr.69, 60329 Fráncfort del Meno.

VEVOR[®]
TOUGH TOOLS, HALF PRICE

Soporte técnico y certificado de garantía
electrónica www.vevor.com/support



Wsparcie techniczne i certyfikat gwarancji

elektronicznej www.vevor.com/support

ZESTAW ODPOWIETRZANIA HAMULCÓW/SPRZĘGŁA

MODEL:BC-105

Nadal staramy się oferować Państwu narzędzia w konkurencyjnych cenach.

„Oszczędź połowę”, „Połowa ceny” lub inne podobne wyrażenia używane przez nas stanowią jedynie szacunkowe oszczędności, jakie możesz uzyskać, kupując u nas określone narzędzia w porównaniu z głównymi markami i niekoniecznie oznaczają one objęcie wszystkich kategorii narzędzi oferowanych przez nas. Uprzejmie przypominamy, aby dokładnie sprawdzić, czy składając u nas zamówienie faktycznie oszczędzasz połowę w porównaniu z głównymi markami.

VEVOR®
TOUGH TOOLS, HALF PRICE

HAMULEC/SPRZĘGŁO

ZESTAW ODPOWIEETRZNIKÓW

MODEL:BC-105



POTRZEBUJESZ POMOCY? SKONTAKTUJ SIĘ Z NAMI!

Masz pytania dotyczące produktu? Potrzebujesz wsparcia technicznego? Skontaktuj się z nami: Wsparcie

techniczne i certyfikat E-Gwarancji www.vevor.com/support

To jest oryginalna instrukcja, przed użyciem należy uważnie przeczytać wszystkie instrukcje. VEVOR zastrzega sobie jasną interpretację naszej instrukcji obsługi. Wygląd produktu będzie zależał od produktu, który otrzymałeś. Prosimy o wybaczenie, że nie poinformujemy Cię ponownie, jeśli w naszym produkcie pojawią się jakiekolwiek aktualizacje technologiczne lub oprogramowania.

LISTA PARAMETRÓW

Model	BC-105
Zakres ciśnienia	10-40 psi
Pojemność	5L
masa netto (kg)	7,5

Save this manual

You will need manual for the safety warnings and precautions , assembly instructions, operating and maintenance procedures , parts list and diagram, keep your invoice with this manual .write the invoice number on the inside of the front cover. Keep the manual and invoice in a safe and dry place for future reference.

Safety warnings and precautions

Warning : when using tool ,basic safety precautions should always be followed to reduce the risk of personal injury and damage to equipment. Read all instructions before using this tool!

1. Keep work area clean .cluttered areas invite injuries.
2. Observe work area condition. Do not use machines or power tools in damp or wet locations. Don't expose to rain. Keep work area well lighted. Do not use electrically powered tools in the presence of flammable gases or liquids.
3. Keep children away. Children must never be allowed in the work area. Do not let them handle machines, tools or extension cords.
4. Store idle equipment. When not in use ,tools must be stored in a dry location to inhibit rust. Always lock up tools and keep out of reach of children.
5. Use the right tool for the job. Do not attempt to force a small tool or attachment to do the work of a larger industrial tool. There are certain applications for which this tool was designed. It will do the job better and more safely at the rate for which it was intended. Do

- not modify this tool and do not use this tool for a purpose for which it was not intended.
6. Dress properly. Do not wear loose clothing or jewelry as they can be caught in moving parts. Protective, electrically non-conductive clothes and non-skid footwear are recommended when working. Wear restrictive hair covering to contain long hair.
7. Use eye and ear protection. Always wear ANSL approved impact safety goggles.
8. Do not overreach. Keep proper footing and balance at all times, do not reach over or across running machines.
9. Maintain tools with care. Inspect tool cords and hoses periodically and, if damaged, have them replaced, or repaired by an authorized technician. The handles must be kept clean, dry, and free from oil and grease at all times.
10. Remove adjusting keys and wrenches. Check that keys and adjusting wrenches are removed from the tool or machine work surface before operating.
11. Avoid unintentional starting. Be sure the air pressure is in the off position when not in use and before making hose connections.
12. Stay alert. Watch what you are doing, use common sense. Do not operate any tool when you are tired.
13. Check for damaged parts. Before using any tool, any part that appears damaged should be carefully checked to determine that it will operate properly and perform its intended function. Check for alignment and binding of moving parts; any broken parts or mounting fixtures; and any other condition that may affect proper operation any part that is damaged should be properly repaired or replaced by a qualified technician. Do not use the tool if any control or switch does operate properly.
14. Replacement parts and accessories. When servicing, use only identical replacement parts. Use of any other parts will void the warranty. Only use accessories intended for use with this tool. Approved accessories are available from Harbor Freight Tools.
15. Do not operate tool if under the influence of alcohol or drugs. Read warning labels if taking prescription medicine to determine if your judgment or reflexes are impaired while taking drugs. If there is any doubt, do not operate the tool.
16. Pacemaker safety warning. People with pacemakers should consult their physician(s) before using this product. Electromagnetic fields in close proximity to a heart pacemaker could cause interference to, or failure of the pacemaker. In addition, people with pacemakers should adhere to the following:
 - caution is necessary when near the coil, spark plug cables, or distributor of a running engine. the engine should always be off if adjustments are to be made to the distributor.
17. maintenance. for your safety, service and maintenance should be performed regularly by a qualified technician.

Note: performance of this tool may vary depending on variations in air pressure and compressor capability.

Brake fluid exchanger safety precautions

Caution: this equipment is designed to be operated by qualified and trained personnel. It should only be operated after reading and understanding the safety warnings and operating procedures in this instruction manual and vehicle's service manual.

1. Wear safety goggles.
2. Do not smoke near this equipment.
3. Use in a well ventilated area.
4. When leaks are found in the equipment or hoses, immediately turn the air pressure off and repair the leaks.
5. Immediately clean up any fluid spills or leaks.
6. Do not exceed the recommended operating air pressure. This could damage equipment. See specifications on page 2.
7. Do not use any cleaning compounds in this system.
8. Keep an empty plastic bucket nearby in case of fires.
9. Keep a type ABC fire extinguisher nearby in case of leaks.
10. Prior to using the brake fluid exchanger, make sure to read and understand all warnings, safety precautions, and instructions as outlined in the vehicle manufacturer's service manual. Every vehicle has specific brake bleeding requirements. It is beyond the scope of this manual to

properly describe the correct procedure for each vehicle.

11. Prior to using the Break Fluid Exchanger, make sure to place the vehicle's transmission in "PARK" (if automatic) or "NEUTRAL" (if manual), then, set the emergency parking brake and block the tires with chocks. }

12. Use the Break Fluid Exchanger only with brake fluid. Do not attempt to use the tool to siphon any other liquids. Contamination of brake fluid and possible break system failure may result.

13. follow guidelines for proper brake fluid disposal. Used brake fluid should be properly disposed of or recycled. many states require recycling. Contact your local solid/liquid waster authority for information on recycling. do not reuse old brake fluid.

14. do not use pressurized air to blow off brake dust. Only use brake parts cleaner to clean dust off of the brake calipers.

15. be alert for hot brake components and other hot vehicle components to avoid accidental burns.

16. some brake pads contain asbestos. Asbestosis, a chronic lung inflammation, can result from prolonged inhalation of asbestos particles. Accordingly, wear appropriate respiratory devices and proper protective clothing when working near any break pads.

17. always keep brake fluid from contacting the vehicle's paint finish. Brake fluid will damage the paint finish on vehicles.

Warning: the warnings, cautions, and instructions discussed in this instruction manual cannot cover all possible conditions and situations that may occur , it must be under-stood by the operator that common sense and caution are factors which cannot be built into this product ,but must be supplied by the operator.

Unpacking

When unpacking, check to make sure the following parts are included. If any parts are missing or broken ,please call Cannon Tools at the number on the cover of this manual as soon as possible.

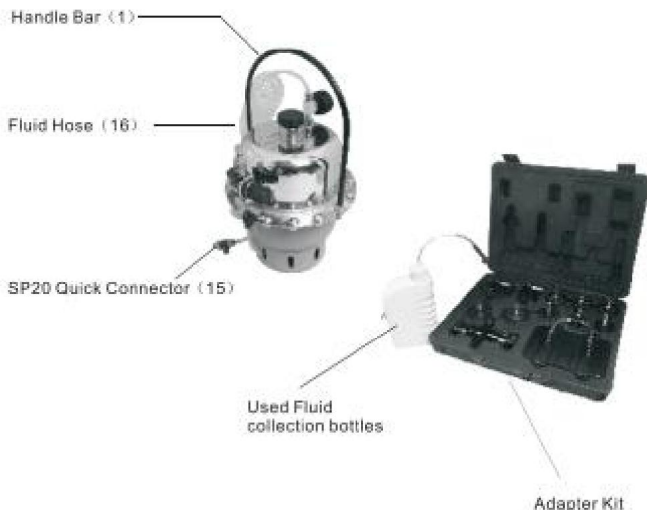

Operation

Preparation

1. Lase vehicle on a hoist or on secure vehicle stands in a well ventilated area.
2. set vehicle emergency brake and turn engine off.
3. remove the wheels and locate the drain connection on the brake cylinders. Refer to the vehicle manufacturer's maintenance manual for their location.
4. turn on the air compressor (not supplied) and place its hose next to the Break Fluid Exchanger (the air compressor should have a moisture filter installed on it. See illustration on the top of page 6.)

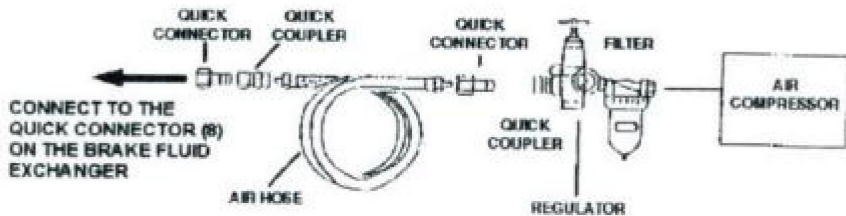

Controls and Indicators

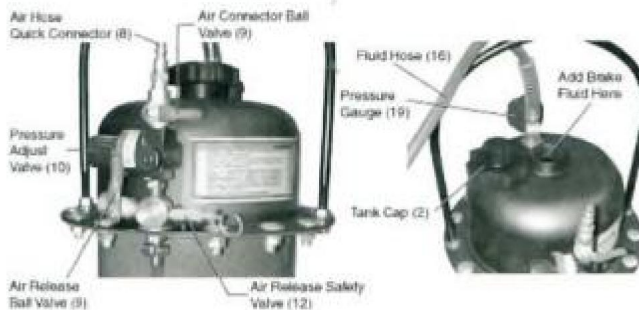

Bleeding brakes and adding new fluid

Warning: the vehicle engine must never be started in a closed garage, or any other sealed structure. Carbon monoxide is produced during operation and is deadly in a closed environment. Early signs of carbon monoxide poisoning resemble the flu, with headaches, dizziness, or nausea..if you have any of these signs get fresh air immediately.

1. Place the Brake Fluid Exchanger near the vehicle and remove the Tank Cap(2)
2. Open and secure the engine hood and find the Master Cylinder.
3. Remove the Master Cylinder Lid.
4. Open the Adapter Kit and find the Adapter Lid that looks like, and best fits, the Master Cylinder.

Refer to the Adapter Kit Parts List at the end of this manual. The temporary Adapter Lid should have the from of the Master Cylinder Lid with the addition of a connector inlet for the Fluid Hose(16).In some instances, a universal Lid (E1,F1,or F2) may need to be used where other Adapters will not fit. Use the mounting loop cables and hardware provided with the

Adapter to secure the universal Lid.

5. Secure the Adapter Lid to the Master Cylinder.

6. Unscrew and remove the Tank Cap(2), then pour in the appropriate amount of new brake fluid. Refer to the vehicle manufacturer's service manual for the correct amount and type of fluid. Screw in the Tank Cap(2) tightly.

7. Insert the Fluid Hose(16) Quick Connector(15) onto the temporary Master Cylinder Adapter Lid. Make sure that's Ball valve(9) is in the closed position (sideways to the direction of the Fluid Hose).

8. Remove the Drain Screws from the rear brake cylinder, and insert clear rubber tube(not supplied) in to the drain holes. Press fit the rubber connector of the Used Fluid Bottles into the other end of the clear rubber tube

Note: The Used Fluid Bottles can be connected directly to the brake cylinders drain, but you will not be able to see the color of the fluid the bottles (darker is old, lighter is new).

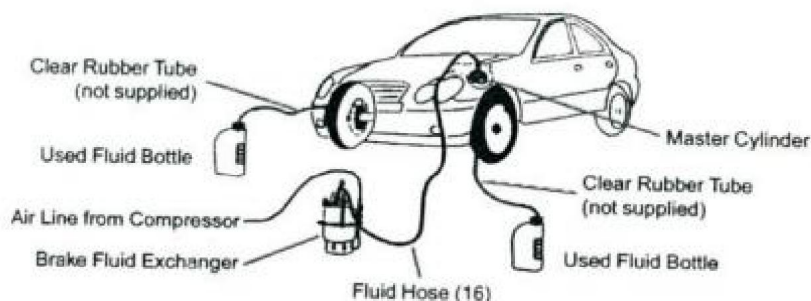

9. Connect the air line hose(not supplied) to the Air Hose Quick Connector (8) on the Brake Fluid Exchanger.

10. Set the Air Connector Ball Valve(9) to the ON(vertical) position.

11. Pull out on the Pressure Adjust Valve(10) knob, and while viewing the Pressure Gauge(19), turn the knob to adjust the Tank pressure to between 20 to 40 PSI

Caution: Never exceed 40 PSI or damage may occur to equipment and connection hoses.

12. Slowly open (in line with hose) the Fluid Hose (16) Ball Valve (9) on top of the Master Cylinder.

This begins the process of forcing the new fluid in, and while old fluid out and into the Used Fluid Bottles. Check for leaks at all connection Points. If leaks and continue.

13. During the fluid transfer, press in quickly on the brake pedal in the vehicle, and release slowly do this a few times.

14. When the Used Fluid Bottles are full, or the fluid color has changed from dark to light as seen through

15. Remove the Used Fluid Bottles or Clear Rubber Tubes connected to the brake cylinder and return screws to the drain holes.

16. Empty the Used Fluid Bottles into a fluid recycle tank, or in other bottles for proper disposal.

17. Repeat steps 8 through 15 the front brake cylinders.

18. When the fluid transfer of the front brake cylinders is complete, turn the Ball Valve(9) on the Master Cylinder to the Off(sideways) position, and remove the Fluid Hose(16) from the Master Cylinder lid.

Adding New Fluid to Vehicles with ABS Brake Systems

1. Follow all the previous steps, with these exceptions.

2. Remove the drain screw for only on the brake cylinder at a time, and drain that brake cylinder.

3. Place the vehicle transmission in Park, and start the engine during this process. When adding new fluid is complete, turn the engine off.

4. Remove the Used fluid bottle or Clear Rubber Tube connected to that brake cylinder and

return screw to the drain hole.
5. Repeat for each brake cylinder individually.

Steps When Finished Bleeding Brakes and Adding New Fluid

1. Replace the original Master Cylinder lid.
2. Remove the air input line from Air hose Quick Connector(8) on the Tank.
3. Open the Air release Ball Valve(9) on the Tank, and pull on the Air Release Safety Valve(12) to depressurize the Tank.
4. Empty the Used Fluid Bottles into a fluid recycle tank, or in other bottles for proper disposal.

WARNING: Before driving the vehicle, depress the brake pedal repeatedly until the brake pedal feels firm. Check the brake calipers for leaks. Then, test the brakes thoroughly at slow speed before operating the vehicle under normal conditions.

Maintenance

Caution: Before performing any maintenance on the Brake Fluid Exchanger, verify that the Brake Fluid Exchanger is depressurized.

1. Clean up any brake fluid oil that may have spilled.
2. Wipe down the Brake Fluid Exchanger components with a cloth.
3. Store the unit in a clean and dry location.

Brake fluid Exchanger Parts List

1	Handle Bar	1	10	Connector	2
2	Cap, Tank	1	11	Valve, Safety, Air Release	1
3	Tank, Upper Half	1	12	Connector	1
4	Rubber Membrane	1	13	Tube	1
5	Tank, lower Half	1	14	Connector, Quick Fluid	1
6	Connector, PL802L	1	15	Hose, Fluid	1
7	Connector, Quick	1	16	Coupler	1
8	Valve, Ball, 1/4"	3	17	Gauge, Pressure	1
9	Valve, Pressure Adjust	1	18	Coupler, Pressure Gauge	1

NOTE: Some parts are listed and shown for illustration purposes only and are not available individually as replacement parts.

Brake Fluid Exchanger Assembly Drawing

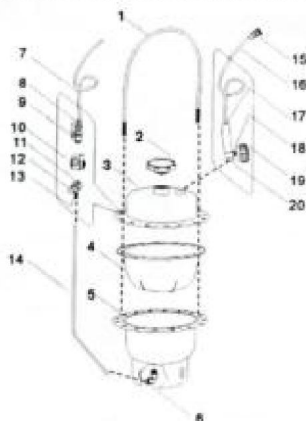

Adapter Kit Parts List

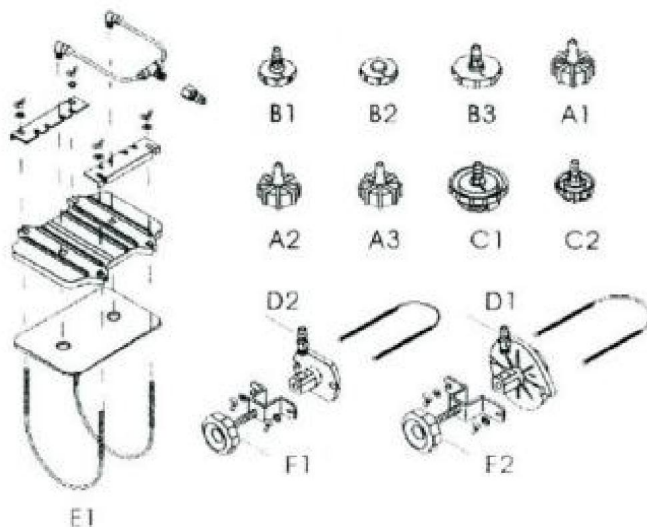

PLEASE READ THE FOLLOWING CAREFULLY

THE MANUFACTURER AND/OR DISTRIBUTOR HAS PROVIDED THE PARTS DIAGRAM IN THIS MANUAL AS A REFERENCE TOOL ONLY. NEITHER THE MANUFACTURER NOR DISTRIBUTOR MAKES ANY REPRESENTATION OR WARRANTY OF ANY KIND TO THE BUYER THAT HE OR SHE IS QUALIFIED TO MAKE ANY REPAIRS TO THE PRODUCT OR THAT HE OR SHE IS QUALIFIED TO REPLACE ANY PARTS OF THE PRODUCT. IN FACT, THE MANUFACTURER AND/OR DISTRIBUTOR EXPRESSLY STATES THAT ALL REPAIRS AND PARTS REPLACEMENTS SHOULD BE UNDERTAKEN BY CERTIFIED AND LICENSED TECHNICIANS AND NOT BY THE BUYER. THE BUYER ASSUMES ALL RISK AND LIABILITY ARISING OUT OF HIS OR HER REPAIRS TO THE ORIGINAL PRODUCT OR REPLACEMENT PARTS THERE TO, OR ARISING OUT OF HIS OR HER INSTALLATION OF REPLACEMENT PARTS THERE TO.

Adres: Shuangchenglu 803nong11hao1602A-1609shi, Baoshanqu, Szanghaj 200000 CN.

Importowane do AUS: SIHAO PTY LTD. 1 ROKEVA STREETEASTWOOD NSW 2122 Australia

Importowane do USA: Sanven Technology Ltd. Suite 250, 9166 Anaheim Place, Rancho Cucamonga, CA 91730

REP WIELKIEJ BRYTANII	
-----------------------	--

YH CONSULTING LIMITED. C/O YH Consulting Limited Biuro
147, Centurion House, London Road, Staines-upon-
Thames, Surrey, TW18 4AX

Przedstawiciel UE	
-------------------	--

E-CrossStu GmbH
Mainzer Landstr.69,
60329 Frankfurt nad Menem.

VEVOR[®]
TOUGH TOOLS, HALF PRICE

Wsparcie techniczne i certyfikat gwarancji
elektronicznej www.vevor.com/support



Teknisk support och e-garanticertifikat

www.vevor.com/support

BROMS/KOPPLING BLÄDER SET

MODELL:BC-105

Vi fortsätter att vara engagerade i att ge dig verktyg till konkurrenskraftiga priser.

"Spara halva", "halva priset" eller andra liknande uttryck som används av oss representerar endast en uppskattning av besparingar du kan dra nytta av att köpa vissa verktyg hos oss jämfört med de stora toppmärkena och betyder inte nödvändigtvis att täcka alla kategorier av verktyg som erbjuds av oss. Du påminns vänligen om att noggrant kontrollera när du gör en beställning hos oss om du faktiskt sparar hälften i jämförelse med de främsta stora varumärkena.

VEVOR®
TOUGH TOOLS, HALF PRICE

BROMS/KOPPLING BLÄDER SET

MODELL:BC-105



BEHÖVER HJÄLP? KONTAKTA OSS!

Har du produktfrågor? Behöver du teknisk support? Kontakta oss gärna: **Teknisk support och e-**
garanticertifikat www.vevor.com/support

Detta är den ursprungliga instruktionen, läs alla instruktioner noggrant innan du använder den. VEVOR reserverar sig för en tydlig tolkning av vår användarmanual. Utseendet på produkten är beroende av den produkt du fått. Ursäkta oss att vi inte kommer att informera dig igen om det finns någon teknik eller mjukvaruuppdateringar på vår produkt.

PARAMETERLISTA

Modell	BC-105
Tryckområde	10-40psi
Kapacitet	5L
nettovikt (kg)	7.5

Save this manual

You will need manual for the safety warnings and precautions , assembly instructions, operating and maintenance procedures , parts list and diagram, keep your invoice with this manual .write the invoice number on the inside of the front cover. Keep the manual and invoice in a safe and dry place for future reference.

Safety warnings and precautions

Warning : when using tool ,basic safety precautions should always be followed to reduce the risk of personal injury and damage to equipment. Read all instructions before using this tool!

1. Keep work area clean .cluttered areas invite injuries.
2. Observe work area condition. Do not use machines or power tools in damp or wet locations. Don't expose to rain. Keep work area well lighted. Do not use electrically powered tools in the presence of flammable gases or liquids.
3. Keep children away. Children must never be allowed in the work area. Do not let them handle machines, tools or extension cords.
4. Store idle equipment. When not in use ,tools must be stored in a dry location to inhibit rust. Always lock up tools and keep out of reach of children.
5. Use the right tool for the job. Do not attempt to force a small tool or attachment to do the work of a larger industrial tool. There are certain applications for which this tool was designed. It will do the job better and more safely at the rate for which it was intended. Do

- not modify this tool and do not use this tool for a purpose for which it was not intended.
6. Dress properly. Do not wear loose clothing or jewelry as they can be caught in moving parts. Protective, electrically non-conductive clothes and non-skid footwear are recommended when working. Wear restrictive hair covering to contain long hair.
7. Use eye and ear protection. Always wear ANSI approved impact safety goggles.
8. Do not overreach. Keep proper footing and balance at all times, do not reach over or across running machines.
9. Maintain tools with care. Inspect tool cords and hoses periodically and, if damaged, have them replaced, or repaired by an authorized technician. The handles must be kept clean, dry, and free from oil and grease at all times.
10. Remove adjusting keys and wrenches. Check that keys and adjusting wrenches are removed from the tool or machine work surface before operating.
11. Avoid unintentional starting. Be sure the air pressure is in the off position when not in use and before making hose connections.
12. Stay alert. Watch what you are doing, use common sense. Do not operate any tool when you are tired.
13. Check for damaged parts. Before using any tool, any part that appears damaged should be carefully checked to determine that it will operate properly and perform its intended function. Check for alignment and binding of moving parts; any broken parts or mounting fixtures; and any other condition that may affect proper operation any part that is damaged should be properly repaired or replaced by a qualified technician. Do not use the tool if any control or switch does operate properly.
14. Replacement parts and accessories. When servicing, use only identical replacement parts. Use of any other parts will void the warranty. Only use accessories intended for use with this tool. Approved accessories are available from Harbor Freight Tools.
15. Do not operate tool if under the influence of alcohol or drugs. Read warning labels if taking prescription medicine to determine if your judgment or reflexes are impaired while taking drugs. If there is any doubt, do not operate the tool.
16. Pacemaker safety warning. People with pacemakers should consult their physician(s) before using this product. Electromagnetic fields in close proximity to a heart pacemaker could cause interference to, or failure of the pacemaker. In addition, people with pacemakers should adhere to the following:
 - caution is necessary when near the coil, spark plug cables, or distributor of a running engine. the engine should always be off if adjustments are to be made to the distributor.
17. maintenance. for your safety, service and maintenance should be performed regularly by a qualified technician.

Note: performance of this tool may vary depending on variations in air pressure and compressor capability.

Brake fluid exchanger safety precautions

Caution: this equipment is designed to be operated by qualified and trained personnel. It should only be operated after reading and understanding the safety warnings and operating procedures in this instruction manual and vehicle's service manual.

1. Wear safety goggles.
2. Do not smoke near this equipment.
3. Use in a well ventilated area.
4. When leaks are found in the equipment or hoses, immediately turn the air pressure off and repair the leaks.
5. Immediately clean up any fluid spills or leaks.
6. Do not exceed the recommended operating air pressure. This could damage equipment. See specifications on page 2.
7. Do not use any cleaning compounds in this system.
8. Keep an empty plastic bucket nearby in case of fires
9. Keep a type ABC fire extinguisher nearby in case of leaks.
10. Prior to using the brake fluid exchanger, make sure to read and understand all warnings, safety precautions, and instructions as outlined in the vehicle manufacturer's service manual. Every vehicle has specific brake bleeding requirements. It is beyond the scope of this manual to

properly describe the correct procedure for each vehicle.

11. Prior to using the Break Fluid Exchanger, make sure to place the vehicle's transmission in "PARK" (if automatic) or "NEUTRAL" (if manual), then, set the emergency parking brake and block the tires with chocks. }

12. Use the Break Fluid Exchanger only with brake fluid. Do not attempt to use the tool to siphon any other liquids. Contamination of brake fluid and possible break system failure may result.

13. follow guidelines for proper brake fluid disposal. Used brake fluid should be properly disposed of or recycled. many states require recycling. Contact your local solid/liquid waster authority for information on recycling. do not reuse old brake fluid.

14. do not use pressurized air to blow off brake dust. Only use brake parts cleaner to clean dust off of the brake calipers.

15. be alert for hot brake components and other hot vehicle components to avoid accidental burns.

16. some brake pads contain asbestos. Asbestosis, a chronic lung inflammation, can result from prolonged inhalation of asbestos particles. Accordingly, wear appropriate respiratory devices and proper protective clothing when working near any break pads.

17. always keep brake fluid from contacting the vehicle's paint finish. Brake fluid will damage the paint finish on vehicles.

Warning: the warnings, cautions, and instructions discussed in this instruction manual cannot cover all possible conditions and situations that may occur , it must be under-stood by the operator that common sense and caution are factors which cannot be built into this product ,but must be supplied by the operator.

Unpacking

When unpacking, check to make sure the following parts are included. If any parts are missing or broken ,please call Cannon Tools at the number on the cover of this manual as soon as possible.

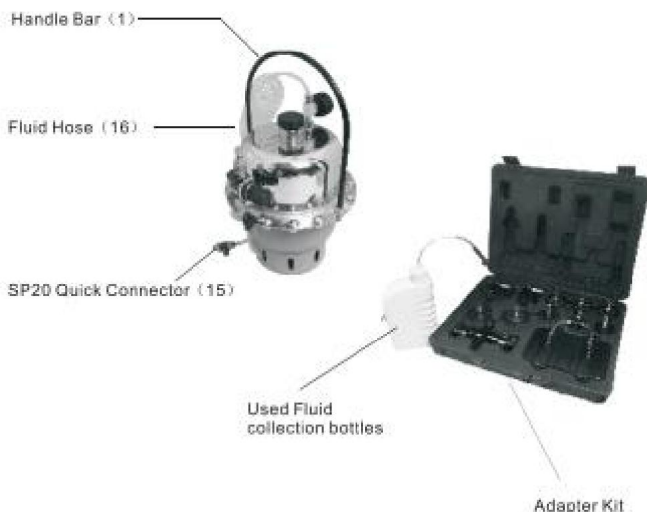

Operation

Preparation

1. Lase vehicle on a hoist or on secure vehicle stands in a well ventilated area.
2. set vehicle emergency brake and turn engine off.
3. remove the wheels and locate the drain connection on the brake cylinders. Refer to the vehicle manufacturer's maintenance manual for their location.
4. turn on the air compressor (not supplied) and place its hose next to the Break Fluid Exchanger (the air compressor should have a moisture filter installed on it. See illustration on the top of page 6.)

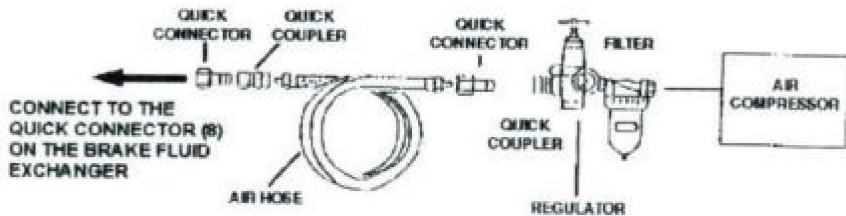

Controls and Indicators

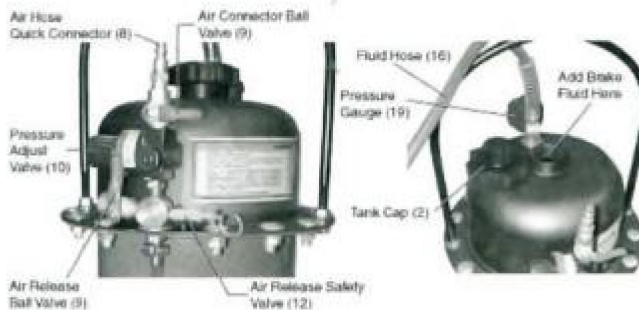

Bleeding brakes and adding new fluid

Warning: the vehicle engine must never be started in a closed garage, or any other sealed structure. Carbon monoxide is produced during operation and is deadly in a closed environment. Early signs of carbon monoxide poisoning resemble the flu, with headaches, dizziness, or nausea..if you have any of these signs get fresh air immediately.

1. Place the Brake Fluid Exchanger near the vehicle and remove the Tank Cap(2)
2. Open and secure the engine hood and find the Master Cylinder.
3. Remove the Master Cylinder Lid.
4. Open the Adapter Kit and find the Adapter Lid that looks like, and best fits, the Master Cylinder.

Refer to the Adapter Kit Parts List at the end of this manual. The temporary Adapter Lid should have the from of the Master Cylinder Lid with the addition of a connector inlet for the Fluid Hose(16).In some instances, a universal Lid (E1,F1,or F2) may need to be used where other Adapters will not fit. Use the mounting loop cables and hardware provided with the

Adapter to secure the universal Lid.

5. Secure the Adapter Lid to the Master Cylinder.

6. Unscrew and remove the Tank Cap(2), then pour in the appropriate amount of new brake fluid. Refer to the vehicle manufacturer's service manual for the correct amount and type of fluid. Screw in the Tank Cap(2) tightly.

7. Insert the Fluid Hose(16) Quick Connector(15) onto the temporary Master Cylinder Adapter Lid. Make sure that's Ball valve(9) is in the closed position (sideways to the direction of the Fluid Hose).

8. Remove the Drain Screws from the rear brake cylinder, and insert clear rubber tube(not supplied) in to the drain holes. Press fit the rubber connector of the Used Fluid Bottles into the other end of the clear rubber tube

Note: The Used Fluid Bottles can be connected directly to the brake cylinders drain, but you will not be able to see the color of the fluid the bottles (darker is old, lighter is new).

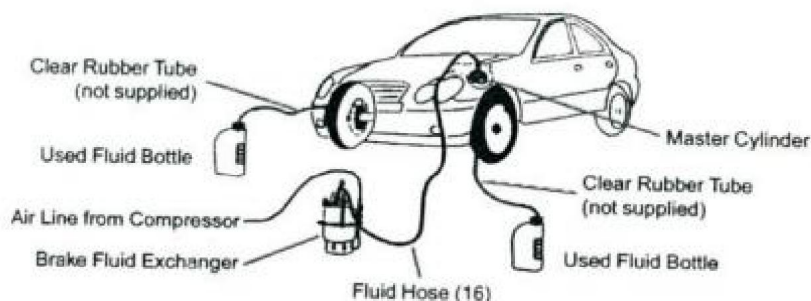

9. Connect the air line hose(not supplied) to the Air Hose Quick Connector (8) on the Brake Fluid Exchanger.

10. Set the Air Connector Ball Valve(9) to the ON(vertical) position.

11. Pull out on the Pressure Adjust Valve(10) knob, and while viewing the Pressure Gauge(19), turn the knob to adjust the Tank pressure to between 20 to 40 PSI

Caution: Never exceed 40 PSI or damage may occur to equipment and connection hoses.

12. Slowly open (in line with hose) the Fluid Hose (16) Ball Valve (9) on top of the Master Cylinder.

This begins the process of forcing the new fluid in, and while old fluid out and into the Used Fluid Bottles. Check for leaks at all connection Points. If leaks and continue.

13. During the fluid transfer, press in quickly on the brake pedal in the vehicle, and release slowly do this a few times.

14. When the Used Fluid Bottles are full, or the fluid color has changed from dark to light as seen through

15. Remove the Used Fluid Bottles or Clear Rubber Tubes connected to the brake cylinder and return screws to the drain holes.

16. Empty the Used Fluid Bottles into a fluid recycle tank, or in other bottles for proper disposal.

17. Repeat steps 8 through 15 the front brake cylinders.

18. When the fluid transfer of the front brake cylinders is complete, turn the Ball Valve(9) on the Master Cylinder to the Off(sideways) position, and remove the Fluid Hose(16) from the Master Cylinder lid.

Adding New Fluid to Vehicles with ABS Brake Systems

1. Follow all the previous steps, with these exceptions.

2. Remove the drain screw for only on the brake cylinder at a time, and drain that brake cylinder.

3. Place the vehicle transmission in Park, and start the engine during this process. When adding new fluid is complete, turn the engine off.

4. Remove the Used fluid bottle or Clear Rubber Tube connected to that brake cylinder and

return screw to the drain hole.
5. Repeat for each brake cylinder individually.

Steps When Finished Bleeding Brakes and Adding New Fluid

1. Replace the original Master Cylinder lid.
2. Remove the air input line from Air hose Quick Connector(8) on the Tank.
3. Open the Air release Ball Valve(9) on the Tank, and pull on the Air Release Safety Valve(12) to depressurize the Tank.
4. Empty the Used Fluid Bottles into a fluid recycle tank, or in other bottles for proper disposal.

WARNING: Before driving the vehicle, depress the brake pedal repeatedly until the brake pedal feels firm. Check the brake calipers for leaks. Then, test the brakes thoroughly at slow speed before operating the vehicle under normal conditions.

Maintenance

Caution: Before performing any maintenance on the Brake Fluid Exchanger, verify that the Brake Fluid Exchanger is depressurized.

1. Clean up any brake fluid oil that may have spilled.
2. Wipe down the Brake Fluid Exchanger components with a cloth.
3. Store the unit in a clean and dry location.

Brake fluid Exchanger Parts List

1	Handle Bar	1	10	Connector	2
2	Cap, Tank	1	11	Valve, Safety, Air Release	1
3	Tank, Upper Half	1	12	Connector	1
4	Rubber Membrane	1	13	Tube	1
5	Tank, lower Half	1	14	Connector, Quick Fluid	1
6	Connector, PL802L	1	15	Hose, Fluid	1
7	Connector, Quick	1	16	Coupler	1
8	Valve, Ball, 1/4"	3	17	Gauge, Pressure	1
9	Valve, Pressure Adjust	1	18	Coupler, Pressure Gauge	1

NOTE: Some parts are listed and shown for illustration purposes only and are not available individually as replacement parts.

Brake Fluid Exchanger Assembly Drawing

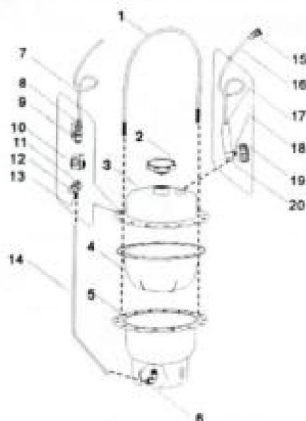

Adapter Kit Parts List

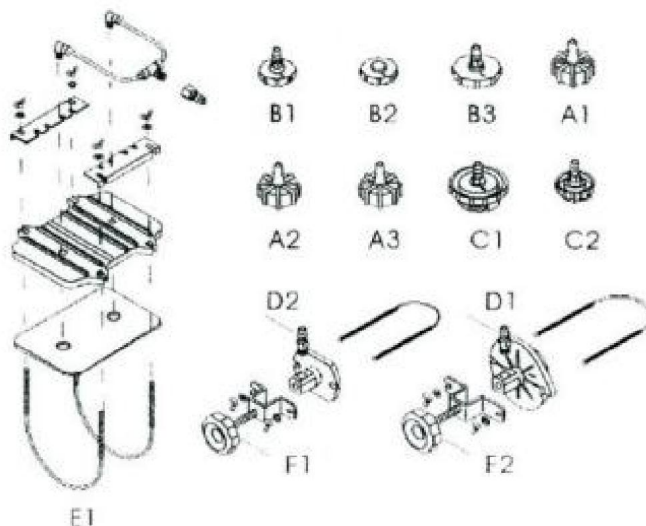

PLEASE READ THE FOLLOWING CAREFULLY

THE MANUFACTURER AND/OR DISTRIBUTOR HAS PROVIDED THE PARTS DIAGRAM IN THIS MANUAL AS A REFERENCE TOOL ONLY. NEITHER THE MANUFACTURER NOR DISTRIBUTOR MAKES ANY REPRESENTATION OR WARRANTY OF ANY KIND TO THE BUYER THAT HE OR SHE IS QUALIFIED TO MAKE ANY REPAIRS TO THE PRODUCT OR THAT HE OR SHE IS QUALIFIED TO REPLACE ANY PARTS OF THE PRODUCT. IN FACT, THE MANUFACTURER AND/OR DISTRIBUTOR EXPRESSLY STATES THAT ALL REPAIRS AND PARTS REPLACEMENTS SHOULD BE UNDERTAKEN BY CERTIFIED AND LICENSED TECHNICIANS AND NOT BY THE BUYER. THE BUYER ASSUMES ALL RISK AND LIABILITY ARISING OUT OF HIS OR HER REPAIRS TO THE ORIGINAL PRODUCT OR REPLACEMENT PARTS THERE TO, OR ARISING OUT OF HIS OR HER INSTALLATION OF REPLACEMENT PARTS THERE TO.

Adress: Shuangchenglu 803nong11hao1602A-1609shi, Baoshanqu, Shanghai 200000 CN.

Importerad till AUS: SIHAO PTY LTD. 1 ROKEVA STREETEASTWOOD NSW 2122 Australien

Importerad till USA: Sanven Technology Ltd. Suite 250, 9166 Anaheim Place, Rancho Cucamonga, CA 91730



YH CONSULTING LIMITED. C/O YH Consulting Limited
Office 147, Centurion House, London Road, Staines-
upon-Thames, Surrey, TW18 4AX



E-CrossStu GmbH
Mainzer Landstr.69,
60329 Frankfurt am Main.

VEVOR[®]
TOUGH TOOLS, HALF PRICE

Teknisk support och e-garanticertifikat
www.vevor.com/support



Technische ondersteuning en e-garantiecertificaat

www.vevor.com/support

REM/KOPPELING ONTLUCHTINGSSET

MODEL:BC-105

Wij streven er voortdurend naar om u gereedschappen tegen concurrerende prijzen te leveren.

"Save Half", "Half Price" of andere soortgelijke uitdrukkingen die wij gebruiken, geven alleen een schatting van de besparingen die u kunt behalen door bepaalde gereedschappen bij ons te kopen in vergelijking met de grote topmerken en betekent niet noodzakelijkerwijs dat alle categorieën gereedschappen die wij aanbieden, worden gedekt. Wij herinneren u eraan om zorgvuldig te controleren of u daadwerkelijk de helft bespaart in vergelijking met de grote topmerken wanneer u een bestelling bij ons plaatst.

VEVOR®
TOUGH TOOLS, HALF PRICE

REM/KOPPELING
ONTLUCHTINGSSET

MODEL:BC-105



HULP NODIG? NEEM CONTACT MET ONS OP!

Heeft u vragen over het product? Heeft u technische ondersteuning nodig? Neem dan gerust contact met

ons op: **Technische ondersteuning en E-garantiecertificaat**
www.vevor.com/support

Dit is de originele instructie, lees alle handleidingen zorgvuldig door voordat u het product gebruikt. VEVOR behoudt zich een duidelijke interpretatie van onze gebruikershandleiding voor. Het uiterlijk van het product is afhankelijk van het product dat u hebt ontvangen. Vergeef ons dat we u niet opnieuw zullen informeren als er technologie- of software-updates voor ons product zijn.

PARAMETERLIJST

Model	BC-105
Drukbereik	10-40psi
Capaciteit	5L
nettogewicht (kg)	7.5

Save this manual

You will need manual for the safety warnings and precautions , assembly instructions, operating and maintenance procedures , parts list and diagram, keep your invoice with this manual .write the invoice number on the inside of the front cover. Keep the manual and invoice in a safe and dry place for future reference.

Safety warnings and precautions

Warning : when using tool ,basic safety precautions should always be followed to reduce the risk of personal injury and damage to equipment. Read all instructions before using this tool!

1. Keep work area clean .cluttered areas invite injuries.
2. Observe work area condition. Do not use machines or power tools in damp or wet locations. Don't expose to rain. Keep work area well lighted. Do not use electrically powered tools in the presence of flammable gases or liquids.
3. Keep children away. Children must never be allowed in the work area. Do not let them handle machines, tools or extension cords.
4. Store idle equipment. When not in use ,tools must be stored in a dry location to inhibit rust. Always lock up tools and keep out of reach of children.
5. Use the right tool for the job. Do not attempt to force a small tool or attachment to do the work of a larger industrial tool. There are certain applications for which this tool was designed. It will do the job better and more safely at the rate for which it was intended. Do

- not modify this tool and do not use this tool for a purpose for which it was not intended.
6. Dress properly. Do not wear loose clothing or jewelry as they can be caught in moving parts. Protective, electrically non-conductive clothes and non-skid footwear are recommended when working. Wear restrictive hair covering to contain long hair.
7. Use eye and ear protection. Always wear ANSL approved impact safety goggles.
8. Do not overreach. Keep proper footing and balance at all times, do not reach over or across running machines.
9. Maintain tools with care. Inspect tool cords and hoses periodically and, if damaged, have them replaced, or repaired by an authorized technician. The handles must be kept clean, dry, and free from oil and grease at all times.
10. Remove adjusting keys and wrenches. Check that keys and adjusting wrenches are removed from the tool or machine work surface before operating.
11. Avoid unintentional starting. Be sure the air pressure is in the off position when not in use and before making hose connections.
12. Stay alert. Watch what you are doing, use common sense. Do not operate any tool when you are tired.
13. Check for damaged parts. Before using any tool, any part that appears damaged should be carefully checked to determine that it will operate properly and perform its intended function. Check for alignment and binding of moving parts; any broken parts or mounting fixtures; and any other condition that may affect proper operation any part that is damaged should be properly repaired or replaced by a qualified technician. Do not use the tool if any control or switch does operate properly.
14. Replacement parts and accessories. When servicing, use only identical replacement parts. Use of any other parts will void the warranty. Only use accessories intended for use with this tool. Approved accessories are available from Harbor Freight Tools.
15. Do not operate tool if under the influence of alcohol or drugs. Read warning labels if taking prescription medicine to determine if your judgment or reflexes are impaired while taking drugs. If there is any doubt, do not operate the tool.
16. Pacemaker safety warning. People with pacemakers should consult their physician(s) before using this product. Electromagnetic fields in close proximity to a heart pacemaker could cause interference to, or failure of the pacemaker. In addition, people with pacemakers should adhere to the following:
 - caution is necessary when near the coil, spark plug cables, or distributor of a running engine. the engine should always be off if adjustments are to be made to the distributor.
17. maintenance. for your safety, service and maintenance should be performed regularly by a qualified technician.

Note: performance of this tool may vary depending on variations in air pressure and compressor capability.

Brake fluid exchanger safety precautions

Caution: this equipment is designed to be operated by qualified and trained personnel. It should only be operated after reading and understanding the safety warnings and operating procedures in this instruction manual and vehicle's service manual.

1. Wear safety goggles.
2. Do not smoke near this equipment.
3. Use in a well ventilated area.
4. When leaks are found in the equipment or hoses, immediately turn the air pressure off and repair the leaks.
5. Immediately clean up any fluid spills or leaks.
6. Do not exceed the recommended operating air pressure. This could damage equipment. See specifications on page 2.
7. Do not use any cleaning compounds in this system.
8. Keep an empty plastic bucket nearby in case of fires
9. Keep a type ABC fire extinguisher nearby in case of leaks.
10. Prior to using the brake fluid exchanger, make sure to read and understand all warnings, safety precautions, and instructions as outlined in the vehicle manufacturer's service manual. Every vehicle has specific brake bleeding requirements. It is beyond the scope of this manual to

properly describe the correct procedure for each vehicle.

11. Prior to using the Break Fluid Exchanger, make sure to place the vehicle's transmission in "PARK" (if automatic) or "NEUTRAL" (if manual), then, set the emergency parking brake and block the tires with chocks. }

12. Use the Break Fluid Exchanger only with brake fluid. Do not attempt to use the tool to siphon any other liquids. Contamination of brake fluid and possible break system failure may result.

13. follow guidelines for proper brake fluid disposal. Used brake fluid should be properly disposed of or recycled. many states require recycling. Contact your local solid/liquid waster authority for information on recycling. do not reuse old brake fluid.

14. do not use pressurized air to blow off brake dust. Only use brake parts cleaner to clean dust off of the brake calipers.

15. be alert for hot brake components and other hot vehicle components to avoid accidental burns.

16. some brake pads contain asbestos. Asbestosis, a chronic lung inflammation, can result from prolonged inhalation of asbestos particles. Accordingly, wear appropriate respiratory devices and proper protective clothing when working near any break pads.

17. always keep brake fluid from contacting the vehicle's paint finish. Brake fluid will damage the paint finish on vehicles.

Warning: the warnings, cautions, and instructions discussed in this instruction manual cannot cover all possible conditions and situations that may occur , it must be under-stood by the operator that common sense and caution are factors which cannot be built into this product ,but must be supplied by the operator.

Unpacking

When unpacking, check to make sure the following parts are included. If any parts are missing or broken ,please call Cannon Tools at the number on the cover of this manual as soon as possible.

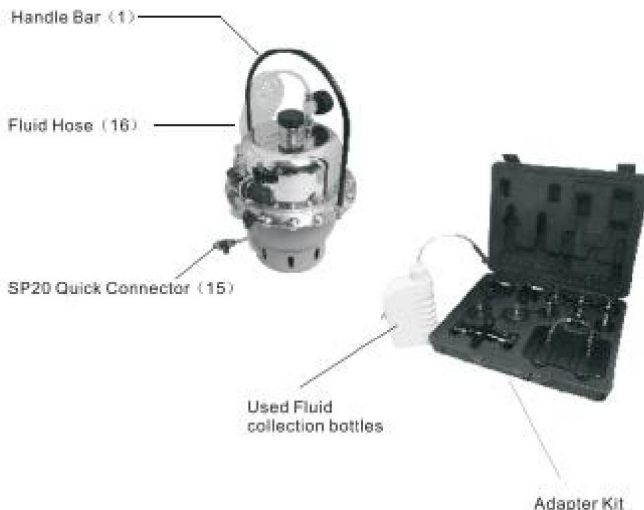

Operation

Preparation

1. Lase vehicle on a hoist or on secure vehicle stands in a well ventilated area.
2. set vehicle emergency brake and turn engine off.
3. remove the wheels and locate the drain connection on the brake cylinders. Refer to the vehicle manufacturer's maintenance manual for their location.
4. turn on the air compressor (not supplied) and place its hose next to the Break Fluid Exchanger (the air compressor should have a moisture filter installed on it. See illustration on the top of page 6.)

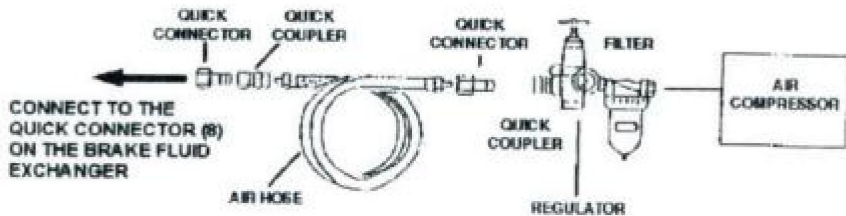

Controls and Indicators

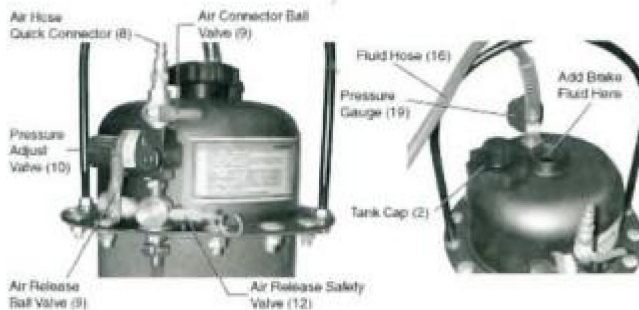

Bleeding brakes and adding new fluid

Warning: the vehicle engine must never be started in a closed garage, or any other sealed structure. Carbon monoxide is produced during operation and is deadly in a closed environment. Early signs of carbon monoxide poisoning resemble the flu, with headaches, dizziness, or nausea..if you have any of these signs get fresh air immediately.

1. Place the Brake Fluid Exchanger near the vehicle and remove the Tank Cap(2)
2. Open and secure the engine hood and find the Master Cylinder.
3. Remove the Master Cylinder Lid.
4. Open the Adapter Kit and find the Adapter Lid that looks like, and best fits, the Master Cylinder.

Refer to the Adapter Kit Parts List at the end of this manual. The temporary Adapter Lid should have the from of the Master Cylinder Lid with the addition of a connector inlet for the Fluid Hose(16).In some instances, a universal Lid (E1,F1,or F2) may need to be used where other Adapters will not fit. Use the mounting loop cables and hardware provided with the

Adapter to secure the universal Lid.

5. Secure the Adapter Lid to the Master Cylinder.

6. Unscrew and remove the Tank Cap(2), then pour in the appropriate amount of new brake fluid. Refer to the vehicle manufacturer's service manual for the correct amount and type of fluid. Screw in the Tank Cap(2) tightly.

7. Insert the Fluid Hose(16) Quick Connector(15) onto the temporary Master Cylinder Adapter Lid. Make sure that's Ball valve(9) is in the closed position (sideways to the direction of the Fluid Hose).

8. Remove the Drain Screws from the rear brake cylinder, and insert clear rubber tube(not supplied) in to the drain holes. Press fit the rubber connector of the Used Fluid Bottles into the other end of the clear rubber tube

Note: The Used Fluid Bottles can be connected directly to the brake cylinders drain, but you will not be able to see the color of the fluid the bottles (darker is old, lighter is new).

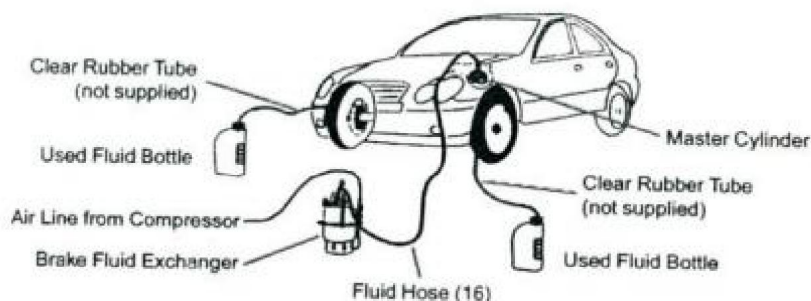

9. Connect the air line hose(not supplied) to the Air Hose Quick Connector (8) on the Brake Fluid Exchanger.

10. Set the Air Connector Ball Valve(9) to the ON(vertical) position.

11. Pull out on the Pressure Adjust Valve(10) knob, and while viewing the Pressure Gauge(19), turn the knob to adjust the Tank pressure to between 20 to 40 PSI

Caution: Never exceed 40 PSI or damage may occur to equipment and connection hoses.

12. Slowly open (in line with hose) the Fluid Hose (16) Ball Valve (9) on top of the Master Cylinder.

This begins the process of forcing the new fluid in, and while old fluid out and into the Used Fluid Bottles. Check for leaks at all connection Points. If leaks and continue.

13. During the fluid transfer, press in quickly on the brake pedal in the vehicle, and release slowly do this a few times.

14. When the Used Fluid Bottles are full, or the fluid color has changed from dark to light as seen through

15. Remove the Used Fluid Bottles or Clear Rubber Tubes connected to the brake cylinder and return screws to the drain holes.

16. Empty the Used Fluid Bottles into a fluid recycle tank, or in other bottles for proper disposal.

17. Repeat steps 8 through 15 the front brake cylinders.

18. When the fluid transfer of the front brake cylinders is complete, turn the Ball Valve(9) on the Master Cylinder to the Off(sideways) position, and remove the Fluid Hose(16) from the Master Cylinder lid.

Adding New Fluid to Vehicles with ABS Brake Systems

1. Follow all the previous steps, with these exceptions.

2. Remove the drain screw for only on the brake cylinder at a time, and drain that brake cylinder.

3. Place the vehicle transmission in Park, and start the engine during this process. When adding new fluid is complete, turn the engine off.

4. Remove the Used fluid bottle or Clear Rubber Tube connected to that brake cylinder and

return screw to the drain hole.
5. Repeat for each brake cylinder individually.

Steps When Finished Bleeding Brakes and Adding New Fluid

1. Replace the original Master Cylinder lid.
2. Remove the air input line from Air hose Quick Connector(8) on the Tank.
3. Open the Air release Ball Valve(9) on the Tank, and pull on the Air Release Safety Valve(12) to depressurize the Tank.
4. Empty the Used Fluid Bottles into a fluid recycle tank, or in other bottles for proper disposal.

WARNING: Before driving the vehicle, depress the brake pedal repeatedly until the brake pedal feels firm. Check the brake calipers for leaks. Then, test the brakes thoroughly at slow speed before operating the vehicle under normal conditions.

Maintenance

Caution: Before performing any maintenance on the Brake Fluid Exchanger, verify that the Brake Fluid Exchanger is depressurized.

1. Clean up any brake fluid oil that may have spilled.
2. Wipe down the Brake Fluid Exchanger components with a cloth.
3. Store the unit in a clean and dry location.

Brake fluid Exchanger Parts List

1	Handle Bar	1	10	Connector	2
2	Cap, Tank	1	11	Valve, Safety, Air Release	1
3	Tank, Upper Half	1	12	Connector	1
4	Rubber Membrane	1	13	Tube	1
5	Tank, lower Half	1	14	Connector, Quick Fluid	1
6	Connector, PL802L	1	15	Hose, Fluid	1
7	Connector, Quick	1	16	Coupler	1
8	Valve, Ball, 1/4"	3	17	Gauge, Pressure	1
9	Valve, Pressure Adjust	1	18	Coupler, Pressure Gauge	1

NOTE: Some parts are listed and shown for illustration purposes only and are not available individually as replacement parts.

Brake Fluid Exchanger Assembly Drawing

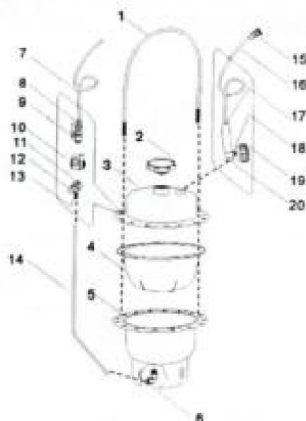

Adapter Kit Parts List

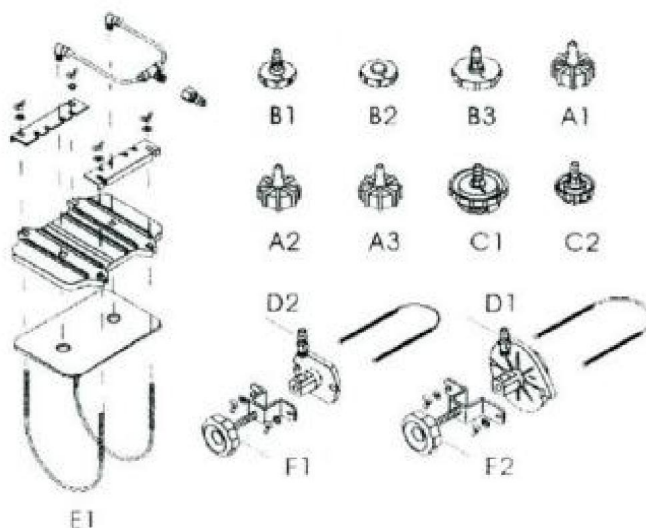

PLEASE READ THE FOLLOWING CAREFULLY

THE MANUFACTURER AND/OR DISTRIBUTOR HAS PROVIDED THE PARTS DIAGRAM IN THIS MANUAL AS A REFERENCE TOOL ONLY. NEITHER THE MANUFACTURER NOR DISTRIBUTOR MAKES ANY REPRESENTATION OR WARRANTY OF ANY KIND TO THE BUYER THAT HE OR SHE IS QUALIFIED TO MAKE ANY REPAIRS TO THE PRODUCT OR THAT HE OR SHE IS QUALIFIED TO REPLACE ANY PARTS OF THE PRODUCT. IN FACT, THE MANUFACTURER AND/OR DISTRIBUTOR EXPRESSLY STATES THAT ALL REPAIRS AND PARTS REPLACEMENTS SHOULD BE UNDERTAKEN BY CERTIFIED AND LICENSED TECHNICIANS AND NOT BY THE BUYER. THE BUYER ASSUMES ALL RISK AND LIABILITY ARISING OUT OF HIS OR HER REPAIRS TO THE ORIGINAL PRODUCT OR REPLACEMENT PARTS THERE TO, OR ARISING OUT OF HIS OR HER INSTALLATION OF REPLACEMENT PARTS THERE TO.

Fabrikant: Shanghaimuxinmuyeyouxiangongsi

Adres: Shuangchenglu 803nong11hao1602A-1609shi, Baoshanqu, Shanghai 200000 CN.

Geïmporteerd naar AUS: SIHAO PTY LTD. 1 ROKEVA STREETEASTWOOD NSW 2122 Australië

Geïmporteerd naar de VS: Sanven Technology Ltd. Suite 250, 9166 Anaheim Place, Rancho Cucamonga, CA 91730



YH CONSULTING LIMITED. C/O YH Consulting Limited
Kantoor 147, Centurion House, London Road, Staines-
upon-Thames, Surrey, TW18 4AX



E-CrossStu GmbH
Mainzer Landstr.69,
60329 Frankfurt am Main.

VEVOR[®]
TOUGH TOOLS, HALF PRICE

Technische ondersteuning en e-
garantiecertificaat www.vevor.com/support