

# **VEVOR<sup>®</sup>**

## **TOUGH TOOLS, HALF PRICE**

Technical Support and E-Warranty Certificate

[www.vevor.com/support](http://www.vevor.com/support)

## **MOBILE BASE**

**MODEL: GZB88093**

We continue to be committed to provide you tools with competitive price.

"Save Half", "Half Price" or any other similar expressions used by us only represents an estimate of savings you might benefit from buying certain tools with us compared to the major top brands and does not necessarily mean to cover all categories of tools offered by us. You are kindly reminded to verify carefully when you are placing an order with us if you are actually saving half in comparison with the top major brands.

# VEVOR<sup>®</sup>

TOUGH TOOLS, HALF PRICE

## MOBILE BASE

**MODEL: GZB88093**



Photo for reference

### **NEED HELP? CONTACT US!**

Have product questions? Need technical support? Please feel free to contact us:

**Technical Support and E-Warranty Certificate**  
**[www.vevor.com/support](http://www.vevor.com/support)**

This is the original instruction, please read all manual instructions carefully before operating. VEVOR reserves a clear interpretation of our user manual. The appearance of the product shall be subject to the product you received. Please forgive us that we won't inform you again if there are any technology or software updates on our product.

## SAFETY INSTRUCTIONS



**WARNING: Read and understand this manual before assembling, installing, operating, or servicing this product. Failure to follow these warnings and instructions can cause death, personal injury, or damage to valuable property.**

1. Please do not put it near flammable materials.
2. It is forbidden to carry people under any condition.
3. This product cannot be used to go up or down stairs.
4. Overload is strictly prohibited.
5. Don't move too fast when passing pothole areas.

## SAVE THESE INSTRUCTIONS

## MODEL AND PARAMETERS

Model	GZB88093
Material	Q235
Base size adjustment range	12x12 inches up to 36x36 inches
maximum load	650 lbs

Part list:

## Part list

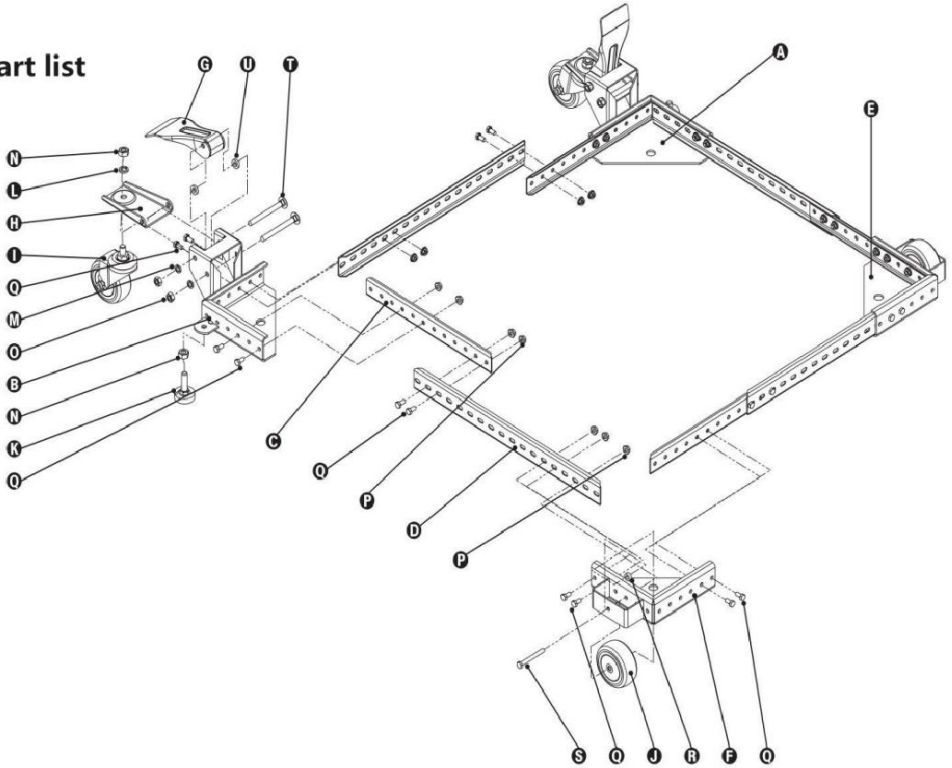

### Parts List

S/N	Description	Qty	S/N	Description	Qty
Ⓐ	FRONT LEFT CORNER	1	Ⓕ	M10 LOCK WASHER	2
Ⓑ	FRONT RIGHT CORNER	1	Ⓜ	M8 LOCK WASHER	4
Ⓒ	Short SIDE RAIL	4	Ⓝ	M10 NUT	4
Ⓓ	Lon9 SIDE RAIL	4	Ⓞ	M8 NUT	4
Ⓔ	REAR LEFT CORNER	1	Ⓟ	M6 FLANGE NUT	26
Ⓕ	REAR RIGHT CORNER	1	Ⓠ	M6-12 HEX BOLT	24
Ⓖ	FOOT LEVER	2	Ⓡ	NYLON WHEEL BUSHING	2
Ⓗ	SWIVEL PLATE	2	Ⓢ	M6-55 AXLE BOLT	2
Ⓛ	3" SWIVEL CASTER	2	Ⓣ	M8-85 CARRIAGE BOLT	4
Ⓟ	3" WHEEL	2	Ⓤ	NYLON FOOT LEVER BUSHING	4
Ⓚ	RUBBER GLIDE FOOT	2			

# Assembly Examples

Be sure to follow Safety and Assembly Instructions. Keep in mind the actual operation of your machine and the effect it has on overall stability.

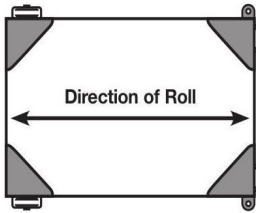

A long, narrow base, such as on a jointer, would benefit from this arrangement. Most machines may be arranged to the convenience of the user.

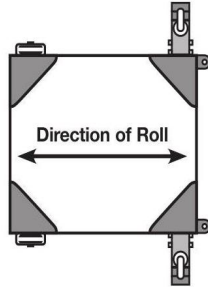

A short, narrow base, such as found on a drill press or bandsaw, may benefit from this arrangement. Due to swivel rotation, base may sit out of level. Rotate swivel wheel away from base to correct.

4. Select and arrange the Corners and the Side Rails as necessary to assemble the base to your machine's footprint. Position Side Rails into corners as far as practical.

a. Below is a standard arrangement, but many different arrangements are possible. You can use 1, 2, or 3 rails on either side.

b. To expand the functionality of this mobile base on larger machine's, purchase additional rails online at <http://www.boratool.com/rail-kit-w-hardware-pm1000-htc2000>

5. Bolt the Side Rails to the corners and each other using these simple rules:

a. All connections require the use of (2) M6-12 bolts and (2) M6 nuts at each end of the connections

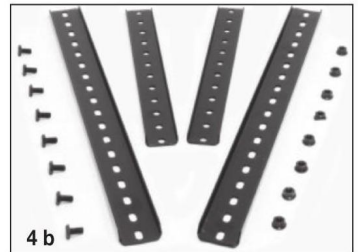

**Note: Insert bolts so that the nuts are on the INSIDE of the mobile base.**

6. Re-check dimensions with the tape measure, then tighten all bolts and nuts. If you are building a square configuration the measurements between diagonal corners should be relatively close.

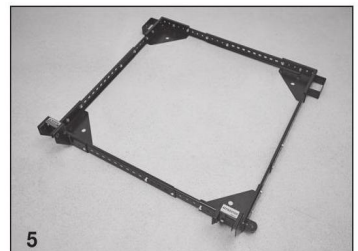

# Attaching Wheels and Casters

1. Attach swivel plate "H" to the Front Right corner "B" using M8-85 carriage bolt "T", M8 lock washer "M", and M8 nut "O".
2. Attach foot lever "G" to the Front Right corner "B".
  - a. Slide the M8-85 carriage bolt "T" through the hole on the inside of the corner, hang a nylon foot lever bushing "U" on the end of the bolt. Insert an extra bolt into the hole from the outside of the corner just far enough to act as a "hanger" for the other nylon bushing.
  - b. Carefully slide the foot lever into place between the nylon bushings.
  - c. Push the carriage bolt through the foot lever, nylon washers, and opposite side of the corner. Secure it using the M8 lock washer "M".
3. Attach swivel caster "I" to swivel plate "H" using M10 lock washer "L" and M10 nut "N".

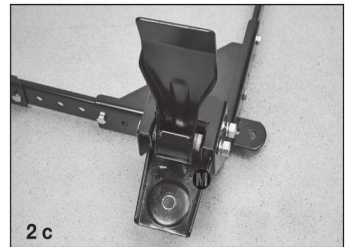
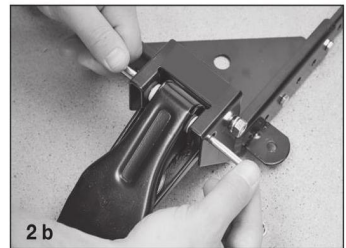
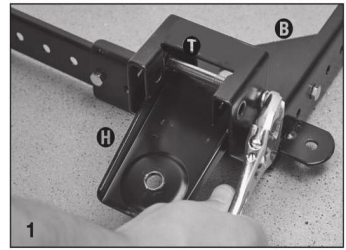

4. Insert rubber glide foot “K” into the threaded hole on the side of the corner. Spin M10 nut “N” onto the top of the rubber glide foot.

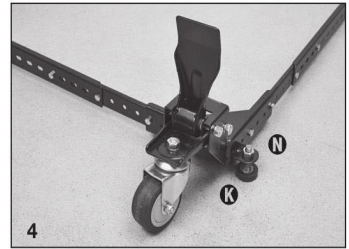

5. Repeat steps 1 through 4 on the Front Left corner “A”.

6. Attach 3” wheel “J” to Rear Right corner “F”.

a. Insert extra bolt into the axle hole from the inside of the corner. Insert the bolt into the wheel housing just far enough to act as a “hanger” for the nylon wheel bushing “G”.

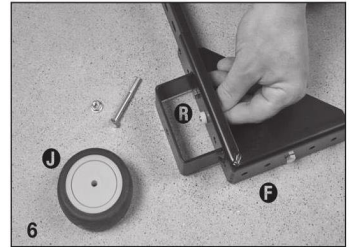

7. Carefully align 3” wheel “J”, and insert M6-55 bolt “S” through hole in the outer edge of wheel housing, through wheel “J”, through nylon bushing “G”.

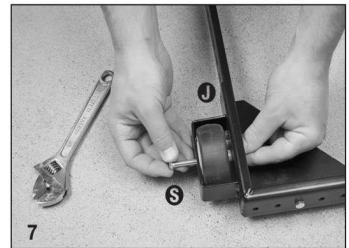

8. Secure the axle bolt using using M6 flange nut “P”.

9. Repeat steps 6-8 for back-left corner “B”, assembly is now complete!

a. Test mobility without machine.

b. Add machine and secure it to the mobile base.

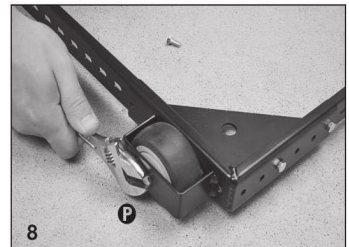

10. Lift your machine or item to be mobilized into place.



**CAUTION: Check stability in both the up and down positions before using. Failure to follow safety and assembly instructions may result in personal injury or damage to product.**

## MAINTENANCE

1. Avoid prolonged exposure to the sun to avoid aging.
2. Inspect accessories for wear, cracks, and other damage before use, and replace defective accessories immediately.

**Manufacturer:** Shanghaimuxinmuyeyouxiangongsi

**Address:** Shuangchenglu 803nong11hao1602A-1609shi, baoshanqu, shanghai 200000 CN.

**Imported to AUS:** SIHAO PTY LTD, 1 ROKEVA STREETEASTWOOD NSW 2122 Australia

**Imported to USA:** Sanven Technology Ltd., Suite 250, 9166 Anaheim Place, Rancho Cucamonga, CA 91730

EC	REP
----	-----

E-CrossStu GmbH  
Mainzer Landstr.69, 60329 Frankfurt am Main.

UK	REP
----	-----

YH CONSULTING LIMITED.  
C/O YH Consulting Limited Office 147, Centurion House,  
London Road, Staines-upon-Thames, Surrey, TW18 4AX

# VEVOR®

**TOUGH TOOLS, HALF PRICE**

**Technical Support and E-Warranty Certificate**

[www.vevor.com/support](http://www.vevor.com/support)



# VEVOR<sup>®</sup>

## TOUGH TOOLS, HALF PRICE

Assistance technique et certificat de garantie

électronique [www.vevor.com/support](http://www.vevor.com/support)

## BASE MOBILE

MODÈLE : GZB88093

Nous continuons à nous engager à vous fournir des outils à des prix compétitifs.

"Économisez la moitié", "Moitié prix" ou toute autre expression similaire que nous utilisons ne représente qu'une estimation des économies dont vous pourriez bénéficier en achetant certains outils chez nous par rapport aux grandes marques et ne signifie pas nécessairement couvrir toutes les catégories d'outils proposés, par nous.

Nous vous rappelons de bien vouloir vérifier attentivement lorsque vous passez une commande chez nous si vous économisez réellement la moitié par rapport aux grandes marques.

**VEVOR**<sup>®</sup>  
TOUGH TOOLS, HALF PRICE

BASE MOBILE

MODÈLE : GZB88093



Photo pour référence

**BESOIN D'AIDE ? CONTACTEZ-NOUS!**

Vous avez des questions sur les produits ? Besoin d'une assistance technique ? N'hésitez pas à nous

contacter : Support technique et certificat de garantie électronique  
[www.vevor.com/support](http://www.vevor.com/support)

Il s'agit des instructions originales, veuillez lire attentivement toutes les instructions du manuel avant de l'utiliser. VEVOR se réserve une interprétation claire de notre manuel d'utilisation. L'apparence du produit dépend du produit que vous avez reçu. Veuillez nous pardonner que nous ne vous informerons plus s'il y a des mises à jour technologiques ou logicielles sur notre produit.

## CONSIGNES DE SÉCURITÉ



**AVERTISSEMENT :** Lisez et comprenez ce manuel avant

l'assemblage, l'installation, l'utilisation ou l'entretien de ce produit.

Le non-respect de ces avertissements et instructions peut entraîner décès, blessures corporelles ou dommages à des biens de valeur.

1. Veuillez ne pas le placer à proximité de matériaux inflammables.
2. Il est interdit de transporter des personnes sous quelque condition que ce soit.
3. Ce produit ne peut pas être utilisé pour monter ou descendre les escaliers.
4. La surcharge est strictement interdite.
5. Ne vous déplacez pas trop vite lorsque vous passez des zones de nids-de-poule.

## CONSERVEZ CES INSTRUCTIONS

## MODÈLE ET PARAMÈTRES

Modèle	GZB88093
Matériel	Q235
Taille du socle plage de réglage	12x12 pouces jusqu'à 36x36 pouces
charge maximale	650 livres

Liste des pièces :

## Part list

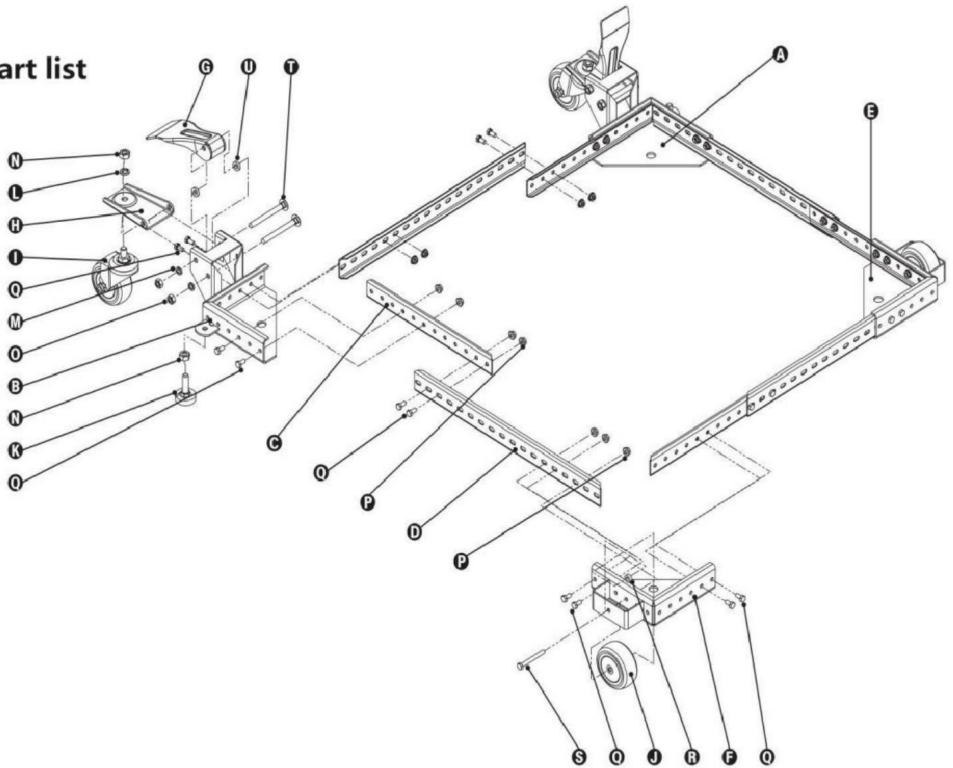

Liste des pièces

S/N	Description	Qté	S/N	Description	Qté
	COIN AVANT GAUCHE 1			RONDELLE DE BLOCAGE M10	2
	COIN AVANT DROIT 1			RONDELLE DE BLOCAGE M8	4
	RAIL LATÉRAL court	4		ÉCROU M10	4
	RAIL LATÉRAL Lon9	4		ÉCROU M8	4
	COIN ARRIÈRE GAUCHE 1			ÉCROU À BRIDE M6	26
	COIN ARRIÈRE DROIT 1			BOULON HEXAGONAL M6-12	24
	LEVIER AU PIED	2		DOUILLE DE ROUE EN NYLON	2
	PLAQUE PIVOTANTE	2		BOULON D'AXE M6-55	2
	ROULETTES PIVOTANTES DE 3"	2		BOULON DE CHARIOT M8-85	4
	ROUE 3"	2		DOUILLE DE LEVIER DE PIED EN NYLON	4
	PIED DE GLISSEMENT EN CAOUTCHOUC	2			

## Assembly Examples

Be sure to follow Safety and Assembly Instructions. Keep in mind the actual operation of your machine and the effect it has on overall stability.

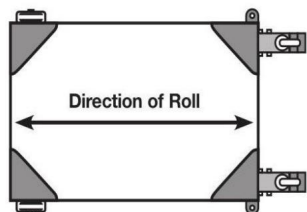

A long, narrow base, such as on a jointer, would benefit from this arrangement. Most machines may be arranged to the convenience of the user.

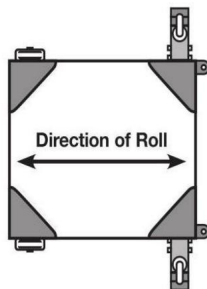

A short, narrow base, such as found on a drill press or bandsaw, may benefit from this arrangement. Due to swivel rotation, base may sit out of level. Rotate swivel wheel away from base to correct.

4. Select and arrange the Corners and the Side Rails as necessary to assemble the base to your machine's footprint. Position Side Rails into corners as far as is practical.

- a. Below is a standard arrangement, but many different arrangements are possible. You can use 1, 2, or 3 rails on either side.

- b. To expand the functionality of this mobile base on larger machine's, purchase additional rails online at <http://www.boratool.com/rail-kit-w-hardware-pm1000-htc2000>

5. Bolt the Side Rails to the corners and each other using these simple rules:

- a. All connections require the use of (2) M6-12 bolts and (2) M6 nuts at each end of the connections

**Note: Insert bolts so that the nuts are on the INSIDE of the mobile base.**

6. Re-check dimensions with the tape measure, then tighten all bolts and nuts. If you are building a square configuration the measurements between diagonal corners should be relatively close.

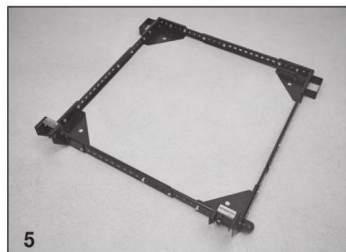
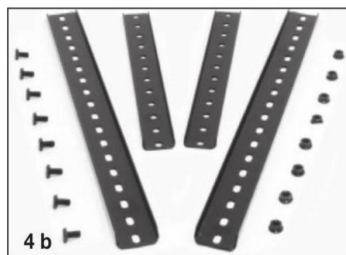
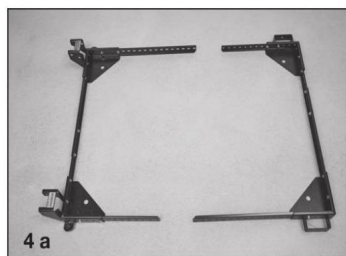

## Attaching Wheels and Casters

1. Attach swivel plate "H" to the Front Right corner "B" using M8-85 carriage bolt "T", M8 lock washer "M", and M8 nut "O".
2. Attach foot lever "G" to the Front Right corner "B".
  - a. Slide the M8-85 carriage bolt "T" through the hole on the inside of the corner, hang a nylon foot lever bushing "U" on the end of the bolt. Insert an extra bolt into the hole from the outside of the corner just far enough to act as a "hanger" for the other nylon bushing.
  - b. Carefully slide the foot lever into place between the nylon bushings.
  - c. Push the carriage bolt through the foot lever, nylon washers, and opposite side of the corner. Secure it using the M8 lock washer "M".
3. Attach swivel caster "I" to swivel plate "H" using M10 lock washer "L" and M10 nut "N".

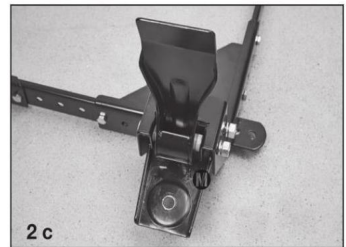
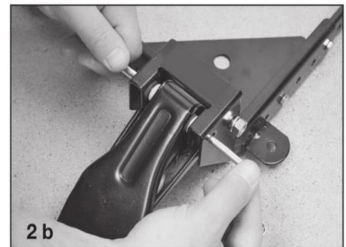
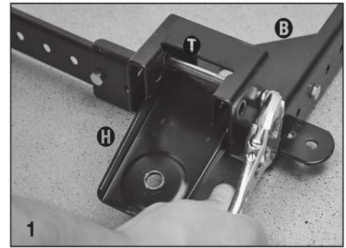

4. Insert rubber glide foot “K” into the threaded hole on the side of the corner. Spin M10 nut “N” onto the top of the rubber glide foot.

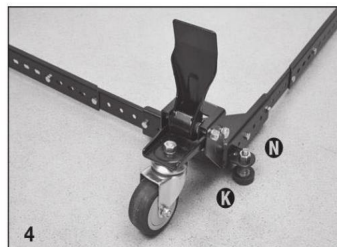

5. Repeat steps 1 through 4 on the Front Left corner “A”.

6. Attach 3” wheel “J” to Rear Right corner “F”.

a. Insert extra bolt into the axle hole from the inside of the corner. Insert the bolt into the wheel housing just far enough to act as a “hanger” for the nylon wheel bushing “G”.

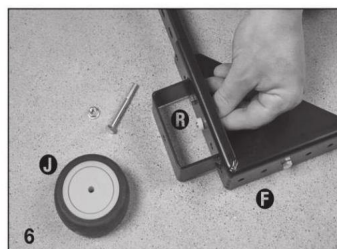

7. Carefully align 3” wheel “J”, and insert M6-55 bolt “S” through hole in the outer edge of wheel housing, through wheel “J”, through nylon bushing “G”.



8. Secure the axle bolt using using M6 flange nut “P”.

9. Repeat steps 6-8 for back-left corner “E”, assembly is now complete!

a. Test mobility without machine.

b. Add machine and secure it to the mobile base.

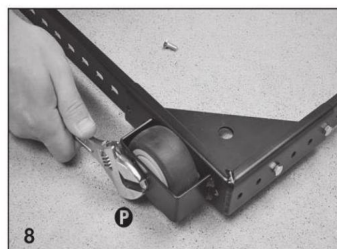

10. Lift your machine or item to be mobilized into place.



**CAUTION: Check stability in both the up and down positions before using. Failure to follow safety and assembly instructions may result in personal injury or damage to product.**

## ENTRETIEN

1. Évitez l'exposition prolongée au soleil pour éviter le vieillissement.
2. Inspectez les accessoires pour déceler l'usure, les fissures et autres dommages avant utilisation et remplacez immédiatement les accessoires défectueux.

Fabricant : Shanghaimuxinmuyeyouxiangongsi

Adresse : Shuangchenglu 803nong11hao1602A-1609shi, baoshanqu, Shanghai  
200000 CN.

Importé en Australie : SIHAO PTY LTD, 1 ROKEVA STREETESTWOOD NSW  
2122 Australie

Importé aux États-Unis : Sanven Technology Ltd., Suite 250, 9166 Anaheim Place, Rancho  
Cucamonga, CA 91730

REPRÉSENTANT	CE
--------------	----

E-CrossStu GmbH

Mainzer Landstr.69, 60329 Francfort-sur-le-Main.

REPRÉSENTANT	DU ROYAUME-UNI
--------------	----------------

YH CONSULTING LIMITÉE.

C/O YH Consulting Limited Bureau 147, Centurion House,  
London Road, Staines-upon-Thames, Surrey, TW18 4AX

# VEVOR®

**TOUGH TOOLS, HALF PRICE**

Assistance technique et certificat de garantie électronique

[www.vevor.com/support](http://www.vevor.com/support)



# **VEVOR<sup>®</sup>**

## **TOUGH TOOLS, HALF PRICE**

Technischer Support und E-Garantie-Zertifikat

[www.vevor.com/support](http://www.vevor.com/support)

## **MOBILE BASIS**

**MODELL: GZB88093**

Wir sind weiterhin bestrebt, Ihnen Werkzeuge zu wettbewerbsfähigen Preisen anzubieten.

„Sparen Sie die Hälfte“, „Halber Preis“ oder andere ähnliche Ausdrücke, die wir verwenden, stellen nur eine Schätzung der Ersparnis dar, die Sie beim Kauf bestimmter Werkzeuge bei uns im Vergleich zu den großen Topmarken erzielen können, und decken nicht unbedingt alle von uns angebotenen Werkzeugkategorien ab. Wir möchten Sie freundlich daran erinnern, bei Ihrer Bestellung bei uns sorgfältig zu prüfen, ob Sie im Vergleich zu den großen Topmarken tatsächlich die Hälfte sparen.

**VEVOR**<sup>®</sup>  
TOUGH TOOLS, HALF PRICE

**MOBILE BASIS**

MODELL: GZB88093



Foto als Referenz

**Brauchen Sie Hilfe? Kontaktieren Sie uns!**

Haben Sie Fragen zum Produkt? Benötigen Sie technischen Support? Bitte kontaktieren Sie uns:

**Technischer Support und E-Garantie-Zertifikat [www.vevor.com/support](http://www.vevor.com/support)**

Dies ist die Originalanleitung. Bitte lesen Sie alle Anweisungen sorgfältig durch, bevor Sie das Gerät in Betrieb nehmen. VEVOR behält sich eine klare Auslegung unserer Bedienungsanleitung vor. Das Erscheinungsbild des Produkts richtet sich nach dem Produkt, das Sie erhalten haben. Bitte verzeihen Sie uns, dass wir Sie nicht erneut informieren, wenn es Technologie- oder Software-Updates für unser Produkt gibt.

## SICHERHEITSHINWEISE



**WARNUNG: Lesen und verstehen Sie dieses Handbuch, bevor Sie**

**Montage, Installation, Bedienung oder Wartung dieses Produkts.**

**Die Nichtbeachtung dieser Warnungen und Anweisungen kann zu Tod, Personenschäden oder Schäden an wertvollem Eigentum.**

1. Bitte nicht in der Nähe von brennbaren Materialien platzieren.
2. Die Beförderung von Personen ist unter allen Umständen verboten.
3. Dieses Produkt kann nicht zum Treppensteigen verwendet werden.
4. Überlastung ist strengstens verboten.
5. Fahren Sie nicht zu schnell durch Schlaglöcher.

**BEWAHREN SIE DIESE ANWEISUNGEN AUF**

## MODELL UND PARAMETER

Modell	GZB88093
Material	Q235
Basisgröße Einstellbereich	12x12 Zoll bis zu 36x36 Zoll
Maximale Belastung	650 Pfund

Stückliste:

## Part list

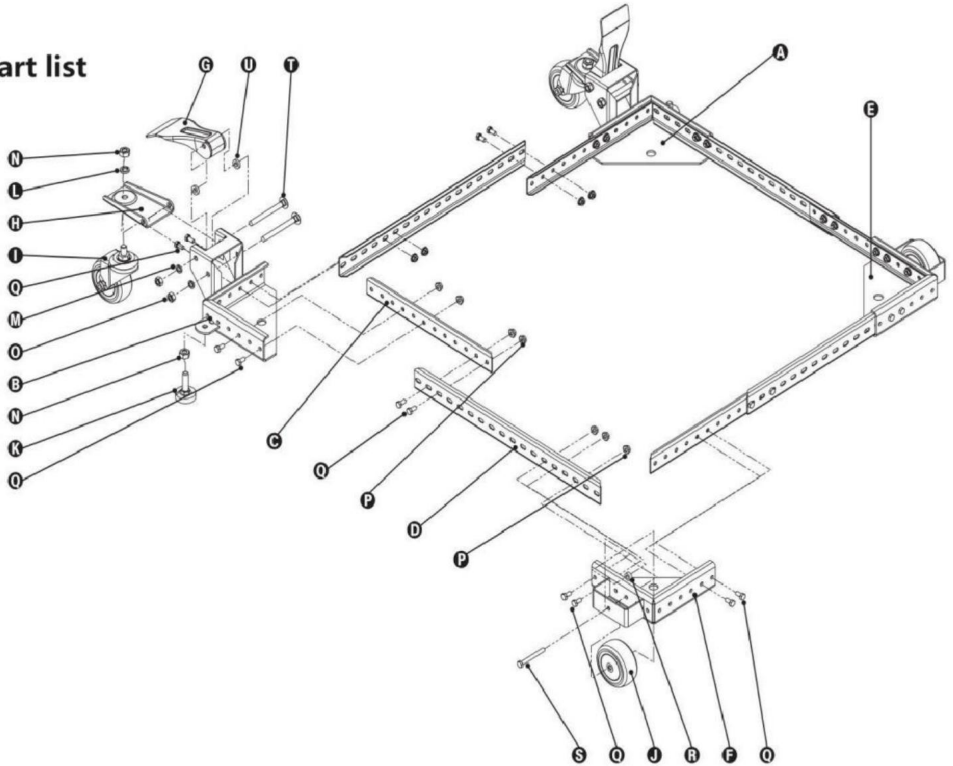

## Ersatzteilliste

Stücknummer	Beschreibung	Menge	S/N	Beschreibung	Menge
ÿ	VORDERE LINKE ECKE 1 ÿ			M10 Federscheibe	2
ÿ	VORDERE RECHTE ECKE 1 ÿ			M8 Federscheibe	4
ÿ	Kurzes SEITENGELÄNDER	4 ÿ		M10 MUTTER	4
ÿ	Lon9 SEITENSCHIENE	4 ÿ		M8 MUTTER	4
ÿ	HINTERE LINKE ECKE 1 ÿ			M6 FLANSCHMUTTER	26
ÿ	HINTERE RECHTE ECKE 1 ÿ			M6-12 SECHSKANTSCHRAUBE	24
ÿ	FUSSHEBEL	2 ÿ		NYLON-RADBUCHSE	2
ÿ	SCHWENKPLATTE	2 ÿ		M6-55 Achsschraube	2
ÿ	3" LENKROLLEN	2 ÿ		M8-85 SCHLOSSSCHRAUBE	4
ÿ	3" RAD	2 ÿ		NYLON-FUSSHEBELBUCHSE 4	
ÿ	GUMMI-GLEITFUß 2				

## Assembly Examples

Be sure to follow Safety and Assembly Instructions. Keep in mind the actual operation of your machine and the effect it has on overall stability.

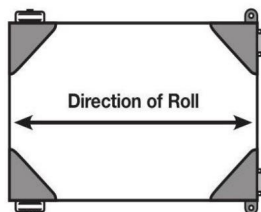

A long, narrow base, such as on a jointer, would benefit from this arrangement. Most machines may be arranged to the convenience of the user.

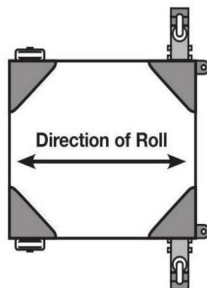

A short, narrow base, such as found on a drill press or bandsaw, may benefit from this arrangement. Due to swivel rotation, base may sit out of level. Rotate swivel wheel away from base to correct.

4. Select and arrange the Corners and the Side Rails as necessary to assemble the base to your machine's footprint. Position Side Rails into corners as far as is practical.

- a. Below is a standard arrangement, but many different arrangements are possible. You can use 1, 2, or 3 rails on either side.

- b. To expand the functionality of this mobile base on larger machine's, purchase additional rails online at <http://www.boratool.com/rail-kit-w-hardware-pm1000-htc2000>

5. Bolt the Side Rails to the corners and each other using these simple rules:

- a. All connections require the use of (2) M6-12 bolts and (2) M6 nuts at each end of the connections

**Note: Insert bolts so that the nuts are on the INSIDE of the mobile base.**

6. Re-check dimensions with the tape measure, then tighten all bolts and nuts. If you are building a square configuration the measurements between diagonal corners should be relatively close.

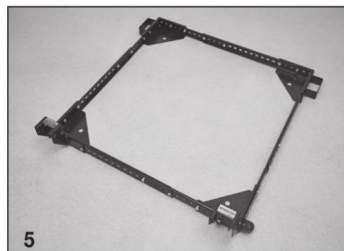
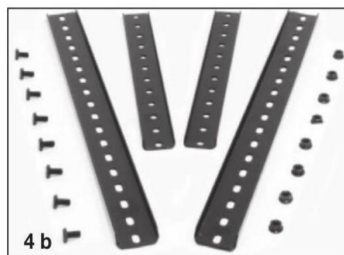
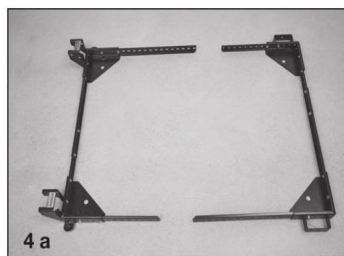

## Attaching Wheels and Casters

1. Attach swivel plate "H" to the Front Right corner "B" using M8-85 carriage bolt "T", M8 lock washer "M", and M8 nut "O".
2. Attach foot lever "G" to the Front Right corner "B".
  - a. Slide the M8-85 carriage bolt "T" through the hole on the inside of the corner, hang a nylon foot lever bushing "U" on the end of the bolt. Insert an extra bolt into the hole from the outside of the corner just far enough to act as a "hanger" for the other nylon bushing.
  - b. Carefully slide the foot lever into place between the nylon bushings.
  - c. Push the carriage bolt through the foot lever, nylon washers, and opposite side of the corner. Secure it using the M8 lock washer "M".
3. Attach swivel caster "I" to swivel plate "H" using M10 lock washer "L" and M10 nut "N".

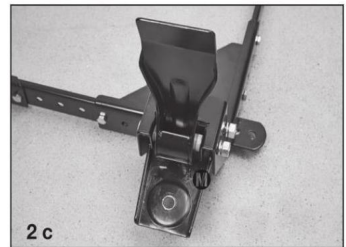
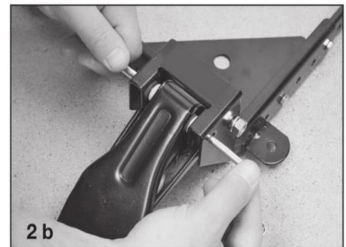
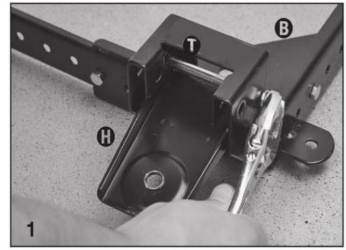

4. Insert rubber glide foot “K” into the threaded hole on the side of the corner. Spin M10 nut “N” onto the top of the rubber glide foot.

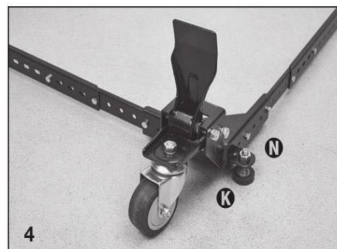

5. Repeat steps 1 through 4 on the Front Left corner “A”.

6. Attach 3” wheel “J” to Rear Right corner “F”.

a. Insert extra bolt into the axle hole from the inside of the corner. Insert the bolt into the wheel housing just far enough to act as a “hanger” for the nylon wheel bushing “G”.

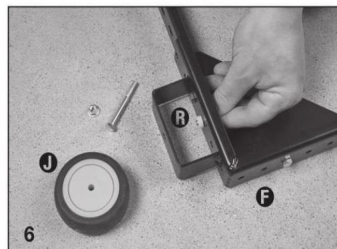

7. Carefully align 3” wheel “J”, and insert M6-55 bolt “S” through hole in the outer edge of wheel housing, through wheel “J”, through nylon bushing “G”.



8. Secure the axle bolt using using M6 flange nut “P”.

9. Repeat steps 6-8 for back-left corner “B”, assembly is now complete!

a. Test mobility without machine.

b. Add machine and secure it to the mobile base.

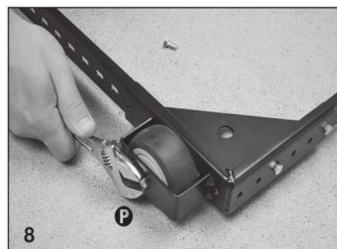

10. Lift your machine or item to be mobilized into place.



**CAUTION: Check stability in both the up and down positions before using. Failure to follow safety and assembly instructions may result in personal injury or damage to product.**

## WARTUNG

1. Vermeiden Sie längere Sonneneinstrahlung, um der Hautalterung vorzubeugen.
2. Überprüfen Sie Zubehör vor der Verwendung auf Verschleiß, Risse und andere Schäden und ersetzen Sie defektes Zubehör sofort.

**Hersteller:** Shanghai muxinmuyeyouxiangongsi

**Adresse:** Shuangchenglu 803nong11hao1602A-1609shi, baoshanqu, Shanghai 200000 CN.

**Nach AUS importiert:** SIHAO PTY LTD, 1 ROKEVA STREET EASTWOOD NSW 2122 Australien

**Importiert in die USA:** Sanven Technology Ltd., Suite 250, 9166 Anaheim Place, Rancho Cucamonga, CA 91730

<b>Vertreter der EG</b>	
-------------------------	--

E-CrossStu GmbH

Mainzer Landstr.69, 60329 Frankfurt am Main.

<b>UK REP</b>	
---------------	--

YH CONSULTING LIMITED.

C/O YH Consulting Limited Office 147, Centurion House, London Road, Staines-upon-Thames, Surrey, TW18 4AX

# VEVOR®

**TOUGH TOOLS, HALF PRICE**

**Technischer Support und E-Garantie-Zertifikat**

[www.vevor.com/support](http://www.vevor.com/support)



# **VEVOR<sup>®</sup>**

## **TOUGH TOOLS, HALF PRICE**

Supporto tecnico e certificato di garanzia  
elettronica [www.vevor.com/support](http://www.vevor.com/support)

## **BASE MOBILE**

**MODELLO: GZB88093**

Continuiamo a impegnarci per fornirvi strumenti a prezzi competitivi. "Risparmia la metà", "Metà prezzo" o qualsiasi altra espressione simile da noi utilizzata rappresenta solo una stima del risparmio che potresti trarre dall'acquistare determinati strumenti con noi rispetto ai principali marchi più importanti e non significa necessariamente coprire tutte le categorie di strumenti offerti da noi. Ti ricordiamo di verificare attentamente quando effettui un ordine con noi se stai effettivamente risparmiando la metà rispetto ai migliori marchi principali.

**VEVOR**<sup>®</sup>  
TOUGH TOOLS, HALF PRICE

**BASE MOBILE**

MODELLO: GZB88093



Foto per riferimento

**HAI BISOGNO DI AIUTO? CONTATTACI!**

Hai domande sul prodotto? Hai bisogno di supporto tecnico? Non esitate a contattarci:

**Supporto**

**tecnico e certificato di garanzia elettronica [www.vevor.com/  
support](http://www.vevor.com/support)**

Queste sono le istruzioni originali, leggere attentamente tutte le istruzioni del manuale prima dell'uso. VEVOR si riserva una chiara interpretazione del nostro manuale d'uso. L'aspetto del prodotto sarà soggetto al prodotto ricevuto. Ti preghiamo di perdonarci se non ti informeremo più se sono presenti aggiornamenti tecnologici o software sul nostro prodotto.

## ISTRUZIONI DI SICUREZZA



**ATTENZIONE:** Leggere e comprendere questo manuale prima

**durante l'assemblaggio, l'installazione, il funzionamento o la manutenzione di questo prodotto.**

**La mancata osservanza di queste avvertenze e istruzioni può causare morte, lesioni personali o danni a beni di valore.**

1. Si prega di non posizionarlo vicino a materiali infiammabili.
2. È vietato trasportare persone in qualsiasi condizione.
3. Questo prodotto non può essere utilizzato per salire o scendere le scale.
4. Il sovraccarico è severamente vietato.
5. Non muoverti troppo velocemente quando attraversi aree con buche.

## CONSERVA QUESTE ISTRUZIONI

## MODELLO E PARAMETRI

Modello	GZB88093
Materiale	Q235
Dimensione della base intervallo di regolazione	12x12 pollici fino a 36x36 pollici
carico massimo	650 libbre

Elenco delle parti:

## Part list

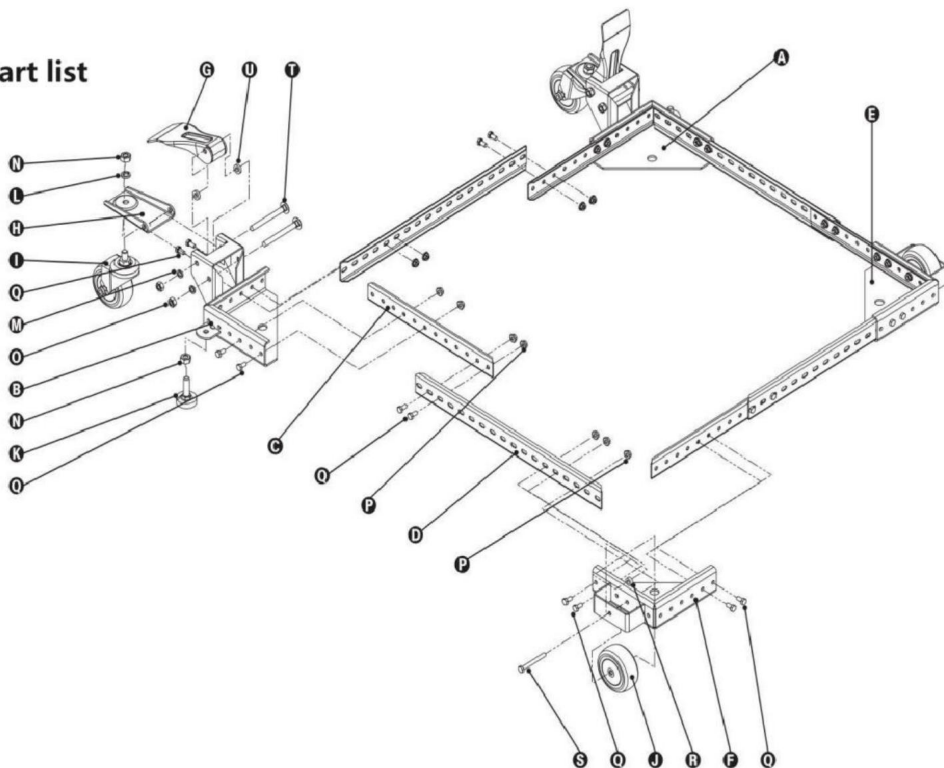

## Elenco delle parti

S/N	Descrizione	Qtà	S/N	Descrizione	Qtà
ÿ	ANGOLO ANTERIORE SINISTRO 1	ÿ		RONDELLA DI SICUREZZA M10	2
ÿ	ANGOLO ANTERIORE DESTRO 1	ÿ		RONDELLA DI SICUREZZA M8	4
ÿ	GUIDA LATERALE corta	4ÿ		DADO M10	4
ÿ	SPONDA LATERALE Lon9	4	ÿ	DADO M8	4
ÿ	ANGOLO POSTERIORE SINISTRO 1	ÿ		DADO FLANGIATO M6	26
ÿ	ANGOLO POSTERIORE DESTRO 1	ÿ		BULLONE ESAGONALE M6-12	24
ÿ	LEVA A PIEDE	2	ÿ	BOCCOLA RUOTA IN NYLON	2
ÿ	PIASTRA GIREVOLE	2ÿ		BULLONE ASSE M6-55	2
ÿ	RUOTA GIREVOLE DA 3 "	2ÿ		BULLONE DI TRASPORTO M8-85	4
ÿ	RUOTA DA 3".	2	ÿ	BOCCOLA PEDALE LEVA IN NYLON 4	
ÿ	PIEDINO SCORREVOLE IN GOMMA	2			

## Assembly Examples

Be sure to follow Safety and Assembly Instructions. Keep in mind the actual operation of your machine and the effect it has on overall stability.

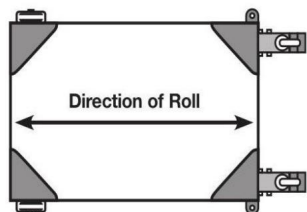

A long, narrow base, such as on a jointer, would benefit from this arrangement. Most machines may be arranged to the convenience of the user.

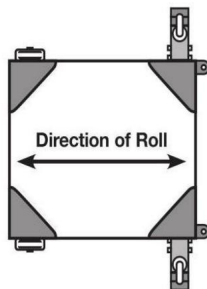

A short, narrow base, such as found on a drill press or bandsaw, may benefit from this arrangement. Due to swivel rotation, base may sit out of level. Rotate swivel wheel away from base to correct.

4. Select and arrange the Corners and the Side Rails as necessary to assemble the base to your machine's footprint. Position Side Rails into corners as far as is practical.

- a. Below is a standard arrangement, but many different arrangements are possible. You can use 1, 2, or 3 rails on either side.

- b. To expand the functionality of this mobile base on larger machine's, purchase additional rails online at <http://www.boratool.com/rail-kit-w-hardware-pm1000-htc2000>

5. Bolt the Side Rails to the corners and each other using these simple rules:

- a. All connections require the use of (2) M6-12 bolts and (2) M6 nuts at each end of the connections

**Note: Insert bolts so that the nuts are on the INSIDE of the mobile base.**

6. Re-check dimensions with the tape measure, then tighten all bolts and nuts. If you are building a square configuration the measurements between diagonal corners should be relatively close.

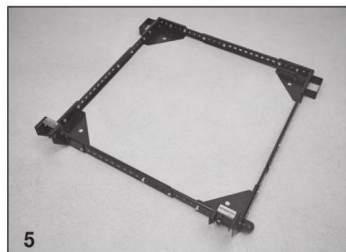
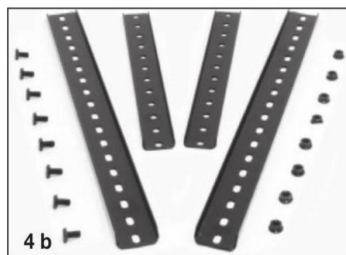
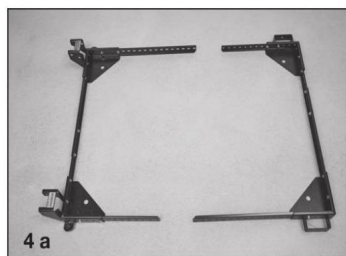

## Attaching Wheels and Casters

1. Attach swivel plate "H" to the Front Right corner "B" using M8-85 carriage bolt "T", M8 lock washer "M", and M8 nut "O".
2. Attach foot lever "G" to the Front Right corner "B".
  - a. Slide the M8-85 carriage bolt "T" through the hole on the inside of the corner, hang a nylon foot lever bushing "U" on the end of the bolt. Insert an extra bolt into the hole from the outside of the corner just far enough to act as a "hanger" for the other nylon bushing.
  - b. Carefully slide the foot lever into place between the nylon bushings.
  - c. Push the carriage bolt through the foot lever, nylon washers, and opposite side of the corner. Secure it using the M8 lock washer "M".
3. Attach swivel caster "I" to swivel plate "H" using M10 lock washer "L" and M10 nut "N".

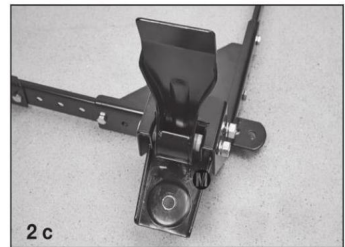
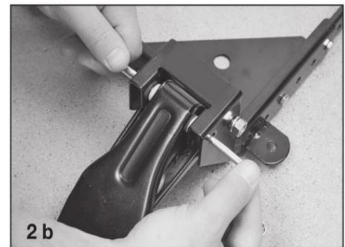
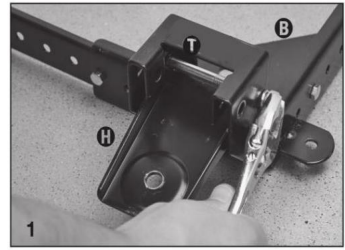

4. Insert rubber glide foot “K” into the threaded hole on the side of the corner. Spin M10 nut “N” onto the top of the rubber glide foot.

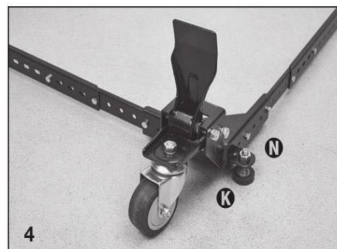

5. Repeat steps 1 through 4 on the Front Left corner “A”.

6. Attach 3” wheel “J” to Rear Right corner “F”.

a. Insert extra bolt into the axle hole from the inside of the corner. Insert the bolt into the wheel housing just far enough to act as a “hanger” for the nylon wheel bushing “G”.

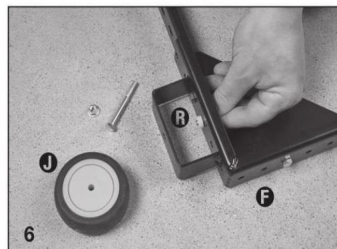

7. Carefully align 3” wheel “J”, and insert M6-55 bolt “S” through hole in the outer edge of wheel housing, through wheel “J”, through nylon bushing “G”.

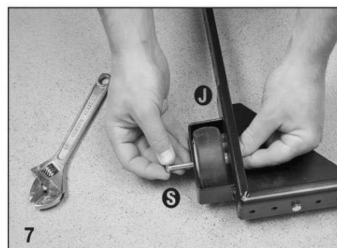

8. Secure the axle bolt using using M6 flange nut “P”.

9. Repeat steps 6-8 for back-left corner “E”, assembly is now complete!

a. Test mobility without machine.

b. Add machine and secure it to the mobile base.

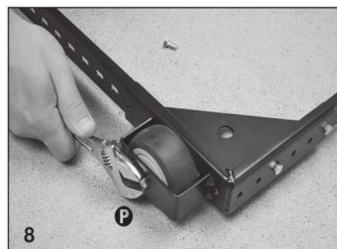

10. Lift your machine or item to be mobilized into place.



**CAUTION: Check stability in both the up and down positions before using. Failure to follow safety and assembly instructions may result in personal injury or damage to product.**

## MANUTENZIONE

1. Evitare l'esposizione prolungata al sole per evitare l'invecchiamento.
2. Ispezionare gli accessori per eventuali segni di usura, crepe e altri danni prima dell'uso e sostituire immediatamente gli accessori difettosi.

**Produttore:** Shanghaimuxinmuyeyouxiangongsi

**Indirizzo:** Shuangchenglu 803nong11hao1602A-1609shi, baoshanqu, shanghai 200000 CN.

**Importato in AUS:** SIHAO PTY LTD, 1 ROKEVA STREETEASTWOOD NSW 2122Australia

**Importato negli Stati Uniti:** Sanven Technology Ltd., Suite 250, 9166 Anaheim Place, Rancho Cucamonga, CA 91730



E-CrossStu GmbH  
Mainzer Landstr.69, 60329 Francoforte sul Meno.



YH CONSULENZA LIMITATA.  
C/O YH Consulting Limited Ufficio 147, Centurion House,  
London Road, Staines-upon-Thames, Surrey, TW18 4AX

# VEVOR®

TOUGH TOOLS, HALF PRICE

Supporto tecnico e certificato di garanzia elettronica

[www.vevor.com/support](http://www.vevor.com/support)



# VEVOR<sup>®</sup>

## TOUGH TOOLS, HALF PRICE

Soporte técnico y certificado de garantía  
electrónica [www.vevor.com/support](http://www.vevor.com/support)

### BASE MÓVIL

MODELO: GZB88093

Seguimos comprometidos a proporcionarle herramientas a precios competitivos. "Ahorre a mitad de precio", "A mitad de precio" o cualquier otra expresión similar utilizada por nosotros solo representa una estimación de los ahorros que podría beneficiarse al comprar ciertas herramientas con nosotros en comparación con las principales marcas y no significa necesariamente cubrir todas las categorías de herramientas ofrecidas por nosotros. Le recordamos que, cuando realice un pedido con nosotros, verifique cuidadosamente si realmente está ahorrando la mitad en comparación con las principales marcas.

**VEVOR**<sup>®</sup>  
TOUGH TOOLS, HALF PRICE

BASE MÓVIL

MODELO: GZB88093



Foto como referencia

¿NECESITAR AYUDA? ¡CONTÁCTANOS!

¿Tiene preguntas sobre el producto? ¿Necesita soporte técnico? No dude en contactarnos:  
Soporte

técnico y certificado de garantía electrónica [www.vevor.com/support](http://www.vevor.com/support)

Estas son las instrucciones originales; lea atentamente todas las instrucciones del manual antes de operar. VEVOR se reserva una interpretación clara de nuestro manual de usuario. La apariencia del producto estará sujeta al producto que recibió. Perdone que no le informaremos nuevamente si hay actualizaciones de tecnología o software en nuestro producto.

## INSTRUCCIONES DE SEGURIDAD



**ADVERTENCIA:** Lea y comprenda este manual antes  
ensamblar, instalar, operar o dar servicio a este producto.

El incumplimiento de estas advertencias e instrucciones puede causar  
muerte, lesiones personales o daños a bienes valiosos.

1. No lo coloques cerca de materiales inflamables.
2. Está prohibido transportar personas bajo cualquier condición.
3. Este producto no se puede utilizar para subir o bajar escaleras.
4. La sobrecarga está estrictamente prohibida.
5. No se mueva demasiado rápido al pasar por zonas con baches.

## GUARDE ESTAS INSTRUCCIONES

## MODELO Y PARÁMETROS

Modelo	GZB88093
Material	Q235
Tamaño básico rango de ajuste	12x12 pulgadas hasta 36x36 pulgadas
carga máxima	650 libras

Lista de piezas:

## Part list

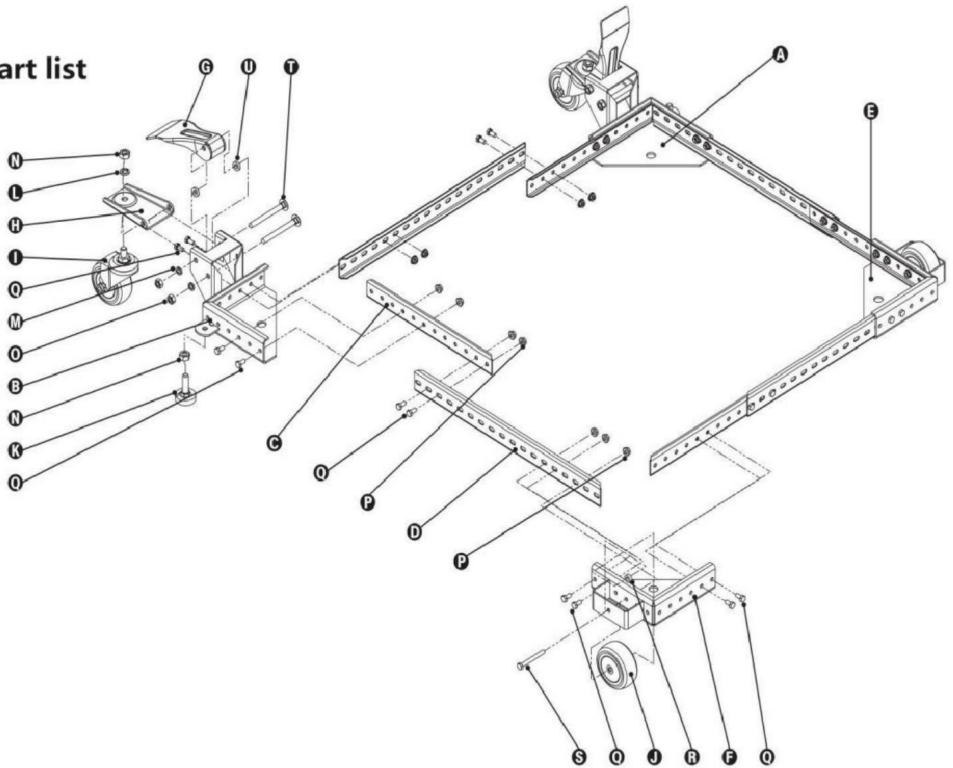

## Lista de piezas

S/N	Descripción	Cantidad	S/N	Descripción	Cantidad
	ESQUINA DELANTERA IZQUIERDA	1		ARANDELA DE PRESIÓN M10	2
	ESQUINA DELANTERA DERECHA	1		ARANDELA DE PRESIÓN M8	4
	RIEL LATERAL CORTA	4		TUERCA M10	4
	RIEL LATERAL Lon9	4		TUERCA M8	4
	ESQUINA TRASERA IZQUIERDA	1		TUERCA DE BRIDA M6	26
	ESQUINA TRASERA DERECHA	1		PERNO HEXAGONAL M6-12	24
	PALANCA DE PIE	2		CASQUILLO DE RUEDA DE NYLON	2
	PLACA GIRATORIA	2		PERNO DEL EJE M6-55	2
	RUEDA GIRATORIA DE 3"	2		PERNO DE CARRO M8-85	4
	RUEDA DE 3"	2		BUJE DE PALANCA DE PIE DE NYLON	4
	PIE DESLIZANTE DE GOMA	2			

## Assembly Examples

Be sure to follow Safety and Assembly Instructions. Keep in mind the actual operation of your machine and the effect it has on overall stability.

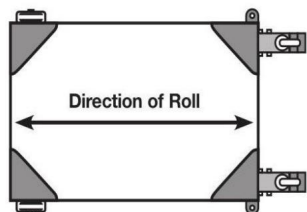

A long, narrow base, such as on a jointer, would benefit from this arrangement. Most machines may be arranged to the convenience of the user.

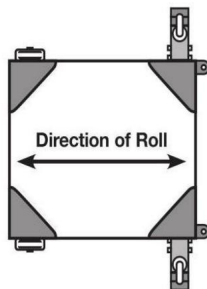

A short, narrow base, such as found on a drill press or bandsaw, may benefit from this arrangement. Due to swivel rotation, base may sit out of level. Rotate swivel wheel away from base to correct.

4. Select and arrange the Corners and the Side Rails as necessary to assemble the base to your machine's footprint. Position Side Rails into corners as far as is practical.

- a. Below is a standard arrangement, but many different arrangements are possible. You can use 1, 2, or 3 rails on either side.

- b. To expand the functionality of this mobile base on larger machine's, purchase additional rails online at <http://www.boratool.com/rail-kit-w-hardware-pm1000-htc2000>

5. Bolt the Side Rails to the corners and each other using these simple rules:

- a. All connections require the use of (2) M6-12 bolts and (2) M6 nuts at each end of the connections

**Note: Insert bolts so that the nuts are on the INSIDE of the mobile base.**

6. Re-check dimensions with the tape measure, then tighten all bolts and nuts. If you are building a square configuration the measurements between diagonal corners should be relatively close.

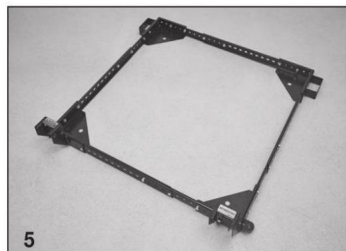
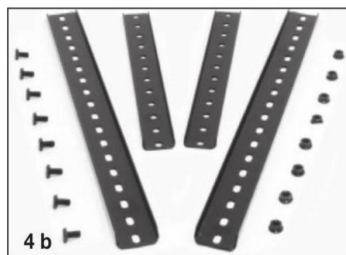
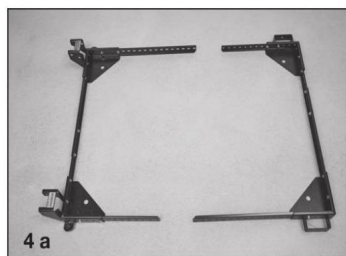

## Attaching Wheels and Casters

1. Attach swivel plate "H" to the Front Right corner "B" using M8-85 carriage bolt "T", M8 lock washer "M", and M8 nut "O".
2. Attach foot lever "G" to the Front Right corner "B".
  - a. Slide the M8-85 carriage bolt "T" through the hole on the inside of the corner, hang a nylon foot lever bushing "U" on the end of the bolt. Insert an extra bolt into the hole from the outside of the corner just far enough to act as a "hanger" for the other nylon bushing.
  - b. Carefully slide the foot lever into place between the nylon bushings.
  - c. Push the carriage bolt through the foot lever, nylon washers, and opposite side of the corner. Secure it using the M8 lock washer "M".
3. Attach swivel caster "I" to swivel plate "H" using M10 lock washer "L" and M10 nut "N".

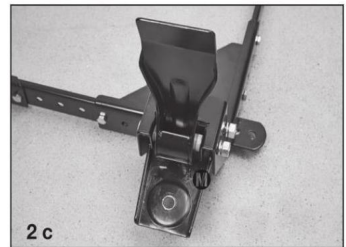
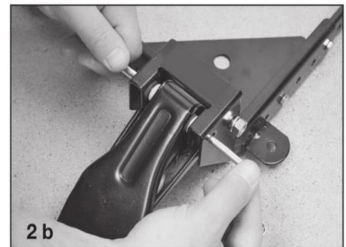
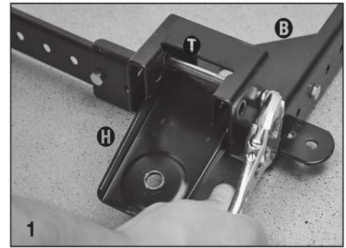

4. Insert rubber glide foot “K” into the threaded hole on the side of the corner. Spin M10 nut “N” onto the top of the rubber glide foot.

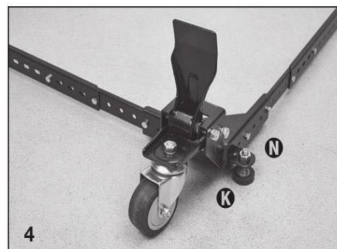

5. Repeat steps 1 through 4 on the Front Left corner “A”.

6. Attach 3” wheel “J” to Rear Right corner “F”.

a. Insert extra bolt into the axle hole from the inside of the corner. Insert the bolt into the wheel housing just far enough to act as a “hanger” for the nylon wheel bushing “G”.

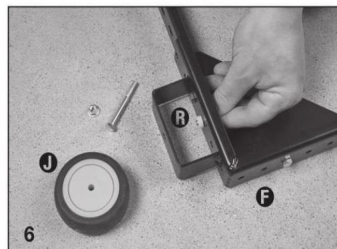

7. Carefully align 3” wheel “J”, and insert M6-55 bolt “S” through hole in the outer edge of wheel housing, through wheel “J”, through nylon bushing “G”.



8. Secure the axle bolt using using M6 flange nut “P”.

9. Repeat steps 6-8 for back-left corner “E”, assembly is now complete!

a. Test mobility without machine.

b. Add machine and secure it to the mobile base.

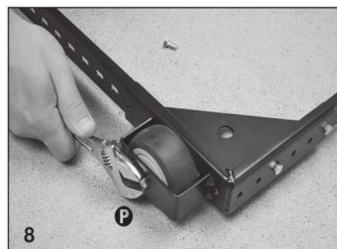

10. Lift your machine or item to be mobilized into place.



**CAUTION: Check stability in both the up and down positions before using. Failure to follow safety and assembly instructions may result in personal injury or damage to product.**

## MANTENIMIENTO

1. Evite la exposición prolongada al sol para evitar el envejecimiento.
2. Inspeccione los accesorios en busca de desgaste, grietas y otros daños antes de usarlos y reemplace los accesorios defectuosos inmediatamente.

Fabricante: Shanghaimuxinmuyeyouxiangongsi

Dirección: Shuangchenglu 803nong11hao1602A-1609shi, baoshanqu, shanghai 200000 CN.

Importado a AUS: SIHAO PTY LTD, 1 ROKEVA STREETEASTWOOD NSW 2122 Australia

Importado a EE. UU.: Sanven Technology Ltd., Suite 250, 9166 Anaheim Place, Rancho Cucamonga, CA 91730

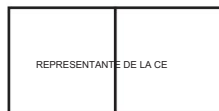

E-CrossStu GmbH

Mainzer Landstr.69, 60329 Fráncfort del Meno.

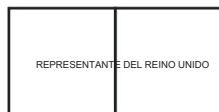

YH CONSULTING LIMITADO.

C/O YH Consulting Limited Oficina 147, Centurion House, London Road, Staines upon Thames, Surrey, TW18 4AX

# VEVOR®

**TOUGH TOOLS, HALF PRICE**

Soporte técnico y certificado de garantía electrónica

[www.vevor.com/support](http://www.vevor.com/support)



# VEVOR®

**TOUGH TOOLS, HALF PRICE**

Wsparcie techniczne i certyfikat e-gwarancji

[www.vevor.com/support](http://www.vevor.com/support)

## BAZA MOBILNA

MODEL: GZB88093

Nadal dokładamy wszelkich starań, aby zapewnić Państwu narzędzia w konkurencyjnej cenie.

„Zaoszczędź o połowę”, „o połowę ceny” lub inne podobne wyrażenia używane przez nas przedstawiają jedynie szacunkową oszczędność, jaką możesz uzyskać kupując u nas określone narzędzia w porównaniu z głównymi najlepszymi markami i niekoniecznie oznaczają uwzględnienie wszystkich kategorii oferowanych narzędzi przez nas. Przypominamy, aby podczas składania zamówienia u nas dokładnie sprawdzić, czy faktycznie oszczędzasz połowę w porównaniu z czołowymi markami.

**VEVOR**<sup>®</sup>  
TOUGH TOOLS, HALF PRICE

BAZA MOBILNA

MODEL: GZB88093



Zdjęcie w celach informacyjnych

POTRZEBUJESZ POMOCY? SKONTAKTUJ SIĘ Z NAMI!

Masz pytania dotyczące produktu? Potrzebujesz wsparcia technicznego? Prosimy o kontakt:  
Wsparcie

techniczne i certyfikat e-gwarancji [www.vevor.com/support](http://www.vevor.com/support)

To jest oryginalna instrukcja. Przed przystąpieniem do obsługi prosimy o dokładne zapoznanie się ze wszystkimi instrukcjami. VEVOR zastrzega sobie jasną interpretację naszej instrukcji obsługi. Wygląd produktu zależy od produktu, który otrzymałeś. Proszę wybaczyć nam, że nie będziemy ponownie informować Państwa, jeśli pojawią się jakieś aktualizacje technologii lub oprogramowania naszego produktu.

## INSTRUKCJE BEZPIECZEŃSTWA



**OSTRZEŻENIE:** Przeczytaj i zrozum tę instrukcję wcześniej montażu, instalacji, obsługi lub serwisowania tego produktu.

Niezastosowanie się do tych ostrzeżeń i instrukcji może spowodować śmierć, obrażenia ciała lub uszkodzenie cennego mienia.

1. Proszę nie umieszczać go w pobliżu materiałów łatwopalnych.
2. Zabrania się przewożenia osób w jakichkolwiek warunkach.
3. Tego produktu nie można używać do wchodzenia i schodzenia po schodach.
4. Przeciążanie jest surowo zabronione.
5. Nie poruszaj się zbyt szybko, mijając dziury.

**ZACHOWAJ TE INSTRUKCJE**

## MODEL I PARAMETRY

Model	GZB88093
Tworzywo	Q235
Rozmiar podstawowy zakres regulacji	12 x 12 cali do 36x36 cali
maksymalne obciążenie	650 funtów

Lista części:

## Part list

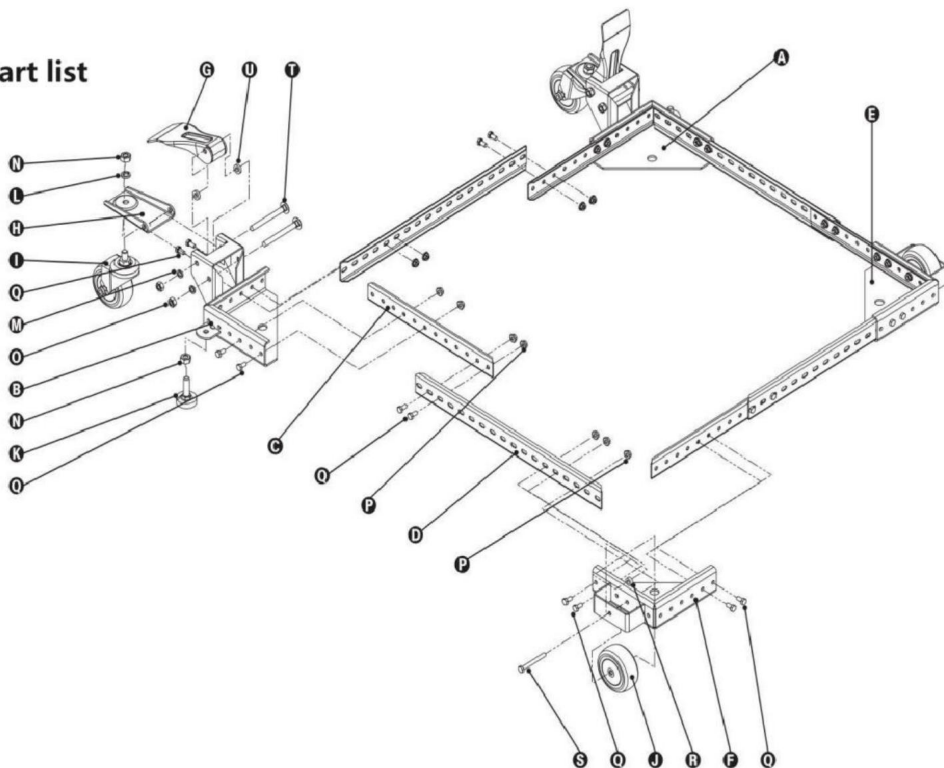

## Lista części

S/N	Opis	Ilość	S/N	Opis	Ilość
	LEWY PRZÓD NAROŻNIK 1			PODKŁADKA BLOKUJĄCA M10	2
	PRAWY PRZEDNI NAROŻNIK 1			PODKŁADKA BLOKUJĄCA M8	4
	Krótką BELKA BOCZNA	4		NAKRĘTKA M10	4
	PROWADNICA BOCZNA Lon9	4		NAKRĘTKA M8	4
	TYLNY LEWY NAROŻNIK 1			NAKRĘTKA KOŁNIERZOWA M6	26
	TYLNY PRAWY NAROŻNIK 1			ŚRUBA SZEŚCIOKĄTNA M6-12	24
	DŹWIGNIA NOŻNA	2		NYLONOWA TULEJA KOŁA	2
	PŁYTA OBROTOWA	2		ŚRUBA OSI M6-55	2
	3-CALOWE KÓŁKO OBROTOWE	2		ŚRUBA PODSTAWOWA M8-85	4
	3-calowe KOŁO	2		NYLONOWA TULEJA DŹWIGNI NOŻNEJ 4	
	GUMOWA STOPKA ŚLIZGOWA 2				

## Assembly Examples

Be sure to follow Safety and Assembly Instructions. Keep in mind the actual operation of your machine and the effect it has on overall stability.

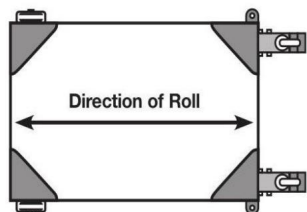

A long, narrow base, such as on a jointer, would benefit from this arrangement. Most machines may be arranged to the convenience of the user.

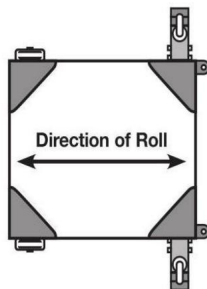

A short, narrow base, such as found on a drill press or bandsaw, may benefit from this arrangement. Due to swivel rotation, base may sit out of level. Rotate swivel wheel away from base to correct.

4. Select and arrange the Corners and the Side Rails as necessary to assemble the base to your machine's footprint. Position Side Rails into corners as far as is practical.

- a. Below is a standard arrangement, but many different arrangements are possible. You can use 1, 2, or 3 rails on either side.

- b. To expand the functionality of this mobile base on larger machine's, purchase additional rails online at <http://www.boratool.com/rail-kit-w-hardware-pm1000-htc2000>

5. Bolt the Side Rails to the corners and each other using these simple rules:

- a. All connections require the use of (2) M6-12 bolts and (2) M6 nuts at each end of the connections

**Note: Insert bolts so that the nuts are on the INSIDE of the mobile base.**

6. Re-check dimensions with the tape measure, then tighten all bolts and nuts. If you are building a square configuration the measurements between diagonal corners should be relatively close.

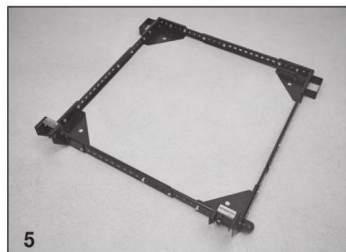
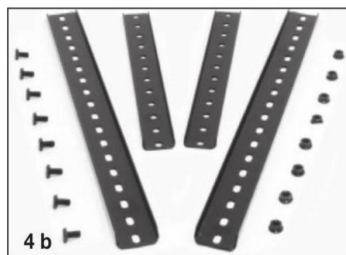
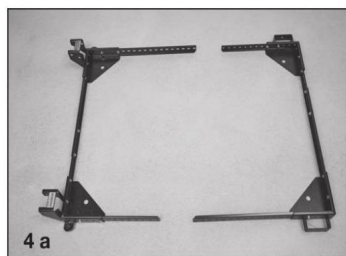

## Attaching Wheels and Casters

1. Attach swivel plate "H" to the Front Right corner "B" using M8-85 carriage bolt "T", M8 lock washer "M", and M8 nut "O".
2. Attach foot lever "G" to the Front Right corner "B".
  - a. Slide the M8-85 carriage bolt "T" through the hole on the inside of the corner, hang a nylon foot lever bushing "U" on the end of the bolt. Insert an extra bolt into the hole from the outside of the corner just far enough to act as a "hanger" for the other nylon bushing.
  - b. Carefully slide the foot lever into place between the nylon bushings.
  - c. Push the carriage bolt through the foot lever, nylon washers, and opposite side of the corner. Secure it using the M8 lock washer "M".
3. Attach swivel caster "I" to swivel plate "H" using M10 lock washer "L" and M10 nut "N".

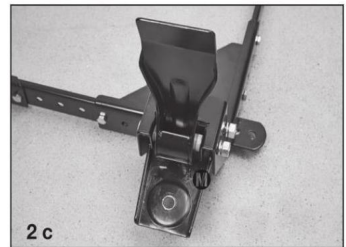
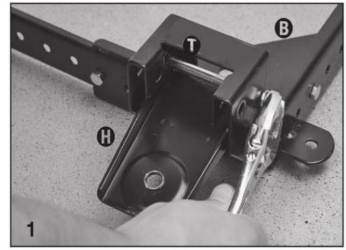

4. Insert rubber glide foot “K” into the threaded hole on the side of the corner. Spin M10 nut “N” onto the top of the rubber glide foot.

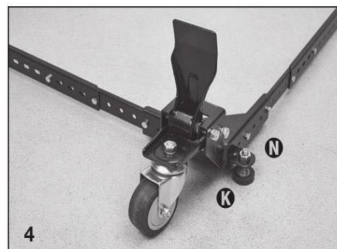

5. Repeat steps 1 through 4 on the Front Left corner “A”.

6. Attach 3” wheel “J” to Rear Right corner “F”.

a. Insert extra bolt into the axle hole from the inside of the corner. Insert the bolt into the wheel housing just far enough to act as a “hanger” for the nylon wheel bushing “G”.

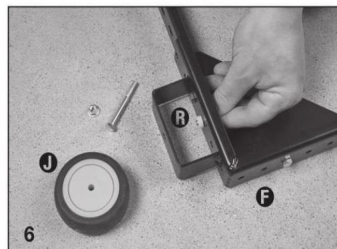

7. Carefully align 3” wheel “J”, and insert M6-55 bolt “S” through hole in the outer edge of wheel housing, through wheel “J”, through nylon bushing “G”.



8. Secure the axle bolt using using M6 flange nut “P”.

9. Repeat steps 6-8 for back-left corner “E”, assembly is now complete!

a. Test mobility without machine.

b. Add machine and secure it to the mobile base.

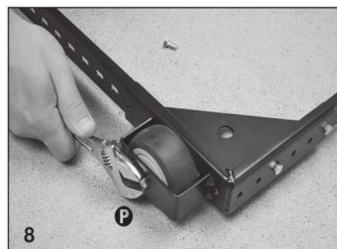

10. Lift your machine or item to be mobilized into place.



**CAUTION: Check stability in both the up and down positions before using. Failure to follow safety and assembly instructions may result in personal injury or damage to product.**

## KONSERWACJA

1. Unikaj długotrwałej ekspozycji na słońce, aby uniknąć starzenia.
2. Przed użyciem sprawdź akcesoria pod kątem zużycia, pęknięć i innych uszkodzeń i natychmiast wymień wadliwe akcesoria.

Producent: Shanghaimuxinmuyeyouxiangongsi

Adres: Shuangchenglu 803nong11hao1602A-1609shi, baoshanqu, szanghaj  
200000 CN.

Import do AUS: SIHAO PTY LTD, 1 ROKEVA STREETEASTWOOD NSW  
2122 Australii

Import do USA: Sanven Technology Ltd., Suite 250, 9166 Anaheim Place, Rancho  
Cucamonga, CA 91730

REP	REZENT KE
-----	-----------

E-CrossStu GmbH

Mainzer Landstr.69, 60329 Frankfurt nad Menem.

REPUBLIKA	Wielkiej Brytanii
-----------	-------------------

YH CONSULTING SPÓŁKA Z OGRANICZONĄ ODPOWIEDZIALNOŚCIĄ

C/O YH Consulting Limited Office 147, Centurion House,  
London Road, Staines-upon-Thames, Surrey, TW18 4AX

# VEVOR®

**TOUGH TOOLS, HALF PRICE**

Wsparcie techniczne i certyfikat e-gwarancji  
[www.vevor.com/support](http://www.vevor.com/support)



# VEVOR<sup>®</sup>

## TOUGH TOOLS, HALF PRICE

Technische ondersteuning en e-garantiecertificaat  
[www.vevor.com/support](http://www.vevor.com/support)

## MOBIELE BASIS

**MODEL: GZB88093**

Wij blijven ons inzetten om u gereedschap te bieden tegen een concurrerende prijs. 'Bespaar de helft', 'Halve prijs' of andere soortgelijke uitdrukkingen die door ons worden gebruikt vertegenwoordigen slechts een schatting van de besparingen die u zou kunnen profiteren als u bepaalde gereedschappen bij ons koopt in vergelijking met de grote topmerken en betekenen niet noodzakelijkerwijs dat ze alle aangeboden categorieën gereedschappen dekken. door ons. U wordt er vriendelijk aan herinnerd om bij het plaatsen van een bestelling bij ons zorgvuldig te verifiëren of u daadwerkelijk de helft bespaart in vergelijking met de grote topmerken.

# VEVOR<sup>®</sup>

TOUGH TOOLS, HALF PRICE

## MOBIELE BASIS

MODEL: GZB88093



Foto ter referentie

**HULP NODIG? NEEM CONTACT MET ONS OP!**

Heeft u productvragen? Technische ondersteuning nodig? Neem gerust contact met ons op:

**Technische**

**ondersteuning en e-garantiecertificaat [www.vevor.com/  
support](http://www.vevor.com/support)**

Dit is de originele instructie. Lees alle instructies in de handleiding zorgvuldig door voordat u ermee aan de slag gaat. VEVOR behoudt zich een duidelijke interpretatie van onze gebruikershandleiding voor. Het uiterlijk van het product is afhankelijk van het product dat u heeft ontvangen. Vergeef ons alstublieft dat we u niet opnieuw zullen informeren als er technologie- of software-updates zijn voor ons product.

## VEILIGHEIDSINSTRUCTIES



**WAARSCHUWING: Lees en begrijp eerst deze handleiding**

**assembleren, installeren, bedienen of onderhouden van dit product.**

**Het niet opvolgen van deze waarschuwingen en instructies kan leiden tot overlijden, persoonlijk letsel of schade aan waardevolle eigendommen.**

1. Plaats het niet in de buurt van brandbare materialen.
2. Het is onder geen enkele omstandigheid verboden mensen te vervoeren.
3. Dit product kan niet worden gebruikt om trappen op of af te gaan.
4. Overbelasting is ten strengste verboden.
5. Beweeg niet te snel bij het passeren van kuilen.

## BEWAAR DEZE INSTRUCTIES

## MODEL EN PARAMETERS

Model	GZB88093
Materiaal	Q235
Basisgrootte aanpassingsbereik	12x12 inch tot 36x36 inch
maximale belasting	650 pond

Onderdelenlijst:

## Part list

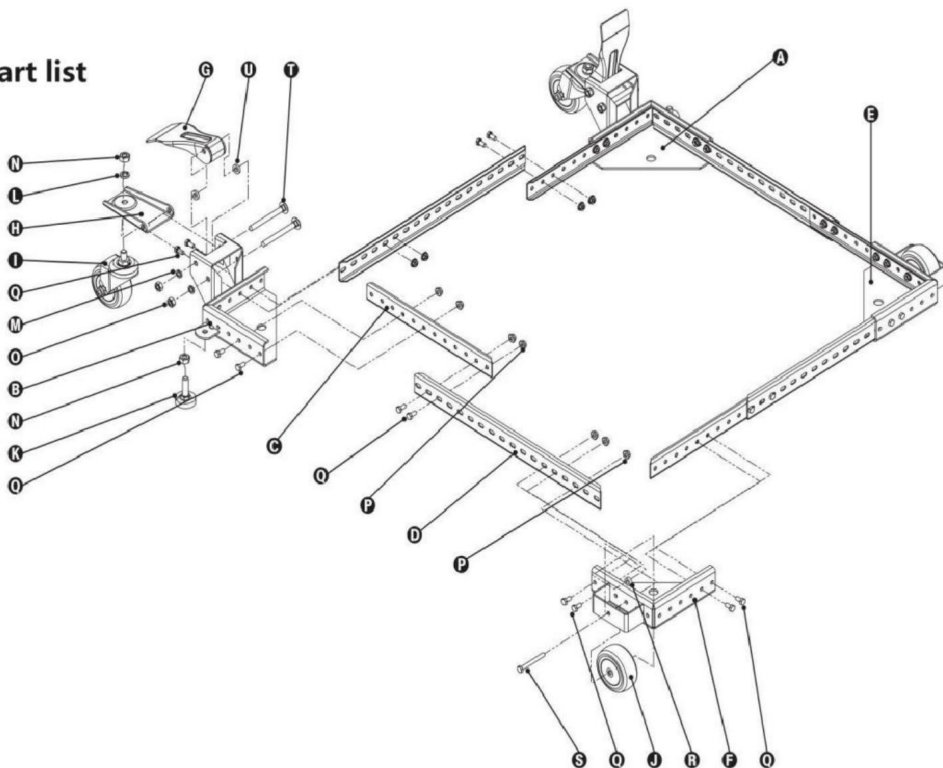

## Onderdelenlijst

S/N	Beschrijving	Aantal	S/N	Beschrijving	Aantal
ÿ	VOOR LINKER HOEK 1 ÿ			M10 BORGRING	2
ÿ	RECHTER VOORHOEK 1 ÿ			M8 BORGRING	4
ÿ	Korte ZIJREK	4 ÿ		M10 MOER	4
ÿ	Lon9 ZIJREK	4ÿ		M8 MOER	4
ÿ	ACHTER LINKER HOEK 1 ÿ			M6 FLENSMOER	26
ÿ	RECHTER ACHTER HOEK 1 ÿ			M6-12 ZESKANTIGE BOUT	24
ÿ	VOET HENDEL	2 ÿ	NYLON	WIELBUS	2
ÿ	DRAAIPLAAT	2 ÿ		M6-55 ASBOUT	2
ÿ	3" ZWENKWIEL	2 ÿ		M8-85 DRAAGBOUT	4
ÿ	3" WIEL	2 ÿ	NYLON	VOETHENDELBUS 4	
ÿ	RUBBEREN GLIJVOET 2				

## Assembly Examples

Be sure to follow Safety and Assembly Instructions. Keep in mind the actual operation of your machine and the effect it has on overall stability.

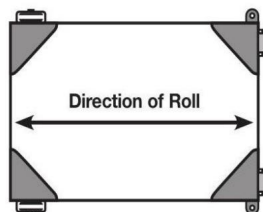

A long, narrow base, such as on a jointer, would benefit from this arrangement. Most machines may be arranged to the convenience of the user.

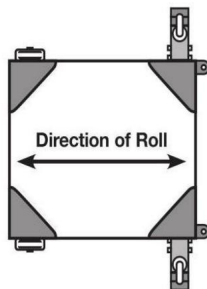

A short, narrow base, such as found on a drill press or bandsaw, may benefit from this arrangement. Due to swivel rotation, base may sit out of level. Rotate swivel wheel away from base to correct.

4. Select and arrange the Corners and the Side Rails as necessary to assemble the base to your machine's footprint. Position Side Rails into corners as far as is practical.

- a. Below is a standard arrangement, but many different arrangements are possible. You can use 1, 2, or 3 rails on either side.

- b. To expand the functionality of this mobile base on larger machine's, purchase additional rails online at <http://www.boratool.com/rail-kit-w-hardware-pm1000-htc2000>

5. Bolt the Side Rails to the corners and each other using these simple rules:

- a. All connections require the use of (2) M6-12 bolts and (2) M6 nuts at each end of the connections

**Note: Insert bolts so that the nuts are on the INSIDE of the mobile base.**

6. Re-check dimensions with the tape measure, then tighten all bolts and nuts. If you are building a square configuration the measurements between diagonal corners should be relatively close.

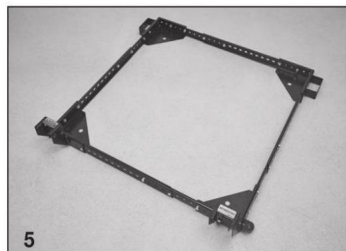
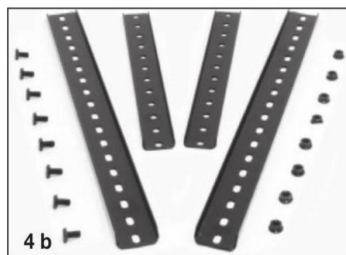
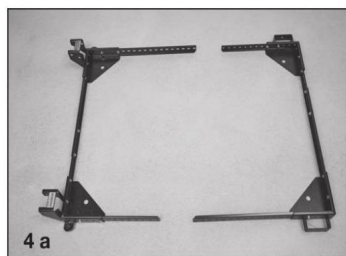

## Attaching Wheels and Casters

1. Attach swivel plate "H" to the Front Right corner "B" using M8-85 carriage bolt "T", M8 lock washer "M", and M8 nut "O".
2. Attach foot lever "G" to the Front Right corner "B".
  - a. Slide the M8-85 carriage bolt "T" through the hole on the inside of the corner, hang a nylon foot lever bushing "U" on the end of the bolt. Insert an extra bolt into the hole from the outside of the corner just far enough to act as a "hanger" for the other nylon bushing.
  - b. Carefully slide the foot lever into place between the nylon bushings.
  - c. Push the carriage bolt through the foot lever, nylon washers, and opposite side of the corner. Secure it using the M8 lock washer "M".
3. Attach swivel caster "I" to swivel plate "H" using M10 lock washer "L" and M10 nut "N".

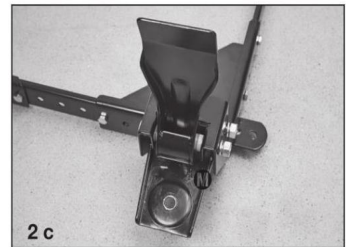
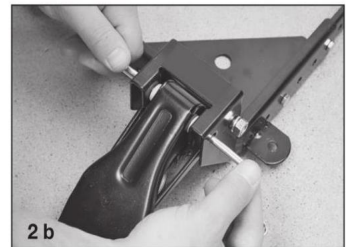
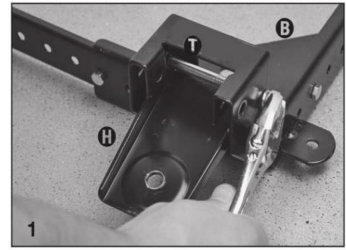

4. Insert rubber glide foot “K” into the threaded hole on the side of the corner. Spin M10 nut “N” onto the top of the rubber glide foot.

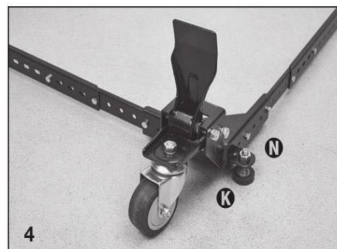

5. Repeat steps 1 through 4 on the Front Left corner “A”.

6. Attach 3” wheel “J” to Rear Right corner “F”.

a. Insert extra bolt into the axle hole from the inside of the corner. Insert the bolt into the wheel housing just far enough to act as a “hanger” for the nylon wheel bushing “G”.

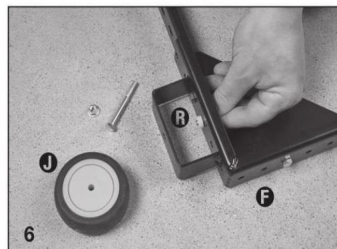

7. Carefully align 3” wheel “J”, and insert M6-55 bolt “S” through hole in the outer edge of wheel housing, through wheel “J”, through nylon bushing “G”.



8. Secure the axle bolt using using M6 flange nut “P”.

9. Repeat steps 6-8 for back-left corner “E”, assembly is now complete!

a. Test mobility without machine.

b. Add machine and secure it to the mobile base.

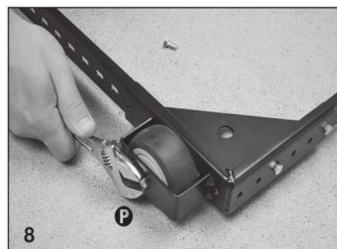

10. Lift your machine or item to be mobilized into place.



**CAUTION: Check stability in both the up and down positions before using. Failure to follow safety and assembly instructions may result in personal injury or damage to product.**

## ONDERHOUD

1. Vermijd langdurige blootstelling aan de zon om veroudering te voorkomen.
2. Inspecteer accessoires vóór gebruik op slijtage, scheuren en andere schade en vervang defecte accessoires onmiddellijk.

**Fabrikant:** Shanghaimuxinmuyeyouxiangongsi

**Adres:** Shuangchenglu 803nong11hao1602A-1609shi, baoshanqu, shanghai  
200000 CN.

**Geïmporteerd naar AUS:** SIHAO PTY LTD, 1 ROKEVA STREETEASTWOOD NSW  
2122 Australië

**Geïmporteerd naar de VS:** Sanven Technology Ltd., Suite 250, 9166 Anaheim  
Place, Rancho Cucamonga, CA 91730



E-CrossStu GmbH

Mainzer Landstr.69, 60329 Frankfurt am Main.



YH CONSULTING LIMITED.

C/O YH Consulting Limited Kantoor 147, Centurion House,  
London Road, Staines-upon-Thames, Surrey, TW18 4AX

# VEVOR®

**TOUGH TOOLS, HALF PRICE**

**Technische ondersteuning en e-garantiecertificaat**

**[www.vevor.com/support](http://www.vevor.com/support)**



# **VEVOR<sup>®</sup>**

## **TOUGH TOOLS, HALF PRICE**

Teknisk support och e-garanticertifikat

[www.vevor.com/support](http://www.vevor.com/support)

## **MOBIL BAS**

**MODELL: GZB88093**

Vi fortsätter att vara engagerade i att ge dig verktyg till konkurrenskraftiga priser. "Spara hälften", "halva priset" eller andra liknande uttryck som används av oss representerar bara en uppskattning av besparingar du kan dra nytta av att köpa vissa verktyg hos oss jämfört med de stora toppmärkena och betyder inte nödvändigtvis att täcka alla kategorier av verktyg som erbjuds av oss. Du påminns vänligen om att noggrant kontrollera när du gör en beställning hos oss om du faktiskt sparar hälften i jämförelse med de främsta stora varumärkena.

# VEVOR®

TOUGH TOOLS, HALF PRICE

## MOBIL BAS

MODELL: GZB88093



Foto för referens

**BEHÖVER HJÄLP? KONTAKTA OSS!**

Har du produktfrågor? Behöver du teknisk support? Kontakta oss gärna: **Teknisk support och e-**  
**garanticertifikat [www.vevor.com/support](http://www.vevor.com/support)**

Detta är den ursprungliga instruktionen, läs alla instruktioner noggrant innan du använder den. VEVOR reserverar sig för en tydlig tolkning av vår användarmanual. Utseendet på produkten är beroende av den produkt du fått. Ursäkta oss att vi inte kommer att informera dig igen om det finns någon teknik eller mjukvaruuppdateringar på vår produkt.

## SÄKERHETSINSTRUKTIONER



**VARNING: Läs och förstå denna manual innan**

**montering, installation, drift eller service av denna produkt.**

**Underlåtenhet att följa dessa varningar och instruktioner kan orsaka dödsfall, personskada eller skada på värdefull egendom.**

1. Placera den inte nära brandfarliga material.
2. Det är förbjudet att transportera människor under alla förhållanden.
3. Denna produkt kan inte användas för att gå upp eller ner för trappor.
4. Överbelastning är strängt förbjuden.
5. Rör dig inte för snabbt när du passerar gropar.

## SPARA DESSA INSTRUKTIONER

### MODELL OCH PARAMETRAR

Modell	GZB88093
Material	Q235
Basstorlek justeringsområde	12x12 tum upp till 36x36 tum
maximal belastning	650 lbs

Dellista:

## Part list

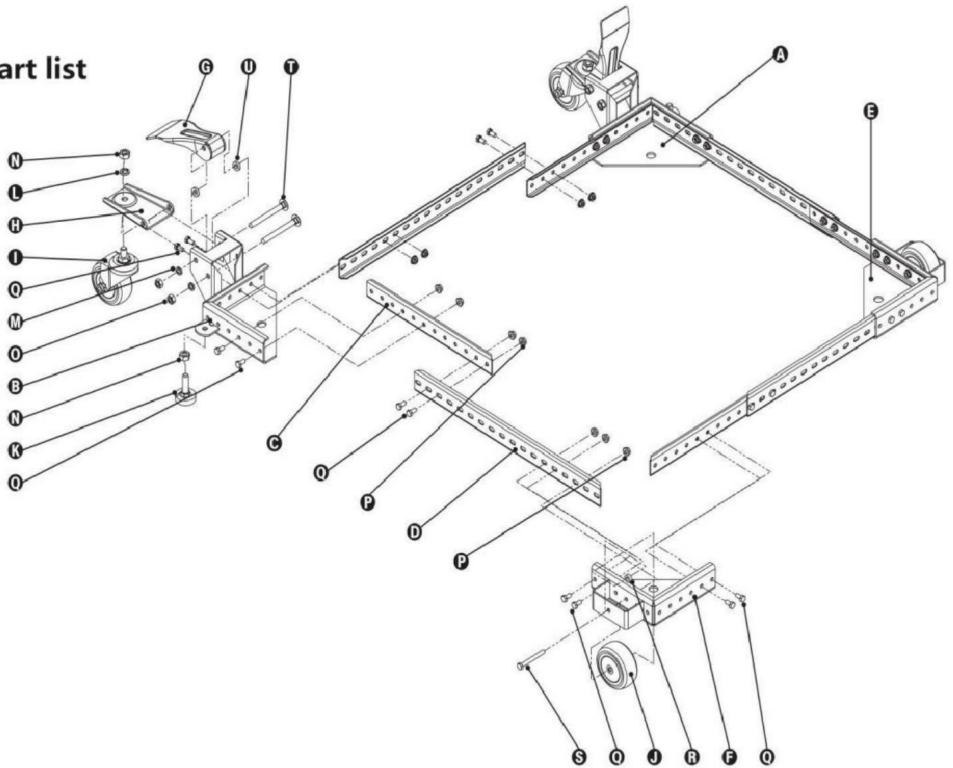

## Delarlista

S/N	Beskrivning	Antal	S/N	Beskrivning	Antal
ÿ	FRAMVÄNSTER HÖRN 1 ÿ			M10 LÅSBRICKA	2
ÿ	FRAMRE HÖGER HÖRN 1 ÿ			M8 LÅSBRICKA	4
ÿ	Kort SIDORÄNNE	4 ÿ		M10 MUTTER	4
ÿ	Lång SIDORÄN	4 ÿ		M8 MUTTER	4
ÿ	BAKRE VÄNSTER HÖRN 1 ÿ			M6 FLÄNSMUTTER	26
ÿ	BAK HÖGER HÖRN 1 ÿ			M6-12 HEXBOLTEN	24
ÿ	FOTSPAK	2 ÿ		NYLONHJULBUSSNING	2
ÿ	VÄNDPLÅTA	2 ÿ		M6-55 AXELBOLT	2
ÿ	3" SVÄNGLIG HJUL	2 ÿ		M8-85 BORDBULT	4
ÿ	3" HJUL	2 ÿ		NYLON FOTSPAKSBUSNING 4	
ÿ	GUMMI GLIDFOT 2				

## Assembly Examples

Be sure to follow Safety and Assembly Instructions. Keep in mind the actual operation of your machine and the effect it has on overall stability.

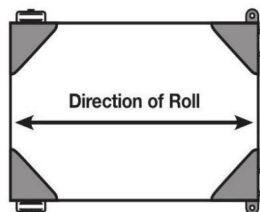

A long, narrow base, such as on a jointer, would benefit from this arrangement. Most machines may be arranged to the convenience of the user.

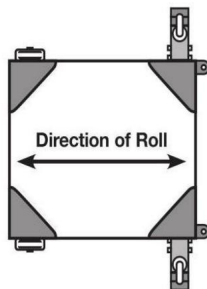

A short, narrow base, such as found on a drill press or bandsaw, may benefit from this arrangement. Due to swivel rotation, base may sit out of level. Rotate swivel wheel away from base to correct.

4. Select and arrange the Corners and the Side Rails as necessary to assemble the base to your machine's footprint. Position Side Rails into corners as far as is practical.

- a. Below is a standard arrangement, but many different arrangements are possible. You can use 1, 2, or 3 rails on either side.

- b. To expand the functionality of this mobile base on larger machine's, purchase additional rails online at <http://www.boratool.com/rail-kit-w-hardware-pm1000-htc2000>

5. Bolt the Side Rails to the corners and each other using these simple rules:

- a. All connections require the use of (2) M6-12 bolts and (2) M6 nuts at each end of the connections

**Note: Insert bolts so that the nuts are on the INSIDE of the mobile base.**

6. Re-check dimensions with the tape measure, then tighten all bolts and nuts. If you are building a square configuration the measurements between diagonal corners should be relatively close.

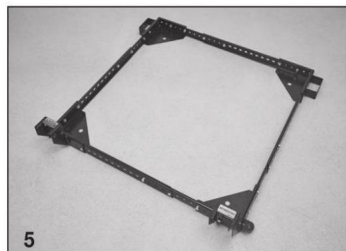
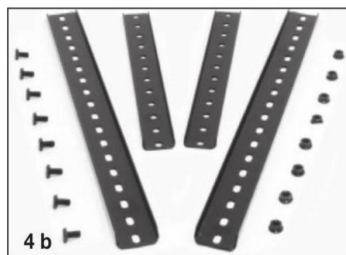
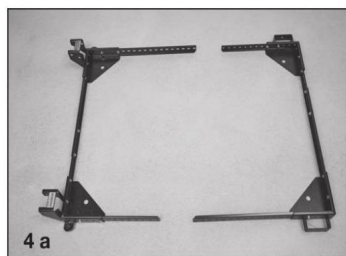

## Attaching Wheels and Casters

1. Attach swivel plate "H" to the Front Right corner "B" using M8-85 carriage bolt "T", M8 lock washer "M", and M8 nut "O".
2. Attach foot lever "G" to the Front Right corner "B".
  - a. Slide the M8-85 carriage bolt "T" through the hole on the inside of the corner, hang a nylon foot lever bushing "U" on the end of the bolt. Insert an extra bolt into the hole from the outside of the corner just far enough to act as a "hanger" for the other nylon bushing.
  - b. Carefully slide the foot lever into place between the nylon bushings.
  - c. Push the carriage bolt through the foot lever, nylon washers, and opposite side of the corner. Secure it using the M8 lock washer "M".
3. Attach swivel caster "I" to swivel plate "H" using M10 lock washer "L" and M10 nut "N".

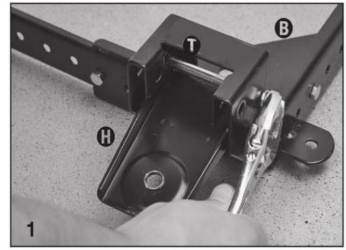

4. Insert rubber glide foot “K” into the threaded hole on the side of the corner. Spin M10 nut “N” onto the top of the rubber glide foot.

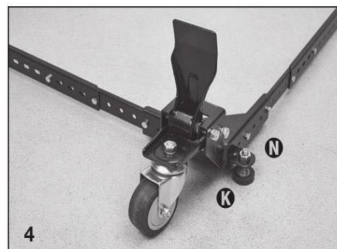

5. Repeat steps 1 through 4 on the Front Left corner “A”.

6. Attach 3” wheel “J” to Rear Right corner “F”.

a. Insert extra bolt into the axle hole from the inside of the corner. Insert the bolt into the wheel housing just far enough to act as a “hanger” for the nylon wheel bushing “G”.

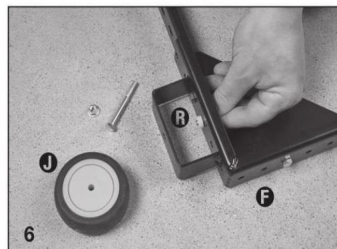

7. Carefully align 3” wheel “J”, and insert M6-55 bolt “S” through hole in the outer edge of wheel housing, through wheel “J”, through nylon bushing “G”.



8. Secure the axle bolt using using M6 flange nut “P”.

9. Repeat steps 6-8 for back-left corner “B”, assembly is now complete!

a. Test mobility without machine.

b. Add machine and secure it to the mobile base.

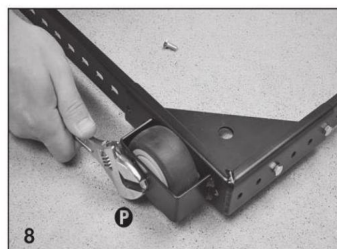

10. Lift your machine or item to be mobilized into place.



**CAUTION: Check stability in both the up and down positions before using. Failure to follow safety and assembly instructions may result in personal injury or damage to product.**

## UNDERHÅLL

1. Undvik långvarig exponering för solen för att undvika åldrande.
2. Inspektera tillbehören för slitage, sprickor och andra skador före användning och byt ut defekta tillbehör omedelbart.

**Tillverkare:** Shanghaimuxinmuyeyouxiangongsi

**Adress:** Shuangchenglu 803nong11hao1602A-1609shi, baoshanqu, shanghai 200000 CN.

**Importerad till AUS:** SIHAO PTY LTD, 1 ROKEVA STREETEASTWOOD NSW 2122 Australien

**Importerad till USA:** Sanven Technology Ltd., Suite 250, 9166 Anaheim Place, Rancho Cucamonga, CA 91730



E-CrossStu GmbH

Mainzer Landstr.69, 60329 Frankfurt am Main.



YH CONSULTING LIMITED.

C/O YH Consulting Limited Office 147, Centurion House, London Road, Staines-upon-Thames, Surrey, TW18 4AX

# VEVOR®

**TOUGH TOOLS, HALF PRICE**

**Teknisk support och e-garanticertifikat**

**[www.vevor.com/support](http://www.vevor.com/support)**