

# **VEVOR<sup>®</sup>**

**TOUGH TOOLS, HALF PRICE**

Technical Support and E-Warranty Certificate [www.vevor.com/support](http://www.vevor.com/support)

## **STANDARD BABY STROLLER**

**MODEL:C628**

We continue to be committed to provide you tools with competitive price.

"Save Half", "Half Price" or any other similar expressions used by us only represents an estimate of savings you might benefit from buying certain tools with us compared to the major top brands and does not necessarily mean to cover all categories of tools offered by us. You are kindly reminded to verify carefully when you are placing an order with us if you are actually saving half in comparison with the top major brands.

# VEVOR®

TOUGH TOOLS, HALF PRICE

MODEL:C628



## NEED HELP? CONTACT US!

Have product questions? Need technical support? Please feel free to contact us:

**Technical Support and E-Warranty Certificate**  
**[www.vevor.com/support](http://www.vevor.com/support)**

This is the original instruction, please read all manual instructions carefully before operating. VEVOR reserves a clear interpretation of our user manual. The appearance of the product shall be subject to the product you received. Please forgive us that we won't inform you again if there are any technology or software updates on our product.

# Safety

## **CAUTION:**

TO AVOID INJURY OR DEATH

Read these instructions carefully before use and keep for future reference. The child may be hurt if you do not follow these instructions.

## **WARNING!**

Follow the manufacturers instructions.

## **WARNING!**

Always apply the brakes whenever the stroller is stationary.

## **WARNING!**

Do not leave the child unattended.

## **WARNING!**

Secure the child in the harness at all times.

## **WARNING!**

Do not carry extra children or bags on this stroller.

## **WARNING!**

Make sure children are clear of any moving parts if you adjust the stroller. Otherwise they may be injured.

## **WARNING!**

Use the harness at all times.

## **WARNING!**

Use the tether strap to stop the stroller rolling away.

## **WARNING!**

check that the pram body or seat unit attachment devices are correctly engaged before use.

**WARNING!**

the product is not suitable for running or skating.

**Remember, your child's safety is your responsibility:**

- Always fit and use the tether strap when the stroller is in use.
- When using the stroller, always ensure your hand is positioned in and around
  - the tether strap. The strap is a compulsory safety feature which must be used
  - at all times. It is for the safety and benefit of your child.
- This product is suitable for one child in an upright or reclined position from birth and up to 15kg.
- The stroller will become unstable if the manufacturer's recommended load is exceeded.
- The correct use and maintenance of this stroller are essential.
- Be sure that all clamps and buckles are securely fixed and in place before use.
- When in the stroller, your child must always wear the safety harness,
  - correctly fitted and adjusted, at all times.
  - Always use the harness correctly fitted and adjusted, with your child in the seat.
  - Never leave the harness buckles when not fitted to a child in the stroller
  - because the harness can form loops which may pose a strangulation hazard.
  - When in use, the head of the child in the product should never be lower
  - than the body of the child.
- Use the stroller on flat or gentle sloping surfaces. It may be unstable on
  - higher sloping and uneven surfaces - be aware of the possibility of the stroller tipping over.
  - Care should be taken if the stroller is used on stairs or escalators.
  - Care must be taken when folding and unfolding the product to prevent

finger entrapment.

- Check all parts before use for breakage or fatigue. Discontinue use immediately if any part is found to be damaged or broken.
- The basket can carry a maximum load of 5kg.
- This product is suitable to be used with a new born baby. Please ensure the seat is in its full recline position when using with a new born child.
- Do not carry additional children. This stroller is manufactured for the use with one child only.
- Any load attached to the handle and/or on the back of the backrest and/or on the sides will affect the stability of the product.
- Always be aware of the risks provided by fire and other significant sources of heat such as radiators etc. which may be in the immediate vicinity of your stroller.
- Be aware of the risk of open fire and other sources of heat, such as electric bar fires, gas fires etc. in the vicinity of the stroller.
- It may be unsafe to use any accessories other than those approved by manufacturer.
- Keep the plastic packaging away from children to avoid danger of suffocation.
- Take extra care in windy conditions.
- Lift and carry the stroller safely. Please ensure all locking devices are engaged before lifting stroller - injuries can occur from moving parts.
- Only carry stroller if folded and locking or storage latches are engaged. Please apply storage latch if latch does not engage automatically.
- Never leave a raincover, hood or apron on the product indoors, in a hot atmosphere or near a heat source, as your child may overheat.
- To prevent damage, always remove a raincover before folding the pram.
- This product is intended for domestic use only. It is not for commercial use.

**This product conforms to AS/NZS 2088:2013**

## STROLLER DO'S & DON'TS



### **Do use your brakes!**

Ensure the parking brake is engaged during the loading and unloading of children & when the stroller is stationary.



### **Do always use the restraint system!**

Ensure that the child restraint system is correctly fitted at all times.



### **Do keep your stroller clean and dirt free.**

Use a clean white cloth, warm water and a mild detergent to keep your stroller clean.



### **Do always keep two hands on the handles when pushing.**

You could lose control of your stroller if not steering with both hands.



### **Do follow manufacturers instructions when assembling and using your stroller.**

For safety, please refer to our instruction manuals or contact customer support if you're unsure.



**Don't use your stroller up and down stairs!**

Don't use your stroller up or down stairs or to bump kerbs.



**Don't hang bags off the handles!**

Bags and other items should not be hung from the handles as this can affect the stability of the stroller.



**Don't run or skate with your stroller!**

Our products are not suitable for running or skating.



**Don't carry the stroller with baby inside!**

Our strollers are not designed to be carried with your baby inside them.



**Don't put hot drinks in the cup holder.**

Hot drinks burn and can easily spill from the bottle holder.



**Don't jetwash your stroller.**

Some jet washers are very powerful and could damage parts of your stroller!



**Don't leave your child un-attended in their stroller.**

Always keep your child and stroller in view to avoid accidents.



**Don't treat your stroller like a trolley.**

Don't load your stroller up with all your shopping as they are not built for this purpose and could cause damage.



**Don't use your stroller as a bumper cart!**

Damage can easily occur if your stroller is knocked into other things.



**Don't smoke around your stroller**

We wouldn't want your stroller or little one getting hurt or damaged!





**Don't leave your stroller unattended on extreme gradients.**

Even with your brakes on your stroller is at risk from tipping or sliding on extreme gradients!



**Don't sit in the strollers unless the user is under the guideline weight.**

Our strollers are designed to hold a maximum weight. If exceeded this will cause damage!



**Do enjoy your product!**

Go out and have fun adventures with your little one!

# ASSEMBLY INSTRUCTIONS

## Components

Open the carton and take out the frame and parts.

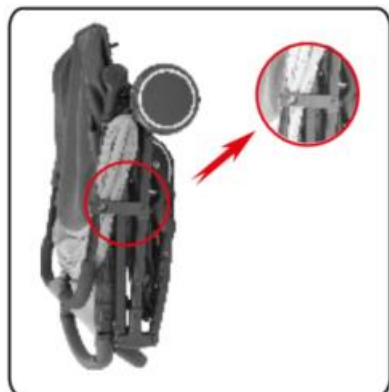

## Step 1

Open the locking hook to unfold the frame , and lift the handle backward and upward with both hands . The stroller is fully extended when you hear a " click " sound . Unfold the canopy in the direction of the arrow.

## Step 2

Insert the front bumper into the joints . You must hear a clear " click " Press the button in the middle of the joints to remove the front bumper .



# OPERATION

## FIX THE DIRCTION OF FRONTWHEELS

Put the front wheels in forward direction and press down the fixer . You should hear a clear "click".

Pull up the fixer and wheel can be flexible.

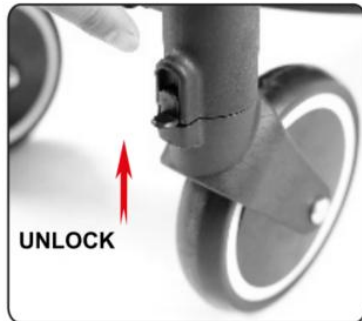
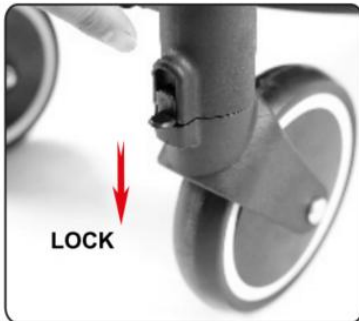

## BRAKE OPERATION

Press down the brake lever with your foot to activate the brake.

Pull up the brake lever with your foot to release the brake.

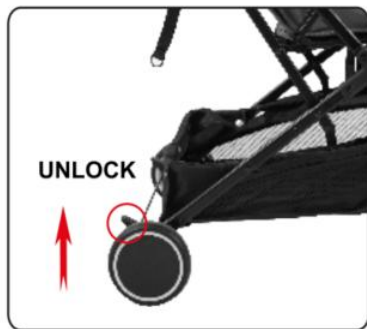
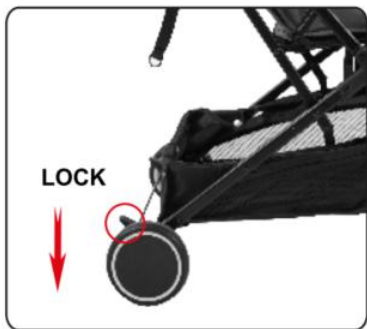

### **BACKREST ADJUSTMENT**

To raise the backrest , squeeze the clip on the reclining harness and gently pull up the backrest to the height you needed.

To reline the backrest , squeeze the clip on the reclining harness and gently lower the backrest.

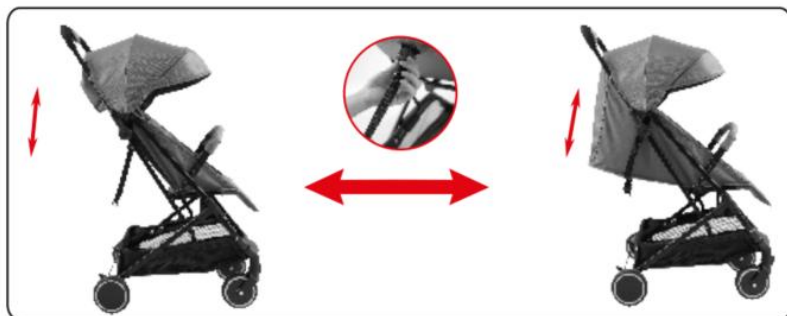

### **FOOTREST ADJUSTMENT**

Hold the footrest adjustment button with both hands to adjust the position of the footrest freely ( the button is hidden )

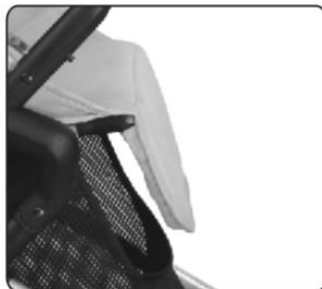

## HOW TO FOLD



Fold the canopy backward firstly . Push the unlock button to the left position , then push forward to fold the frame , the frame will be locked automatically.

## ATTENTION

### HANDLE OPERATION

The stroller is equipped with a 5-pointsafety belt to ensure the safety . Adjust the shoulder , waist and crotch harness according to the size of the infant.

Press and hold the release button to release the harness.



### Handle grip operation

The handle grip must be fully extended when using the stroller as the height of the handle grip can not be adjusted.

Children are not allowed to ride without the handle grip fully extended.



## Care

### **Maintenance:**

The product requires regular maintenance to ensure correct and safe performance.

Regularly inspect the wheels, locks, brakes, harness, catches, seat adjusters, joints and fixings to ensure they are clean, operating correctly and in full working order.

Replace tyres if they are excessively worn.

Do not use this product if any part is broken, torn or missing and use only spares provided by the manufacturer.

If parts become stiff or difficult to operate, ensure dirt is not the cause, then try a light application of a silicon lubricant, ensuring it penetrates between the components. Regular lubrication of moving parts will extend the life of your product and make opening and folding easier.

The stroller should be serviced and reconditioned before using for a second baby, or within 18 months, whichever is sooner.

After exposure to damp conditions, dry off with a soft cloth and leave fully open in a warm environment. Storing damp will encourage mildew to form. Store in a dry place.

Do not leave in sunlight for prolonged periods as some fabrics may fade.

### **Cleaning:**

Spot or sponge clean fabrics with mild detergent. Use mild soap or

upholstery shampoo. Wash separately. NEVER use bleach. Dry in shade thoroughly before reuse and avoid direct heat and sunlight. Do not iron. Do not dry clean.

Wipe clean plastics and metals with damp cloth. Never clean any part of the product with abrasive, ammonia based, bleach based or spirit type cleaners.

Ensure the product is fully dry before use or storage.

Always ensure the product is stored in a dry place to prevent mold or mildew developing.

**Manufacturer:** Shanghai muxinmuyeyouxiangongsi

**Address:** Shuangchenglu 803nong11hao1602A-1609shi, baoshanqu, shanghai 200000 CN.

**Imported to AUS:** SIHAO PTY LTD. 1 ROKEVA STREET EASTWOOD NSW 2122 Australia

**Imported to USA:** Sanven Technology Ltd. Suite 250, 9166 Anaheim Place, Rancho Cucamonga, CA 91730

<b>EC</b>	<b>REP</b>
-----------	------------

E-CrossStu GmbH  
Mainzer Landstr.69, 60329 Frankfurt am Main.

<b>UK</b>	<b>REP</b>
-----------	------------

YH CONSULTING LIMITED.  
C/O YH Consulting Limited Office 147, Centurion House, London Road, Staines-upon-Thames, Surrey, TW18 4AX

**VEVOR**<sup>®</sup>

**TOUGH TOOLS, HALF PRICE**

**Technical Support and E-Warranty Certificate**

**[www.vevor.com/support](http://www.vevor.com/support)**