

VEVOR[®]

TOUGH TOOLS, HALF PRICE

Technical Support and E-Warranty Certificate www.vevor.com/support

ICE MACHINE

MODEL:SKF300BLS/SKF-500BLS

We continue to be committed to provide you tools with competitive price. "Save Half", "Half Price" or any other similar expressions used by us only represents an estimate of savings you might benefit from buying certain tools with us compared to the major top brands and does not necessarily mean to cover all categories of tools offered by us. You are kindly reminded to verify carefully when you are placing an order with us if you are actually Saving Half in comparison with the top major brands.

VEVOR®

TOUGH TOOLS, HALF PRICE

ICE MACHINE

MODEL:SKF300BLS/SKF-500BLS

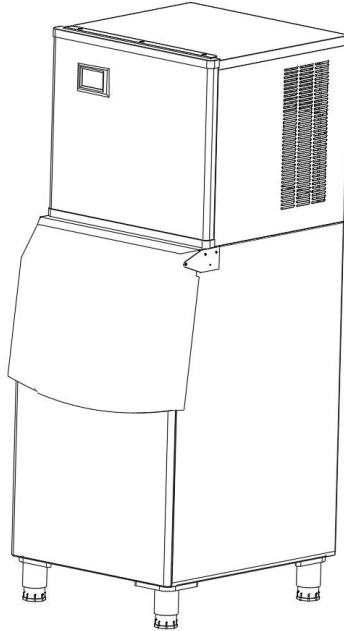



NEED HELP? CONTACT US!



Have product questions? Need technical support? Please feel free to contact us:

Technical Support and E-Warranty Certificate
www.vevor.com/support

This is the original instruction, please read all manual instructions carefully before operating. VEVOR reserves a clear interpretation of our user manual. The appearance of the product shall be subject to the product you received. Please forgive us that we won't inform you again if there are any technology or software updates on our product.

	<p>Warning-To reduce the risk of injury, user must read instructions manual carefully.</p>
	<p>This product is subject to the provision of European Directive 2012/19/EC. The symbol showing a wheeled bin crossed through indicates that the product requires separate refuse collection in the European Union. This applies to the product and all accessories marked with this symbol. Products marked as such may not be discarded with normal domestic waste, but must be taken to a collection point for recycling electrical and electronic devices</p>

SAFETY PRECAUTION



 Before the appliance is used, please read the manual carefully. To reduce the risk of fire, electrical shock or injury when using the appliance, follow basic precaution, including the following:

 DANGER:

- ◆ Read all instructions before using the ice-making machine.
- ◆ Plug into a grounded 3-prong outlet, do not remove grounding prong, do not use an adapter, and do not use an extension cord.
- ◆ It is recommended that a separate circuit, serving only your appliance be provided. Use an outlet that cannot be turned off by a switch.
- ◆ Never clean appliance parts with flammable fluids. These fumes can create a fire hazard or explosion. And do not store or use gasoline or other flammable vapours and liquids in the vicinity of this or any other appliance. The fumes can create a fire hazard or explosion.

- ◆ Before proceeding with cleaning and maintenance operations, make sure the power line of the unit is disconnected.
- ◆ Do not connect or disconnect the electric plug when your hands are wet.
- ◆ Unplug the appliance or disconnect power before cleaning or servicing. Failure to do so can result in electrical shock or death.
- ◆ Do not attempt to repair or replace any part of your appliance unless it is specifically recommended in this material. All other servicing should be referred to a qualified technician.
- ◆ To prevent a child from being entrapped, Keep out of reach of children and not in the vicinity of ice-making machine.
- ◆ Before you throw away your old ice-making machine, take off the door but leave the shelves in place so that children may not easily climb inside.
- ◆ Never allow children to operate, play with, or crawl inside the appliance.

 **Warning:**

- ◆ This machine should be operated by professionals or trained personnel; Make sure the machine is reliably connected to the ground to keep safe
- ◆ Use the power consistent with the one in the nameplate, and the bias voltage is less than $\pm 10\%$ of the rated voltage. The professionals must do the wiring;
- ◆ If the supply cord is damaged, it must be replaced by the manufacturer, its service agent or similarly qualified persons in order to avoid a hazard.;
- ◆ Before maintaining the machine, make sure you have cut off the power;
- ◆ Don't wet or sprinkle the liquid onto the plugs, motors, or other electrical parts

to avoid electric shock;

- ◆ This appliance can be used by children aged from 8 years and above and persons with reduced physical, sensory or mental capabilities or lack of experience and knowledge if they have been given supervision or instruction concerning use of the appliance in a safe way and understand the hazards involved. Children shall not play with the appliance. Cleaning and user maintenance shall not be made by children without supervision.

FLAMMABLE REFRIGERANT

For your safety observe the following recommendations.

- ◆ This appliance contains a small quantity of R290/R600a ice-making machine which is environmentally friendly, but flammable. It does not damage the ozone layer, nor does it increase the greenhouse effect.
- ◆ During transportation and installation, ensure that the tubing of the refrigerant circuit is not damaged.
- ◆ when handling, moving and use of the refrigerator or freezer to avoid either damaging the refrigerant tubing or increasing the risk of a leak.
- ◆ Avoid using or manipulating sharp objects near by the appliances.
- ◆ Leaking refrigerant can ignite and may damage the eyes.
- ◆ In the event any damage does occur, avoid exposure to open fires and any device which creates a spark. Disconnect the appliance from the mains power.
- ◆ Thoroughly ventilate the room in which the appliance is located for several

minutes.

- ◆ Notify Customer Service for necessary action and advice.
- ◆ The ice-making machine quantity contained in this appliance is listed above in grams; it is also noted on the Rating Plate of the appliance.



R290/R600a

◆ **WARNING: During using, service and disposal the appliance, please pay attention to symbol similar as left side, which is located on rear of appliance (rear panel or compressor) and with yellow or orange color. It's risk of fire warning symbol. There are flammable materials in refrigerant pipes and compressor. Please be far away fire source during using, service and disposal.**



Note:

- ◆ Please keep the water or other conductive liquids away from the machine;
- ◆ Don't stick clubs into the machine;
- ◆ During the movement of the machine, it should be carefully carried at an angle of less than 45 degrees.

Prohibit water discharge pipe or water supply pipe from being bent so that the pipes are damaged and water leaks out from the pipes.

- ◆ The distance between the air outlets and the wall should be over 30 cm.
- Besides, keep good ventilation and ensure the machine is dry and clean.

QUICK USAGE INSTRUCTIONS

Installation requirements:

- 1.The surface of the machine is covered with a metal protective film, which needs to be removed before use
- 2.In order to extend the service life of the ice maker, it must be placed upright for at least 6 hours before being powered on .
- 3.The host of this product should be placed directly above the ice storage bin, and the left, right, and back of the ice maker host should be aligned with the ice storage bin
- 4.Pay attention to personal safety when placing the main unit of the ice maker, and the main unit should not tilt more than 15 °and be at least 30cm away from obstacles
- 5.Please install the water inlet and outlet pipes of the ice maker host according to the installation diagram on the back of the host
- 6.The ambient temperature of this product should not exceed 38 °C , and the inlet water temperature should not exceed 32 °C
- 7.If there is an E04 alarm, please check the ambient temperature and water temperature in a timely manner and make corresponding adjustments
- 8.Before use, the protective tape needs to be removed. The specific steps are as follows

step1:Loose the screws .

step2:Remove the tape.

step3:Remove the pearl cotton.

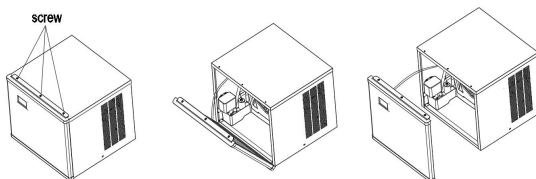

Cleaning requirements:

- 1.Due to significant differences in water quality among different regions, it is recommended to connect the inlet to prevent impurities from depositing and blocking pipelines and water pumps
- 2.Adding a water purification device to the water pipe may cause impurities to deposit and block the water path, which is not a product quality issue. Please clean the machine regularly
- 3.It is recommended to clean the main water system (sink, water pump, water pipe) every 10-14 days
- 4.Before manual cleaning mode, add the prepared cleaning agent (such as citric acid descaling agent) to the water tank. Clean for about 40 minutes

Function Description:

1. Ice thickness setting function: Press "reservation/addition" twice in the startup state to enter the ice thickness gear state. At this time, you can adjust the ice thickness according to the actual ice thickness by pressing "reservation/addition" and "lighting/reduction". It is recommended that the ice thickness gear is not less than 0

2. Cleaning function: Press the "switch" to display OFF, then press "clean/set" to enter the cleaning mode. The cleaning time in the cleaning mode is about 40 minutes

SAVE THESE INSTRUCTIONS

BASIC STRUCTURE

Split type

No.	Name	No.	Name
1	Front panel	11	electric control panel
2	Control panel	12	Fan motor
3	Evaporator cover	13	spray pipe
4	Water storage tank	14	Top panel
5	Water pump	15	drain valve
6	Evaporator	16	condenser
7	Compressor	17	water pump outlet pipe
8	Right panel	18	Left panel
9	outfall	19	back shroud
10	water supply valve	20	fan guard

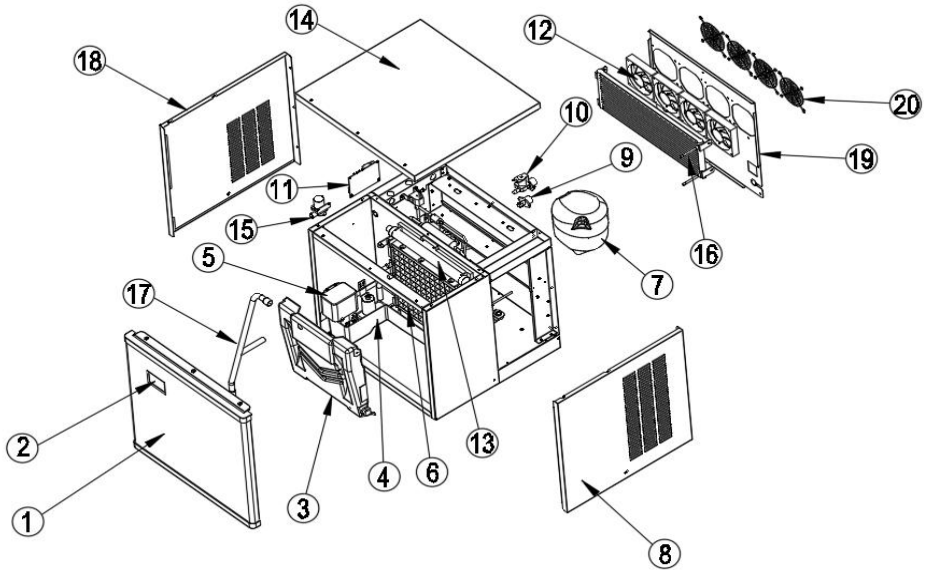

ICE MACHINE ACCESSORIES

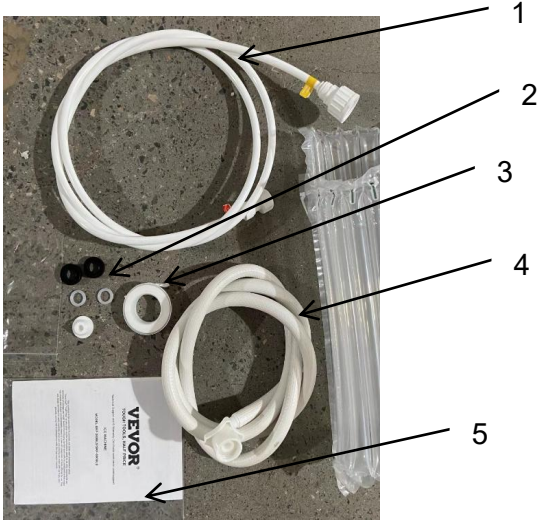

No.	Name
1	Water inlet pipe
2	Sealing ring
3	PTFE tape
4	Water drainage pipe
5	Instructions

ICE STORAGE BUCKET ACCESSORIES

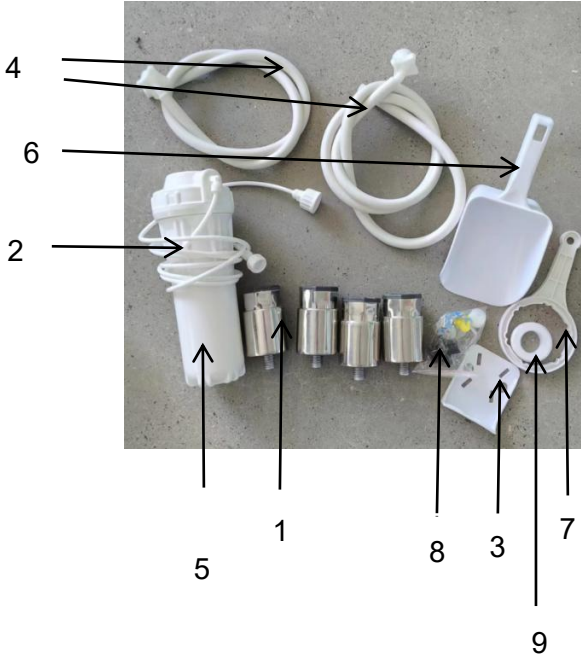

No.	Name
1	Adjustable feet
2	Filter connection pipe
3	mounting plate
4	Ice storage bucket drain pipe
5	Water filter
6	Ice shovel
7	wrench
8	accessories package
9	thread seal tape

**※This batch of attachments
need to buy ice storage buckets**

INSTALLATION

Open the case, move the machine to a appropriate location. Check the packing list and the contents, if they are different, please inquire your dealer.

2. Operating environment

A. Environment temperature: SN、N、ST: 10℃~38℃

Environment humidity: relative humidity ≤90%

1. Take out the feet of the ice storage bucket and install them at the bottom of the ice storage bucket.
2. Two people carry the ice machine host and place it on the ice storage bucket, and it is flush with the ice storage bucket.
3. Maintain the level of the main engine by adjusting the feet of the ice bucket machine.

The ice maker is to be installed in accordance with the Safety Standard for Refrigeration Systems, ASHRAE 15. In addition, the ice maker shall not be installed in corridors or hallways of public buildings.

Please use it with the ice storage bucket provided by the manufacturer. Do not replace it at will.

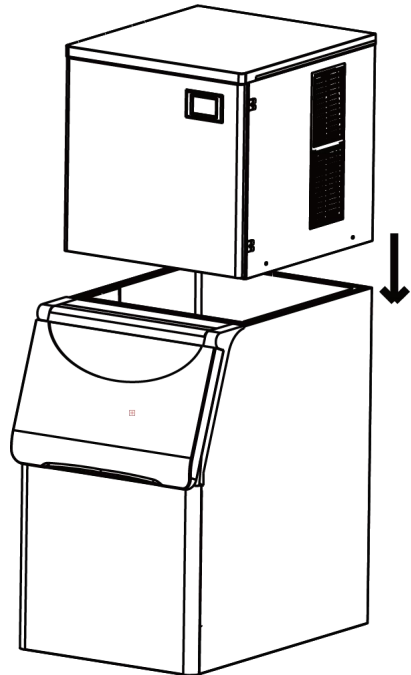

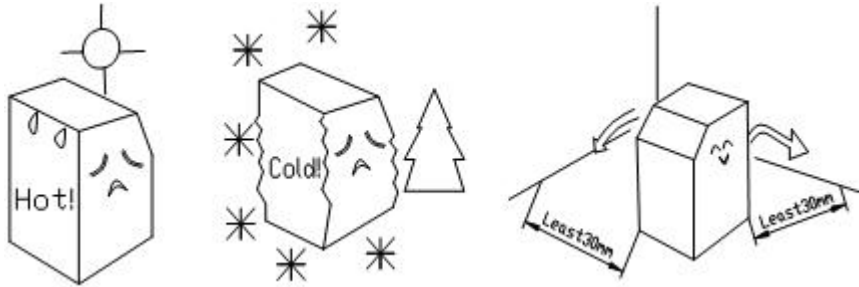

The distance between the air outlets and the wall should be over 30 cm. Besides, keep good ventilation and ensure the machine is dry and clean. The position to place the ice maker must be far away from the heat source, such as a bake oven, electric cooker, etc.

B. Water source is suitable for the sanitary standards, the water temperature and pressure is suitable. For getting the biggest efficiency, the inlet water temperature value should be $0.6\sim 32^{\circ}\text{C}$, and the pressure should be $0.1\sim 0.63\text{MPa}$.



C. There should be a sewer. While working, some of the water will be discharged, so the sewer is necessary. Furthermore, the sewer must be kept unblocked.

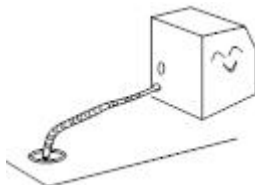

POWER SUPPLY

- a. Select the proper power supply according to the voltage and power on the nameplate.
- b. Connect the power wire and supply, ensuring the yellow and green wires were connected with the ground wire firmly.

	<p>Caution:</p> <ol style="list-style-type: none">a. For safety, ensure the ground connection is in good condition.b. All the exterior wires and other appliances must confirm with national standard.
---	--

- c. If the voltage fluctuation range is extensive ($\pm 10\%$ over the rated voltage), it will cause many faults, such as the machine can't be started, the electronic control board is damaged, or the compressor being damaged. Therefore, you must use a suitable automatic voltage regulator.

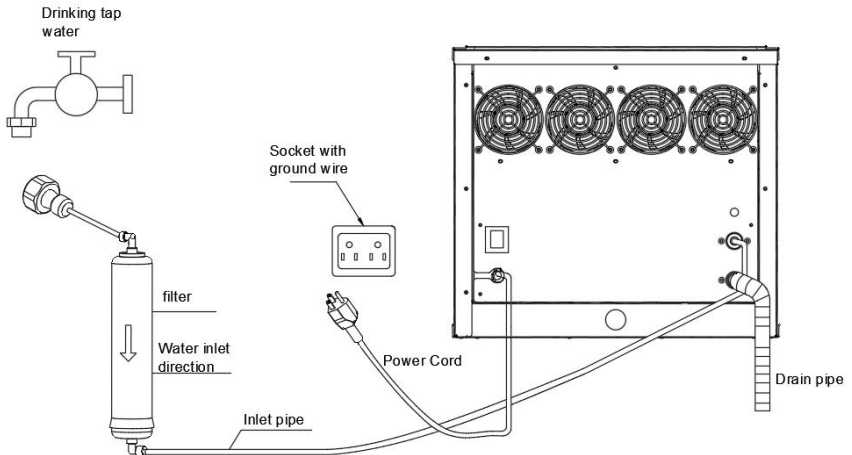

For the SKF-300BLS、SKF-500BLS,you must remove the decorative panel so as to turn on the power.

4. Connect the water supply pipe

Take out the water supply pipe from accessory bag, connect pipe's double ends to the water supply valve and water faucet. First, sleeve the connector 1 to the water faucet, then join one end of water supply pipe which has steel balls to the connector 1(hang on this water supply pipe's end, loose it after being connected to the connector 1), and connect the other end which is attached with a screw to the water supply valve, the valve also has a screw in its end, screw down the valve in clockwise. Once finished installation, check the connect part if it is leaks or not. you should connect the water pipes according to the diagram on the rear panel. The flow rate of condensate water is adjustable according to customers' need. (Condensate flow relates to the speed of making ice)



Warning: The water used to make edible ice block must be drinking water, furthermore, water's temperature must be among 0.6~32℃ and the pressure among 0.1~0.63Mpa.

5. Connect the water discharge pipe

The water discharge pipe is situated at the back of the machine, extended pipe's end to the sewer.



Attention: In order to keep the water discharged smoothly, discharge pipe's lowest point must be above the highest point of the sewer, so to prevent the discharge water to flow back.

6. Keep the main body in level situation

Please keep the main body level to ensure the ice maker usually works. First, screw down the two adjustable legs into the machine's nuts. You can adjust the two legs properly if the main body is not level.

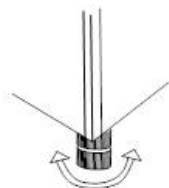

SERVICE INSTRUCTION

1.Operation process

First, turn on the water faucet, power, and water supply valve, then fill the sink with water, and turn off the faucet when the sink is filled with appropriate water.

2. Ice-make process

After several minutes, the water pump starts work, and the water will be pumped and flowed through the ice model evenly. At last, the ice is formed in the model. When the ice thickness sensor detects the regulated thickness of ice, the ice starts to drop.

3. Ice-drop process

The water pump stops working, the water supply valve will be opened, and water go into the sink. The heating valve will be turned on, and the refrigerant gas is led into the ice model; the ice root will be melted, and after about 2 minutes, the ice block drop into the ice cabinet. The falling ice block hit the retaining board (the inductive switch, which is fixed on the right side of the retaining board, till now, one circle is over, and the new ice-make circle will start.

4. Auto-stop

When the ice cabinet is filled with ice blocks, the continuing falling ice block will be locked between the retained board and evaporator; the retained board would be opened continually and couldn't return to the original position. After several seconds, the ice maker will stop working automatically. Once the ice block locked between the retained board and evaporator is taken away, the retained board will return to the its original position, and the ice maker will restart to make ice.

5. Running check

A、 When the ice maker is in the working process, a sudden interruption of water supply can lead to the sink not being filled with appropriate water. The ice maker will turn into standby condition and not make ice as usual. After the water supply becomes normal and restart the machine, it can work normally.

B、 The fan motor for condenser is controlled by temperature, when condenser's surface temperature is lower, the fan motor will stop, so as to save power; when surface temperature rises up, the fan motor will work again, so fan motor work intermittently during the ice-make process.

C、 When a commercial ice maker works at a lower ambient temperature, the ice-drop process will be later than usual. If it occurs three times continuously, the machine will stop automatically, and the red light in the electrical box alternately flickers with the other four lights. After restarting the machine, it will become normal. Therefore, we suggest the user not use the machine at a low ambient temperature.

LCD FULL PAGE DISPLAY

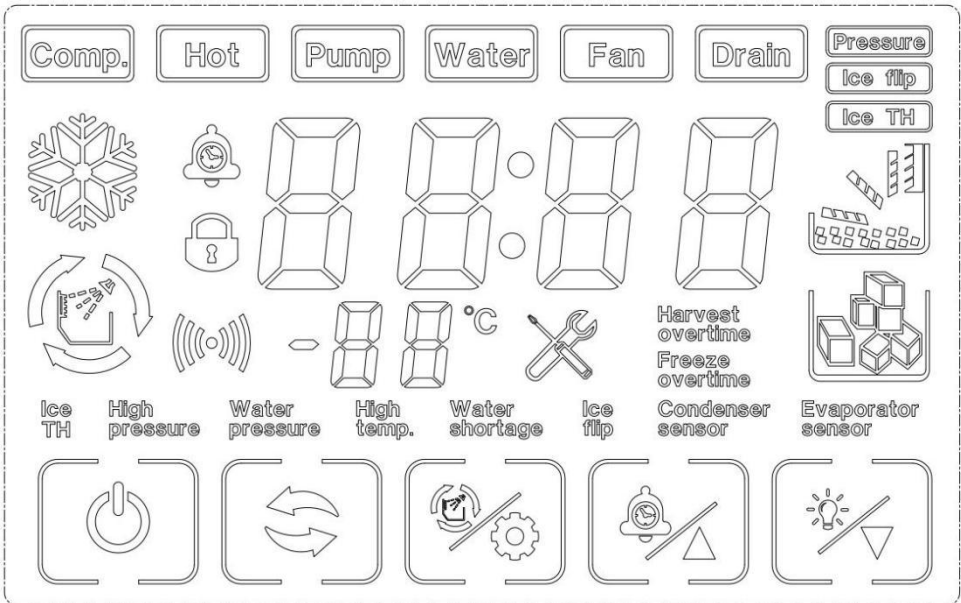

7. Buttons on display board

Boot / shutdown: 

press 3 seconds to turn off the machine under turn on status

press on/off button to turn on the machine under turn off status press the on/off button to exit setting under ice thickness setting and filling water adjust status

Mode button: 

Switch the ice making program

Clean / Set Button: 

Press to clean status under machine turn off status

+/reservation button: 

press to ice thickness adjust under pressure equilibrium、 making ice、 unload ice、 ice full status

click to increase 1, long press the button to increase continuously under ice thickness adjust status

click to reservation time setting status under turn off status

-/light button: 

click to decrease 1, long press the button to decrease continuously under ice thickness adjust status

Instruction: when the machine is in the “lack-water protection” condition, it can restart automatically after the sink is filled with appropriate water. If other faults cause the machine to stop, press the start button or supply power again after forty-five minutes, and the machine will start again.

DAILY CLEANING AND MAINTENANCE

Clean

Warning

Before cleaning or maintaining the ice maker, unplug the ice maker from the power supply network. .

It is strictly prohibited to flush the ice maker directly with water sprayer.

Attention

When using neutral or sodium hypochlorite solutions, be sure to read and understand the accompanying instructions to avoid potential health problems.

[a]Ice maker and refrigerator housing

Wipe the ice maker's shell with a clean, soft cloth at least once a week, and wipe grease and dirt with a damp cloth containing a neutral cleaner.

Attention

Do not use a hard brush, wire brush, do not use detergent powder, gasoline, banana water, acetone and other organic solutions, do not use boiling water or containing strong acids, alkali cleaning agents to clean the ice machine.

Please do not wash directly with water when cleaning, so as not to affect the insulation of electrical appliances.

[b]Ice machine cleaning and disinfection (recommended more than 2 times per month)

Note: Some areas may need to be cleaned and disinfected more frequently due to different water quality.

Attention

Before cleaning, at the end of the ice machine cycle, all the ice cubes slide behind, shut down, open the front panel, and remove all the ice cubes in the ice machine and ice storage bucket. .

Do not use tools to peel the ice from the ice mold, otherwise it may cause damage to the ice mold.

Do not use any liquid containing alcohol to clean or disinfect the ice machine, or it may cause cracks in the plastic parts.

Attention

During the cleaning and disinfection process, please pay attention to protection, wear goggles and gloves, if the cleaning agent or disinfectant on the skin or eyes may cause inflammation. In case of accidental contamination, please follow the precautions of the medicine.

During cleaning, attention should be paid to ventilation. Chlorine gas produced by disinfectants is a health hazard. Please handle it in a ventilated place.

Cleaning and disinfection sequence

Please clean and disinfect in the following order.

order of use	Pharmaceutical species	use
1	Citric acid detergent (dilution ratio refer to detergent instructions)	rinse
2	Disinfectant (dilution ratio refer to disinfectant instructions)	sterilie

Cleaning and disinfection procedures

Daily cleaning and maintenance methods(10-15 days)

1. Click the "OFF" button on the display screen after the ice maker finishes all the ice sliding. The display screen displays "off". Open the ice bucket door and remove all the ice.



2. Open the front panel, put the dissolved detergent (or disinfectant) into the water storage tank, and then close the front panel.



3. In the "off" state, press the "OFF" button. When you see that the key flashes, release it and enter the cleaning mode.

4. After entering the cleaning procedure, the equipment will follow the instructions: (1) Water inlet → (2) cleaning for 15 minutes → (3) drainage for 1 minute → (4) Water inlet → (5) rinsing for 3 minutes → (6) drainage → Repeat steps (4) to (6) for 5 times → End. After completing the above steps, the cleaning procedure is over.

Note: Detergent (or disinfectant) should be adjusted according to its own use instructions. After entering the cleaning program, it will run automatically without operation. Do not add disinfectant and cleaning agent to the sink at the same time.

Note: If cleaning and disinfecting steps are performed at the same time, please follow the above steps twice.

Deep cleaning and maintenance methods(2 months)

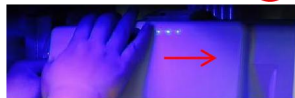

Step 1: Turn off the switch and unplug the power cord.

Step 2: Use a cross driver to remove the two screws on the right panel of the ice maker.

Step 3: Open the front panel.

Note: The opening Angle of the door panel should not exceed 180° .

Step 4: Remove the plug under the water storage tank and drain the water from the water storage tank.

Step 5: Remove evaporator cover.(Pry open the evaporator cover slightly to the right.)

Step 6: Remove water pipe retaining cover and water pipe



Step 7: Remove the screw top of the water pipe and take out the inner and outer water pipes.



Step 8: Use a small brush to clean the inside and outside walls of the pipe.



Step 9: Use a small brush to clean the inside and outside of the evaporator cover.



Step 10: Remove the screws that secure the water pump, and remove the pump water pipe.



Step 11: Remove the two screws from the water level sensor.



Step 12: Use a small brush to clean the bottom of the pump.



Step 13: Use a small brush to clean under the water level sensor.



Step 14: Use a clean, soft cloth to clean the inside surface of the ice maker, the surface of the evaporator, the surface of the sink, and the inside of the ice bucket.



install

Step 1: Install the water pipe and tighten the screws at both ends of the water pipe (note: that the direction of the water outlet hole of the inner water pipe is opposite to that of the outer water pipe).







Step 3: Install water pipe retaining cover, water pump, water level sensor.

Step 4: Close the front pane, Tighten the two side screws.



Note: After the ice machine is cleaned, the pre-made 5 sheets of ice should not be eaten. Cleaning and maintenance cycle please adjust according to the local water quality, recommended Daily cleaning and maintenance methods(10-15 days), Deep cleaning and maintenance methods(2 months), if there is serious scale, please first follow the deep maintenance cleaning, and check the filter condition.

TROUBLE SHOOTING

LED Panel	LCD Panel	Possible Cause	Solution
E01	 Ice flip	<ol style="list-style-type: none"> 1. De-icing plate is missing or misplaced; 2. The polarity of the magnetic induction element is reversed; 3. Abnormal ice full switch; 	<ol style="list-style-type: none"> 1. Reset the ice removal plate; 2. Replace the ice removal plate/full ice sensor; 3. Contact after-sales service/visual trouble guidance/confirm the fault point;
E03	 Harvest overtime	<ol style="list-style-type: none"> 1. The ice cube setting is too thin; 2. The water tank is insufficient; 3. The ambient temperature is too low; 4. De-icing solenoid valve failure; 	<ol style="list-style-type: none"> 1. Check and set the water thickness parameters(Recommended gears 0-2) 2. Check the water inlet system, or if the water sufficient; 3. Use membrane materials to block the ventilation inlet area proportionally; 4. Check if the ice is stuck; 5. Check if the machine is placed horizontally; 6.Contact after-sales/video guidance/confirm the point of failure;
E04	 High Temp.	<ol style="list-style-type: none"> 1. The ambient temperature is too high; 2. The cooling effect of the condensing system is poor; 3. The cooling fan is damaged; 	<ol style="list-style-type: none"> 1. Improve environmental ventilation or displacement, or turn on air conditioning; 2. Clean the condenser; 3. The distance between the machine and the obstruction should be at least 30cm; 4. Check if the fan is working ; 5. Contact after-sales/confirm the point of failure;
E05	 Water Pressure	<ol style="list-style-type: none"> 1. No water supply; 2. The water supply pressure is too low; 3. Water tank leaks; 4. The water level sensor fails; 5. Malfunction of the inlet valve; 	<ol style="list-style-type: none"> 1. Check the water source or whether the water filter is blocked; 2. Check the water supply pressure or whether the water filter is blocked; 3. Check whether the bottle cap at the bottom of the water tank is tightened and sealed; 4. Check for scale on the water level switch ; 5. Contact after-sales/video guidance/confirm the point of failure ;
E06	 High Pressure	<ol style="list-style-type: none"> 1. The condenser temperature is too high; 2. The refrigeration system is blocked; 3. Pressure switch failure;4. The main control board is abnormal; 	<ol style="list-style-type: none"> 1. Improve environmental ventilation or displacement, or turn on air conditioning; 2. Check the condensation heat dissipation system; 3. Contact after-sales/video guidance/confirm the point of failure;
E11		<ol style="list-style-type: none"> 1. The ring temperature is too high; 2. Poor dissipation effect of the condensing system; 3. Leakage of refrigeration system; 	<ol style="list-style-type: none"> 1. Check if the water pump is started and running 2. Clean the condenser; 3. The distance between the machine and the obstruction should be at least 30cm; 4. Contact after-sales/video guidance/confirm the point of failure ;

TECHNICAL PARAMETER AND WIRING DIAGRAM

A、Technology parameters are on the nameplate.

B、The electrical schematic diagram is on the inner side of the board .

VEVOR[®]

TOUGH TOOLS, HALF PRICE

Technical Support and E-Warranty Certificate

www.vevor.com/support