

# **VEVOR<sup>®</sup>**

**TOUGH TOOLS, HALF PRICE**

Technical Support and E-Warranty Certificate [www.vevor.com/support](http://www.vevor.com/support)

## **GRAVITY WATER PURIFIER REPLACEMENT FILTERS**

We continue to be committed to provide you tools with competitive price. "Save Half", "Half Price" or any other similar expressions used by us only represents an estimate of savings you might benefit from buying certain tools with us compared to the major top brands and does not necessarily mean to cover all categories of tools offered by us. You are kindly reminded to verify carefully when you are placing an order with us if you are actually Saving Half in comparison with the top major brands.

# VEVOR<sup>®</sup>

TOUGH TOOLS, HALF PRICE

GRAVITY WATER  
PURIFIER  
REPLACEMENT FILTERS

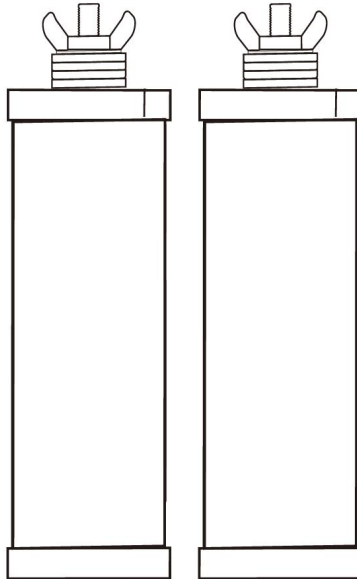

## NEED HELP? CONTACT US!

Have product questions? Need technical support? Please feel free to contact us:

**Technical Support and E-Warranty Certificate**  
**[www.vevor.com/support](http://www.vevor.com/support)**

This is the original instruction, please read all manual instructions carefully before operating. VEVOR reserves a clear interpretation of our user manual. The appearance of the product shall be subject to the product you received. Please forgive us that we won't inform you again if there are any technology or software updates on our product.

## LIFESPAN

Two filters can purify 6000 Gallons of drinking water. The filter should be replaced every 6 months, depending on the water quality.

## Gravity Water Purifier Replacement Filters

Offering long life and simple replacement, the Black Purification Element, ensures your tap water continues to taste great glass after glass. This high-efficiency composite filter systems effectively reduces odors and contaminants.

## Black Purification Element Compatible Models

Berkey, Travel, Big, Royal, Imperial, Crown Series;  
Popur Traveler, Nomad, King, Big Series;  
Doulton Super Sterasyl & ATC Super Sterasyl filter, W9361122 & W9361123 system.

**\*Note that this is a compatible spare part. The manufacturers' names and part numbers have been used only for reference.**

Filter Capacity:	3,000 Gallons / Filters
Filter Accuracy:	0.01 Micron (Minimum)
Product Size:	Height 8.5" * Diameter 2.8"
Flow Rate:	2 Gallons (7.5 Liters)Per Hour /1 Filters

Test germ	Test group	Average cfu of testing groups (cfu/100mL)	Average cfu of positive controls (cfu/100mL)	Sterilization rate(%)
Escherichia coli 8099	1	8	104	>99.99
	2	5	104	>99.99
	3	7	104	>99.99
	Average			>99.99

Test germ	Test result	Standard request	Unit
total coliforms	absence	absenc	cfu/100ml
colority	<5	≤5	degree
turbidity	<0.5	≤0.5	ntu
visible substance	nothing	nothing	/
stench and taste	nothing	odorless,no odor	/

## LATEST DOUBLE FILTRATION TECHNOLOGY

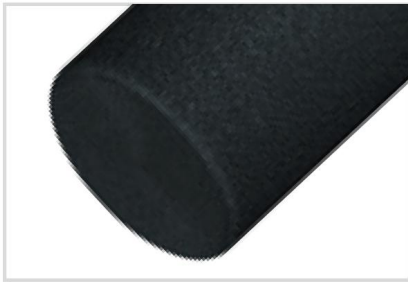

Natural coconut shell  
activated carbon

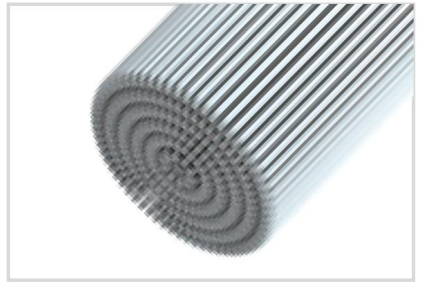

0.01-Micron hollow fiber  
UF membrane

## ATTENTIONS

1. The filters can NOT remove pigment from any drinks, such as coke.
2. Prime filters before using:

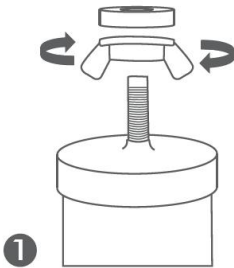

Screw the wing nut on the filter in reverse  
and put one washer (like in the picture).

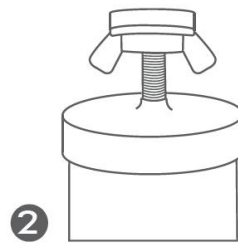

Make sure they're firm.



Prime the filter against the faucet until water goes through the whole filter (like in the picture).



Make sure they're firm.

3. We recommend filling the upper chamber as much as possible at the beginning of the filtration process because our filter relies on gravity and water pressure for filtration. Sufficient water pressure is required to ensure water passes through the filter; otherwise, there may be situations where no water flows through the filter.
4. We suggest adding water to the upper chamber for filtration only after the water in the lower chamber has been consumed. This is because adding water to the upper chamber when the lower chamber is full can cause leakage.

## ATTENTIONS

### 1. What should I do if there is no water flow during the first use?

Fill up the upper chamber with water, patiently wait for 20-40 minutes, and water should start flowing (but sometimes some filters may take a day for water to pass through). If there's still no water flow, please contact us via after-sales email.

### 2. How often should the system and filter be cleaned?

We advise cleaning the container once a week. To clean the filter element, rinse the filter surface with water and backwash the filter as shown in the previous 4 pictures, this can slightly extend the filter's lifespan.

### 3. When should I replace the filters?

Generally, we suggest replacing the filter elements every 6 months, or when the filtration speed significantly decreases or the filter becomes clogged. Of course, you can decide the replacement schedule based on your actual usage.

**4. What are the additional white plugs used for?**

They are spare parts and are only helpful when you need them. You can use them to block the other hole(s) in the chamber using only one filter for filtration.

**5. How long can water be stored in the container?**

We recommend not storing water in the container for too long; it is best to replace the water every 1-2 days.

**6. About storage and reuse procedures?**

Before storing, please air-dry the filters and store them in a dry and well-ventilated place, avoiding direct sunlight. Do not store them in dark and damp places. If you need to reuse them, please prime the filters again.

**If you encounter issues such as filter clogging, system leaking, or strange taste in the filtered water, please feel free to contact us via email. We are committed to making every effort to resolve your concerns.**

**Address:** Shuangchenglu 803nong11hao1602A-1609shi, baoshanqu, shanghai 200000 CN.

**Imported to AUS:** SIHAO PTY LTD, 1 ROKEVA STREETEASTWOOD NSW 2122 Australia

**Imported to USA:** Sanven Technology Ltd., Suite 250, 9166 Anaheim Place, Rancho Cucamonga, CA 91730

<b>EC</b>	<b>REP</b>
-----------	------------

E-CrossStu GmbH  
Mainzer Landstr.69, 60329 Frankfurt am Main.

<b>UK</b>	<b>REP</b>
-----------	------------

YH CONSULTING LIMITED.  
C/O YH Consulting Limited Office 147, Centurion House,  
London Road, Staines-upon-Thames, Surrey, TW18 4AX

**VEVOR<sup>®</sup>**

**TOUGH TOOLS, HALF PRICE**

**Technical Support and E-Warranty Certificate**

**[www.vevor.com/support](http://www.vevor.com/support)**