

# **VEVOR<sup>®</sup>**

## **TOUGH TOOLS, HALF PRICE**

Technical Support and E-Warranty Certificate

[www.vevor.com/support](http://www.vevor.com/support)

## **KIDS SWIVEL CHAIR**

### **USER MANUAL**

**MODEL NO.: LY-8303**

We continue to be committed to provide you tools with competitive price.

"Save Half", "Half Price" or any other similar expressions used by us only represents an estimate of savings you might benefit from buying certain tools with us compared to the major top brands and does not necessarily mean to cover all categories of tools offered by us. You are kindly reminded to verify carefully when you are placing an order with us if you are actually saving half in comparison with the top major brands.

# VEVOR<sup>®</sup>

TOUGH TOOLS, HALF PRICE

## kids swivel chair

MODEL NO.: LY-8303



### NEED HELP? CONTACT US!

Have product questions? Need technical support? Please feel free to contact us:

**Technical Support and E-Warranty Certificate**  
**[www.vevor.com/support](http://www.vevor.com/support)**

This is the original instruction, please read all manual instructions carefully before operating. VEVOR reserves a clear interpretation of our user manual. The appearance of the product shall be subject to the product you received. Please forgive us that we won't inform you again if there are any technology or software updates on our product.

 **WARNING:**

**Please read this manual carefully before using the product. Failure to do so may result in serious injury. SAVE THIS MANUAL**

1. Not for children under 3 years. Children should play under adult's supervision.
2. Ensure all parts are well received and intact before assembling. If any part is lost or damaged, please send us a message, and we will solve it for you as soon as possible.
3. Please ensure the chair is well assembled and test its condition before using.
4. DO NOT use the chair on the uneven floor.
5. Please DO NOT let kids sit or spin more than 20 minutes every time in case of dizziness and naupathia.
6. Avoid direct sunlight and high temperature in case of plastic deforming and aging.

## **TECHNICAL SPECIFICATIONS**

Model	LY-8303
Main Material	Metal +PP Plastic
Color	Blue/Green/Orange
Product Dimensions(LxWxH)	495*515*250 mm
Packing Size(LxWxH)	560*150*540 mm
Net Weight (kg)	4.6
Gross Weight (kg)	5.4

# PACKAGE CONTENTS



Panel\*1



Chair Base\*1



Metal Plate\*1



Big Screw\*1



Small Screw\*8



Screwdriver\*2

## Assembling

### SETP1

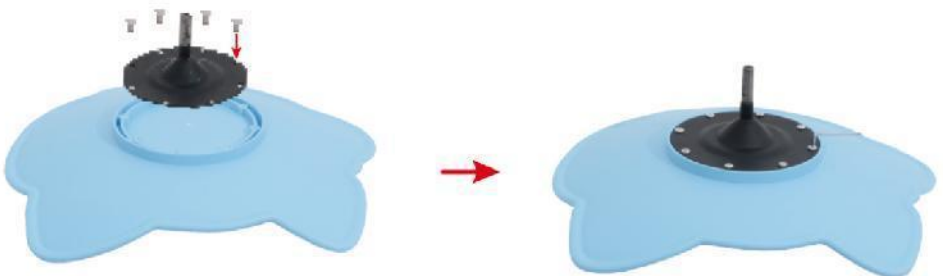

Attach the metal plate to chair panel with small screws.

## STEP2

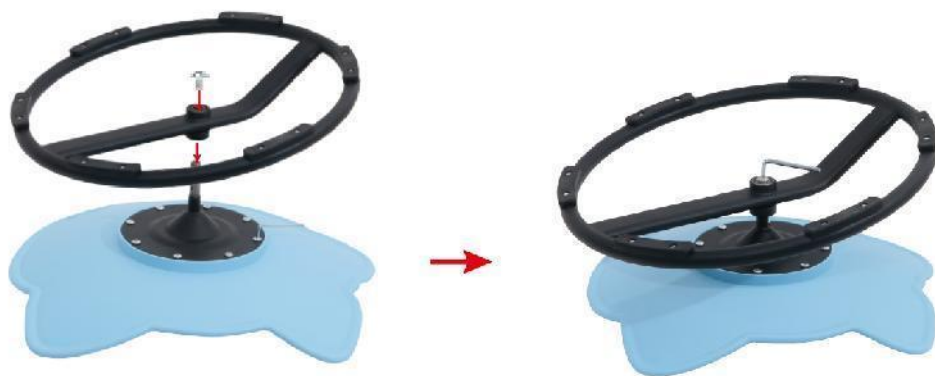

Fix the chair base on the chair panel.

## STEP3



Tighten the big screw with a screwdriver to complete the installation.

# COMPLETION



**Manufacturer:** Shanghaimuxinmuyeyouxiangongsi

**Address:** Shuangchenglu 803nong11hao1602A-1609shi, baoshanqu, shanghai 200000 CN.

**Imported to AUS:** SIHAO PTY LTD. 1 ROKEVA STREETEASTWOOD NSW 2122 Australia

**Imported to USA:** Sanven Technology Ltd. Suite 250, 9166 Anaheim Place, Rancho Cucamonga, CA 91730

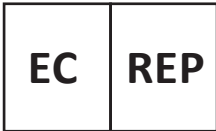

E-CrossStu GmbH  
Mainzer Landstr.69, 60329 Frankfurt am Main.



YH CONSULTING LIMITED.  
C/O YH Consulting Limited Office 147, Centurion House, London Road, Staines-upon-Thames, Surrey, TW18 4AX

**VEVOR<sup>®</sup>**

**TOUGH TOOLS, HALF PRICE**

**Technical Support and E-Warranty Certificate**

**[www.vevor.com/support](http://www.vevor.com/support)**



# **VEVOR<sup>®</sup>**

## **TOUGH TOOLS, HALF PRICE**

Technique Assistance et certificat de garantie électronique  
[www.vevor.com/support](http://www.vevor.com/support)

# **CHAISE PIVOTANTE POUR ENFANTS**

## **MANUEL DE L'UTILISATEUR**

**N° DE MODÈLE : LY-8303**

We continue to be committed to provide you tools with competitive price. "Save Half", "Half Price" or any other similar expressions used by us only represents an estimate of savings you might benefit from buying certain tools with us compared to the major top brands and does not necessarily mean to cover all categories of tools offered by us. You are kindly reminded to verify carefully when you are placing an order with us if you are actually saving half in comparison with the top major brands.

# VEVOR<sup>®</sup>

TOUGH TOOLS, HALF PRICE

## kids swivel chair

N° DE MODÈLE : LY-8303



### NEED HELP? CONTACT US!

Have product questions? Need technical support? Please feel free to contact us:

**Technical Support and E-Warranty Certificate**  
**[www.vevor.com/support](http://www.vevor.com/support)**

This is the original instruction, please read all manual instructions carefully before operating. VEVOR reserves a clear interpretation of our user manual. The appearance of the product shall be subject to the product you received. Please forgive us that we won't inform you again if there are any technology or software updates on our product.

 **AVERTISSEMENT:**

**Veillez lire attentivement ce manuel avant d'utiliser le produit. Ne pas le faire pourrait entraîner des blessures graves. CONSERVEZ CE MANUEL**

7. Pas pour les enfants de moins de 3 ans. Les enfants doivent jouer sous la surveillance d'un adulte.
8. Assurez-vous que toutes les pièces sont bien reçues et intactes avant l'assemblage . Je fais partie est perdu ou endommagé, veuillez nous envoyer un message et nous le résoudrons pour vous dans les plus brefs délais que possible.
9. Veuillez vous assurer que la chaise est bien assemblée et tester son état avant en utilisant.
10. N'utilisez PAS la chaise sur un sol inégal.
11. Veuillez NE PAS laisser les enfants s'asseoir ou tourner plus de 20 minutes à chaque fois au cas où de vertiges et de naupathie.
12. Évitez la lumière directe du soleil et les températures élevées en cas de déformation du plastique et vieillissement.

## SPÉCIFICATIONS TECHNIQUES

Modèle	LY-8303
Matériau principal	Métal + PP P dernier ic
Couleur	Bleu/Vert/Orange
Dimensions du produit (LxlxH)	495*515*250 millimètres
Taille de l'emballage (LxlxH)	560*150*540 millimètres
Poids net / kg)	4.6
Poids brut (kg)	5.4

## CONTENU DU COLIS



Panneau \*1 Base de chaise \*1 Plaque métallique \*1



Grand Équipage S \*1 Petit équipement S \*8 Tournevis\*2

## Assemblage

### SETP1

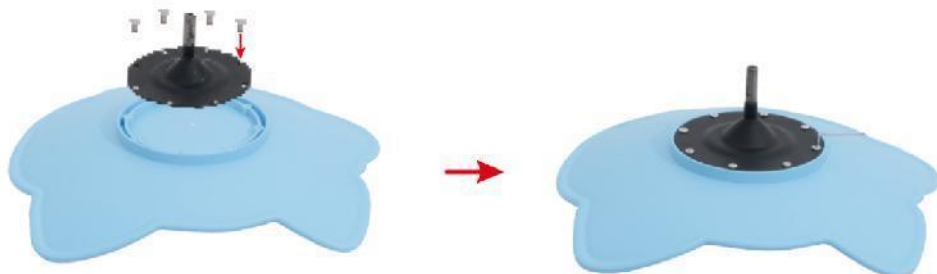

Fixez la plaque métallique au panneau chaie avec de petites vis.

## SETP2

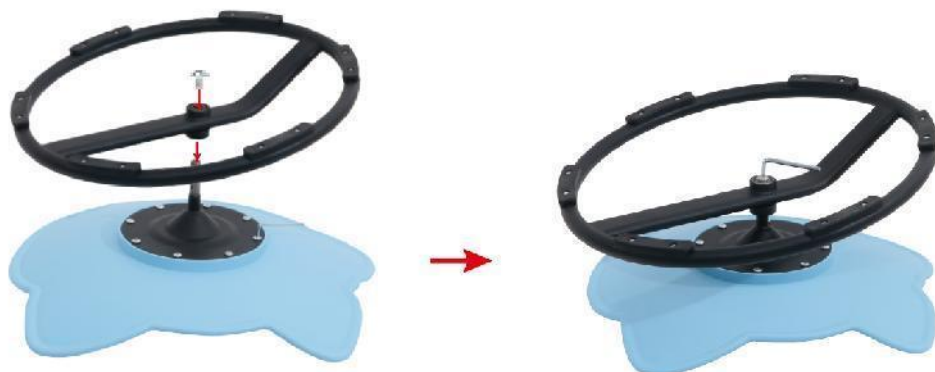

Fixez la base du chaie sur le panneau de la chaise.

## SETP3



Serrez la grosse vis avec un tournevis pour terminer l'installation.

# ACHÈVEMENT





**Fabricant** : Shanghaimuxinmuyeyouxiangongsi

**Adresse** : Shuangchenglu 803nong11hao1602A-1609shi, baoshanqu,  
Shanghai 200000 CN.

**Importé en Australie** : SIHAO PTY LTD. 1 ROKEVA STREETASTWOOD  
NSW 2122 Australie

**Importé aux États-Unis** : Sanven Technology Ltd. Suite 250, 9166  
Anaheim Place, Rancho Cucamonga, CA 91730



E-CrossStu GmbH  
Mainzer Landstr.69, 60329 Frankfurt am Main.



YH CONSULTING LIMITED.  
C/O YH Consulting Limited Office 147, Centurion  
House, London Road, Staines-upon-Thames, Surrey,  
TW18 4AX



**VEVOR<sup>®</sup>**

**TOUGH TOOLS, HALF PRICE**

**Technique Assistance et certificat de garantie électronique**

**[www.vevor.com/support](http://www.vevor.com/support)**

# **VEVOR<sup>®</sup>**

## **TOUGH TOOLS, HALF PRICE**

Technisch Support und E-Garantie-Zertifikat  
[www.vevor.com/support](http://www.vevor.com/support)

# **KINDERDREHSTUHL**

# **BENUTZERHANDBUCH**

**MODELL NR.: LY-8303**

We continue to be committed to provide you tools with competitive price.

"Save Half", "Half Price" or any other similar expressions used by us only represents an estimate of savings you might benefit from buying certain tools with us compared to the major top brands and does not necessarily mean to cover all categories of tools offered by us. You are kindly reminded to verify carefully when you are placing an order with us if you are actually saving half in comparison with the top major brands.

# VEVOR®

TOUGH TOOLS, HALF PRICE

## kids swivel chair

MODELL NR.: LY-8303



### NEED HELP? CONTACT US!

Have product questions? Need technical support? Please feel free to contact us:

**Technical Support and E-Warranty Certificate**  
**[www.vevor.com/support](http://www.vevor.com/support)**

This is the original instruction, please read all manual instructions carefully before operating. VEVOR reserves a clear interpretation of our user manual. The appearance of the product shall be subject to the product you received. Please forgive us that we won't inform you again if there are any technology or software updates on our product.

 **WARNUNG:**

**Bitte lesen Sie dieses Handbuch sorgfältig durch, bevor Sie das Produkt verwenden. Andernfalls kann es zu schweren Verletzungen kommen. BEWAHREN SIE DIESES HANDBUCH AUF**

13. Nicht für Kinder unter 3 Jahren. Kinder sollten unter Aufsicht eines Erwachsenen spielen.

14. Stellen Sie sicher, dass alle Teile gut angekommen und intakt sind, bevor Sie sie zusammenbauen. Wenn ein Teil verloren geht oder beschädigt wird, senden Sie uns bitte eine Nachricht und wir werden das Problem so schnell wie möglich für Sie lösen wie möglich.

15. Bitte stellen Sie sicher, dass der Stuhl ordnungsgemäß zusammengebaut ist und testen Sie seinen Zustand, bevor Sie verwenden.

16. Verwenden Sie den Stuhl NICHT auf unebenem Boden.

17. Bitte lassen Sie Kinder NICHT länger als 20 Minuten sitzen oder drehen, falls von Schwindel und Naupathie.

18. Vermeiden Sie direkte Sonneneinstrahlung und hohe Temperaturen, da sich Kunststoff verformen kann und Altern.

## **TECHNISCHE SPEZIFIKATIONEN**

Modell	LY-8303
Hauptmaterial	Metall + PP P last ic
Farbe	Blau/Grün/Orange
Produktabmessungen (L x B x H)	495*515*250 mm
Verpackungsgröße (L x B x H)	560*150*540 mm
Nettogewicht / kg)	4.6
Bruttogewicht (kg)	5.4

## PACKUNGSIHALT



Panel \* 1 Stuhl Basis \* 1 Metallplatte \* 1



Groß S -Schraube \* 1 Kleine S -Schraube \* 8

Schraubendreher \* 2

## Zusammenbau

**SETUP1: Die erste Zeile des Satzes**

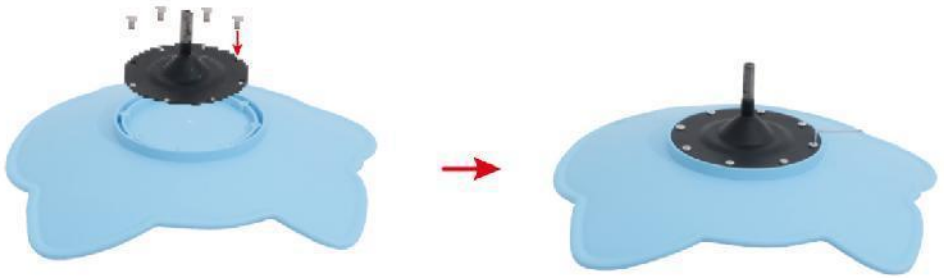

Befestigen Sie die Metallplatte mit kleinen Schrauben an der Chaiselongue.

## SETP2

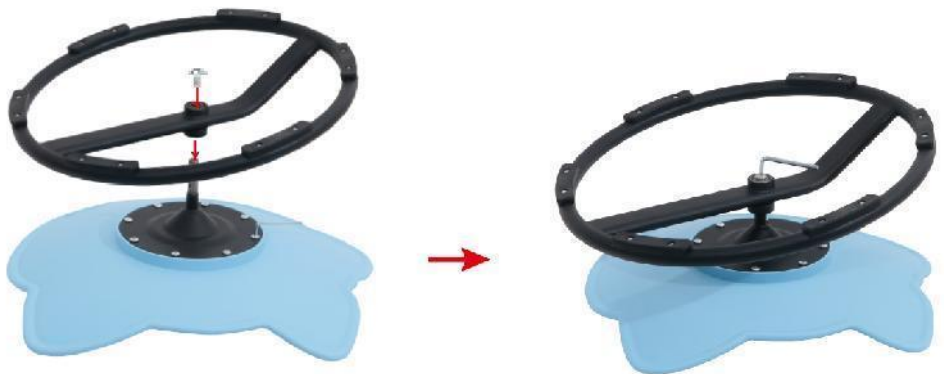

Befestigen Sie den Stuhlfuß auf der Stuhlplatte.

## SETUP3 - Die besten Seiten von SETUP3



Ziehen Sie die große Schraube mit einem Schraubendreher fest, um die Installation abzuschließen.

## FERTIGSTELLUNG







**Hersteller:** Shanghaimuxinmuyeyouxiangongsi

**Adresse:** Shuangchenglu 803nong11hao1602A-1609shi, Baoshanqu, Shanghai 200000 CN.

**Nach AUS importiert:** SIHAO PTY LTD. 1 ROKEVA  
STREETEASTWOOD NSW 2122 Australien

**Importiert in die USA:** Sanven Technology Ltd. Suite 250, 9166 Anaheim  
Place, Rancho Cucamonga, CA 91730



E-CrossStu GmbH  
Mainzer Landstr.69, 60329 Frankfurt am Main.



YH CONSULTING LIMITED.  
C/O YH Consulting Limited Office 147, Centurion  
House, London Road, Staines-upon-Thames, Surrey,  
TW18 4AX

**VEVOR**<sup>®</sup>

**TOUGH TOOLS, HALF PRICE**

**Technisch Support und E-Garantie-Zertifikat**

**[www.vevor.com/support](http://www.vevor.com/support)**

# **VEVOR<sup>®</sup>**

**TOUGH TOOLS, HALF PRICE**

Tecnico Supporto e certificato di garanzia elettronica

[www.vevor.com/support](http://www.vevor.com/support)

## **SEDIA GIREVOLE PER BAMBINI**

### **MANUALE D' USO**

**MODELLO N.: LY-8303**

We continue to be committed to provide you tools with competitive price.

"Save Half", "Half Price" or any other similar expressions used by us only represents an estimate of savings you might benefit from buying certain tools with us compared to the major top brands and does not necessarily mean to cover all categories of tools offered by us. You are kindly reminded to verify carefully when you are placing an order with us if you are actually saving half in comparison with the top major brands.

# VEVOR®

TOUGH TOOLS, HALF PRICE

## kids swivel chair

MODELLO N.: LY-8303



### NEED HELP? CONTACT US!

Have product questions? Need technical support? Please feel free to contact us:

**Technical Support and E-Warranty Certificate**  
**[www.vevor.com/support](http://www.vevor.com/support)**

This is the original instruction, please read all manual instructions carefully before operating. VEVOR reserves a clear interpretation of our user manual. The appearance of the product shall be subject to the product you received. Please forgive us that we won't inform you again if there are any technology or software updates on our product.

 **AVVERTIMENTO:**

**Si prega di leggere attentamente questo manuale prima di utilizzare il prodotto. In caso contrario, potrebbero verificarsi lesioni gravi.**

**CONSERVA QUESTO MANUALE**

19. Non per bambini sotto i 3 anni. I bambini dovrebbero giocare sotto la supervisione di un adulto.
20. Assicurarsi che tutte le parti siano ben ricevute e intatte prima del montaggio . Se c'è qualche parte è perso o danneggiato, ti preghiamo di inviarci un messaggio e lo risolveremo al più presto possibile.
21. Assicurati che la sedia sia ben assemblata e verificane prima le condizioni utilizzando.
22. NON utilizzare la sedia su pavimenti irregolari.
23. Si prega di NON lasciare che i bambini si siedano o girino per più di 20 minuti ogni volta, per ogni evenienza di vertigini e naupatia.
24. Evitare la luce solare diretta e le alte temperature in caso di deformazione della plastica e invecchiamento.

## **SPECIFICHE TECNICHE**

Modello	LY-8303
materiale principale	Metallo + PP P ultimo ic
Colore	Blu/Verde/Arancione
Dimensioni del prodotto (LxLxA)	495*515*250 mm
Dimensioni imballo (LxLxA)	560*150*540mm
Peso netto (kg)	4.6
Peso lordo (kg)	5.4

## CONTENUTO DEL PACCO



Pannello \*1 Base della sedia \*1 Piastra metallica\*1



Grande Chiave a S \*1 Chiave a S piccola \*8 Cacciavite\*2

## Assemblaggio

### SETP1

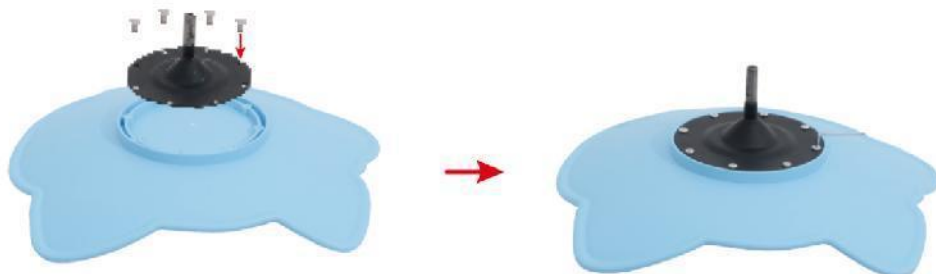

Fissare la piastra metallica al pannello della chaie con piccole viti.

## SETP2

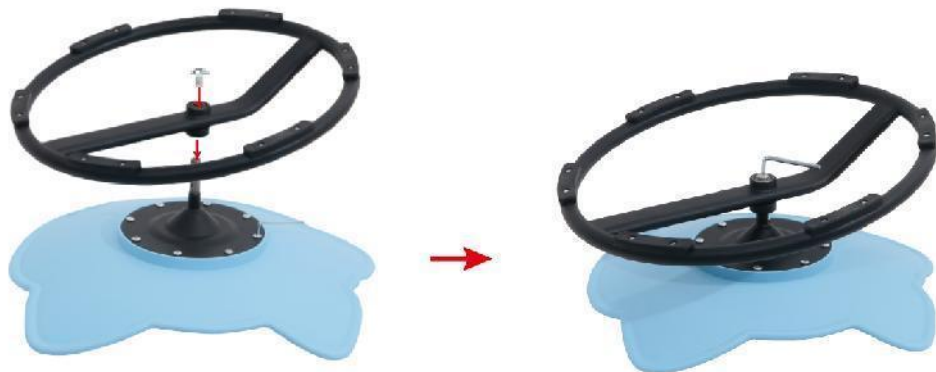

Fissare la base della chaie sul pannello della sedia.

## SETP3



Stringere la vite grande con un cacciavite per completare l'installazione.

# COMPLETAMENTO







**Produttore:** Shanghaimuxinmuyeyouxiangongsi

**Indirizzo:** Shuangchenglu 803nong11hao1602A-1609shi, baoshanqu, shanghai 200000 CN.

**Importato in Australia:** SIHAO PTY LTD. 1 ROKEVA  
STREETEASTWOOD NSW 2122 Australia

**Importato negli Stati Uniti:** Sanven Technology Ltd. Suite 250, 9166  
Anaheim Place, Rancho Cucamonga, CA 91730



E-CrossStu GmbH  
Mainzer Landstr.69, 60329 Frankfurt am Main.



YH CONSULTING LIMITED.  
C/O YH Consulting Limited Office 147, Centurion  
House, London Road, Staines-upon-Thames, Surrey,  
TW18 4AX

**VEVOR**<sup>®</sup>

**TOUGH TOOLS, HALF PRICE**

**Tecnico Supporto e certificato di garanzia elettronica**

**[www.vevor.com/support](http://www.vevor.com/support)**

# **VEVOR<sup>®</sup>**

## **TOUGH TOOLS, HALF PRICE**

Técnico Certificado de soporte y garantía electrónica  
[www.vevor.com/support](http://www.vevor.com/support)

# **SILLA GIRATORIA PARA NIÑOS**

## **MANUAL DE USUARIO**

**N.º DE MODELO: LY-8303**

We continue to be committed to provide you tools with competitive price.

"Save Half", "Half Price" or any other similar expressions used by us only represents an estimate of savings you might benefit from buying certain tools with us compared to the major top brands and does not necessarily mean to cover all categories of tools offered by us. You are kindly reminded to verify carefully when you are placing an order with us if you are actually saving half in comparison with the top major brands.

# VEVOR<sup>®</sup>

TOUGH TOOLS, HALF PRICE

## kids swivel chair

N.º DE MODELO: LY-8303



### NEED HELP? CONTACT US!

Have product questions? Need technical support? Please feel free to contact us:

**Technical Support and E-Warranty Certificate**  
**[www.vevor.com/support](http://www.vevor.com/support)**

This is the original instruction, please read all manual instructions carefully before operating. VEVOR reserves a clear interpretation of our user manual. The appearance of the product shall be subject to the product you received. Please forgive us that we won't inform you again if there are any technology or software updates on our product.

 **ADVERTENCIA:**

**Lea atentamente este manual antes de utilizar el producto. De lo contrario, podrían producirse lesiones graves. GUARDE ESTE MANUAL**

25. No apto para niños menores de 3 años. Los niños deben jugar bajo la supervisión de un adulto.

26. Asegúrese de que todas las piezas estén bien recibidas y intactas antes de ensamblarlas. Si alguna parte se pierde o está dañado, envíenos un mensaje y lo resolveremos lo antes posible. como sea posible.

27. Asegúrese de que la silla esté bien ensamblada y pruebe su estado antes usando.

28. NO utilice la silla en suelos irregulares.

29. NO permita que los niños se sienten o giren más de 20 minutos cada vez en caso de que de mareos y naupatía.

30. Evite la luz solar directa y las altas temperaturas en caso de que el plástico se deforme y envejecimiento.

## **ESPECIFICACIONES TÉCNICAS**

Modelo	LY-8303
material principal	Metal + PP P último ic
Color	Azul/Verde/Naranja
Dimensiones del producto (largo x ancho x alto)	495*515*250 milímetros
Tamaño del embalaje (largo x ancho x alto)	560*150*540 milímetros
Peso neto / kg)	4.6
Peso bruto (kg)	5.4

## CONTENIDOS DEL PAQUETE



Panel \*1 Base de silla \*1 Placa de metal\*1



Grande Equipo S \*1 Equipo S pequeño \*8 Destornillador\*2

## Montaje

### SETP1

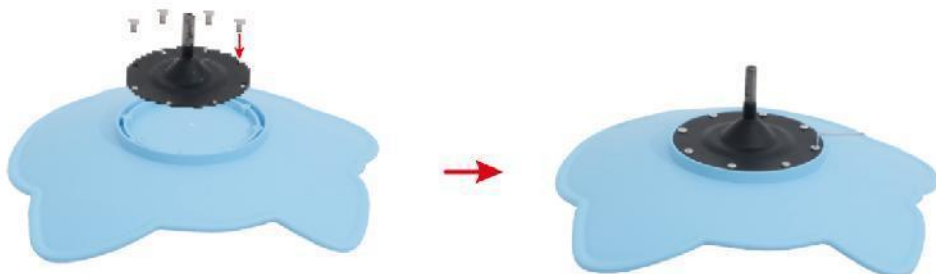

Fije la placa de metal al panel del chasis con tornillos pequeños.

## SETP2

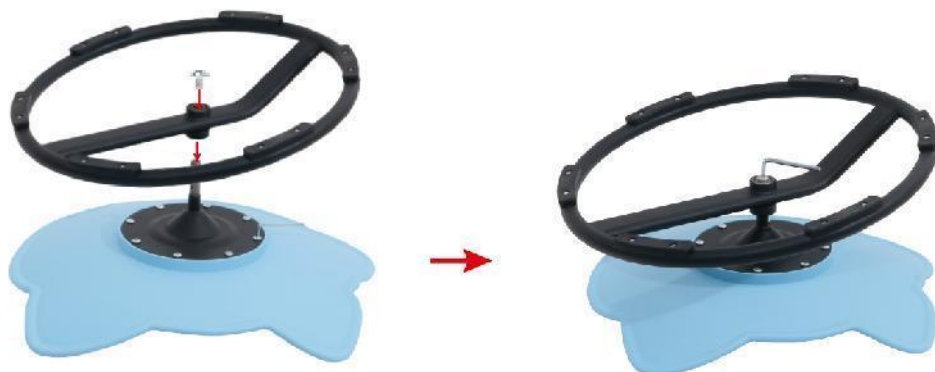

Fije la base del chaie al panel de la silla.

## SETP3



Apriete el tornillo grande con un destornillador para completar la instalación.



# TERMINACIÓN





**Fabricante:** Shanghaimuxinmuyeyouxiangongsi

**Dirección:** Shuangchenglu 803nong11hao1602A-1609shi, baoshanqu, shanghai 200000 CN.

**Importado a AUS:** SIHAO PTY LTD. 1 ROKEVA STREET ASTWOOD NSW 2122 Australia

**Importado a EE. UU.:** Sanven Technology Ltd. Suite 250, 9166 Anaheim Place, Rancho Cucamonga, CA 91730



E-CrossStu GmbH  
Mainzer Landstr.69, 60329 Frankfurt am Main.



YH CONSULTING LIMITED.  
C/O YH Consulting Limited Office 147, Centurion House, London Road, Staines-upon-Thames, Surrey, TW18 4AX

**VEVOR<sup>®</sup>**

**TOUGH TOOLS, HALF PRICE**

**Técnico Certificado de soporte y garantía electrónica**

**[www.vevor.com/support](http://www.vevor.com/support)**

# **VEVOR<sup>®</sup>**

**TOUGH TOOLS, HALF PRICE**

Techniczny Certyfikat wsparcia i e-gwarancji

[www.vevor.com/support](http://www.vevor.com/support)

## **KRZESŁO OBROTOWE DLA DZIECI**

### **INSTRUKCJA OBSŁUGI**

**MODEL NR: LY-8303**

We continue to be committed to provide you tools with competitive price.

"Save Half", "Half Price" or any other similar expressions used by us only represents an estimate of savings you might benefit from buying certain tools with us compared to the major top brands and does not necessarily mean to cover all categories of tools offered by us. You are kindly reminded to verify carefully when you are placing an order with us if you are actually saving half in comparison with the top major brands.

# VEVOR®

TOUGH TOOLS, HALF PRICE

## kids swivel chair

MODEL NR: LY-8303



### NEED HELP? CONTACT US!

Have product questions? Need technical support? Please feel free to contact us:

**Technical Support and E-Warranty Certificate**  
**[www.vevor.com/support](http://www.vevor.com/support)**

This is the original instruction, please read all manual instructions carefully before operating. VEVOR reserves a clear interpretation of our user manual. The appearance of the product shall be subject to the product you received. Please forgive us that we won't inform you again if there are any technology or software updates on our product.

## OSTRZEŻENIE:

**Przed użyciem produktu prosimy o dokładne zapoznanie się z niniejszą instrukcją. Niezastosowanie się do tego może spowodować poważne obrażenia. ZACHOWAJ TĘ INSTRUKCJĘ**

31. Nie dla dzieci poniżej 3 lat. Dzieci powinny bawić się pod nadzorem osoby dorosłej.

32. Przed montażem upewnij się, że wszystkie części są dobrze odebrane i w nienaruszonym stanie. Jeśli chodzi o jakąkolwiek część został zgubiony lub uszkodzony, wyślij nam wiadomość, a my jak najszybciej go rozwiążemy jak to możliwe.

33. Upewnij się, że krzesło jest dobrze zmontowane i sprawdź wcześniej jego stan za pomocą.

34. NIE używaj krzesła na nierównej podłodze.

35. Na wszelki wypadek NIE pozwalaj dzieciom siedzieć ani kręcić się dłużej niż 20 minut zawrotów głowy i naupatii.

36. Unikaj bezpośredniego światła słonecznego i wysokiej temperatury w przypadku odkształcenia plastycznego starzenie się.

## SPECYFIKACJA TECHNICZNA

Model	LY-8303
główny materiał	Metal + PP P ostatni ic
Kolor	Niebieski/zielony/pomarańczowy
Wymiary produktu (DxSxW)	495*515* 250mm
Rozmiar opakowania (DxSxW)	560*150*540mm
Masa netto (kg)	4.6
Masa brutto (kg)	5.4

## ZAWARTOŚĆ PACZKI



Panel \* 1 podstawa krzesła \* 1 metalowa płytką \* 1



Duży Załoga S \*1 Mała załoga S \*8 Śrubokręt\*2

## Złożenie

### SETP1

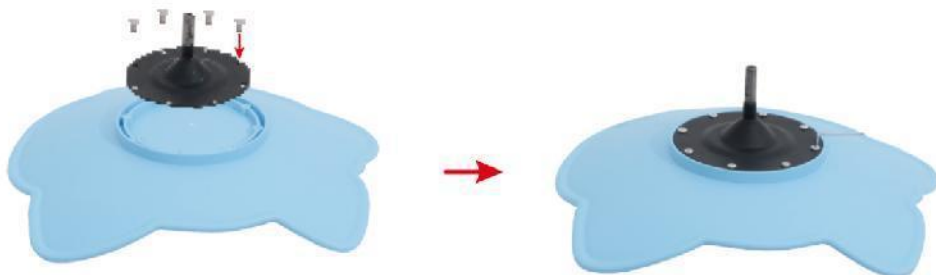



Przymocuj metalową płytkę do panelu chaie za pomocą małych śrub.

## SETP2

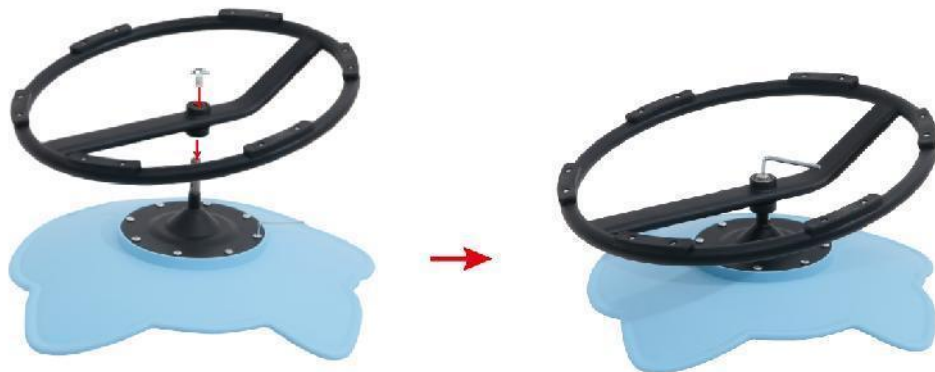

Zamocuj podstawę chaie na panelu krzesła.

## SETP3



Dokręć dużą śrubę śrubokrętem, aby zakończyć instalację.

# UKOŃCZENIE





**Producent:** Shanghaimuxinmuyeyouxiangongsi

**Adres:** Shuangchenglu 803nong11hao1602A-1609shi, baoshanqu, szanghaj 200000 CN.

**Import do AUS:** SIHAO PTY LTD. 1 ROKEVA STREETEASTWOOD NSW 2122 Australia

**Import do USA:** Sanven Technology Ltd. Suite 250, 9166 Anaheim Place, Rancho Cucamonga, CA 91730



E-CrossStu GmbH  
Mainzer Landstr.69, 60329 Frankfurt am Main.



YH CONSULTING LIMITED.  
C/O YH Consulting Limited Office 147, Centurion House, London Road, Staines-upon-Thames, Surrey, TW18 4AX

**VEVOR<sup>®</sup>**

**TOUGH TOOLS, HALF PRICE**

**Techniczny Certyfikat wsparcia i e-gwarancji**

**[www.vevor.com/support](http://www.vevor.com/support)**

# **VEVOR<sup>®</sup>**

## **TOUGH TOOLS, HALF PRICE**

Technisch Ondersteuning en e-garantiecertificaat  
[www.vevor.com/support](http://www.vevor.com/support)

## **KINDER DRAAISTOEL**

### **HANDLEIDING**

**MODELNR.: LY-8303**

We continue to be committed to provide you tools with competitive price.

"Save Half", "Half Price" or any other similar expressions used by us only represents an estimate of savings you might benefit from buying certain tools with us compared to the major top brands and does not necessarily mean to cover all categories of tools offered by us. You are kindly reminded to verify carefully when you are placing an order with us if you are actually saving half in comparison with the top major brands.

# VEVOR®

TOUGH TOOLS, HALF PRICE

## kids swivel chair

MODELNR.: LY-8303



### NEED HELP? CONTACT US!

Have product questions? Need technical support? Please feel free to contact us:

**Technical Support and E-Warranty Certificate**  
**[www.vevor.com/support](http://www.vevor.com/support)**

This is the original instruction, please read all manual instructions carefully before operating. VEVOR reserves a clear interpretation of our user manual. The appearance of the product shall be subject to the product you received. Please forgive us that we won't inform you again if there are any technology or software updates on our product.

## **WAARSCHUWING:**

**Lees deze handleiding zorgvuldig door voordat u het product gebruikt. Als u dit niet doet, kan dit leiden tot ernstig letsel. BEWAAR DEZE HANDLEIDING**

37. Niet voor kinderen jonger dan 3 jaar. Kinderen moeten spelen onder toezicht van volwassenen.
38. Zorg ervoor dat alle onderdelen goed zijn ontvangen en intact zijn voordat u ze monteert . Ik heb een deel kwijt of beschadigd is, stuur ons dan een bericht , dan lossen wij het zo snel mogelijk voor u op als mogelijk.
39. Zorg ervoor dat de stoel goed is gemonteerd en test vooraf de staat ervan gebruik makend van.
40. Gebruik de stoel NIET op een oneffen vloer.
41. Laat kinderen NIET langer dan 20 minuten per keer zitten of draaien van duizeligheid en naupathie.
42. Vermijd direct zonlicht en hoge temperaturen in geval van plastische vervorming veroudering.

## **TECHNISCHE SPECIFICATIES**

Model	LY-8303
hoofd materiaal	Metaal + PP P laatste ic
Kleur	Blauw/Groen/Oranje
Productafmetingen (LxBxH)	495*515*250 mm
Verpakkingsgrootte (LxBxH)	560*150*540mm
Netto gewicht / kg)	4.6
Bruto gewicht (kg)	5.4



# VERPAKKINGSINHOUD



Paneel \*1 Stoelbasis \*1 Metalen plaat\*1



Groot S- crew\*1 Kleine S- crew \*8 Schroevendraaier\*2

## in elkaar zetten

### STEP1

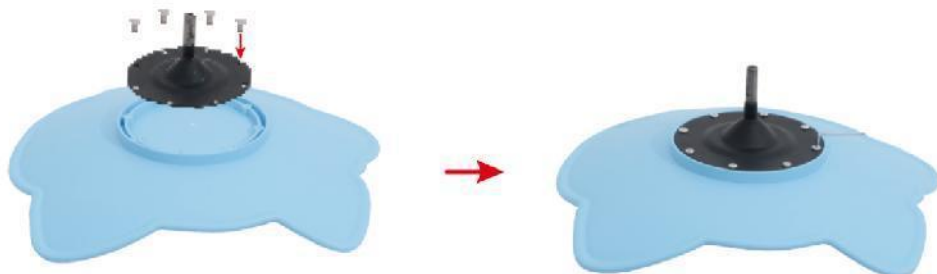

Bevestig de metalen plaat met kleine schroeven aan het chaiepaneel.

## SETP2

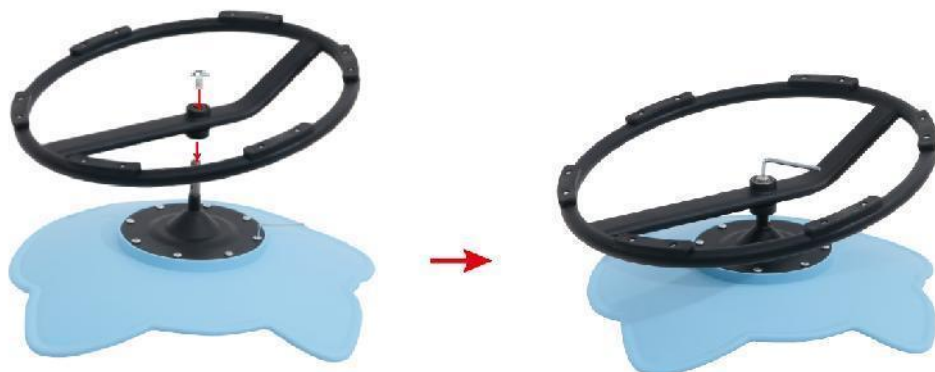

Bevestig de chaiebasis op het stoelpaneel.

## SETP3



Draai de grote schroef vast met een schroevendraaier om de installatie te voltooien.

# VOLTOOIING





**Fabrikant:** Shanghaimuxinmuyeyouxiangongsi

**Adres:** Shuangchenglu 803nong11hao1602A-1609shi, baoshanqu, shanghai 200000 CN.

**Geïmporteerd naar AUS:** SIHAO PTY LTD. 1 ROKEVA  
STREETEASTWOOD NSW 2122 Australië

**Geïmporteerd naar de VS:** Sanven Technology Ltd. Suite 250, 9166  
Anaheim Place, Rancho Cucamonga, CA 91730



E-CrossStu GmbH  
Mainzer Landstr.69, 60329 Frankfurt am Main.



YH CONSULTING LIMITED.  
C/O YH Consulting Limited Office 147, Centurion  
House, London Road, Staines-upon-Thames, Surrey,  
TW18 4AX

**VEVOR<sup>®</sup>**

**TOUGH TOOLS, HALF PRICE**

**Technisch Ondersteuning en e-garantiecertificaat**

**[www.vevor.com/support](http://www.vevor.com/support)**

# **VEVOR<sup>®</sup>**

## **TOUGH TOOLS, HALF PRICE**

Teknisk Support och e-garanticertifikat  
[www.vevor.com/support](http://www.vevor.com/support)

## **BARN SNURRSTOL**

# **ANVÄNDARMANUAL**

**MODELLNR: LY-8303**

We continue to be committed to provide you tools with competitive price.

"Save Half", "Half Price" or any other similar expressions used by us only represents an estimate of savings you might benefit from buying certain tools with us compared to the major top brands and does not necessarily mean to cover all categories of tools offered by us. You are kindly reminded to verify carefully when you are placing an order with us if you are actually saving half in comparison with the top major brands.

# VEVOR<sup>®</sup>

TOUGH TOOLS, HALF PRICE

## kids swivel chair

MODELLNR: LY-8303



### NEED HELP? CONTACT US!

Have product questions? Need technical support? Please feel free to contact us:

**Technical Support and E-Warranty Certificate**  
**[www.vevor.com/support](http://www.vevor.com/support)**

This is the original instruction, please read all manual instructions carefully before operating. VEVOR reserves a clear interpretation of our user manual. The appearance of the product shall be subject to the product you received. Please forgive us that we won't inform you again if there are any technology or software updates on our product.



 **VARNING:**

**Läs denna bruksanvisning noggrant innan du använder produkten. Underlåtenhet att göra det kan leda till allvarliga skador. SPARA DENNA MANUAL**

43. Ej för barn under 3 år. Barn ska leka under vuxens uppsikt.
44. Se till att alla delar är väl mottagna och i takt innan montering . Jag f någon del är borttappad eller skadad, skicka ett meddelande till oss så löser vi det åt dig så snart som möjligt.
45. Se till att stolen är välmonterad och testa dess skick innan använder sig av.
46. ANVÄND INTE stolen på det ojämna golvet.
47. Vänligen låt INTE barn sitta eller snurra mer än 20 minuter varje gång i så fall av yrsel och naupati.
48. Undvik direkt solljus och hög temperatur vid plastdeformering och åldrande.

## TEKNISKA SPECIFIKATIONER

Modell	LY-8303
huvudmaterial	Metall + PP P sista ic
Färg	Blå/grön/orange
Produktmått (LxBxH)	495*515*250 mm
Förpackningsstorlek (LxBxH)	560*150*540 mm
Nettovikt (kg)	4.6
Bruttovikt (kg)	5.4

# PAKET INNEHÅLL



Panel \*1 stolsockel \*1 metallplatta\*1



Stor S besättning\*1 Liten S besättning \*8 Skruvmejsel\*2

## Montering

### SETP1

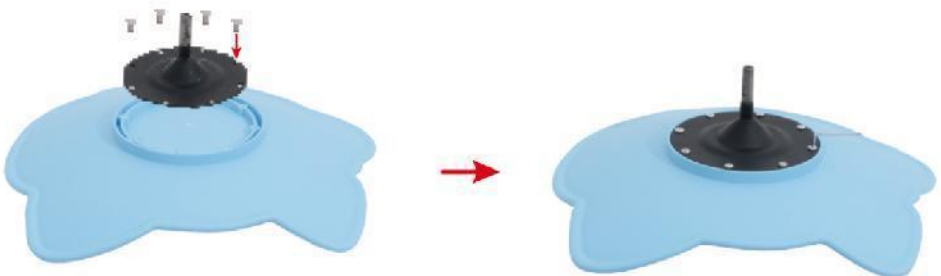

Fäst metallplattan på chaiepanelen med små skruvar.

## SETP2

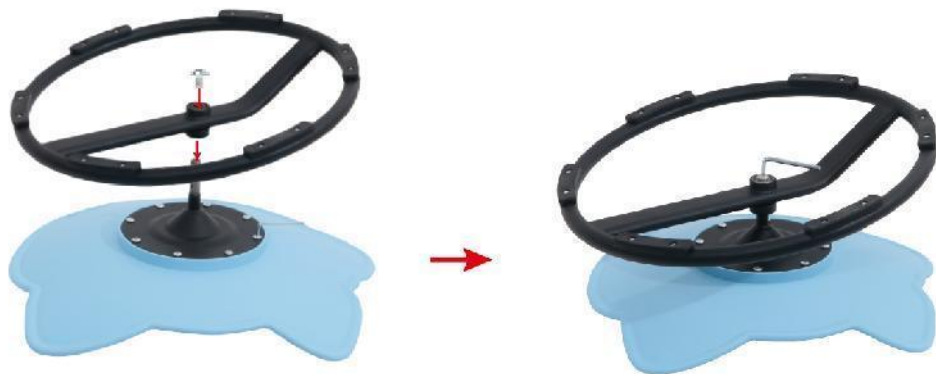

Fäst chaiebasen på stolspanelen.

## SETP3



Dra åt den stora skruven med en skruvmejsel för att slutföra installationen.

# KOMPLETTERING



**Tillverkare:** Shanghaimuxinmuyeyouxiangongsi

**Address:** Shuangchenglu 803nong11hao1602A-1609shi, baoshanqu, shanghai 200000 CN.

**Importerad till AUS:** SIHAO PTY LTD. 1 ROKEVA STREETEASTWOOD NSW 2122 Australien

**Importerad till USA:** Sanven Technology Ltd. Suite 250, 9166 Anaheim Place, Rancho Cucamonga, CA 91730



E-CrossStu GmbH  
Mainzer Landstr.69, 60329 Frankfurt am Main.



YH CONSULTING LIMITED.  
C/O YH Consulting Limited Office 147, Centurion House, London Road, Staines-upon-Thames, Surrey, TW18 4AX

**VEVOR<sup>®</sup>**

**TOUGH TOOLS, HALF PRICE**

**Teknisk Support och e-garanticertifikat**

**[www.vevor.com/support](http://www.vevor.com/support)**

