

VEVOR

Affordable. Reliable. Home Improvement.

SPRAY BOOTH USER MANUAL

VEVOR

Affordable. Reliable. Home Improvement.

SPRAY BOOTH

MODEL: AH-311



Photo for reference

This is the original instruction, please read all manual instructions carefully before operating. VEVOR reserves a clear interpretation of our user manual. The appearance of the product shall be subject to the product you received. Please forgive us that we won't inform you again if there are any technology or software updates on our product.

SAFETY INSTRUCTION AND PRECAUTIONS

⚠WARNING:

Unqualified use and improve maintenance of these mini air compressor could result in serious personal injury. The following safety instructions should be operated to avoid any risk! Please read all of these instructions carefully and follow them!

1. Choose the right tools and power supply tie-in with right frequency and voltage according to the local power supply. Otherwise, the motor maybe damaged and/or the fire maybe caused.
2. Please check and make sure that the machine, including the connection, switch is all in good conditions.
3. The spray booth must be operated in accordance with the current safety regulations, and all the power sockets must be earthed. Please do not touch the electric cable with the wet hands.
4. The unauthorized conversion, modification of disassembly of the products is inadmissible because of safety and approval reasons.
5. Keep working area clean and tidy. Unused tools should be stored in their respective places. Ensure that the working area is well ventilated.
6. Never operate the spray booth in the presence of flammable liquids or gases the spray booth may produce sparks when in operation. Do not use the booth in areas where painting colors, petrol, chemicals, adhesives, and other flammable and explosive substances are present.
7. Keep out of the reach of children. Never allow children and other irrelevant persons touch the spray booth and its power cord. All unauthorized persons should be kept clear of the working area.
8. Don't open or tamper with any part of the spray booth. Contact an authorized service center.
9. The spray booth must be used in suitable environment (well ventilated, with an ambient temperature between +5°C and +40°C)
10. The device should continue to run for approx 2 to 6 minutes after each use, which ensures the self-cleaning of the device!
11. If you have reason to assume that safe operation is no longer possible, disconnect the device immediately and secure it against inadvertent operation it.

If you find any potential dangerous during using, PLEASE disconnect the power immediately.

FCC Information:

CAUTION: Changes or modifications not expressly approved by the party responsible for compliance could void the user's authority to operate the equipment!

This device complies with Part 15 of the FCC Rules. Operation is subject to the following two conditions:

- 1) This product may cause harmful interference.
- 2) This product must accept any interference received, including interference that may cause undesired operation.

WARNING: Changes or modifications to this product not expressly approved by the party responsible for compliance could void the user's authority to operate the product.

Note: This product has been tested and found to comply with the limits for a Class B digital device pursuant to Part 15 of the FCC Rules, These limits are designed to provide reasonable protection against harmful interference in a residential installation.

This product generates, uses and can radiate radio frequency energy, and if not installed and used in accordance with the instructions, may cause harmful interference to radio communications. However, there is no guarantee that interference will not occur in a particular installation. If this product does cause harmful interference to radio or television reception, which can be determined by turning the product off and on, the user is encouraged to try to correct the interference by one or more of the following measures.

- Reorient or relocate the receiving antenna.
- Increase the distance between the product and receiver.
- Connect the product to an outlet on a circuit different from that to which the receiver is connected.
- Consult the dealer or an experienced radio/TV technician for assistance.

CORRECT DISPOSAL:



This product is subject to the provision of European Directive 2012/19/EU. The symbol showing a wheeled bin crossed through indicates that the product requires separate refuse collection in the European Union. This applies to the product and all accessories marked with this symbol. Products marked as such may not be discarded with normal domestic waste, but must be taken to a collection point for recycling electrical and electronic devices.

Features:

1. The spray booth can be folded and extended, smart in size, light in weight.
2. It has small power, with big air flow, no need of ventilation pipe, it saves energy and protects environment.
3. It has high density filter net, can filter most of the paint and moisture. And it has no pollution.
4. With full transparent booth, and the two machines can be combined together for big toys.
5. It has light on/off switch, it will light when the machine turns on. And it has low noise about 53 db.
6. It has a revolving plate, and has handle on the top, convenient to use.
7. The air volume can be adjusted to high and low by a knob.

Specification:

Motor: DC12V 5A

Adapter Input: AC100-240V 50/60HZ

Air flow: 9.2 m³ /min

Working voltage(Led light):12V

Power(Led Light): 6W

Noise level: ≤53 db

Shrink dimension: 54.8x29.2x32.7cm

Extend dimension: 54.5x47.5x37cm

Part List

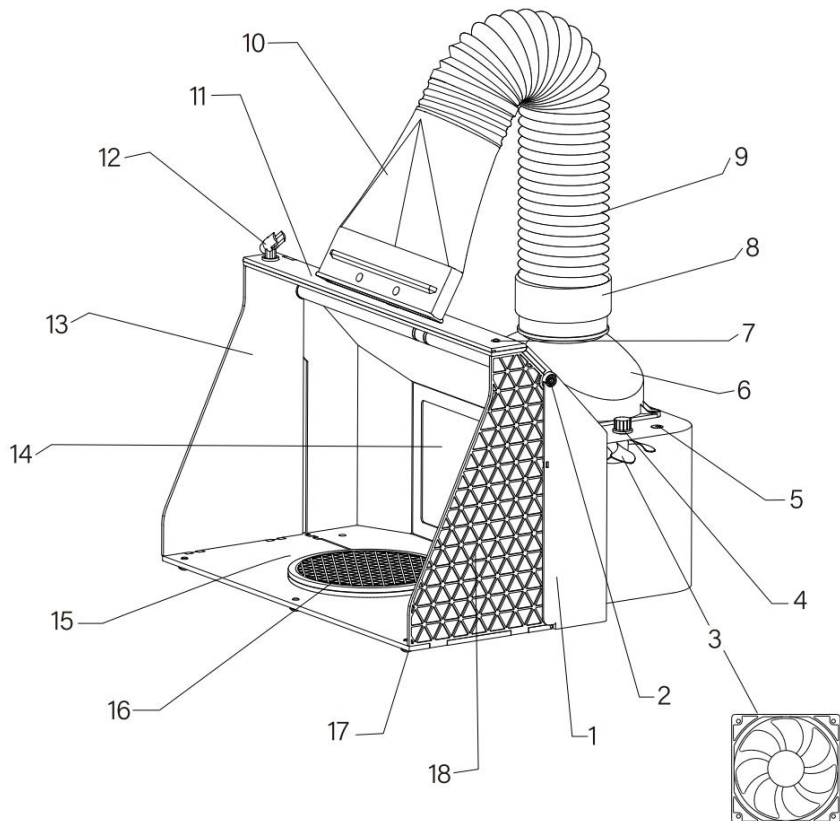

1	The booth body	7	LED light switch	13	Plate
2	Light zone plate port	8	Air duct fastening buckle	14	Filter net for painting
3	Fan	9	Duct	15	Front cover bed-plate
4	Switch	10	Duct head	16	Revolving Turntable
5	Connector for cord adapter	11	Light zone plate	17	Rubber feet
6	Connector for duct	12	Holder	18	Plate

Product accessories:



AH-311 Spray booth



Duct



Duct head



Revolving Turntable



Holder



Adapter

Detail presentation:



Switch: The suction size can be adjusted through the knob

Power interface

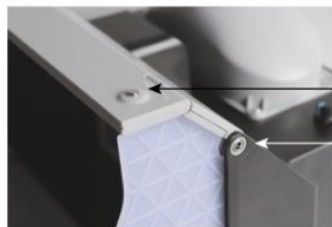

Light strip switch

The lamp has a power port

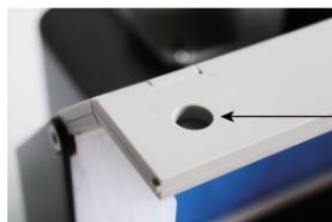

Airbrush holder placement hole

-The spray pen can be placed on the upper left of the spray booth to set the pen when painting or pausing.

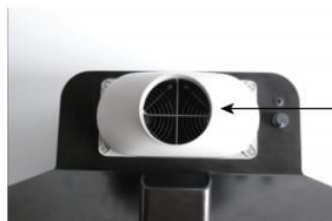

Bigger and stronger Double fan

-Inside two fans can work at the same time, let the air flow be more powerful.
-Exhaust vent placed directly on top of the case, easier to adjust the air hose direction.

Operation Instruction:



1.Unfold The Lamp Strip Plate.

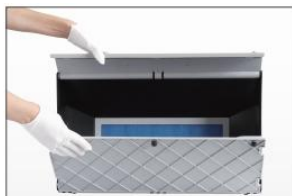

2.Unfold The Baseplate.



3.Respectively Unfold The Side Plate On Both Sides, Align Them With The Hole Positions Of The Lamp Cover Plate, And Fasten Them.



4. Painting table after expansion effect.



5.Extend the hose.



6.Fix the duct head on hose.



7.Connect the duct to connector.



8.Fasten the duct by screwing up the fasteners.



9. Install the spray airbrush holder.



10.The assembly is finished.



11.Plug the cord adapter and connect to Power pack.



12.Turn on the switch, the machine will start working.

Safety instructions and hazard warnings

Please read the entire operating instructions before using the products for the first time; They contain important information about the correct operation.

The guarantee/warranty will be void if damage is incurred resulting from non-compliance with the operating instructions. Liability for any and all consequential damage is excluded!

We do not assume any liability for damage to property or personal injury caused by improper use or the failure to observe the safety instructions! In such cases the guarantee/warranty will be void.

- The unauthorised conversion, modification or disassembly of the products is inadmissible because of safety and approval reasons (CE).
- The product is not a toy and must be kept out of the reach of children. Particular care must therefore be exercised if children are present.
- The product must not get damp or wet, it is only intended for use in dry, indoor locations (not bathrooms or similarly damp areas). There is a risk of a fatal electric shock.
- Do not expose the product or its accessories to damp or extremely high or low temperatures.
- Do not leave packing materials unattended. They may become dangerous playing material for children.
- Dropping, falling, pressure or tensile forces could destroy or at least limit the function of the product.
- Never position the device in the vicinity of combustible or easily inflammable materials, e.g. curtains!
- Always make sure that the rotary table on which the object is placed is located in the center of the housing!
- The device should continue to run for approximately 2 minutes after each application, which ensures the self-cleaning of the device!
- Always turn the device off and pull the mains plug out when the device is not in use!

- If the filter is contaminated with substantial amounts of paint, it can no longer work efficiently and must be replaced with a clean filter.
- To prevent health damage, never use poisonous, flammable or explosive paints or materials!
- Always ensure proper ventilation!
- To not impair the extraction performance, you may not extend the extraction pipe!
- In commercial institutions, the accident prevention regulations of the employer's liability insurance association for electrical systems and operating facilities are to be observed.
- In schools, training centres, hobby and self-help workshops, the use of the product must be supervised by trained personnel in a responsible manner.
- If you have reason to assume that safe operation is no longer possible, disconnect the device immediately and secure it against inadvertent operation.

It can be assumed that safe operation is no longer possible if:

- the device shows visible signs of damage,
- the device no longer functions,
- after a longer period of storage under unfavourable conditions,
- following heavy stress during transportation.

Choice of power source:

1. North America plug: AC100~240V - 50/60Hz
2. European plug: AC100~240V - 50/60Hz
3. Australian plug: AC100~240V - 50/60Hz

Matching kit:

1. Instruction manual * 1
2. Expansion tube * 1
3. Flat mouth exhaust outlet * 1
4. Rubber joint * 1
5. Iron card ring * 1
6. Lamp strip * 3

- 7. Adapter * 1
- 8. Rotary table * 1
- 9. Filter cotton * 1

Address: Shuangchenglu 803nong11hao1602A-1609shi, baoshanqu, shanghai 200000 CN.

Imported to AUS: SIHAO PTY LTD, 1 ROKEVA STREETEASTWOOD NSW 2122 Australia

Imported to USA: Sanven Technology Ltd., Suite 250, 9166 Anaheim Place, Rancho Cucamonga, CA 91730

EC	REP
-----------	------------

E-CrossStu GmbH
Mainzer Landstr.69, 60329 Frankfurt am Main.

UK	REP
-----------	------------

YH CONSULTING LIMITED.
C/O YH Consulting Limited Office 147, Centurion House,
London Road, Staines-upon-Thames, Surrey, TW18 4AX



VEVOR

Affordable. Reliable. Home Improvement.

SPRITZKABINE BENUTZERHANDBUCH

VEVOR

Affordable. Reliable. Home Improvement.

SPRAY BOOTH

MODELL: AH-311



Foto als Referenz

Dies ist die Originalanleitung. Bitte lesen Sie alle Anweisungen sorgfältig durch, bevor Sie das Gerät in Betrieb nehmen. VEVOR behält sich eine klare Auslegung unserer Bedienungsanleitung vor. Das Aussehen des Produkts hängt vom gelieferten Produkt ab. Bitte haben Sie Verständnis dafür, dass wir Sie nicht erneut über Technologie- oder Software-Updates informieren.

SAFETY INSTRUCTION AND PRECAUTIONS

⚠️ WARNUNG:

Unsachgemäßer Gebrauch und Wartung dieses Mini-Luftkompressors können zu schweren Verletzungen führen. Beachten Sie die folgenden Sicherheitshinweise, um Risiken zu vermeiden! Lesen Sie diese Anweisungen sorgfältig durch und befolgen Sie sie!

1. Wählen Sie die richtigen Werkzeuge und das richtige Netzteil mit der richtigen Frequenz und Spannung entsprechend der örtlichen Stromversorgung. Andernfalls kann der Motor beschädigt werden und/oder ein Brand verursacht werden.
2. Bitte überprüfen Sie, ob die Maschine, einschließlich der Anschlüsse und Schalter, in gutem Zustand ist.
3. Die Spritzkabine muss gemäß den geltenden Sicherheitsvorschriften betrieben werden. Alle Steckdosen müssen geerdet sein. Berühren Sie das Stromkabel nicht mit nassen Händen.
4. Das eigenmächtige Umbauen, Verändern oder Zerlegen der Produkte ist aus Sicherheits- und Zulassungsgründen nicht zulässig .
5. Halten Sie den Arbeitsbereich sauber und ordentlich. Unbenutzte Werkzeuge sollten an ihrem jeweiligen Platz aufbewahrt werden. Sorgen Sie für eine gute Belüftung des Arbeitsbereichs.
6. Betreiben Sie die Spritzkabine niemals in der Nähe von brennbaren Flüssigkeiten oder Gasen. Die Spritzkabine kann während des Betriebs Funken erzeugen. Verwenden Sie die Kabine nicht in Bereichen, in denen Farben, Benzin, Chemikalien, Klebstoffe und andere brennbare und explosive Substanzen vorhanden sind .
7. Außerhalb der Reichweite von Kindern aufbewahren. Lassen Sie Kinder und andere unbefugte Personen niemals die Spritzkabine und das Netzkabel berühren. Alle unbefugten Personen sind vom Arbeitsbereich fernzuhalten.
8. Öffnen oder manipulieren Sie keine Teile der Spritzkabine. Wenden Sie sich an ein autorisiertes Servicecenter .
9. Die Spritzkabine muss in einer geeigneten Umgebung (gut belüftet, mit einer Umgebungstemperatur zwischen +5°C und +40°C)

1 0 . Das Gerät sollte nach jedem Gebrauch noch ca. 2 bis 6 Minuten nachlaufen, dadurch wird die Selbstreinigung des Gerätes gewährleistet!

1 1 . Wenn Sie Grund zur Annahme haben, dass ein gefahrloser Betrieb nicht mehr möglich ist, trennen Sie das Gerät sofort vom Stromnetz und sichern Sie es gegen unbeabsichtigten Betrieb.

Wenn Sie während der Verwendung eine mögliche Gefahr feststellen, trennen Sie BITTE sofort die Stromversorgung.

FCC-Informationen:

VORSICHT: Änderungen oder Modifikationen, die nicht ausdrücklich von der für die Einhaltung der Vorschriften verantwortlichen Partei genehmigt wurden, können zum Erlöschen der Berechtigung des Benutzers zum Betrieb des Geräts führen! Dieses Gerät entspricht Teil 15 der FCC-Bestimmungen. Der Betrieb unterliegt den folgenden zwei Bedingungen:

3) Dieses Produkt kann schädliche Störungen verursachen.

4) Dieses Produkt muss alle empfangenen Störungen tolerieren, einschließlich Störungen, die einen unerwünschten Betrieb verursachen können.

WARNUNG: Änderungen oder Modifikationen an diesem Produkt, die nicht ausdrücklich von der für die Einhaltung verantwortlichen Partei genehmigt wurden, können zum Erlöschen der Berechtigung des Benutzers zum Betrieb des Produkts führen.

Hinweis: Dieses Produkt wurde getestet und entspricht den Grenzwerten für digitale Geräte der Klasse B gemäß Teil 15 der FCC-Bestimmungen. Diese Grenzwerte sollen einen angemessenen Schutz vor schädlichen Störungen bei der Installation in Wohngebieten bieten.

Dieses Produkt erzeugt und nutzt Hochfrequenzenergie und kann diese abstrahlen. Bei unsachgemäßer Installation und Verwendung kann es zu Störungen des Funkverkehrs kommen. Es besteht jedoch keine Garantie dafür, dass bei einer bestimmten Installation keine Störungen auftreten. Sollte dieses Produkt Störungen des Radio- oder Fernsehempfangs verursachen (was durch Ein- und Ausschalten des Produkts überprüft werden kann), wird dem Benutzer empfohlen, die Störungen durch eine oder mehrere der folgenden Maßnahmen zu beheben.

· Richten Sie die Empfangsantenne neu aus oder verlegen Sie sie.

- Vergrößern Sie den Abstand zwischen Produkt und Empfänger.
- Schließen Sie das Produkt an eine Steckdose an, die sich in einem anderen Stromkreis befindet als der Empfänger.
- Wenden Sie sich an den Händler oder einen erfahrenen Radio-/Fernsehtechniker, um Hilfe zu erhalten.

RICHTIGE ENTSORGUNG :



Dieses Produkt unterliegt den Bestimmungen der europäischen Richtlinie 2012/19/EU. Das Symbol einer durchgestrichenen Mülltonne weist darauf hin, dass dieses Produkt in der Europäischen Union einer getrennten Müllentsorgung unterliegt. Dies gilt für das Produkt und alle mit diesem Symbol gekennzeichneten Zubehörteile.

Entsprechend gekennzeichnete Produkte dürfen nicht im Hausmüll entsorgt werden, sondern müssen an einer Sammelstelle für das Recycling von elektrischen und elektronischen Geräten abgegeben werden.

Merkmale:

1. Die Spritzkabine kann zusammengeklappt und erweitert werden, hat eine praktische Größe und ein geringes Gewicht.
2. Es hat eine geringe Leistung, mit großem Luftstrom, keine Notwendigkeit eines Belüftungsrohrs, es spart Energie und schützt Umfeld.
3. Es verfügt über ein hochdichtes Filternetz, das den Großteil der Farbe und Feuchtigkeit filtern kann. Es verursacht keine Verschmutzung.
4. Mit vollständig transparenter Kabine können die beiden Maschinen für große Spielzeuge miteinander kombiniert werden.
5. Es verfügt über einen Ein-/Ausschalter für das Licht . Licht, wenn die Maschine eingeschaltet wird. Und es hat geringe Geräusentwicklung etwa 53 dB.
6. Es verfügt über eine Drehplatte und einen Griff an der Oberseite, was die Verwendung erleichtert.
7. Die Luftmenge kann mit einem Drehknopf auf hoch und niedrig eingestellt werden.

Spezifikation:

Motor: DC12V 5 A

Adaptiereingang : AC100-240V 50/60HZ

Luftstrom: 9,2 m³ /min

Betriebsspannung (LED-Licht): 12 V

Leistung (LED-Licht): 6 W

Geräuschpegel: ≤53 dB

Schrumpfmaß: 54,8 x 29,2 x 32,7 cm

Dimension erweitern: 54,5 x 4,75 x 37 cm

Teilleiste

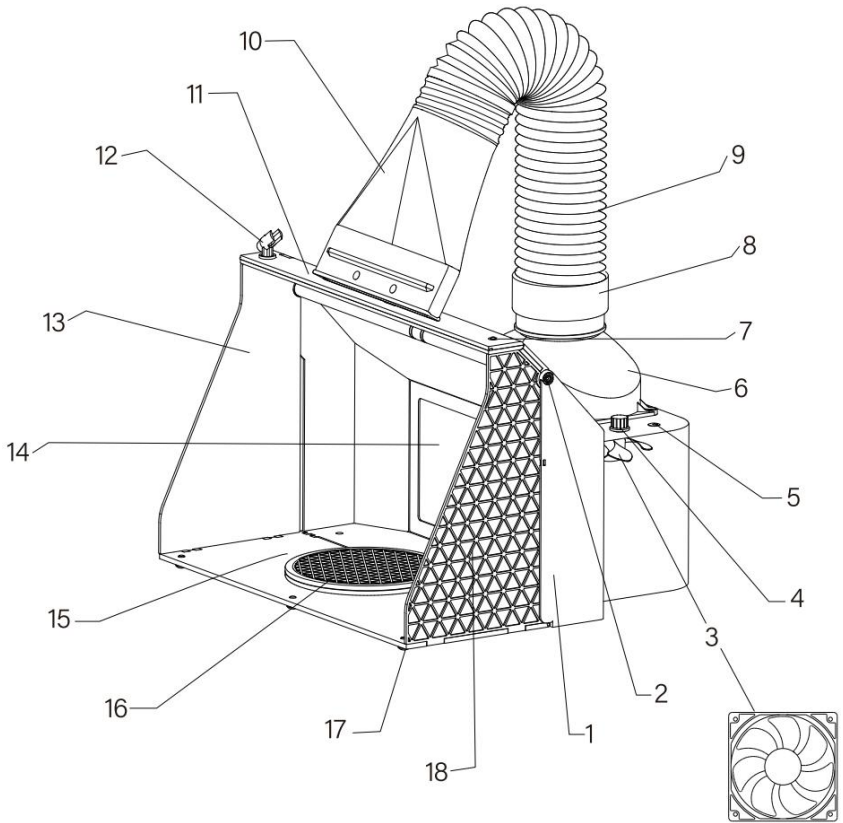

1	Der Standkörper	7	LED-Lichtschalter	13	Platte
2	Lichtzonenplattenanschluss	8	Luftkanal-Befestigungsschnalle	14	Filternetz zum Lackieren
3	Lüfter	9	Leitung	15	Vordere Abdeckung Grundplatte
4	Schalten	10	Kanalkopf	16	Drehbarer Plattenspieler
5	Anschluss für Kabeladapter	11	Lichtzonenplatte	17	GummifüÙe
6	Verbinder für Kanal	12	Halter	18	Platte

Produktzubehör:



AH-311 Spray booth



Duct



Duct head



Revolving Turntable



Holder



Adapter

Detaildarstellung:



Switch: The suction size can be adjusted through the knob

Power interface

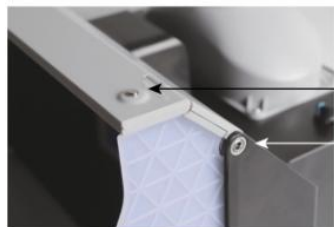

Light strip switch

The lamp has a power port

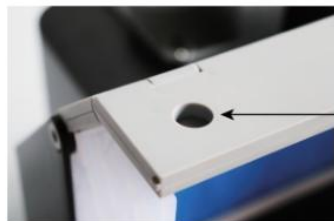

Airbrush holder placement hole

-The spray pen can be placed on the upper left of the spray booth to set the pen when painting or pausing.



Bigger and stronger Double fan

-Inside two fans can work at the same time, let the air flow be more powerful.
-Exhaust vent placed directly on top of the case, easier to adjust the air hose direction.

Bedienungsanleitung:



1.Unfold The Lamp Strip Plate.



2.Unfold The Baseplate.



3.Respectively Unfold The Side Plate On Both Sides, Align Them With The Hole Positions Of The Lamp Cover Plate, And Fasten Them.



4. Painting table after expansion effect.



5.Extend the hose.



6.Fix the duct head on hose.



7.Connect the duct to connector.



8.Fasten the duct by screwing up the fasteners.



9. Install the spray airbrush holder.



10.The assembly is finished.



11.Plug the cord adapter and connect to Power pack.



12.Turn on the switch, the machine will start working.

Sicherheitshinweise und Gefahrenhinweise

Please read the entire operating instructions before using the products for the first time; They contain important information about the correct operation.

The guarantee/warranty will be void if damage is incurred resulting from non-compliance with the operating instructions. Liability for any and all consequential damage is excluded!

We do not assume any liability for damage to property or personal injury caused by improper use or the failure to observe the safety instructions! In such cases the guarantee/warranty will be void.

- The unauthorised conversion, modification or disassembly of the products is inadmissible because of safety and approval reasons (CE).
- The product is not a toy and must be kept out of the reach of children. Particular care must therefore be exercised if children are present.
- The product must not get damp or wet, it is only intended for use in dry, indoor locations (not bathrooms or similarly damp areas). There is a risk of a fatal electric shock.
- Do not expose the product or its accessories to damp or extremely high or low temperatures.
- Do not leave packing materials unattended. They may become dangerous playing material for children.
- Dropping, falling, pressure or tensile forces could destroy or at least limit the function of the product.
- Never position the device in the vicinity of combustible or easily inflammable materials, e.g. curtains!
- Always make sure that the rotary table on which the object is placed is located in the center of the housing!
- The device should continue to run for approximately 2 minutes after each application, which ensures the self-cleaning of the device!
- Always turn the device off and pull the mains plug out when the device is not in use!

- If the filter is contaminated with substantial amounts of paint, it can no longer work efficiently and must be replaced with a clean filter.
- To prevent health damage, never use poisonous, flammable or explosive paints or materials!
- Always ensure proper ventilation!
- To not impair the extraction performance, you may not extend the extraction pipe!
- In commercial institutions, the accident prevention regulations of the employer's liability insurance association for electrical systems and operating facilities are to be observed.
- In schools, training centres, hobby and self-help workshops, the use of the product must be supervised by trained personnel in a responsible manner.
- If you have reason to assume that safe operation is no longer possible, disconnect the device immediately and secure it against inadvertent operation.

It can be assumed that safe operation is no longer possible if:

- the device shows visible signs of damage,
- the device no longer functions,
- after a longer period of storage under unfavourable conditions,
- following heavy stress during transportation.

Wahl der Stromquelle :

1. Nordamerika-Stecker: AC 10 0 ~240V - 50/ 60Hz
2. Europäischer Stecker: AC 10 0 ~240V - 50/ 60Hz
3. Australischer Stecker: AC 10 0 ~240V - 50/ 60Hz

Passendes Kit :

10. Bedienungsanleitung * 1
11. Expansionsrohr * 1
12. Flachmund-Auspuffauslass * 1
13. Gummigelenk * 1
14. Eisenkartenring * 1
15. Lampenstreifen * 3

- 16. Adapter * 1
- 17. Drehtisch * 1
- 18. Filterwatte * 1

Adresse : Shuangchenglu 803nong11hao1602A-1609shi, Baoshanqu, Shanghai 200000 CN.

Importiert nach AUS: SIHAO PTY LTD, 1 ROKEVA STREETEASTWOOD NSW 2122 Australien

Importiert in die USA: Sanven Technology Ltd., Suite 250, 9166 Anaheim Place, Rancho Cucamonga, CA 91730

EC	REP
-----------	------------

E-CrossStu GmbH
Mainzer Landstr.69, 60329 Frankfurt am Main.

UK	REP
-----------	------------

YH CONSULTING LIMITED.
C/O YH Consulting Limited Office 147, Centurion House,
London Road, Staines-upon-Thames, Surrey, TW18 4AX



VEVOR

Affordable. Reliable. Home Improvement.

CABINE DE PEINTURE MANUEL D'UTILISATION

VEVOR

Affordable. Reliable. Home Improvement.

SPRAY BOOTH

MODÈLE : AH-311



Photo pour référence

Ceci est le mode d'emploi d'origine. Veuillez lire attentivement l'intégralité du manuel avant utilisation. VEVOR se réserve le droit d'interpréter clairement ce manuel d'utilisation. L'apparence du produit dépend du produit que vous avez reçu. Veuillez nous excuser pour les éventuelles mises à jour technologiques ou logicielles.

SAFETY INSTRUCTION AND PRECAUTIONS

⚠️ AVERTISSEMENT:

L'utilisation non conforme et un entretien insuffisant de ce mini compresseur d'air peuvent entraîner des blessures graves. Respectez les consignes de sécurité suivantes pour éviter tout risque ! Veuillez lire attentivement ces instructions et les respecter !

1. Choisissez les bons outils et une alimentation électrique avec une fréquence et une tension adaptées au réseau électrique local. Dans le cas contraire, le moteur risque d'être endommagé et/ou un incendie peut survenir.
2. Veuillez vérifier et vous assurer que la machine, y compris la connexion et l'interrupteur, sont tous en bon état.
3. La cabine de pulvérisation doit être utilisée conformément aux normes de sécurité en vigueur et toutes les prises électriques doivent être reliées à la terre. Ne touchez pas le câble électrique avec les mains mouillées.
4. La conversion, la modification ou le démontage non autorisés des produits sont inadmissibles pour des raisons de sécurité et d'homologation .
5. Maintenir la zone de travail propre et rangée. Les outils non utilisés doivent être rangés à leur place. Veiller à ce que la zone de travail soit bien ventilée.
6. N'utilisez jamais la cabine de peinture en présence de liquides ou de gaz inflammables ; elle peut produire des étincelles. N'utilisez pas la cabine dans des zones où sont présents des peintures, de l'essence, des produits chimiques, des adhésifs et autres substances inflammables et explosives .
7. Tenir hors de portée des enfants. Ne jamais laisser les enfants ou toute autre personne non autorisée toucher la cabine de pulvérisation et son cordon d'alimentation. Toute personne non autorisée doit être tenue à l'écart de la zone de travail .
8. N'ouvrez ni ne manipulez aucune partie de la cabine de pulvérisation. Contactez un centre de service agréé .
9. La cabine de pulvérisation doit être utilisée dans un environnement approprié (bien ventilé, avec une température ambiante comprise entre **+5°C** et **+40°C**)
10 . L'appareil doit continuer à fonctionner pendant environ 2 à 6 minutes après chaque utilisation, ce qui garantit l'auto-nettoyage de l'appareil !

1 1 . Si vous avez des raisons de penser qu'un fonctionnement sûr n'est plus possible, débranchez immédiatement l'appareil et sécurisez-le contre toute utilisation involontaire.

Si vous trouvez un danger potentiel pendant l'utilisation, VEUILLEZ débrancher immédiatement l'alimentation.

Informations FCC :

ATTENTION : Les changements ou modifications non expressément approuvés par la partie responsable de la conformité pourraient annuler le droit de l'utilisateur à utiliser l'équipement !

Cet appareil est conforme à la partie 15 de la réglementation FCC. Son utilisation est soumise aux deux conditions suivantes :

5) Ce produit peut provoquer des interférences nuisibles.

6) Ce produit doit accepter toute interférence reçue, y compris celles qui peuvent provoquer un fonctionnement indésirable.

AVERTISSEMENT : Les changements ou modifications apportés à ce produit non expressément approuvés par la partie responsable de la conformité pourraient annuler le droit de l'utilisateur à utiliser le produit.

Remarque : ce produit a été testé et jugé conforme aux limites d'un appareil numérique de classe B conformément à la partie 15 des règles de la FCC. Ces limites sont conçues pour fournir une protection raisonnable contre les interférences nuisibles dans une installation résidentielle.

Ce produit génère, utilise et peut émettre des radiofréquences. S'il n'est pas installé et utilisé conformément aux instructions, il peut provoquer des interférences nuisibles aux communications radio. Cependant, rien ne garantit l'absence d'interférences dans une installation donnée. Si ce produit provoque des interférences nuisibles à la réception radio ou télévision, ce qui peut être vérifié en éteignant et en rallumant l'appareil, l'utilisateur est encouragé à essayer de corriger ces interférences en appliquant une ou plusieurs des mesures suivantes.

- Réorienter ou déplacer l'antenne de réception.
- Augmenter la distance entre le produit et le récepteur.
- Branchez le produit sur une prise d'un circuit différent de celui sur lequel le récepteur est branché.

· Consultez le revendeur ou un technicien radio/TV expérimenté pour obtenir de l'aide.

ÉLIMINATION CORRECTE :



Ce produit est soumis aux dispositions de la directive européenne 2012/19/UE. Le symbole représentant une poubelle barrée indique que le produit doit faire l'objet d'une collecte sélective dans l'Union européenne. Ceci s'applique au produit et à tous les accessoires marqués de ce symbole. Les produits ainsi marqués ne doivent pas être jetés avec les ordures ménagères, mais doivent être déposés dans un point de collecte pour le recyclage des appareils électriques et électroniques.

Caractéristiques:

1. La cabine de pulvérisation peut être pliée et étendue, de taille intelligente et légère.
2. Il a une petite puissance, avec un grand débit d'air, pas besoin de tuyau de ventilation, il économise de l'énergie et protège l'environnement.
3. Il est doté d'un filtre haute densité, capable de filtrer la majeure partie de la peinture et de l'humidité. Il est également exempt de pollution.
4. Sa cabine entièrement transparente permet de combiner les deux machines pour les gros jouets.
5. Il est équipé d'un interrupteur marche/arrêt. s'allume lorsque la machine est allumée. Son niveau sonore est faible. environ 53 db.
6. Il dispose d'une plaque tournante et d'une poignée sur le dessus, pratique à utiliser.
7. Le volume d'air peut être réglé haut et bas à l'aide d'un bouton.

Spécification:

Moteur : DC12 V 5 A Entrée

de l'adaptateur : AC100-240 V 50/60 HZ

Débit d'air : 9,2 m³/min

Tension de fonctionnement (lumière LED) : 12 V

Puissance (lumière LED) : 6 W

Niveau sonore : ≤ 53 dB

Dimension de rétrécissement : 54,8x29,2x32,7 cm

Étendre la dimension : 54,5 x 4 7,5 x 37 cm

Liste des parties

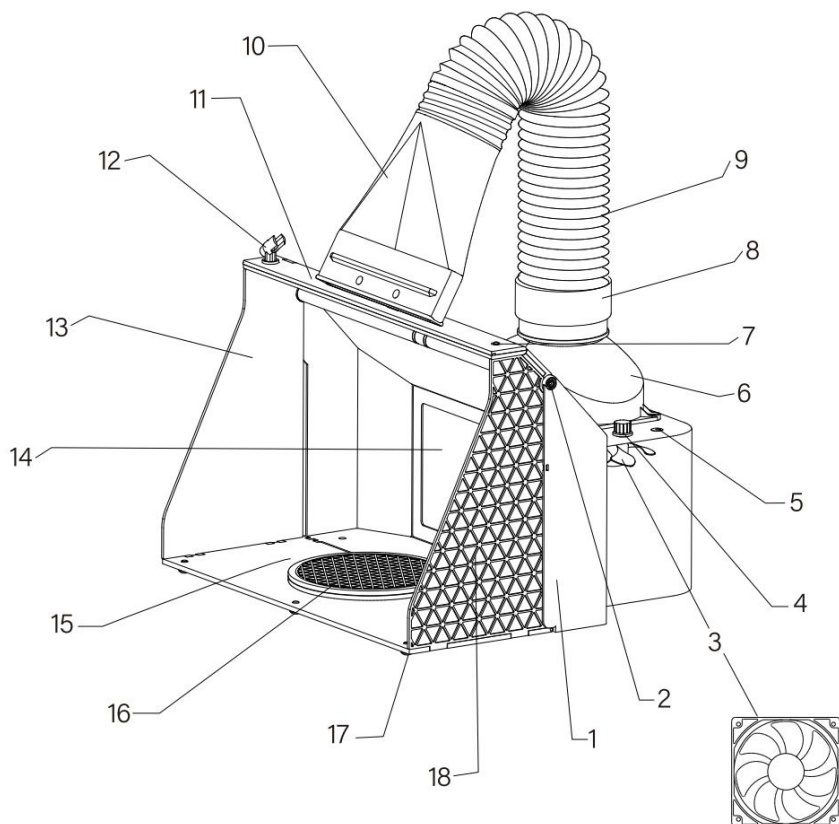

1	Le corps de la cabine	7	Interrupteur d'éclairage LED	13	Plaque
2	Port de plaque de zone lumineuse	8	Boucle de fixation du conduit d'air	14	Filet filtrant pour la peinture

3	Ventilateur	9	Canal	15	Plaque de base du couvercle avant
4	Changer	10	Tête de conduit	16	Plateau tournant
5	Connecteur pour adaptateur de cordon	11	Plaque de zone lumineuse	17	pieds en caoutchouc
6	Connecteur pour conduit	12	Titulaire	18	Plaque

Accessoires du produit :



AH-311 Spray booth



Duct



Duct head



Revolving Turntable



Holder



Adapter

Présentation détaillée :

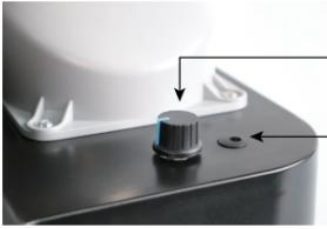

Switch: The suction size can be adjusted through the knob

Power interface

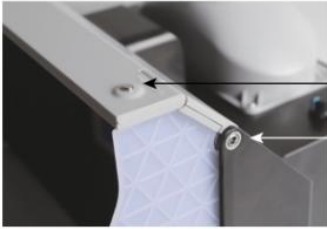

Light strip switch

The lamp has a power port

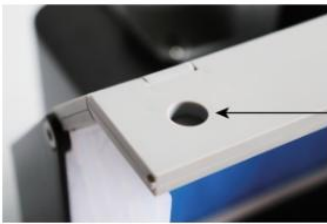

Airbrush holder placement hole

-The spray pen can be placed on the upper left of the spray booth to set the pen when painting or pausing.

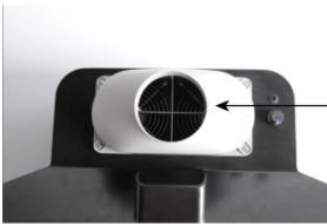

Bigger and stronger Double fan

-Inside two fans can work at the same time, let the air flow Be more powerful.
-Exhaust vent placed directly on top of the case, easier to adjust the air hosedirection.

Instructions d'utilisation :



1.Unfold The Lamp Strip Plate.

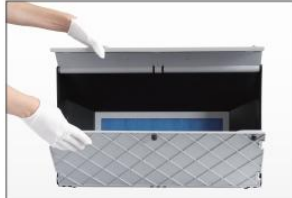

2.Unfold The Baseplate.



3.Respectively Unfold The Side Plate On Both Sides, Align Them With The Hole Positions Of The Lamp Cover Plate, And Fasten Them.



4. Painting table after expansion effect.



5.Extend the hose.

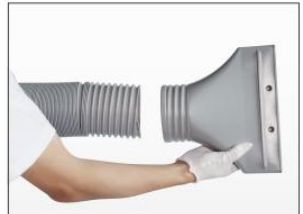

6.Fix the duct head on hose.



7.Connect the duct to connector.



8.Fasten the duct by screwing up the fasteners.



9. Install the spray airbrush holder.



10.The assembly is finished.



11.Plug the cord adapter and connect to Power pack.



12.Turn on the switch, the machine will start working.

Consignes de sécurité et avertissements de danger

Please read the entire operating instructions before using the products for the first time; They contain important information about the correct operation.

The guarantee/warranty will be void if damage is incurred resulting from non-compliance with the operating instructions. Liability for any and all consequential damage is excluded!

We do not assume any liability for damage to property or personal injury caused by improper use or the failure to observe the safety instructions! In such cases the guarantee/warranty will be void.

- The unauthorised conversion,modification of disassembly of the products is inadmissible because of safety and approval reasons (CE).
- The product is not a toy and must be kept out of the reach of children.Particular care must therefore be exercised if children are present.
- The product must not get damp or wet,it is only intended for use in dry,indoor locations(not bathrooms or similarly damp areas).There is a risk of a fatal electric shock.
- Do not expose the product or its accessories to damp or extremely high or low temperatures.
- Do not leave packing materials unattended.They may become dangerous playing material for children.
- Dropping,falling,pressure or tensile forces could destroy or at least limit the function of the product.
- Never position the device in the vicinity of combustible or easily inflammable materials,e.g.curtains!
- Always make sure that the rotary table on which the object is placed is located in the center of the housing!
- The device should continue to run for approximate 2 minutes after each application,which ensures the self-cleaning of the device!
- Always turn the device off and pull the mains plug out when the device is not in use!

- If the filter is contaminated with substantial amounts of paint, it can no longer work efficiently and must be replaced with a clean filter.
- To prevent health damage, never use poisonous, flammable or explosive paints or materials!
- Always ensure proper ventilation!
- To not impair the extraction performance, you may not extend the extraction pipe!
- In commercial institutions, the accident prevention regulations of the employer's liability insurance association for electrical systems and operating facilities are to be observed.
- In schools, training centres, hobby and self-help workshops, the use of the product must be supervised by trained personnel in a responsible manner.
- If you have reason to assume that safe operation is no longer possible, disconnect the device immediately and secure it against inadvertent operation.

It can be assumed that safe operation is no longer possible if:

- the device shows visible signs of damage,
- the device no longer functions,
- after a longer period of storage under unfavourable conditions,
- following heavy stress during transportation.

Choix de la source d'alimentation :

- 1、 Prise Amérique du Nord : CA 10 0 ~ 240 V - 50/ 60 Hz
- 2、 Prise européenne : CA 10 0 ~ 240 V - 50/ 60 Hz
- 3、 Prise australienne : CA 10 0 ~ 240 V - 50/ 60 Hz

Kit assorti :

19. Manuel d'instructions * 1
20. Tube d'expansion * 1
21. Sortie d'échappement à bouche plate * 1
22. Joint en caoutchouc * 1
23. Anneau de carte en fer * 1
24. Bande de lampe * 3

- 25. Adaptateur * 1
- 26. Table rotative * 1
- 27. Filtre en coton * 1

Adresse : Shuangchenglu 803nong11hao1602A-1609shi, baoshanqu, Shanghai 200000 CN.

Importé en Australie : SIHAO PTY LTD, 1 ROKEVA STREET, ASTWOOD NSW 2122, Australie

Importé aux États-Unis : Sanven Technology Ltd., Suite 250, 9166 Anaheim Place, Rancho Cucamonga, CA 91730

EC	REP
-----------	------------

E-CrossStu GmbH
Mainzer Landstr.69, 60329 Frankfurt am Main.

UK	REP
-----------	------------

YH CONSULTING LIMITED.
C/O YH Consulting Limited Office 147, Centurion House,
London Road, Staines-upon-Thames, Surrey, TW18 4AX



VEVOR

Affordable. Reliable. Home Improvement.

SPUITCABINE GEBRUIKERSHANDLEIDING

VEVOR

Affordable. Reliable. Home Improvement.

SPRAY BOOTH

MODEL: AH-311



Foto ter referentie

Dit is de originele handleiding. Lees alle instructies zorgvuldig door voordat u het product gebruikt. VEVOR behoudt zich het recht voor om de gebruiksaanwijzing duidelijk te interpreteren. Het uiterlijk van het product is afhankelijk van het product dat u hebt ontvangen. Neemt u het ons niet kwalijk dat we u niet meer op de hoogte stellen van eventuele technologische of software-updates voor ons product.

SAFETY INSTRUCTION AND PRECAUTIONS

⚠WAARSCHUWING:

Onjuist gebruik en slecht onderhoud van deze mini-luchtcompressor kan leiden tot ernstig persoonlijk letsel. Volg de volgende veiligheidsinstructies om elk risico te voorkomen! Lees al deze instructies zorgvuldig door en volg ze op!

1. Kies het juiste gereedschap en de juiste voeding met de juiste frequentie en spanning, afhankelijk van de lokale stroomvoorziening. Anders kan de motor beschadigd raken en/of kan er brand ontstaan.
2. Controleer of de machine, inclusief de aansluitingen en de schakelaar, in goede staat zijn.
3. De spuitcabine moet worden bediend volgens de geldende veiligheidsvoorschriften en alle stopcontacten moeten geaard zijn. Raak de elektrische kabel niet aan met natte handen.
4. Het eigenmachtig ombouwen, wijzigen of demonteren van de producten is om veiligheids- en keuringsredenen niet toegestaan .
5. Houd de werkruimte schoon en opgeruimd. Berg ongebruikt gereedschap op de daarvoor bestemde plaats op. Zorg voor een goede ventilatie van de werkruimte.
6. Gebruik de spuitcabine nooit in de aanwezigheid van ontvlambare vloeistoffen of gassen; de spuitcabine kan vonken produceren tijdens gebruik. Gebruik de cabine niet in ruimtes waar verf, benzine, chemicaliën, lijm en andere ontvlambare en explosieve stoffen aanwezig zijn .
7. Buiten het bereik van kinderen houden. Laat kinderen en andere irrelevante personen nooit de spuitcabine en het netsnoer aanraken. Onbevoegde personen dienen uit de buurt van het werkgebied te worden gehouden .
8. Open of manipuleer geen enkel onderdeel van de spuitcabine. Neem contact op met een erkend servicecentrum.
9. De spuitcabine moet in een geschikte omgeving worden gebruikt (goed geventileerd, met een omgevingstemperatuur tussen +5°C en +40°C)
10. Het apparaat moet na elk gebruik nog ongeveer 2 tot 6 minuten doorwerken, zodat het zichzelf reinigt!

1 1 . Indien u reden heeft om aan te nemen dat een veilige werking niet meer mogelijk is, dient u het apparaat onmiddellijk uit te schakelen en te beveiligen tegen onbedoelde bediening.

Indien u tijdens het gebruik een potentieel gevaarlijke situatie constateert, dient u onmiddellijk de stroom uit te schakelen.

FCC-informatie:

LET OP: Wijzigingen of aanpassingen die niet uitdrukkelijk zijn goedgekeurd door de partij die verantwoordelijk is voor de naleving, kunnen de bevoegdheid van de gebruiker om het apparaat te bedienen ongeldig maken!

Dit apparaat voldoet aan Deel 15 van de FCC-regels. Gebruik is onderworpen aan de volgende twee voorwaarden:

7) Dit product kan schadelijke interferentie veroorzaken.

8) Dit product moet alle ontvangen interferentie accepteren, inclusief interferentie die een ongewenste werking kan veroorzaken.

WAARSCHUWING: Wijzigingen of aanpassingen aan dit product die niet uitdrukkelijk zijn goedgekeurd door de partij die verantwoordelijk is voor de naleving, kunnen de bevoegdheid van de gebruiker om het product te bedienen ongeldig maken.

Let op: Dit product is getest en voldoet aan de limieten voor een digitaal apparaat van klasse B, conform Deel 15 van de FCC-regels. Deze limieten zijn bedoeld om een redelijke bescherming te bieden tegen schadelijke interferentie in een woonomgeving.

Dit product genereert, gebruikt en kan radiofrequentie-energie uitstralen. Indien niet geïnstalleerd en gebruikt volgens de instructies, kan het schadelijke interferentie veroorzaken in radiocommunicatie. Er is echter geen garantie dat er in een bepaalde installatie geen interferentie zal optreden. Als dit product schadelijke interferentie veroorzaakt in radio- of televisieontvangst, wat kan worden vastgesteld door het product uit en weer in te schakelen, wordt de gebruiker aangeraden de interferentie te verhelpen door een of meer van de volgende maatregelen te nemen.

- Heroriënteer of verplaats de ontvangstantenne.
- Vergroot de afstand tussen het product en de ontvanger.

- Sluit het product aan op een stopcontact in een ander circuit dan waarop de ontvanger is aangesloten.
- Raadpleeg de dealer of een ervaren radio-/tv-technicus voor hulp.

CORRECTE VERWIJDERING :



Dit product valt onder de bepalingen van de Europese Richtlijn 2012/19/EU. Het symbool met een doorgekruiste vuilnisbak geeft aan dat het product in de Europese Unie gescheiden afvalinzameling vereist. Dit geldt voor het product en alle accessoires die met dit symbool zijn gemarkeerd. Producten die als zodanig zijn gemarkeerd, mogen niet met het normale huisvuil worden weggegooid, maar moeten worden ingeleverd bij een inzamelpunt voor recycling van elektrische en elektronische apparaten.

Functies:

1. De spuitcabine is opvouwbaar en uitschuifbaar, heeft een slim formaat en is licht van gewicht.
2. Het heeft een klein vermogen, een grote luchtstroom, geen ventilatiebuis nodig, het bespaart energie en beschermt omgeving.
3. Het heeft een filternet met hoge dichtheid, kan de meeste verf en vocht filteren. En het veroorzaakt geen vervuiling.
4. Met een volledig transparante cabine, en de twee machines kunnen worden gecombineerd voor groot speelgoed.
5. Het heeft een aan/uit-schakelaar voor de verlichting, het zal licht op wanneer de machine aan staat. En het heeft een laag geluidsniveau. ongeveer 53 dB.
6. Het heeft een draaibaar bord en een handvat aan de bovenkant, handig in gebruik.
7. Het luchtvolume kan met een draaiknop op hoog en laag worden ingesteld.

Specificatie:

Motor: DC12V 5 A

Adapteringang : AC100-240V 50/60HZ
 Luchtstroom: 9,2 m³ /min
 Werkspanning (ledlamp): 12V
 Vermogen (ledlamp): 6W
 Geluidsniveau: ≤53 dB
 Krimpmaat: 54,8x29,2x32,7 cm
 Dimensie uitbreiden: 54,5 x 4 7,5 x 37 cm

Deellijst

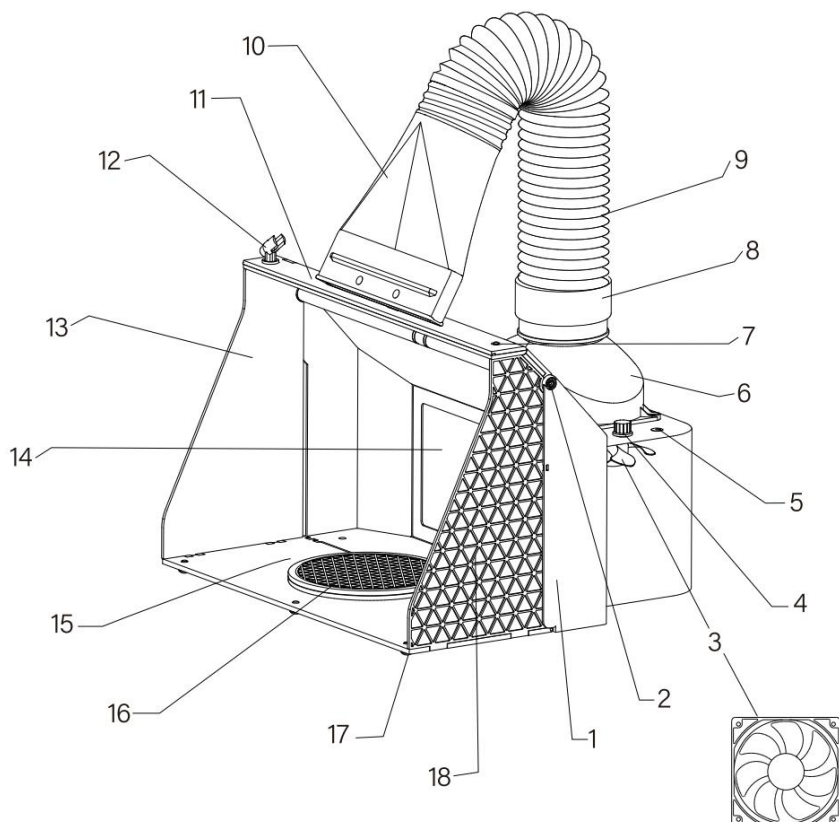

1	De stand	7	LED-lichtschakelaar	13	Bord
---	----------	---	---------------------	----	------

2	Lichtzone plaatpoort	8	Bevestigingsgesp voor luchtkanaal	14	Filternet voor schilderen
3	Fan	9	Kanaal	15	Voorste afdekplaat
4	Schakelaar	10	Kanaalkop	16	Draaibare draaitafel
5	Connector voor snoeradapter	11	Lichtzoneplaat	17	Rubberen voetjes
6	Connector voor kanaal	12	Houder	18	Bord

Productaccessoires:



AH-311 Spray booth



Duct



Duct head



Revolving
Turntable



Holder



Adapter

Gedetailleerde presentatie:

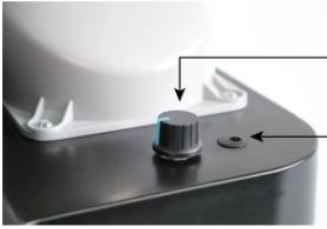

Switch: The suction size can be adjusted through the knob

Power interface

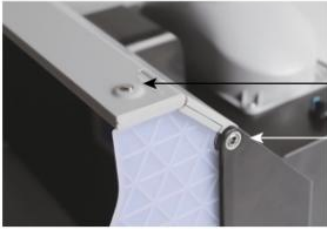

Light strip switch

The lamp has a power port

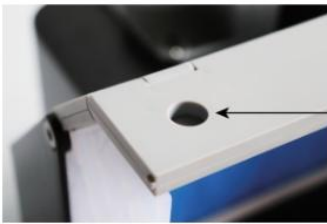

Airbrush holder placement hole

-The spray pen can be placed on the upper left of the spray booth to set the pen when painting or pausing.

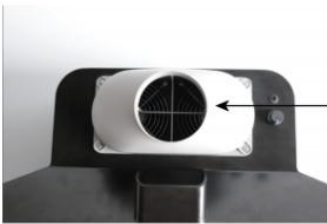

Bigger and stronger Double fan

-Inside two fans can work at the same time, let the air flow Be more powerful.
-Exhaust vent placed directly on top of the case, easier to adjust the air hosedirection.

Gebruiksaanwijzing:



1.Unfold The Lamp Strip Plate.



2.Unfold The Baseplate.



3.Respectively Unfold The Side Plate On Both Sides, Align Them With The Hole Positions Of The Lamp Cover Plate, And Fasten Them.



4. Painting table after expansion effect.



5.Extend the hose.



6.Fix the duct head on hose.



7.Connect the duct to connector.



8.Fasten the duct by screwing up the fasteners.



9. Install the spray airbrush holder.



10.The assembly is finished.



11.Plug the cord adapter and connect to Power pack.



12.Turn on the switch, the machine will start working.

Veiligheidsinstructies en gevaarwaarschuwingen

Please read the entire operating instructions before using the products for the first time; They contain important information about the correct operation.

The guarantee/warranty will be void if damage is incurred resulting from non-compliance with the operating instructions. Liability for any and all consequential damage is excluded!

We do not assume any liability for damage to property or personal injury caused by improper use or the failure to observe the safety instructions! In such cases the guarantee/warranty will be void.

- The unauthorised conversion,modification of disassembly of the products is inadmissible because of safety and approval reasons (CE).
- The product is not a toy and must be kept out of the reach of children.Particular care must therefore be exercised if children are present.
- The product must not get damp or wet,it is only intended for use in dry,indoor locations(not bathrooms or similarly damp areas).There is a risk of a fatal electric shock.
- Do not expose the product or its accessories to damp or extremely high or low temperatures.
- Do not leave packing materials unattended.They may become dangerous playing material for children.
- Dropping,falling,pressure or tensile forces could destroy or at least limit the function of the product.
- Never position the device in the vicinity of combustible or easily inflammable materials,e.g.curtains!
- Always make sure that the rotary table on which the object is placed is located in the center of the housing!
- The device should continue to run for approximate 2 minutes after each application,which ensures the self-cleaning of the device!
- Always turn the device off and pull the mains plug out when the device is not in use!

- If the filter is contaminated with substantial amounts of paint, it can no longer work efficiently and must be replaced with a clean filter.
- To prevent health damage, never use poisonous, flammable or explosive paints or materials!
- Always ensure proper ventilation!
- To not impair the extraction performance, you may not extend the extraction pipe!
- In commercial institutions, the accident prevention regulations of the employer's liability insurance association for electrical systems and operating facilities are to be observed.
- In schools, training centres, hobby and self-help workshops, the use of the product must be supervised by trained personnel in a responsible manner.
- If you have reason to assume that safe operation is no longer possible, disconnect the device immediately and secure it against inadvertent operation.

It can be assumed that safe operation is no longer possible if:

- the device shows visible signs of damage,
- the device no longer functions,
- after a longer period of storage under unfavourable conditions,
- following heavy stress during transportation.

Keuze van de energiebron :

1. Noord-Amerikaanse stekker: AC 10 0 ~ 240V - 50/ 60Hz
2. Europese stekker: AC 10 0 ~ 240V - 50/ 60Hz
3. Australische stekker: AC 10 0 ~ 240V - 50/ 60Hz

Bijpassende set :

28. Gebruiksaanwijzing * 1
29. Expansiebuis * 1
30. Uitlaat met platte mond * 1
31. Rubberen verbinding * 1
32. IJzeren kaartring * 1
33. Lampenstrip * 3

- 34. Adapter * 1
- 35. Draaitafel * 1
- 36. Filterkatoen * 1

Adres : Shuangchenglu 803nong11hao1602A-1609shi, baoshanqu, shanghai 200000 CN.

Geïmporteerd naar AUS: SIHAO PTY LTD, 1 ROKEVA STREETEASTWOOD NSW 2122 Australië

Geïmporteerd naar de VS: Sanven Technology Ltd., Suite 250, 9166 Anaheim Place, Rancho Cucamonga, CA 91730

EC	REP
-----------	------------

E-CrossStu GmbH
Mainzer Landstr.69, 60329 Frankfurt am Main.

UK	REP
-----------	------------

YH CONSULTING LIMITED.
C/O YH Consulting Limited Office 147, Centurion House,
London Road, Staines-upon-Thames, Surrey, TW18 4AX



VEVOR

Affordable. Reliable. Home Improvement.

SPRUTNINGSKABOS ANVÄNDARMANUAL

VEVOR

Affordable. Reliable. Home Improvement.

SPRAY BOOTH

MODELL: AH-311



Foto för referens

Detta är originalinstruktionerna, vänligen läs alla instruktioner noggrant innan du använder produkten. VEVOR förbehåller sig en tydlig tolkning av vår användarmanual. Produktens utseende ska vara beroende av den produkt du mottagit. Vi ber om ursäkt för att vi inte kommer att informera dig igen om det finns några teknik- eller programuppdateringar för vår produkt.

SAFETY INSTRUCTION AND PRECAUTIONS

⚠️ VARNING:

Okvalificerad användning och förbättrat underhåll av dessa mini-luftkompressorer kan leda till allvarliga personskador. Följande säkerhetsinstruktioner bör följas för att undvika risker! Läs alla dessa instruktioner noggrant och följ dem!

1. Välj rätt verktyg och anslut strömförsörjningen med rätt frekvens och spänning i enlighet med den lokala strömförsörjningen. Annars kan motorn skadas och/eller brand uppstå.
2. Kontrollera att maskinen, inklusive anslutning och brytare, är i gott skick.
3. Sprutboxen måste användas i enlighet med gällande säkerhetsföreskrifter och alla eluttag måste vara jordade. Rör inte elkabeln med våta händer.
4. Otillåten ombyggnad, modifiering eller demontering av produkterna är otillåten av säkerhets- och godkännandeskäl .
5. Håll arbetsområdet rent och snyggt. Oanvända verktyg ska förvaras på sina respektive platser. Se till att arbetsområdet är väl ventilerat.
6. Använd aldrig sprutboxen i närheten av brandfarliga vätskor eller gaser, sprutboxen kan producera gnistor under drift. Använd inte sprutboxen i områden där färger, bensin, kemikalier, lim och andra brandfarliga och explosiva ämnen finns .
7. Förvaras utom räckhåll för barn. Låt aldrig barn och andra obehöriga personer vidröra sprutboxen och dess nätsladd. Alla obehöriga personer ska hållas borta från arbetsområdet.
8. Öppna eller manipulera inte någon del av sprutboxen. Kontakta en auktoriserad serviceverkstad.
9. Sprutboxen måste användas i lämplig miljö (välventilerad, med en omgivningstemperatur mellan **+5°C** och **+40°C**)
- 10 . Apparaten bör fortsätta att vara igång i cirka 2 till 6 minuter efter varje användning, vilket säkerställer att apparaten självrengörs!
11. Om du har anledning att anta att säker drift inte längre är möjlig, koppla omedelbart bort apparaten och säkra den mot oavsiktlig användning. Om du upptäcker någon potentiell fara under användningen, **VÄNLIGEN** koppla bort strömmen omedelbart.

FCC-information:

WARNING: Ändringar eller modifieringar som inte uttryckligen godkänts av den part som ansvarar för efterlevnaden kan upphäva användarens rätt att använda utrustningen!

Denna enhet uppfyller del 15 i FCC-reglerna. Användning är underkastad följande två villkor:

9) Denna produkt kan orsaka skadliga störningar.

10) Denna produkt måste acceptera alla mottagna störningar, inklusive störningar som kan orsaka oönskad funktion.

WARNING: Ändringar eller modifieringar av denna produkt som inte uttryckligen godkänts av den part som ansvarar för efterlevnaden kan ogiltigförklara användarens rätt att använda produkten.

Obs! Denna produkt har testats och befunnits uppfylla gränserna för en digital enhet av klass B i enlighet med del 15 i FCC-reglerna. Dessa gränser är utformade för att ge rimligt skydd mot skadlig störning i en bostadsinstallation. Denna produkt genererar, använder och kan utstråla radiofrekvensenergi, och om den inte installeras och används i enlighet med instruktionerna kan den orsaka skadliga störningar på radiokommunikation. Det finns dock ingen garanti för att störningar inte kommer att uppstå i en viss installation. Om denna produkt orsakar skadliga störningar på radio- eller tv-mottagning, vilket kan fastställas genom att stänga av och slå på produkten, uppmanas användaren att försöka korrigera störningen med en eller flera av följande åtgärder.

- Rikta om eller flytta mottagarantennen.
- Öka avståndet mellan produkten och mottagaren.
- Anslut produkten till ett uttag på en annan krets än den som mottagaren är ansluten till.
- Kontakta återförsäljaren eller en erfaren radio-/TV-tekniker för hjälp.

KORREKT AVFALLSHANTERING :



Denna produkt omfattas av bestämmelserna i EU-direktiv

2012/19/EU. Symbolen som visar en överstruken soptunna indikerar att produkten kräver separat sophämtning inom Europeiska unionen. Detta gäller produkten och alla tillbehör som är märkta med denna symbol. Produkter som är märkta som sådana får inte kasseras med vanligt hushållsavfall, utan måste lämnas till en insamlingsplats för återvinning av elektriska och elektroniska apparater.

Drag:

1. Sprutboxen kan fällas ihop och förlängas, är smart i storleken och lätt i vikt.
2. Den har liten effekt, med stort luftflöde, inget behov av ventilationsrör, det sparar energi och skyddar miljö.
3. Den har ett filternät med hög densitet som kan filtrera bort det mesta av färgen och fukten. Och den har ingen förorening.
4. Den har en helt transparent box, och de två maskinerna kan kombineras för stora leksaker.
5. Den har en på/av-knapp för ljus . Ljuset tänds när maskinen slås på. Och den har lågt ljud. cirka 53 dB.
6. Den har en roterande platta och ett handtag på toppen, bekväm att använda.
7. Luftvolymen kan justeras till hög och låg med en ratt.

Specifikation:

Motor: DC12V 5 A

Adapteringång : AC100-240V 50/60HZ

Luftflöde: 9,2 m³/min

Arbetsspänning (Led-lampa): 12V

Effekt (Led-ljus): 6W

Bullernivå: ≤53 dB

Krympdimension: 54,8 x 29,2 x 32,7 cm

Utöka dimensionen: 54,5 x 4,7,5 x 37 cm

Dellista

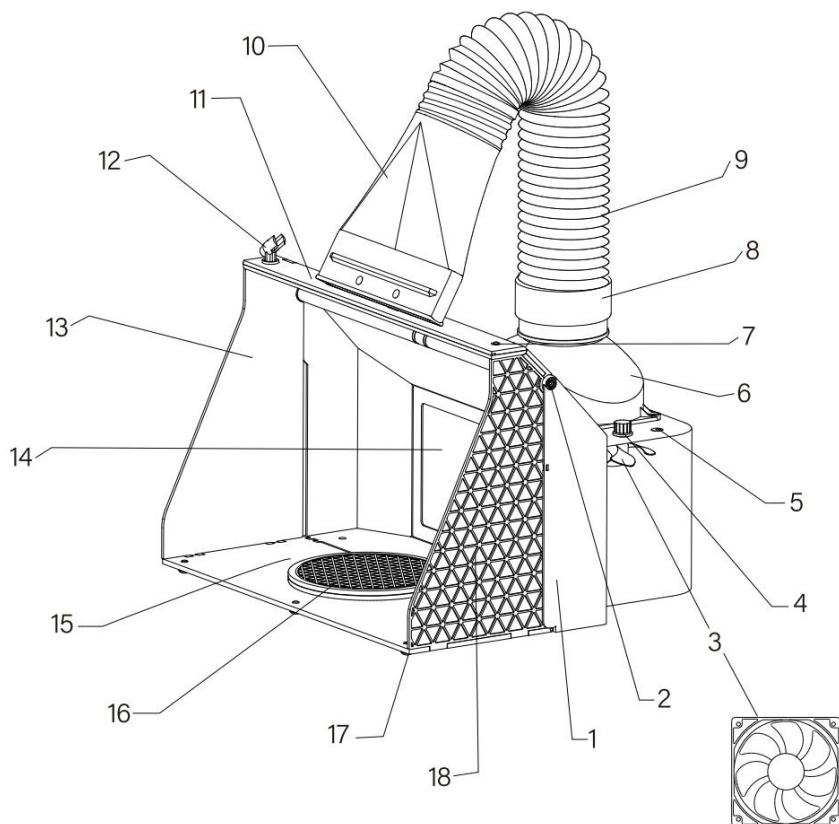

1	Båsens kropp	7	LED-ljusströmbrytare	13	Tallrik
2	Ljuszonplattans port	8	Spänne för fästning av luftkanaler	14	Filternät för målning
3	Fläkt	9	Kanal	15	Främre skyddsplatta
4	Växla	10	Kanalhuvud	16	Roterande skivspelare
5	Kontakt för sladdadapter	11	Ljuszonplatta	17	Gummifötter
6	Anslutning för kanal	12	Hållare	18	Tallrik

Produkttillbehör:



AH-311 Spray booth



Duct



Duct head



Revolving Turntable



Holder



Adapter

Detaljerad presentation:



Switch: The suction size can be adjusted through the knob

Power interface

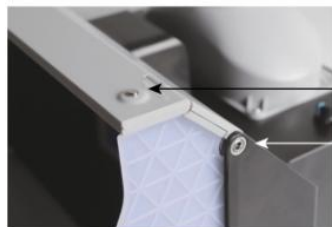

Light strip switch

The lamp has a power port

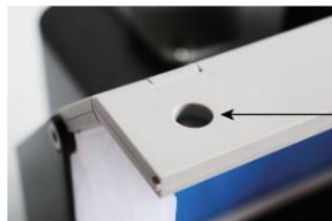

Airbrush holder placement hole

-The spray pen can be placed on the upper left of the spray booth to set the pen when painting or pausing.

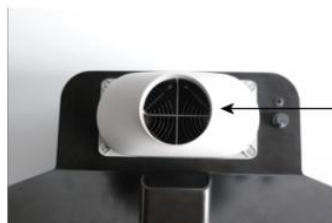

Bigger and stronger Double fan

-Inside two fans can work at the same time, let the air flow be more powerful.
-Exhaust vent placed directly on top of the case, easier to adjust the air hose direction.

Bruksanvisning:



1.Unfold The Lamp Strip Plate.

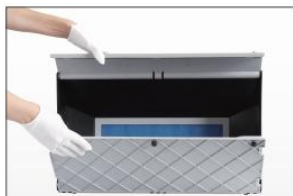

2.Unfold The Baseplate.



3.Respectively Unfold The Side Plate On Both Sides, Align Them With The Hole Positions Of The Lamp Cover Plate, And Fasten Them.



4. Painting table after expansion effect.



5.Extend the hose.



6.Fix the duct head on hose.



7.Connect the duct to connector.



8.Fasten the duct by screwing up the fasteners.



9. Install the spray airbrush holder.



10.The assembly is finished.



11.Plug the cord adapter and connect to Power pack.



12.Turn on the switch, the machine will start working.

Säkerhetsinstruktioner och varningar

Please read the entire operating instructions before using the products for the first time; They contain important information about the correct operation.

The guarantee/warranty will be void if damage is incurred resulting from non-compliance with the operating instructions. Liability for any and all consequential damage is excluded!

We do not assume any liability for damage to property or personal injury caused by improper use or the failure to observe the safety instructions! In such cases the guarantee/warranty will be void.

- The unauthorised conversion, modification or disassembly of the products is inadmissible because of safety and approval reasons (CE).
- The product is not a toy and must be kept out of the reach of children. Particular care must therefore be exercised if children are present.
- The product must not get damp or wet, it is only intended for use in dry, indoor locations (not bathrooms or similarly damp areas). There is a risk of a fatal electric shock.
- Do not expose the product or its accessories to damp or extremely high or low temperatures.
- Do not leave packing materials unattended. They may become dangerous playing material for children.
- Dropping, falling, pressure or tensile forces could destroy or at least limit the function of the product.
- Never position the device in the vicinity of combustible or easily inflammable materials, e.g. curtains!
- Always make sure that the rotary table on which the object is placed is located in the center of the housing!
- The device should continue to run for approximately 2 minutes after each application, which ensures the self-cleaning of the device!
- Always turn the device off and pull the mains plug out when the device is not in use!

- If the filter is contaminated with substantial amounts of paint, it can no longer work efficiently and must be replaced with a clean filter.
- To prevent health damage, never use poisonous, flammable or explosive paints or materials!
- Always ensure proper ventilation!
- To not impair the extraction performance, you may not extend the extraction pipe!
- In commercial institutions, the accident prevention regulations of the employer's liability insurance association for electrical systems and operating facilities are to be observed.
- In schools, training centres, hobby and self-help workshops, the use of the product must be supervised by trained personnel in a responsible manner.
- If you have reason to assume that safe operation is no longer possible, disconnect the device immediately and secure it against inadvertent operation.

It can be assumed that safe operation is no longer possible if:

- the device shows visible signs of damage,
- the device no longer functions,
- after a longer period of storage under unfavourable conditions,
- following heavy stress during transportation.

Val av strömkälla :

1. Nordamerikansk kontakt: AC 10 0 ~240V - 50/ 60Hz
2. Europeisk kontakt: AC 10 0 ~240V - 50/ 60Hz
3. Australiensk kontakt: AC 10 0 ~240V - 50/ 60Hz

Matchande kit :

37. Bruksanvisning * 1
38. Expansionsrör * 1
39. Platt avgasutlopp * 1
40. Gummifog * 1
41. Järnkörtring * 1
42. Lamprensa * 3

- 43. Adapter * 1
- 44. Roterande bord * 1
- 45. Filterbomull * 1

Address : Shuangchenglu 803nong11hao1602A-1609shi, baoshanqu, shanghai 200000 CN.

Importerad till Australien: SIHAO PTY LTD, 1 ROKEVA
STREETEASTWOOD NSW 2122 Australien

Importerad till USA: Sanven Technology Ltd., Suite 250, 9166 Anaheim
Place, Rancho Cucamonga, CA 91730

EC	REP
-----------	------------

E-CrossStu GmbH
Mainzer Landstr.69, 60329 Frankfurt am Main.

UK	REP
-----------	------------

YH CONSULTING LIMITED.
C/O YH Consulting Limited Office 147, Centurion House,
London Road, Staines-upon-Thames, Surrey, TW18 4AX



VEVOR

Affordable. Reliable. Home Improvement.

CABINA DE PINTURA MANUAL DEL USUARIO

VEVOR

Affordable. Reliable. Home Improvement.

SPRAY BOOTH

MODELO: AH-311



Foto de referencia

Estas son las instrucciones originales; lea atentamente todas las instrucciones del manual antes de utilizarlo. VEVOR se reserva el derecho de interpretar su manual de usuario. La apariencia del producto dependerá del producto que haya recibido. Le rogamos que nos disculpe si no le informamos de nuevo si hay actualizaciones tecnológicas o de software en nuestro producto.

SAFETY INSTRUCTION AND PRECAUTIONS

ADVERTENCIA:

El uso no cualificado y el mantenimiento inadecuado de este minicompresor de aire podrían causar lesiones personales graves. ¡ Sigan las siguientes instrucciones de seguridad para evitar cualquier riesgo! Lea atentamente todas estas instrucciones y sígalas.

1. Elija las herramientas adecuadas y la conexión a la fuente de alimentación con la frecuencia y el voltaje adecuados según la red eléctrica local. De lo contrario, el motor podría dañarse o provocar un incendio.
2. Verifique y asegúrese de que la máquina, incluida la conexión y el interruptor, estén en buenas condiciones.
3. La cabina de pintura debe operarse de acuerdo con las normas de seguridad vigentes y todas las tomas de corriente deben tener toma de tierra. No toque el cable eléctrico con las manos mojadas.
4. La conversión, modificación o desmontaje no autorizado de los productos no está permitido por razones de seguridad y de aprobación .
5. Mantenga el área de trabajo limpia y ordenada. Las herramientas no utilizadas deben guardarse en sus respectivos lugares. Asegúrese de que el área de trabajo esté bien ventilada.
6. Nunca utilice la cabina de pintura en presencia de líquidos o gases inflamables, ya que puede producir chispas durante su funcionamiento. No utilice la cabina en zonas donde haya pinturas, gasolina, productos químicos, adhesivos u otras sustancias inflamables y explosivas.
7. Mantener fuera del alcance de los niños. Nunca permita que niños ni otras personas no autorizadas toquen la cabina de pintura ni su cable de alimentación. Se debe mantener a toda persona no autorizada alejada del área de trabajo .
8. No abra ni manipule ninguna pieza de la cabina de pintura. Contacte con un centro de servicio autorizado .
9. La cabina de pintura debe utilizarse en un entorno adecuado (bien ventilado, con una temperatura ambiente entre **+5°C** y **+40°C**)

1 0 . El dispositivo debe seguir funcionando durante aproximadamente 2 a 6 minutos después de cada uso, lo que garantiza la autolimpieza del dispositivo.

1 1 . Si tiene motivos para suponer que ya no es posible un funcionamiento seguro, desconecte el dispositivo inmediatamente y asegúrelo contra un uso involuntario. Si encuentra algún peligro potencial durante el uso, DESCONECTE la alimentación inmediatamente.

Información de la FCC:

PRECAUCIÓN: ¡ Los cambios o modificaciones no aprobados expresamente por la parte responsable del cumplimiento podrían anular la autoridad del usuario para operar el equipo!

Este dispositivo cumple con la Parte 15 de las Normas de la FCC. Su funcionamiento está sujeto a las dos condiciones siguientes:

- 11) Este producto puede causar interferencias dañinas.
- 12) Este producto debe aceptar cualquier interferencia recibida, incluida aquella que pueda provocar un funcionamiento no deseado.

ADVERTENCIA: Los cambios o modificaciones a este producto no aprobados expresamente por la parte responsable del cumplimiento podrían anular la autoridad del usuario para operar el producto.

Nota: Este producto ha sido probado y se ha comprobado que cumple con los límites para un dispositivo digital de Clase B según la Parte 15 de las Normas de la FCC. Estos límites están diseñados para brindar protección razonable contra interferencias dañinas en una instalación residencial.

Este producto genera, utiliza y puede radiar energía de radiofrecuencia. Si no se instala y utiliza según las instrucciones, puede causar interferencias perjudiciales en las comunicaciones por radio. Sin embargo, no se garantiza que no se produzcan interferencias en una instalación específica. Si este producto causa interferencias perjudiciales en la recepción de radio o televisión, lo cual puede determinarse encendiéndolo y apagándolo, se recomienda al usuario que intente corregir la interferencia mediante una o más de las siguientes medidas.

- Reorientar o reubicar la antena receptora.
- Aumentar la distancia entre el producto y el receptor.
- Conecte el producto a una toma de corriente de un circuito diferente a aquel al que está conectado el receptor.

· Consulte al distribuidor o a un técnico de radio/TV experimentado para obtener ayuda.

ELIMINACIÓN CORRECTA :



Este producto está sujeto a la Directiva europea 2012/19/UE. El símbolo de un contenedor de basura tachado indica que el producto requiere recogida selectiva en la Unión Europea. Esto aplica al producto y a todos los accesorios marcados con este símbolo. Los productos marcados con este símbolo no pueden desecharse con la basura doméstica normal, sino que deben llevarse a un punto limpio para el reciclaje de aparatos eléctricos y electrónicos.

Características:

1. La cabina de pintura se puede plegar y extender, es de tamaño inteligente y liviana.
2. Tiene poca potencia, con gran flujo de aire, no necesita tubo de ventilación, ahorra energía y protege ambiente.
3. Cuenta con una red de filtro de alta densidad que filtra la mayor parte de la pintura y la humedad, sin contaminar.
4. Con una cabina totalmente transparente, las dos máquinas se pueden combinar para juguetes grandes.
5. Tiene un interruptor de encendido y apagado. Se enciende al encender la máquina. Tiene poco ruido. alrededor de 53 db.
6. Tiene un plato giratorio y un mango en la parte superior, cómodo de usar.
7. El volumen de aire se puede ajustar a alto o bajo mediante una perilla.

Especificación:

Motor: DC12V 5 A Entrada

del adaptador : AC100-240V 50/60HZ

Flujo de aire: 9,2 m³/min

Voltaje de funcionamiento (luz LED): 12 V

Potencia (luz LED): 6 W

Nivel de ruido: ≤ 53 db

Dimensión de contracción: 54,8 x 29,2 x 32,7 cm

Extender dimensión: 54,5 x 47,5 x 37 cm

Lista de piezas

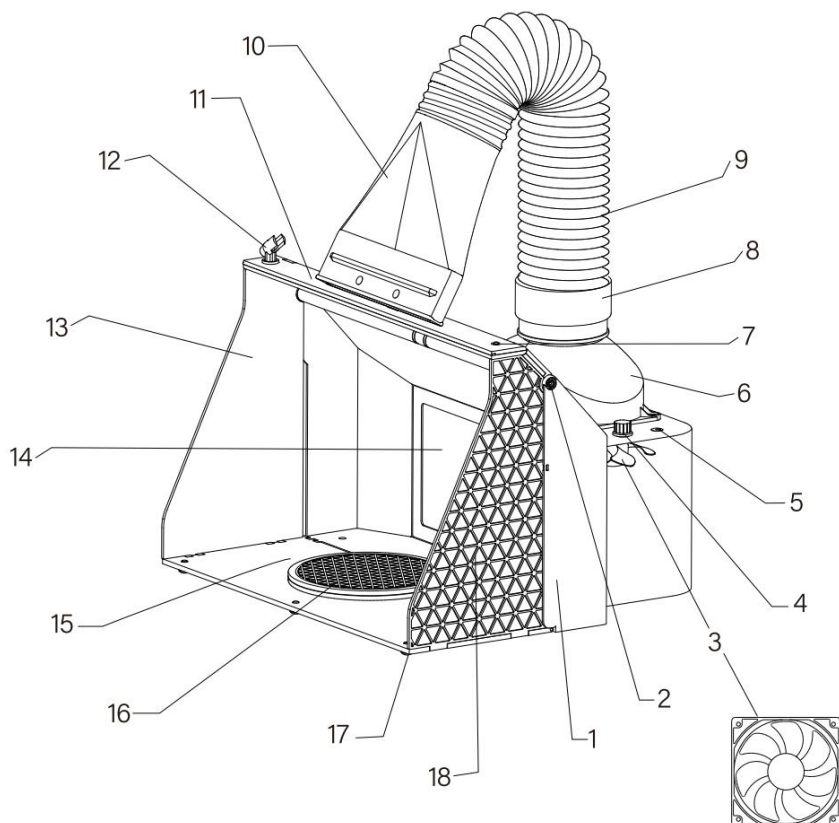

1	El cuerpo del stand	7	interruptor de luz LED	13	Lámina
2	Puerto de placa de zona de luz	8	Hebilla de sujeción del conducto de aire	14	Red de filtro para pintura

3	Admirador	9	Conducto	15	Placa de base de la cubierta frontal
4	Cambiar	10	Cabezal del conducto	16	Plato giratorio
5	Conector para adaptador de cable	11	Placa de zona clara	17	pies de goma
6	Conector para conducto	12	Titular	18	Lámina

Accesorios del producto:



AH-311 Spray booth



Duct



Duct head



Revolving Turntable



Holder



Adapter

Presentación detallada:



Switch: The suction size can be adjusted through the knob

Power interface

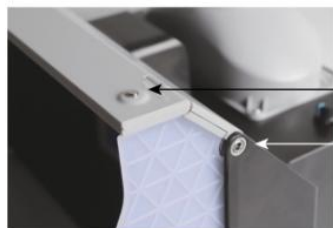

Light strip switch

The lamp has a power port

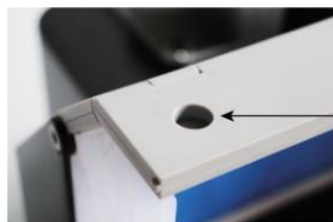

Airbrush holder placement hole

-The spray pen can be placed on the upper left of the spray booth to set the pen when painting or pausing.



Bigger and stronger Double fan

-Inside two fans can work at the same time, let the air flow Be more powerful.
-Exhaust vent placed directly on top of the case, easier to adjust the air hosedirection.

Instrucciones de funcionamiento:



1.Unfold The Lamp Strip Plate.



2.Unfold The Baseplate.



3.Respectively Unfold The Side Plate On Both Sides, Align Them With The Hole Positions Of The Lamp Cover Plate, And Fasten Them.



4. Painting table after expansion effect.



5.Extend the hose.

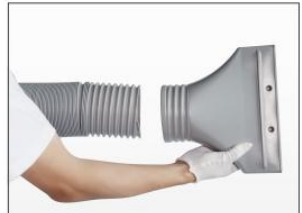

6.Fix the duct head on hose.



7.Connect the duct to connector.



8.Fasten the duct by screwing up the fasteners.



9. Install the spray airbrush holder.



10.The assembly is finished.



11.Plug the cord adapter and connect to Power pack.



12.Turn on the switch, the machine will start working.

Instrucciones de seguridad y advertencias de peligro

Please read the entire operating instructions before using the products for the first time; They contain important information about the correct operation.

The guarantee/warranty will be void if damage is incurred resulting from non-compliance with the operating instructions. Liability for any and all consequential damage is excluded!

We do not assume any liability for damage to property or personal injury caused by improper use or the failure to observe the safety instructions! In such cases the guarantee/warranty will be void.

- The unauthorised conversion,modification of disassembly of the products is inadmissible because of safety and approval reasons (CE).
- The product is not a toy and must be kept out of the reach of children.Particular care must therefore be exercised if children are present.
- The product must not get damp or wet,it is only intended for use in dry,indoor locations(not bathrooms or similarly damp areas).There is a risk of a fatal electric shock.
- Do not expose the product or its accessories to damp or extremely high or low temperatures.
- Do not leave packing materials unattended.They may become dangerous playing material for children.
- Dropping,falling,pressure or tensile forces could destroy or at least limit the function of the product.
- Never position the device in the vicinity of combustible or easily inflammable materials,e.g.curtains!
- Always make sure that the rotary table on which the object is placed is located in the center of the housing!
- The device should continue to run for approximate 2 minutes after each application,which ensures the self-cleaning of the device!
- Always turn the device off and pull the mains plug out when the device is not in use!

- If the filter is contaminated with substantial amounts of paint, it can no longer work efficiently and must be replaced with a clean filter.
- To prevent health damage, never use poisonous, flammable or explosive paints or materials!
- Always ensure proper ventilation!
- To not impair the extraction performance, you may not extend the extraction pipe!
- In commercial institutions, the accident prevention regulations of the employer's liability insurance association for electrical systems and operating facilities are to be observed.
- In schools, training centres, hobby and self-help workshops, the use of the product must be supervised by trained personnel in a responsible manner.
- If you have reason to assume that safe operation is no longer possible, disconnect the device immediately and secure it against inadvertent operation.

It can be assumed that safe operation is no longer possible if:

- the device shows visible signs of damage,
- the device no longer functions,
- after a longer period of storage under unfavourable conditions,
- following heavy stress during transportation.

Elección de la fuente de energía :

1. Enchufe de América del Norte: CA 10 0 ~240 V - 50/60 Hz
2. Enchufe europeo: CA 10 0 ~240 V - 50/60 Hz
3. Enchufe australiano: CA 10 0 ~240 V - 50/60 Hz

Kit a juego :

46. Manual de instrucciones * 1
47. Tubo de expansión * 1
48. Salida de escape de boca plana * 1
49. Junta de goma * 1
50. Anillo de tarjeta de hierro * 1
51. Tira de lámpara * 3

- 52. Adaptador * 1
- 53. Mesa giratoria * 1
- 54. Filtro de algodón * 1

Dirección : Shuangchenglu 803nong11hao1602A-1609shi, baoshanqu, shanghai 200000 CN.

Importado a AUS: SIHAO PTY LTD, 1 ROKEVA STREET, EASTWOOD, NSW 2122, Australia

Importado a EE. UU.: Sanven Technology Ltd., Suite 250, 9166 Anaheim Place, Rancho Cucamonga, CA 91730

EC	REP
-----------	------------

E-CrossStu GmbH
Mainzer Landstr.69, 60329 Frankfurt am Main.

UK	REP
-----------	------------

YH CONSULTING LIMITED.
C/O YH Consulting Limited Office 147, Centurion House,
London Road, Staines-upon-Thames, Surrey, TW18 4AX



VEVOR

Affordable. Reliable. Home Improvement.

CABINA DI VERNICIATURA MANUALE D'USO

VEVOR

Affordable. Reliable. Home Improvement.

SPRAY BOOTH

MODELLO: AH-311



Foto di riferimento

Queste sono le istruzioni originali, si prega di leggere attentamente tutte le istruzioni del manuale prima dell'uso. VEVOR si riserva la piena interpretazione del proprio manuale utente. L'aspetto del prodotto dipenderà dal prodotto ricevuto. Vi preghiamo di scusarci se non vi informeremo più in caso di aggiornamenti tecnologici o software sul nostro prodotto.

SAFETY INSTRUCTION AND PRECAUTIONS

⚠AVVERTIMENTO:

L'uso improprio e la manutenzione non corretta di questo mini compressore d'aria possono causare gravi lesioni personali. Per evitare qualsiasi rischio, attenersi alle seguenti istruzioni di sicurezza! Leggere attentamente tutte le istruzioni e seguirle!

1. Scegliere gli utensili giusti e un alimentatore con la giusta frequenza e tensione in base alla rete elettrica locale. In caso contrario, il motore potrebbe danneggiarsi e/o potrebbe verificarsi un incendio.

2. Verificare e assicurarsi che la macchina, compresi i collegamenti e l'interruttore, siano in buone condizioni.

3. La cabina di verniciatura deve essere utilizzata in conformità alle vigenti norme di sicurezza e tutte le prese di corrente devono essere dotate di messa a terra.

Non toccare il cavo elettrico con le mani bagnate.

4. Per motivi di sicurezza e di omologazione non è ammessa la trasformazione, la modifica o lo smontaggio non autorizzati dei prodotti .

5. Mantenere l'area di lavoro pulita e ordinata. Gli utensili non utilizzati devono essere riposti nei rispettivi spazi. Assicurarsi che l'area di lavoro sia ben ventilata.

6. Non utilizzare mai la cabina di verniciatura in presenza di liquidi o gas infiammabili: la cabina di verniciatura potrebbe produrre scintille durante il funzionamento. Non utilizzare la cabina in aree in cui siano presenti vernici, benzina, prodotti chimici, adesivi e altre sostanze infiammabili ed esplosive .

7. Tenere fuori dalla portata dei bambini. Non permettere mai ai bambini o ad altre persone non autorizzate di toccare la cabina di verniciatura e il relativo cavo di alimentazione. Tutte le persone non autorizzate devono essere tenute lontane dall'area di lavoro.

8. Non aprire o manomettere alcuna parte della cabina di verniciatura. Contattare un centro di assistenza autorizzato .

9. La cabina di verniciatura deve essere utilizzata in un ambiente idoneo (ben ventilato, con una temperatura ambiente compresa tra +5°C e +40°C)

10 . Dopo ogni utilizzo, il dispositivo deve continuare a funzionare per circa 2-6 minuti, il che garantisce l'autopulizia del dispositivo!

1 1 . Se si ha motivo di supporre che non sia più possibile un funzionamento sicuro, scollegare immediatamente l'apparecchio e proteggerlo da un utilizzo involontario. Se durante l'uso si riscontrano situazioni potenzialmente pericolose, SCOLLEGARE immediatamente l'alimentazione.

Informazioni FCC:

ATTENZIONE: Cambiamenti o modifiche non espressamente approvati dalla parte responsabile della conformità potrebbero invalidare l'autorizzazione dell'utente a utilizzare l'apparecchiatura!

Questo dispositivo è conforme alla Parte 15 delle Norme FCC. Il funzionamento è soggetto alle seguenti due condizioni:

13) Questo prodotto potrebbe causare interferenze dannose.

14) Questo prodotto deve accettare qualsiasi interferenza ricevuta, comprese quelle che potrebbero causare un funzionamento indesiderato.

ATTENZIONE: Modifiche o alterazioni apportate al prodotto non espressamente approvate dalla parte responsabile della conformità potrebbero invalidare l'autorizzazione dell'utente a utilizzare il prodotto.

Nota: questo prodotto è stato testato e ritenuto conforme ai limiti per i dispositivi digitali di Classe B, ai sensi della Parte 15 delle Norme FCC. Tali limiti sono concepiti per fornire una protezione ragionevole contro interferenze dannose in un'installazione residenziale.

Questo prodotto genera, utilizza e può irradiare energia a radiofrequenza e, se non installato e utilizzato secondo le istruzioni, può causare interferenze dannose alle comunicazioni radio. Tuttavia, non vi è alcuna garanzia che tali interferenze non si verifichino in una particolare installazione. Se questo prodotto causa interferenze dannose alla ricezione radiofonica o televisiva, verificabili spegnendo e riaccendendo il prodotto, si consiglia all'utente di provare a correggere l'interferenza adottando una o più delle seguenti misure.

- Riorientare o riposizionare l'antenna ricevente.
- Aumentare la distanza tra il prodotto e il ricevitore.
- Collegare il prodotto a una presa di corrente su un circuito diverso da quello a cui è collegato il ricevitore.
- Per assistenza, consultare il rivenditore o un tecnico radio/TV esperto.

SMALTIMENTO CORRETTO :



Questo prodotto è soggetto alle disposizioni della Direttiva Europea 2012/19/UE. Il simbolo raffigurante un bidone della spazzatura barrato indica che il prodotto richiede la raccolta differenziata nell'Unione Europea. Questo vale per il prodotto e tutti gli accessori contrassegnati da questo simbolo. I prodotti contrassegnati come tali non possono essere smaltiti con i normali rifiuti domestici, ma devono essere conferiti presso un punto di raccolta per il riciclaggio di apparecchiature elettriche ed elettroniche.

Caratteristiche:

1. La cabina di verniciatura può essere piegata ed estesa, è di dimensioni compatte e leggera.
2. Ha una potenza ridotta, un grande flusso d'aria, non necessita di tubo di ventilazione, risparmia energia e protegge ambiente.
3. Ha una rete filtrante ad alta densità, può filtrare la maggior parte della vernice e dell'umidità. E non inquina.
4. Con cabina completamente trasparente, e le due macchine possono essere combinate insieme per giocattoli di grandi dimensioni.
5. Ha un interruttore di accensione/spegnimento della luce, si accende quando la macchina si accende. E ha un basso rumore circa 53 db.
6. Ha una piastra girevole e una maniglia nella parte superiore, comoda da usare.
7. Il volume dell'aria può essere regolato su alto o basso tramite una manopola.

Specifiche:

Motore: DC12V 5 A Ingresso

adattatore : AC100-240V 50/60HZ

Flusso d'aria: 9,2 m³ /min

Tensione di lavoro (luce LED): 12 V

Potenza (luce LED): 6W

Livello di rumore: ≤ 53 db

Dimensione di restringimento: 54,8x29,2x32,7 centimetri

Estendi dimensione: 54,5 x4,7,5 x37 cm

Elenco delle parti

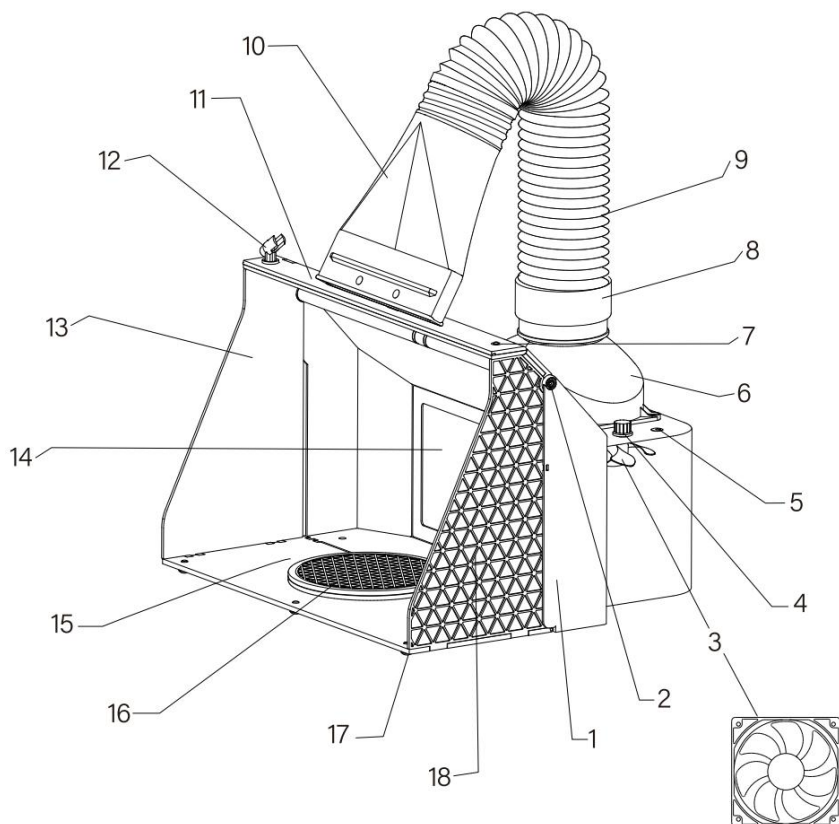

1	Il corpo della cabina	7	interruttore della luce a LED	13	Piatto
2	Porta della piastra della zona	8	Fibbia di fissaggio del condotto	14	Rete filtrante per verniciatura

	luminosa		dell'aria		
3	Fan	9	Condotto	15	Piastra di copertura anteriore
4	Interruttore	10	Testa del condotto	16	Giradischi girevole
5	Connettore per adattatore per cavo	11	Piastra della zona luminosa	17	Piedini in gomma
6	Connettore per condotto	12	Titolare	18	Piatto

Accessori del prodotto:



AH-311 Spray booth



Duct



Duct head



Revolving Turntable



Holder



Adapter

Presentazione dettagliata:



Switch: The suction size can be adjusted through the knob

Power interface

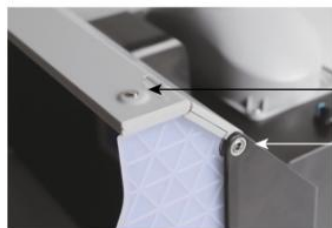

Light strip switch

The lamp has a power port

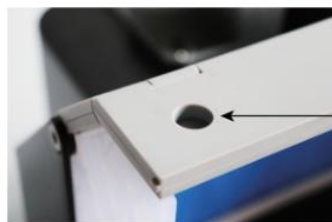

Airbrush holder placement hole

-The spray pen can be placed on the upper left of the spray booth to set the pen when painting or pausing.



Bigger and stronger Double fan

-Inside two fans can work at the same time, let the air flow be more powerful.
-Exhaust vent placed directly on top of the case, easier to adjust the air hose direction.

Istruzioni per l'uso:



1.Unfold The Lamp Strip Plate.



2.Unfold The Baseplate.



3.Respectively Unfold The Side Plate On Both Sides, Align Them With The Hole Positions Of The Lamp Cover Plate, And Fasten Them.



4. Painting table after expansion effect.



5.Extend the hose.



6.Fix the duct head on hose.



7.Connect the duct to connector.



8.Fasten the duct by screwing up the fasteners.



9. Install the spray airbrush holder.



10.The assembly is finished.



11.Plug the cord adapter and connect to Power pack.



12.Turn on the switch, the machine will start working.

Istruzioni di sicurezza e avvertenze di pericolo

Please read the entire operating instructions before using the products for the first time; They contain important information about the correct operation.

The guarantee/warranty will be void if damage is incurred resulting from non-compliance with the operating instructions. Liability for any and all consequential damage is excluded!

We do not assume any liability for damage to property or personal injury caused by improper use or the failure to observe the safety instructions! In such cases the guarantee/warranty will be void.

- The unauthorised conversion, modification or disassembly of the products is inadmissible because of safety and approval reasons (CE).
- The product is not a toy and must be kept out of the reach of children. Particular care must therefore be exercised if children are present.
- The product must not get damp or wet, it is only intended for use in dry, indoor locations (not bathrooms or similarly damp areas). There is a risk of a fatal electric shock.
- Do not expose the product or its accessories to damp or extremely high or low temperatures.
- Do not leave packing materials unattended. They may become dangerous playing material for children.
- Dropping, falling, pressure or tensile forces could destroy or at least limit the function of the product.
- Never position the device in the vicinity of combustible or easily inflammable materials, e.g. curtains!
- Always make sure that the rotary table on which the object is placed is located in the center of the housing!
- The device should continue to run for approximately 2 minutes after each application, which ensures the self-cleaning of the device!
- Always turn the device off and pull the mains plug out when the device is not in use!

- If the filter is contaminated with substantial amounts of paint, it can no longer work efficiently and must be replaced with a clean filter.
- To prevent health damage, never use poisonous, flammable or explosive paints or materials!
- Always ensure proper ventilation!
- To not impair the extraction performance, you may not extend the extraction pipe!
- In commercial institutions, the accident prevention regulations of the employer's liability insurance association for electrical systems and operating facilities are to be observed.
- In schools, training centres, hobby and self-help workshops, the use of the product must be supervised by trained personnel in a responsible manner.
- If you have reason to assume that safe operation is no longer possible, disconnect the device immediately and secure it against inadvertent operation.

It can be assumed that safe operation is no longer possible if:

- the device shows visible signs of damage,
- the device no longer functions,
- after a longer period of storage under unfavourable conditions,
- following heavy stress during transportation.

Scelta della fonte di alimentazione :

1. Spina del Nord America: CA 10 0 ~240 V - 50/60 Hz
2. Spina europea: CA 10 0 ~240 V - 50/60 Hz
3. Spina australiana: CA 10 0 ~240 V - 50/60 Hz

Kit coordinato :

55. Manuale di istruzioni * 1
56. Tubo di espansione * 1
57. Uscita di scarico a bocca piatta * 1
58. Giunto in gomma * 1
59. Anello di carta di ferro * 1
60. Striscia di lampade * 3

- 61. Adattatore * 1
- 62. Tavola rotante * 1
- 63. Filtro di cotone * 1

Indirizzo : Shuangchenglu 803nong11hao1602A-1609shi, baoshanqu, shanghai 200000 CN.

Importato in AUS: SIHAO PTY LTD, 1 ROKEVA STREETEASTWOOD NSW 2122 Australia

Importato negli USA: Sanven Technology Ltd., Suite 250, 9166 Anaheim Place, Rancho Cucamonga, CA 91730

EC	REP
-----------	------------

E-CrossStu GmbH
Mainzer Landstr.69, 60329 Frankfurt am Main.

UK	REP
-----------	------------

YH CONSULTING LIMITED.
C/O YH Consulting Limited Office 147, Centurion House,
London Road, Staines-upon-Thames, Surrey, TW18 4AX



VEVOR

Affordable. Reliable. Home Improvement.

KABINA LAKIERNICZA INSTRUKCJA OBSŁUGI

VEVOR

Affordable. Reliable. Home Improvement.

SPRAY BOOTH

MODEL: AH-311



Zdjęcie w celach informacyjnych

To jest oryginalna instrukcja obsługi. Przed użyciem prosimy o dokładne zapoznanie się z treścią instrukcji. Firma VEVOR zastrzega sobie prawo do jednoznacznej interpretacji niniejszej instrukcji obsługi. Wygląd produktu zależy od stanu, w jakim go otrzymali Państwo. Prosimy o wyrozumiałość, ale nie będziemy Państwa ponownie informować o aktualizacjach technologicznych lub oprogramowania naszego produktu.

SAFETY INSTRUCTION AND PRECAUTIONS

⚠OSTRZEŻENIE:

Niewłaściwe użytkowanie i niewłaściwa konserwacja tych minikompresorów powietrza może spowodować poważne obrażenia ciała. Aby uniknąć ryzyka, należy przestrzegać poniższych instrukcji bezpieczeństwa! Prosimy o uważne przeczytanie wszystkich instrukcji i ich przestrzeganie!

1. Wybierz odpowiednie narzędzia i podłącz zasilanie o odpowiedniej częstotliwości i napięciu, zgodnie z lokalnymi przepisami. W przeciwnym razie silnik może ulec uszkodzeniu i/lub może dojść do pożaru.
2. Sprawdź i upewnij się, że maszyna, łącznie z przyłączami i przełącznikami, jest w dobrym stanie.
3. Kabina lakiernicza musi być obsługiwana zgodnie z obowiązującymi przepisami bezpieczeństwa, a wszystkie gniazda elektryczne muszą być uziemione. Nie dotykaj kabla elektrycznego mokrymi rękami.
4. Nieautoryzowana przebudowa, modyfikacja lub demontaż produktów jest niedopuszczalny ze względów bezpieczeństwa i homologacji .
5. Utrzymuj miejsce pracy w czystości i porządku. Nieużywane narzędzia należy przechowywać na swoim miejscu. Upewnij się, że miejsce pracy jest dobrze wentylowane.
6. Nigdy nie używaj kabiny lakierniczej w obecności łatwopalnych cieczy lub gazów, ponieważ kabina może wytwarzać iskry podczas pracy. Nie używaj kabiny w miejscach, w których znajdują się farby, benzyna, chemikalia, kleje i inne substancje łatwopalne i wybuchowe .
7. Trzymać poza zasięgiem dzieci. Nigdy nie pozwalać dzieciom i innym osobom nieupoważnionym dotykać kabiny lakierniczej ani jej przewodu zasilającego. Osoby nieupoważnione powinny przebywać z dala od obszaru roboczego .
8. Nie otwieraj ani nie manipuluj żadną częścią kabiny lakierniczej. Skontaktuj się z autoryzowanym serwisem.

9. Kabina lakiernicza musi być używana w odpowiednim środowisku (dobrze wentylowanym, o temperaturze otoczenia od +5°C i +40°C)

10. Urządzenie powinno działać jeszcze przez ok. 2 – 6 minut po każdym użyciu, co zapewni samoczynne oczyszczenie urządzenia!

11. Jeżeli istnieją podstawy, by sądzić, że dalsza bezpieczna praca urządzenia nie jest możliwa, należy natychmiast odłączyć urządzenie i zabezpieczyć je przed przypadkowym uruchomieniem.

Jeśli podczas użytkowania zauważysz jakiegokolwiek potencjalne zagrożenie, **PROSZĘ** natychmiast odłączyć zasilanie.

Informacje FCC:

UWAGA: Zmiany lub modyfikacje, na które nie wyraziła wyrażnej zgody strona odpowiedzialna za zgodność, mogą spowodować unieważnienie prawa użytkownika do korzystania ze sprzętu!

To urządzenie jest zgodne z częścią 15 przepisów FCC. Jego eksploatacja podlega dwóm następującym warunkom:

15) Ten produkt może powodować szkodliwe zakłócenia.

16) Produkt ten musi być odporny na wszelkie zakłócenia, w tym zakłócenia mogące powodować niepożądane działanie.

OSTRZEŻENIE: Wszelkie zmiany lub modyfikacje tego produktu, które nie zostały wyraźnie zatwierdzone przez stronę odpowiedzialną za zgodność, mogą spowodować unieważnienie prawa użytkownika do korzystania z produktu.

Uwaga: Produkt ten został przetestowany i uznany za zgodny z ograniczeniami dla urządzeń cyfrowych klasy B zgodnie z częścią 15 przepisów FCC.

Ograniczenia te mają na celu zapewnienie odpowiedniej ochrony przed szkodliwymi zakłóceniami w instalacjach domowych.

Ten produkt generuje, wykorzystuje i może emitować energię o częstotliwości radiowej i jeśli nie zostanie zainstalowany i używany zgodnie z instrukcją, może powodować szkodliwe zakłócenia w komunikacji radiowej. Nie ma jednak gwarancji, że zakłócenia nie wystąpią w danej instalacji. Jeśli ten produkt powoduje szkodliwe zakłócenia w odbiorze sygnału radiowego lub telewizyjnego, co można sprawdzić, wyłączając i włączając urządzenie, zaleca się, aby

użytkownik spróbował skorygować zakłócenia, stosując jeden lub kilka z poniższych środków.

- Zmiana orientacji lub położenia anteny odbiorczej.
- Zwiększ odległość między produktem i odbiornikiem.
- Podłączyć produkt do gniazdka w innym obwodzie niż ten, do którego podłączony jest odbiornik.
- Aby uzyskać pomoc, skontaktuj się ze sprzedawcą lub doświadczonym technikiem radiowo-telewizyjnym.

PRAWIDŁOWA UTYLIZACJA :



Niniejszy produkt podlega przepisom dyrektywy europejskiej 2012/19/UE. Symbol przekreślonego kosza na śmieci na kółkach oznacza, że produkt wymaga selektywnej zbiórki odpadów w Unii Europejskiej. Dotyczy to produktu i wszystkich akcesoriów oznaczonych tym symbolem. Produktów oznaczonych tym symbolem nie wolno wyrzucać razem z normalnymi odpadami domowymi, lecz należy je oddać do punktu zbiórki urządzeń elektrycznych i elektronicznych przeznaczonych do recyklingu.

Cechy:

1. Kabinę natryskową można składać i rozkładać, jest mała i lekka.
2. Ma małą moc, ale duży przepływ powietrza, nie wymaga rury wentylacyjnej, oszczędza energię i chroni środowisko.
3. Posiada filtr siatkowy o wysokiej gęstości, który filtruje większość farby i wilgoci. Nie powoduje zanieczyszczeń.
4. Posiada całkowicie przezroczystą kabinę, a obie maszyny można łączyć, tworząc duże zabawki.
5. Posiada włącznik /wyłącznik światła, który ... Światło po włączeniu urządzenia. I niski poziom hałasu. około 53 dB.
6. Posiada obrotowy talerz i uchwyt na górze, co ułatwia użytkowanie.
7. Objętość powietrza można regulować za pomocą pokrętkła.

Specyfikacja:

Silnik: DC12V 5 A Wejście

adaptera : AC100-240V 50/60 Hz

Przepływ powietrza: 9,2 m³/min

Napięcie robocze (dioda LED): 12 V

Moc (światło LED): 6 W

Poziom hałas: ≤53 dB

Wymiar kurczenia: 54,8 x 29,2 x 32,7 cm

Rozszerz wymiar: 54,5 x 47,5 x 37 cm

Lista części

Akcesoria produktu:



AH-311 Spray booth



Duct



Duct head



Revolving
Turntable



Holder



Adapter

Prezentacja szczegółowa:



Switch: The suction size can be adjusted through the knob

Power interface

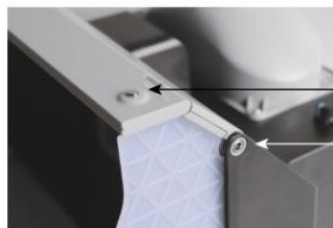

Light strip switch

The lamp has a power port

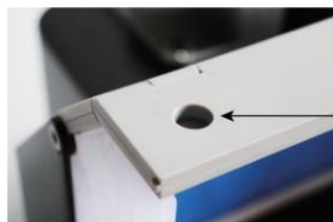

Airbrush holder placement hole

-The spray pen can be placed on the upper left of the spray booth to set the pen when painting or pausing.



Bigger and stronger Double fan

-Inside two fans can work at the same time, let the air flow Be more powerful.
-Exhaust vent placed directly on top of the case, easier to adjust the air hosedirection.

Instrukcja obsługi:



1.Unfold The Lamp Strip Plate.



2.Unfold The Baseplate.



3.Respectively Unfold The Side Plate On Both Sides, Align Them With The Hole Positions Of The Lamp Cover Plate, And Fasten Them.



4. Painting table after expansion effect.



5.Extend the hose.

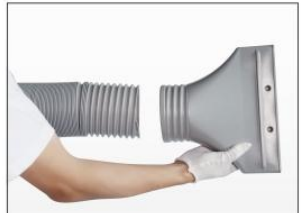

6.Fix the duct head on hose.



7.Connect the duct to connector.



8.Fasten the duct by screwing up the fasteners.



9. Install the spray airbrush holder.



10.The assembly is finished.



11.Plug the cord adapter and connect to Power pack.



12.Turn on the switch, the machine will start working.

Instrukcje bezpieczeństwa i ostrzeżenia o zagrożeniach

Please read the entire operating instructions before using the products for the first time; They contain important information about the correct operation.

The guarantee/warranty will be void if damage is incurred resulting from non-compliance with the operating instructions. Liability for any and all consequential damage is excluded!

We do not assume any liability for damage to property or personal injury caused by improper use or the failure to observe the safety instructions! In such cases the guarantee/warranty will be void.

- The unauthorised conversion,modification of disassembly of the products is inadmissible because of safety and approval reasons (CE).
- The product is not a toy and must be kept out of the reach of children.Particular care must therefore be exercised if children are present.
- The product must not get damp or wet,it is only intended for use in dry,indoor locations(not bathrooms or similarly damp areas).There is a risk of a fatal electric shock.
- Do not expose the product or its accessories to damp or extremely high or low temperatures.
- Do not leave packing materials unattended.They may become dangerous playing material for children.
- Dropping,falling,pressure or tensile forces could destroy or at least limit the function of the product.
- Never position the device in the vicinity of combustible or easily inflammable materials,e.g.curtains!
- Always make sure that the rotary table on which the object is placed is located in the center of the housing!
- The device should continue to run for approximate 2 minutes after each application,which ensures the self-cleaning of the device!
- Always turn the device off and pull the mains plug out when the device is not in use!

- If the filter is contaminated with substantial amounts of paint, it can no longer work efficiently and must be replaced with a clean filter.
- To prevent health damage, never use poisonous, flammable or explosive paints or materials!
- Always ensure proper ventilation!
- To not impair the extraction performance, you may not extend the extraction pipe!
- In commercial institutions, the accident prevention regulations of the employer's liability insurance association for electrical systems and operating facilities are to be observed.
- In schools, training centres, hobby and self-help workshops, the use of the product must be supervised by trained personnel in a responsible manner.
- If you have reason to assume that safe operation is no longer possible, disconnect the device immediately and secure it against inadvertent operation.

It can be assumed that safe operation is no longer possible if:

- the device shows visible signs of damage,
- the device no longer functions,
- after a longer period of storage under unfavourable conditions,
- following heavy stress during transportation.

Wybór źródła zasilania :

1. Wtyczka północnoamerykańska: Prąd zmienny 10 0 ~ 240 V - 50/60 Hz
2. Wtyczka europejska: Prąd zmienny 10 0 ~ 240 V - 50/60 Hz
3. Wtyczka australijska: Prąd zmienny 10 0 ~ 240 V - 50/60 Hz

Pasujący zestaw :

64. Instrukcja obsługi * 1
65. Rurka rozprężna * 1
66. Wylot spalin płaski * 1
67. Złącze gumowe * 1
68. Pierścień z żelazną kartą * 1
69. Pasek lampowy * 3

- 70. Adapter * 1
- 71. Stół obrotowy * 1
- 72. Filtr bawełniany * 1

Adres : Shuangchenglu 803nong11hao1602A-1609shi, baoshanqu, szanghaj 200000 CN.

Importowane do Australii: SIHAO PTY LTD, 1 ROKEVA STREETEASTWOOD NSW 2122 Australia

Importowane do USA: Sanven Technology Ltd., Suite 250, 9166 Anaheim Place, Rancho Cucamonga, CA 91730

EC	REP
-----------	------------

E-CrossStu GmbH
Mainzer Landstr.69, 60329 Frankfurt am Main.

UK	REP
-----------	------------

YH CONSULTING LIMITED.
C/O YH Consulting Limited Office 147, Centurion House,
London Road, Staines-upon-Thames, Surrey, TW18 4AX

